

STATE OF ILLINOIS  
DEPARTMENT OF TRANSPORTATION

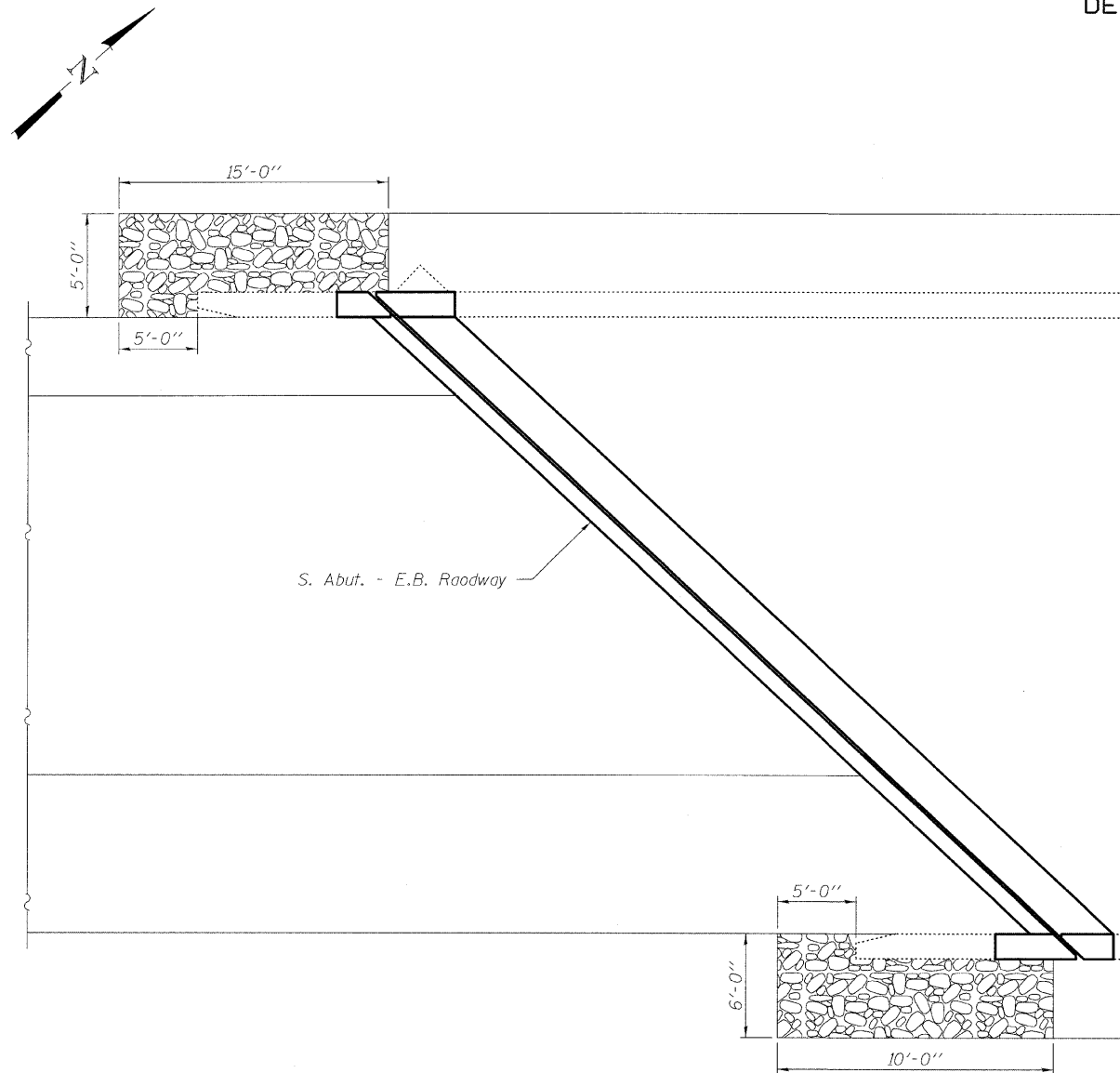

PLAN OF RIPRAP

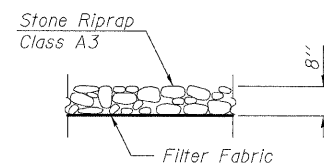

SECTION THRU RIPRAP

GENERAL NOTES

No field welding is permitted except as specified in the contract documents. Reinforcement bars shall conform to the requirements of ASTM A 706 Gr 60. See Special Provisions.

Reinforcement bars designated (E) shall be epoxy coated.

Prior to pouring the new concrete deck, all heavy or loose rust, loose mill scale, and other loose or potentially detrimental foreign material shall be removed from the surfaces in contact with concrete. Tightly adhered paint may remain unless otherwise noted. Removal shall be accomplished by methods that will not damage the steel and the cost will be included in the pay item covering removal of the existing concrete.

Plan dimensions and details relative to existing plans are subject to nominal construction variations. The Contractor shall field verify existing dimensions and details affecting new construction and make necessary approved adjustments prior to construction or ordering of materials. Such variations shall not be cause for additional compensation for a change in scope of the work, however, the Contractor will be paid for the quantity actually furnished at the unit price bid for the work.

Concrete Sealer shall be applied to the designated areas of the abutments. The existing structural steel coating contains lead. The Contractor shall take appropriate precautions to deal with the presence of lead on this project.

The Organic Zinc Rich Primer / Epoxy / Urethane Paint System shall be used for painting of new structural steel except where otherwise noted. The entire system shall be shop applied, with the exception that masked off connection surfaces, field installed fasteners and damaged areas shall be touched up in the field. The color of the final finish coat shall be Gray, Munsell No. 5B 7/1. See Special Provision for "Cleaning and Painting New Metal Structures".

Fasteners shall be high strength bolts. bolts  $\frac{3}{4}$ " $\phi$ , open holes  $\frac{13}{16}$ " $\phi$ , or Bolts  $\frac{7}{8}$ " $\phi$ , open holes  $\frac{15}{16}$ " $\phi$ , unless otherwise noted.

Existing structural steel that will be in contact with new structural steel shall be cleaned and painted prior to erection as required by the Special Provision "Cleaning and Painting Contact Surface Areas of Existing Steel Structures".

The bridge deck, parapets, and abutment seats shall be washed according to Article 592.00 of the Standard Specifications. Cost is included with Bridge Washing No. 3.

The joints between the bridge approach slab and wingwalls shall be sealed according to Article 452.00 of the Standard Specifications.

All structural steel shall conform to AASHTO Classification M 270 Gr. 36, unless otherwise noted.

Existing reinforcement bars extending into the removal area shall be cleaned, straightened and incorporated into the new construction. Any reinforcement bars that are damaged during concrete removal shall be replaced with an approved bar splicer or anchorage system. Cost included with "Concrete Removal".

If the analysis submitted to the Contractor for the jacking/temporary support system to be used shows temporary stiffeners are required to prevent web crippling or buckling, the stiffeners shall be steel and bolted to the web. If stiffeners are not required, hardwood timbers shall be installed tightly between the top and bottom flange to prevent flange rotation.

Joint openings shall be adjusted according to Article 520.04 of the Standard Specifications when the deck is poured at an ambient temperature other than 50° F.

Concrete Sealer shall be applied to the surfaces of the bridge deck and parapets, including wings. See Special Provision "Bridge Deck Concrete Sealer".

TOTAL BILL OF MATERIAL  
TWO STRUCTURES

ITEM	UNIT	SUPER	SUB	TOTAL
Stone Riprap, Class A3	Sq. Yd.		15	15
Filter Fabric	Sq. Yd.		15	15
Joint or Crack Filling	Pound			30
Concrete Removal	Cu. Yd.	87.3	2.6	89.9
Structure Excavation	Cu. Yd.		13	13
Concrete Structures	Cu. Yd.		20.4	20.4
Concrete Superstructure	Cu. Yd.	87.1		87.1
Furnishing and Erecting Structural Steel	Pound	64,530		64,530
Jack and Remove Existing Bearings	Each	12		12
Reinforcement Bars, Epoxy Coated	Pound	5,770	3,290	9,060
Bar Splicers	Each	40		40
Preformed Joint Strip Seal	Foot	473.5		473.5
Elastomeric Bearing Assembly, Type I	Each	12		12
Anchor Bolts, 1/2"	Each	24		24
Concrete Sealer	Sq. Ft.	24,005	1,210	25,215
Bridge Washing No. 3	Each			2

DESIGNED	EML
CHECKED	KLH
DRAWN	EML
CHECKED	KLH

GENERAL DATA  
STRUCTURE NO. 060-0014 (E.B.)  
STRUCTURE NO. 060-0015 (W.B.)

**HORNER & SHIFRIN, INC.**  
ENGINEERS

SHEET NO. 2 16 SHEETS	F.A.I. RTE. 70	SECTION 60-(6,7)BR	COUNTY MADISON	TOTAL SHEETS 185	SHEET NO. 130
	CONTRACT NO. 76C56				
FED. ROAD DIST. NO. ILLINOIS FED. AID PROJECT					