

Notes:

See sheet 4 of 14 for Bill of Material.

Bars indicated thus 4x2-#4 etc, indicates 4 lines of bars with 2 lengths per line.

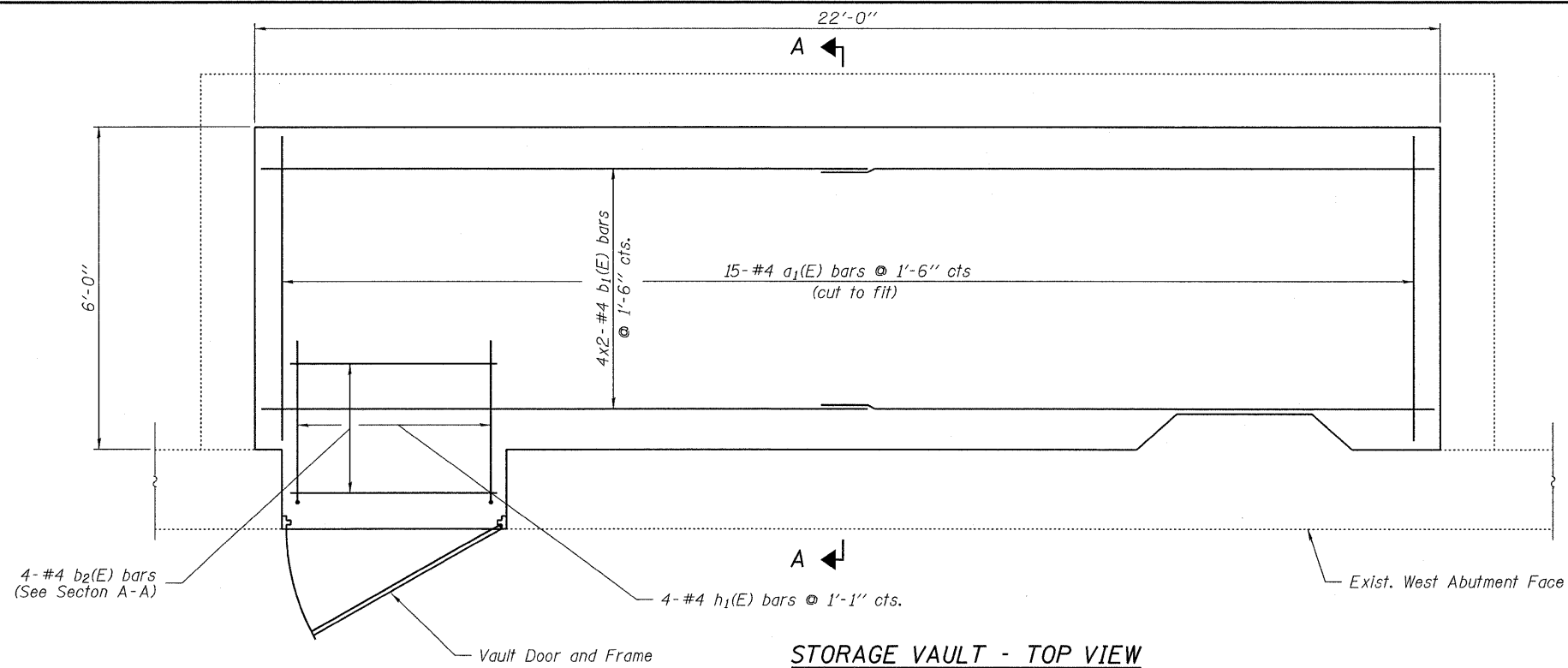

STORAGE VAULT - TOP VIEW

MIN. BAR LAP

#4 bar = 1'-0"

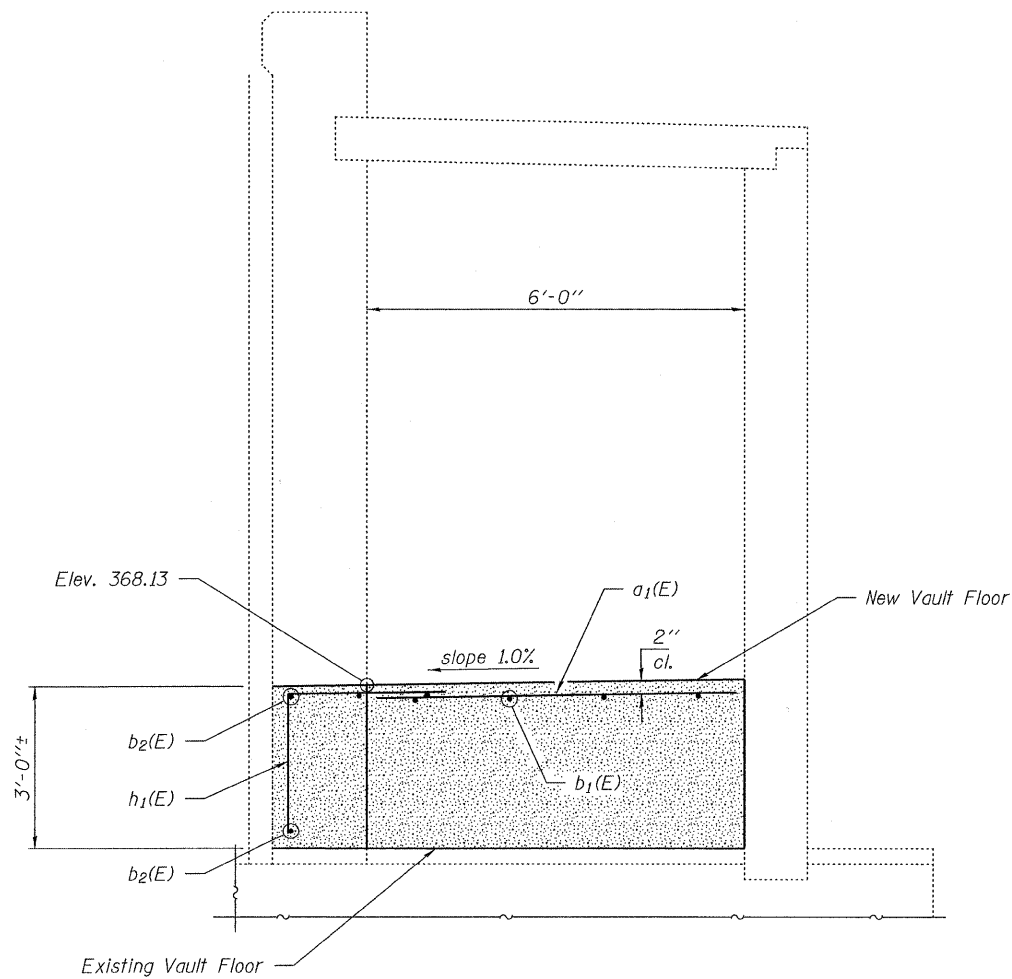

SECTION A-A

SILL SLAB, WALL &
VAULT MODIFICATION DETAILS
MOVABLE LEVEE CLOSURE STRUCTURE

DESIGNED - T.P.L.
CHECKED - M.D.C., S.M.S.
DRAWN - P.J.L.
CHECKED - J.L.B.

HAMPTON, LENZINI & RENWICK, INC. CIVIL & STRUCTURAL ENGINEERS LAND SURVEYORS  3085 STEVENSON DRIVE, SUITE 201 SPRINGFIELD, ILLINOIS 62703 (217) 546-3400	SHEET NO. 6 14 SHEETS	FAP	SECTION	COUNTY	TOTAL SHEETS	SHEET NO.
		869	(105)RS-2	SALINE	82	41
PROJECT NUMBER: 08.0214.130 DATE: 10/01/09		IL - 34 HARRISBURG		CONTRACT NO. 78079		
		FED. ROAD DIST. NO.	ILLINOIS	FED. AID PROJECT		