

F.A.U. RTE	SECTION	COUNTY	TOTAL SHEETS	SHEET NO.
5827	02-00221-00-RP	ROCK ISLAND		

NOTE:  
PLACE STONE SURFACE SPECIAL  
BETWEEN SIDEWALK AND RETAINING  
WALL.

DRIVEWAY WIDTHS	@ CURB	@ THROAT
P.E. STA. 104+18.4 / RT	20.2'	12.0'
P.E. STA. 105+00 / RT	18.0'	12.0'
P.E. STA. 106+49 / RT	32.2'	26.2'
P.E. STA. 107+69.8	18.0'	12.0'

STA 106+05 / 14.80' LT  
MANHOLE TY "A", 4' DIA.  
W/ T. I F. OPEN LID (STORM)  
RIM ELEV. = 666.25  
INVERT IN EAST = 654.62  
INVERT IN NORTH = 657.11  
INVERT OUT = 654.29  
CONNECT EXISTING STORM SEWER  
TO NEW MANHOLE, INCIDENTAL.

LOW POINT ELEV = 663.27  
LOW POINT STA = 109+83.26  
PVI STA = 110+25.68  
PVI ELEV = 661.77  
A.D. = 2.76  
K = 163.33  
450.00' VC

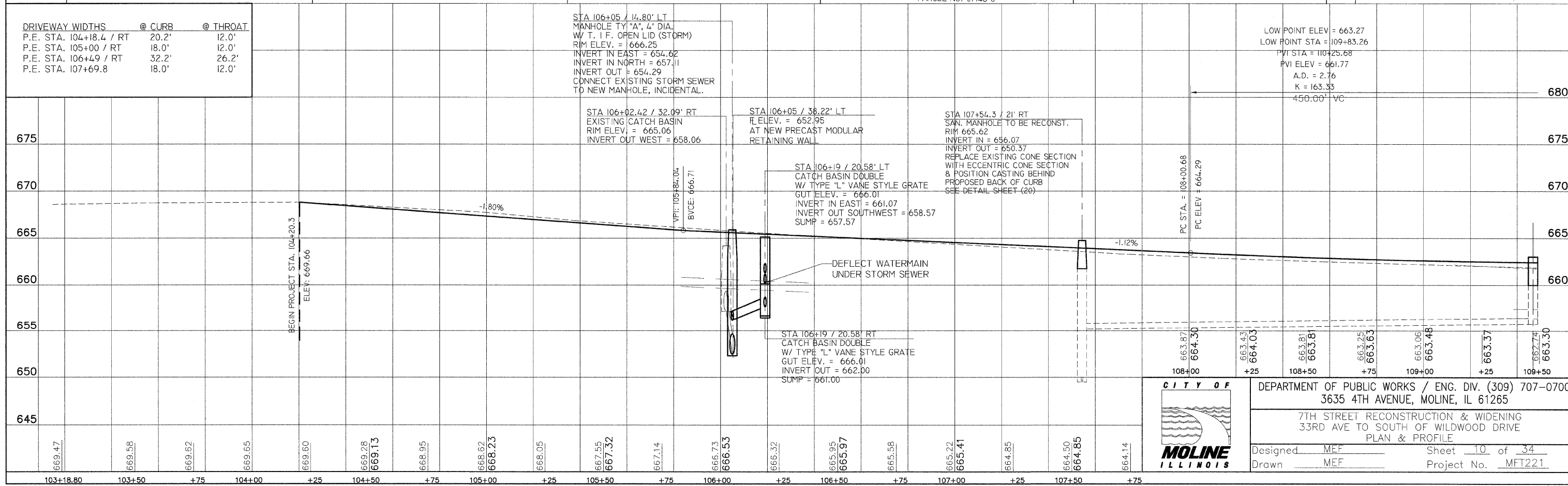

DEPARTMENT OF PUBLIC WORKS / ENG. DIV. (309) 707-0700  
3635 4TH AVENUE, MOLINE, IL 61265  
7TH STREET RECONSTRUCTION & WIDENING  
33RD AVE TO SOUTH OF WILDWOOD DRIVE  
PLAN & PROFILE  
Designed MEF Sheet 10 of 34  
Drawn MEF Project No. MFT221