

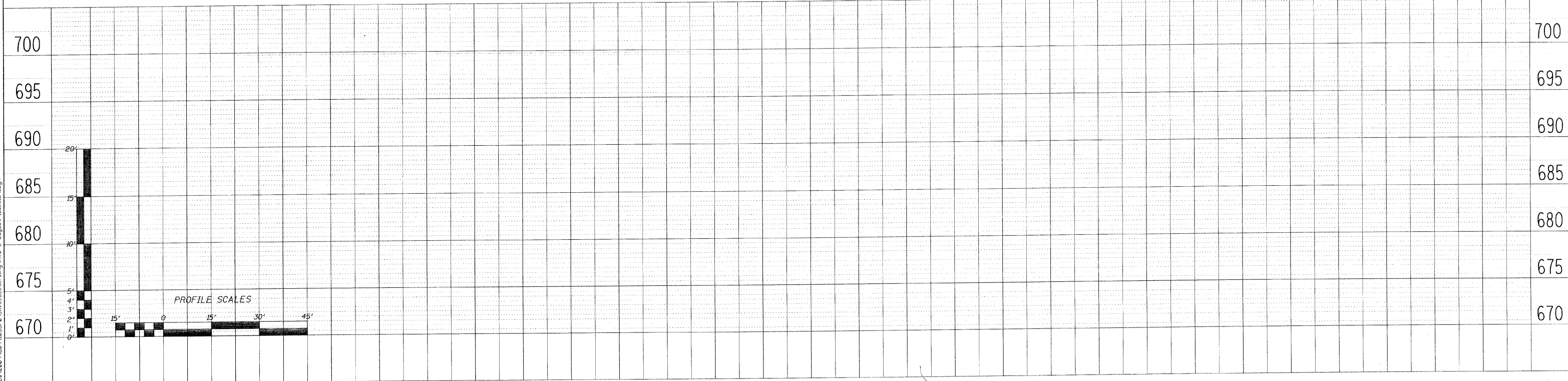

INDICATES LIMIT OF HOT MIX ASPHALT SURFACE REMOVAL - 2 3/4". REMOVE FULL WIDTH OF AVENUE G AND AT INTERSECTING STREETS AS SHOWN.

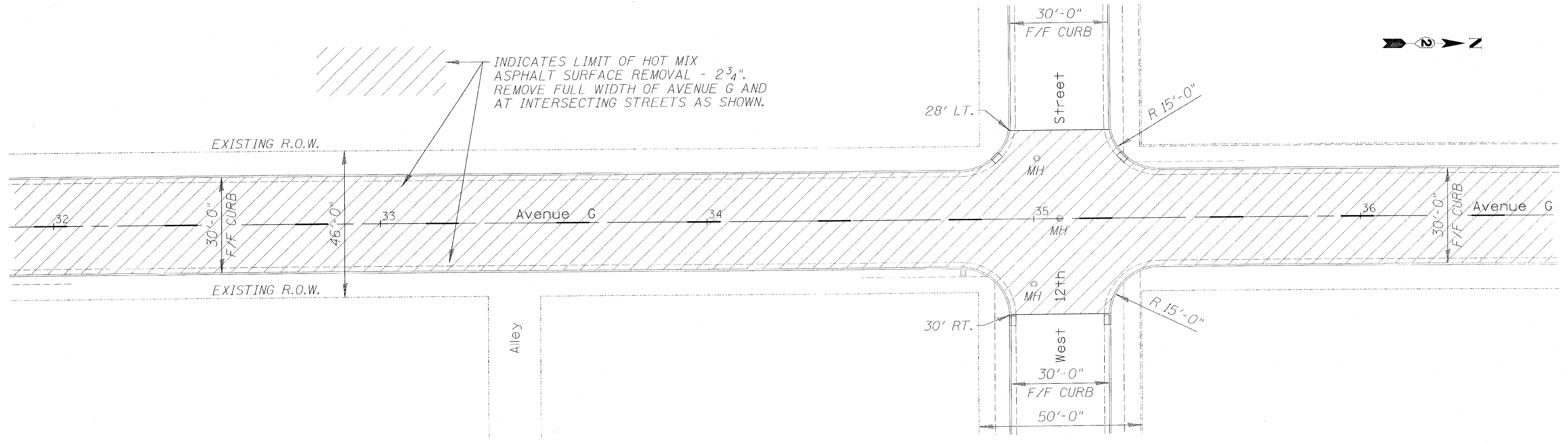

FILE NAME: L:\Jobs\2005\09\103525\Ave G Sterling\Ave G Layout 10.28.05.dgn

WILLET, HOFMANN & ASSOCIATES, INC.
CONSULTING ENGINEERS
809 East Second Street Dixon, IL 61021
Phone 815.284.3381 Fax 815.284.3385
Design Firm #184-00918
www.wiltothofmann.com

DESIGNED	- BDF	REVISED	-
DRAWN	- JDH	REVISED	-
CHECKED	- BDF	REVISED	-
DATE	-	REVISED	-

CITY OF STERLING, ILLINOIS AVENUE G - 5TH STREET TO LE FEVRE RD.

AVENUE G PLAN & PROFILE

SCALE: SHEET NO. 13 OF 31 SHEETS

F.A. RTE.	SECTION	COUNTY	TOTAL SHEETS	SHEET NO.
	09-00147-00-RS	WHITESIDE	31	13
CONTRACT NO. 85495				
FED. ROAD DIST. NO. [] ILLINOIS FED. AID PROJECT				