

EXISTING CURVE DATA

- Δ - 3° 00'
- D - 1° 12'
- R - 4,774.74'
- T - 125.00'
- L - 250.00'
- E - 1.64'

INDICATES LIMIT OF HOT MIX ASPHALT SURFACE REMOVAL - 1 1/4" REMOVE FULL WIDTH OF 12TH AVENUE AND AT INTERSECTING STREETS AS SHOWN.

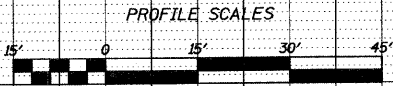
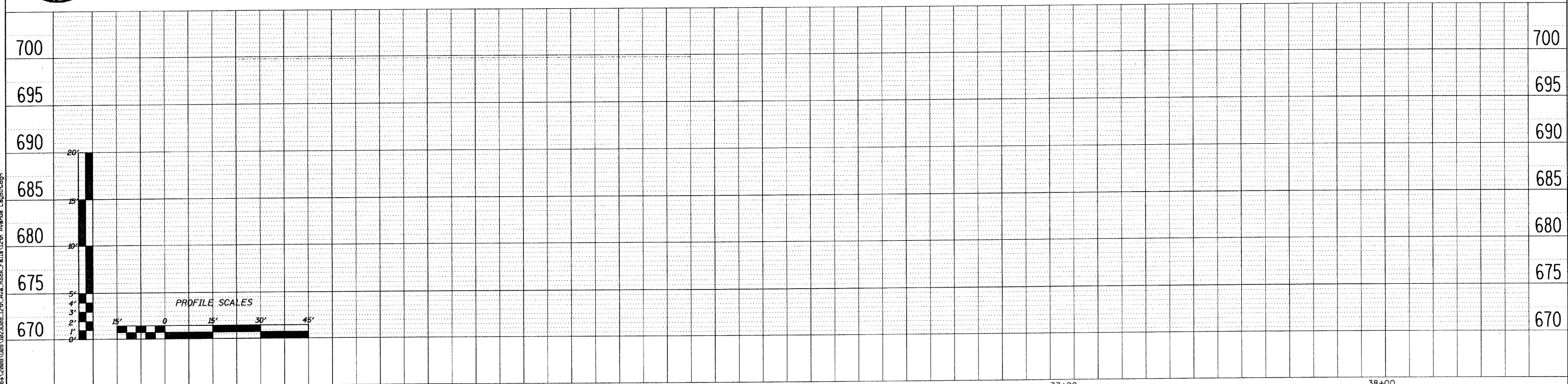
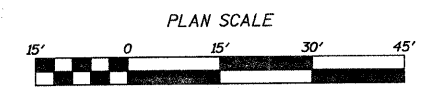
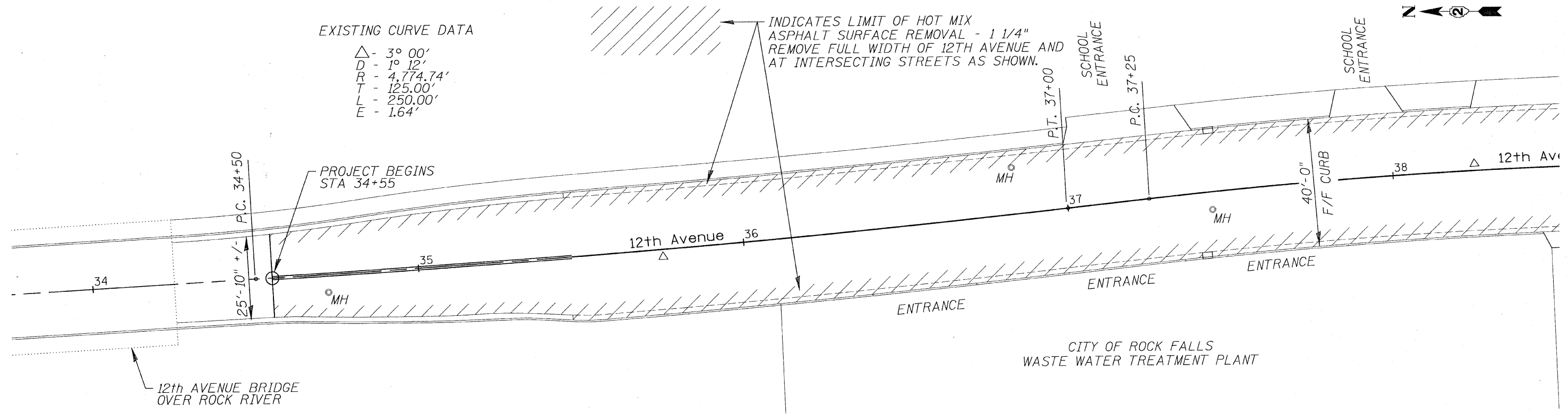

FILE NAME: L:\Vista\2008\08\12th Ave Rock Falls\12th Avenue Layout.dgn

**WILLETT, HOFMANN & ASSOCIATES, INC.**  
**CONSULTING ENGINEERS**  
 809 East Second Street Dixon, IL 61021  
 Phone: 815.284.3381 Fax: 815.284.3385  
 Design Firm #104-00019  
 www.willettthofmann.com

DESIGNED - BDF	REVISED -
DRAWN - JDH	REVISED -
CHECKED - BDF	REVISED -
DATE -	REVISED -

**CITY OF ROCK FALLS, ILLINOIS**  
**12th AVE. - ROCK RIVER BRIDGE to W. 10th ST.**

**12TH AVENUE PLAN & PROFILE**

F.A. RTE.	SECTION	COUNTY	TOTAL SHEETS	SHEET NO.
	09-00130-00-RS	WHITESIDE	21	6
CONTRACT NO. 85499				
FED. ROAD DIST. NO.		ILLINOIS FED. AID PROJECT		