

F.A.S. ROUTE NO.	SECTION	ILLINOIS PROJECT	CONTRACT NO.	COUNTY	TOTAL SHEETS	SHEET NUMBER
268	06-00173-00-SW	TE-0003(58)	87359	LASALLE	15	7

**F.A.S. 268 - MAIN STREET**  
**SECTION 06-00173-00-SW**  
**CITY OF MARSEILLES, LASALLE COUNTY**

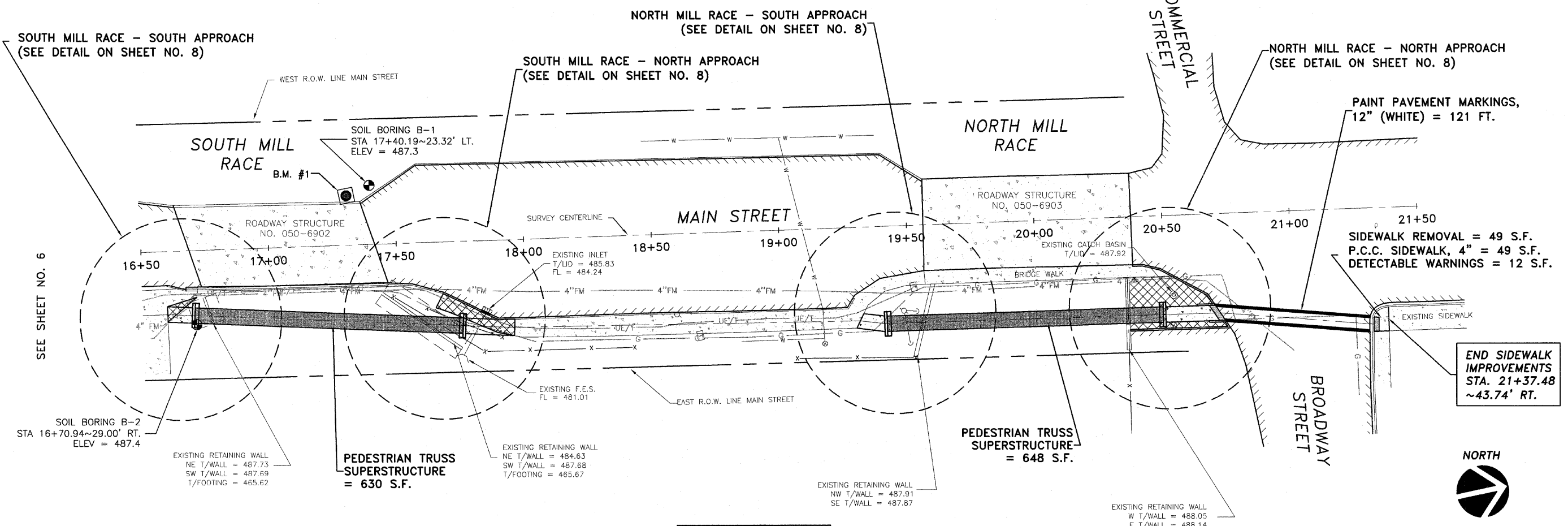

**SCALES**  
**PLAN**  
 HORIZ. : 1" = 20'  
**PROFILE**  
 HORIZ. : 1" = 20'  
 VERT. : 1" = 5'

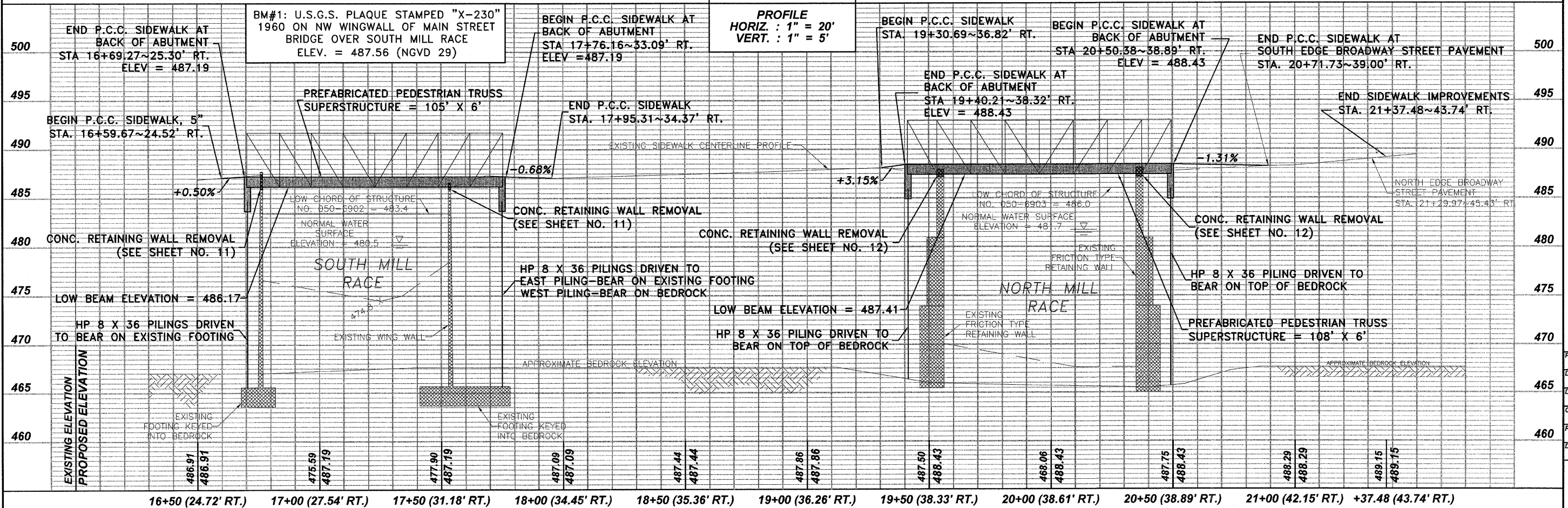

134 GEMINI CIRCLE  
 OTTAWA, IL 61350-1092  
 TEL: 815-434-3025  
 FAX: 815-434-3033  
**ETSCHEID**  
**DUTTLINGER**  
**& ASSOCIATES INC.**  
 Professional Engineers & Land Surveyors

PROFESSIONAL DESIGN  
 FIRM # 184-000711  
 DATE PLOTTED:  
 OCTOBER 21, 2009  
 DRAWN BY:  
 R.M.S.  
 CHECKED BY:  
 PROJECT NUMBER:  
 2057.92  
 DRAWING FILE:  
 J:\205792\_BASE2.DWG  
**SHEET NO.**  
**7 OF 15**

**SIDEWALK & BRIDGE IMPROVEMENTS ~ 16+50 TO 21+37.48**