

ROUTE NO.	SECTION	COUNTY	TOTAL SHEETS	SHEET NO.
5370	*	DEKALB	35	30
F.A.A.I. 5370		ILLINOIS FED. AID PROJECT-		
FED. ROAD DIST. NO. 7		* Section 09-00175-00-SP Contract #87419		

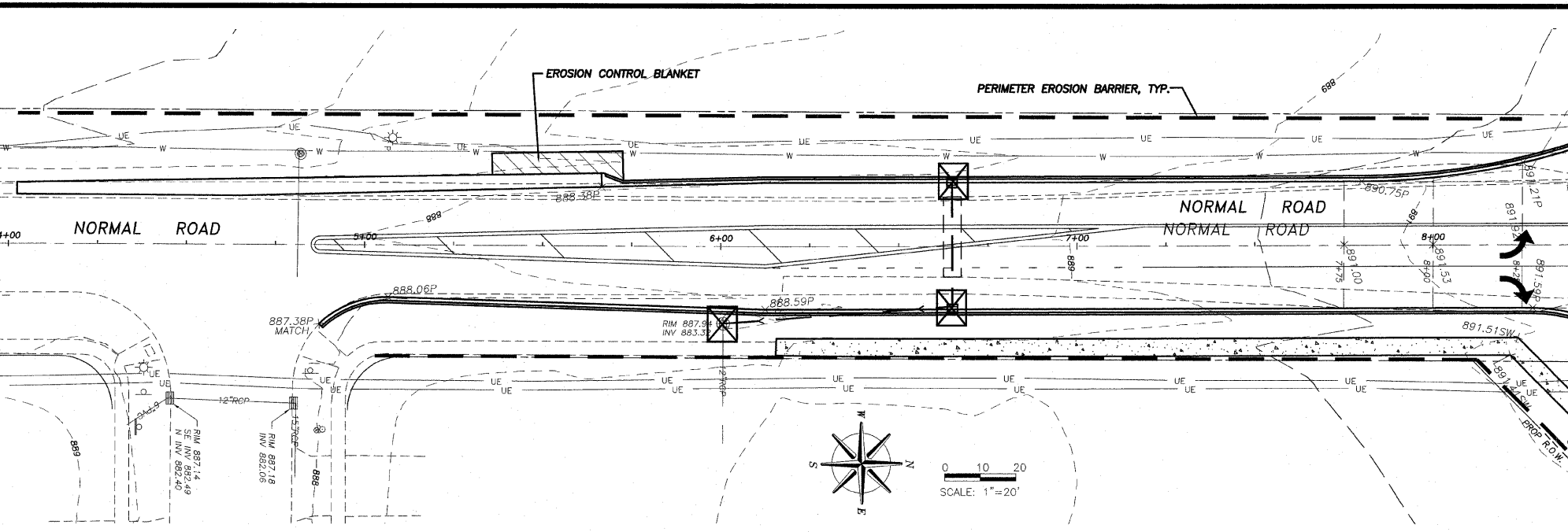
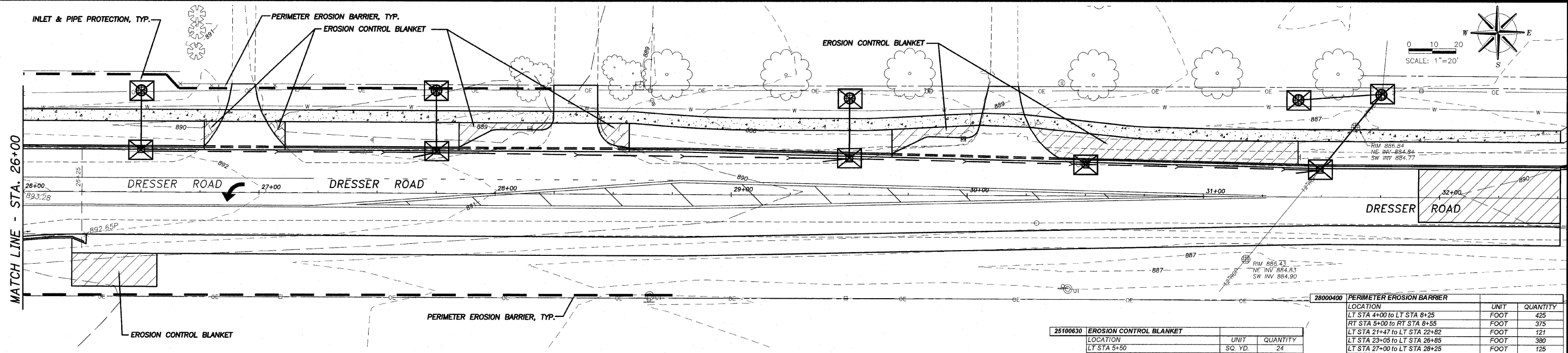

25100630	EROSION CONTROL BLANKET	UNIT	QUANTITY
LT STA 5+50	SQ. YD.	24	
STA 9+45	SQ. YD.	32	
LT STA 21+50	SQ. YD.	56	
RT STA 21+50	SQ. YD.	56	
LT STA 22+75	SQ. YD.	7	
LT STA 23+10	SQ. YD.	8	
RT STA 26+30	SQ. YD.	56	
LT STA 26+75	SQ. YD.	5	
LT STA 27+10	SQ. YD.	5	
LT STA 28+00	SQ. YD.	18	
LT STA 28+50	SQ. YD.	12	
LT STA 29+80	SQ. YD.	22	
LT STA 31+00	SQ. YD.	117	
TOTAL		418	

28000400	PERIMETER EROSION BARRIER	UNIT	QUANTITY
LT STA 4+00 to LT STA 8+25	FOOT	425	
RT STA 5+00 to RT STA 8+55	FOOT	375	
LT STA 21+47 to LT STA 22+82	FOOT	121	
LT STA 23+05 to LT STA 28+85	FOOT	380	
LT STA 27+00 to LT STA 28+25	FOOT	125	
RT STA 25+75 to RT STA 26+75	FOOT	300	
TOTAL		1726	

28000500	INLET AND PIPE PROTECTION	UNIT	QUANTITY
RT STA 6+00	EACH	1	
RT & LT STA 6+65	EACH	2	
RT STA 21+73	EACH	1	
RT STA 23+26	EACH	1	
LT STA 23+26	EACH	2	
LT STA 26+50	EACH	2	
LT STA 27+75	EACH	2	
LT STA 29+50	EACH	2	
LT STA 30+50	EACH	1	
LT STA 31+40	EACH	1	
LT STA 31+50	EACH	1	
LT STA 31+78	EACH	1	
TOTAL		17	

28000250	TEMPORARY EROSION CONTROL SEEDING	UNIT	QUANTITY
VARIOUS LOCATIONS	POUND	333	
TOTAL		333	

EROSION CONTROL PLAN

DRESSER & NORMAL ROADS
SECTION 09-00175-00-SP
CITY OF DEKALB



GROUND BREAKING SOLUTIONS
engineers - surveyors - scientists

www.wendlergs.com

Date:
10/22/09

Job:
2098003

ph: 815.288.2281