

**LEGEND**

- ☼-○-☼ PROPOSED ORNAMENTAL LIGHTING UNIT COMPLETE
- ☼-○-☼ EXISTING LIGHT
- EXISTING BURIED WIRING JUNCTION BOX
- EXISTING CATCH BASIN
- EXISTING UTILITY POLE
- EXISTING INLET
- EXISTING MANHOLE
- G EXISTING GAS
- W EXISTING WATER
- A B C DECORATIVE LIGHT TYPE A  
DECORATIVE LIGHT TYPE B  
DECORATIVE LIGHT TYPE C
- T EXISTING TELEPHONE
- E EXISTING ELECTRICAL
- G EXISTING GAS
- OE EXISTING OVERHEAD ELECTRICAL
- EXISTING R.O.W.
- - - EXISTING PIPE CULVERT
- - - EXISTING STORMSEWER
- - - EXISTING SANITARY SEWER

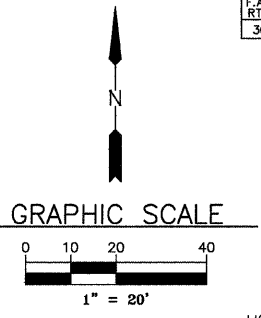

LIGHT NO. 14  
(EXISTING)  
STA. 125+96  
23' LT.

LIGHT NO. 15  
(PROPOSED)  
STA. 127+55  
24' LT.

LIGHTING CONTROL PANEL NO. 2  
CONTROLS LIGHTS 12-16, 17-21,  
49-53 AND 54-58

LIGHT NO. 16  
(EXISTING)  
STA. 129+13  
24' LT.

LIGHT NO. 17  
(EXISTING)  
STA. 130+71  
24' LT.

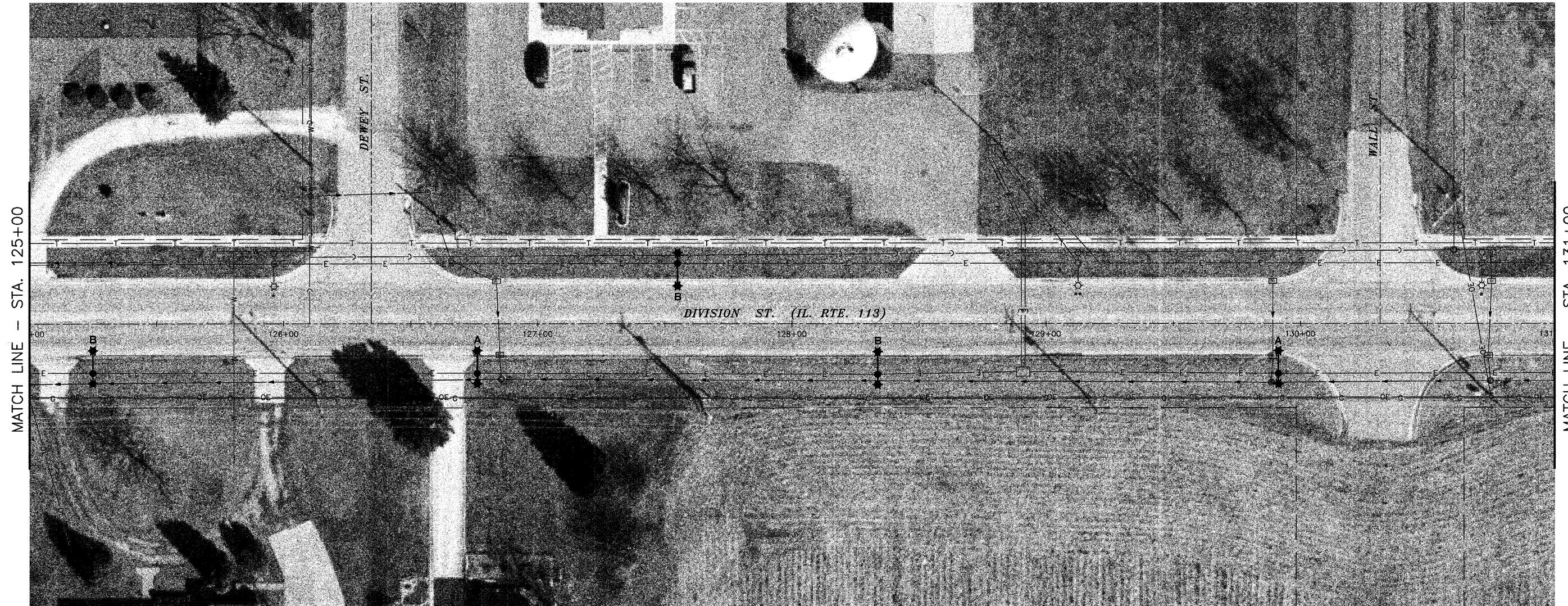

LIGHT NO. 51  
(PROPOSED)  
STA. 125+25  
19' RT.

LIGHT NO. 52  
(PROPOSED)  
STA. 126+76  
19' RT.

LIGHT NO. 53  
(PROPOSED)  
STA. 128+34  
20' RT.

LIGHT NO. 54  
(PROPOSED)  
STA. 129+91  
20' RT.

NOTE: AERIAL PHOTOGRAPHS SUPPLIED BY THE SIDWELL COMPANY

DRAWN BY: RGP/JMT	6978-00 CAD/DWG: P125-131 BASE	REVISIONS	
		DATE	BY
CHECKED BY: MWP/DJD	DATE: 09-24-09		

**CHAMLIN ASSOCIATES**  
PERU MORRIS ILLINOIS

**VILLAGE OF DIAMOND  
DIVISION STREET LIGHTING IMPROVEMENTS - 2010**

**PLAN SHEET - STA. 125+00 TO STA. 131+00**

SCALE: AS NOTED	SHEET 7
FILE NO.: 6978-00	OF 12