

LEGEND

- | | |
|---|--|
| <ul style="list-style-type: none"> ☼-○-☼ PROPOSED ORNAMENTAL LIGHTING UNIT COMPLETE ☼-○-☼ EXISTING LIGHT □ EXISTING BURIED WIRING JUNCTION BOX ○ EXISTING CATCH BASIN ○ EXISTING UTILITY POLE ○ EXISTING INLET ○ EXISTING MANHOLE G EXISTING GAS W EXISTING WATER A DECORATIVE LIGHT TYPE A B DECORATIVE LIGHT TYPE B C DECORATIVE LIGHT TYPE C | <ul style="list-style-type: none"> T EXISTING TELEPHONE E EXISTING ELECTRICAL G EXISTING GAS OE EXISTING OVERHEAD ELECTRICAL — EXISTING R.O.W. — EXISTING PIPE CULVERT — EXISTING STORMSEWER — EXISTING SANITARY SEWER |
|---|--|
- * REMOVAL OF LUMINAIRE, SALVAGE & LUMINAIRE, HIGH PRESSURE SODIUM SPECIAL (310 WATT)

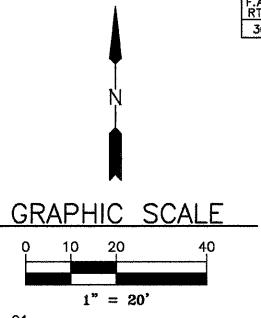

LIGHT NO. 18
(PROPOSED)
STA. 132+06
24' LT.

LIGHT NO. 19
(PROPOSED)
STA. 133+40
24' LT.

LIGHT NO. 20
(PROPOSED)
STA. 135+00
24' LT.

LIGHT NO. 21
(EXISTING)
STA. 136+03
23' LT.

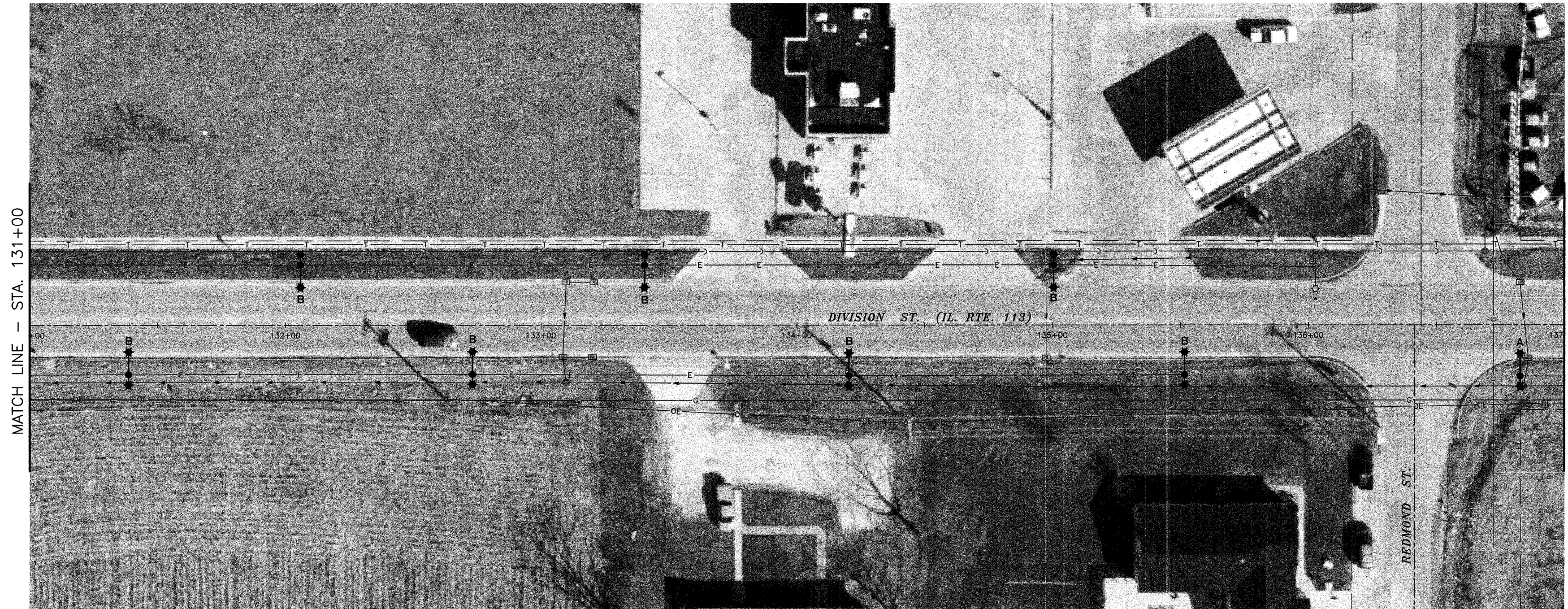

MATCH LINE - STA. 131+00

MATCH LINE - STA. 137+00

LIGHT NO. 55
(PROPOSED)
STA. 131+39
19' RT.

LIGHT NO. 56
(PROPOSED)
STA. 132+73
19' RT.

LIGHT NO. 57
(PROPOSED)
STA. 134+20
20' RT.

LIGHT NO. 58
(PROPOSED)
STA. 135+52
19' RT.

LIGHT NO. 59
(PROPOSED)
STA. 136+83
20' RT.

NOTE: AERIAL PHOTOGRAPHS SUPPLIED BY THE SIDWELL COMPANY

DRAWN BY: RGP/JMT
CHECKED BY: MWP/DJD

6978-00
CAD/DWG: P131-137
BASE
DATE: 09-24-09

REVISIONS	
DATE	BY

CHAMLIN ASSOCIATES

PERU MORRIS
ILLINOIS

**VILLAGE OF DIAMOND
DIVISION STREET LIGHTING IMPROVEMENTS - 2010**

PLAN SHEET - STA. 131+00 TO STA. 137+00

SCALE: AS NOTED

SHEET 8

FILE NO.: 6978-00

OF 12