

F.A. RTE.	SECTION	COUNTY
301	09-0004-00-LT	GRUNDY
CONTRACT NO. 87442		

LEGEND

- ☼-○-☼ PROPOSED ORNAMENTAL LIGHTING UNIT COMPLETE
- ☼ EXISTING LIGHT
- EXISTING BURIED WIRING JUNCTION BOX
- EXISTING CATCH BASIN
- EXISTING UTILITY POLE
- EXISTING INLET
- EXISTING MANHOLE
- G EXISTING GAS
- W EXISTING WATER
- A DECORATIVE LIGHT TYPE A
- B DECORATIVE LIGHT TYPE B
- C DECORATIVE LIGHT TYPE C
- T EXISTING TELEPHONE
- E EXISTING ELECTRICAL
- G EXISTING GAS
- OE EXISTING OVERHEAD ELECTRICAL
- EXISTING R.O.W.
- EXISTING PIPE CULVERT
- EXISTING STORMSEWER
- EXISTING SANITARY SEWER

* REMOVAL OF LUMINAIRE, SALVAGE & LUMINAIRE, HIGH PRESSURE SODIUM SPECIAL (310 WATT)

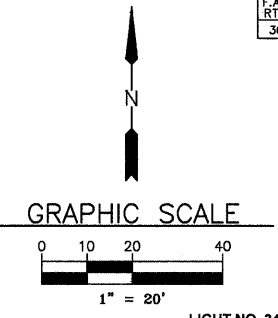

LIGHT NO. 30
(PROPOSED)
STA. 149+44
21' LT.

LIGHT NO. 31
(PROPOSED)
STA. 150+54
21' LT.

LIGHT NO. 32
(PROPOSED)
STA. 151+83
22' LT.

LIGHT NO. 33
(EXISTING)
STA. 153+08
21' LT.

LIGHT NO. 34
(PROPOSED)
STA. 154+53
21' LT.

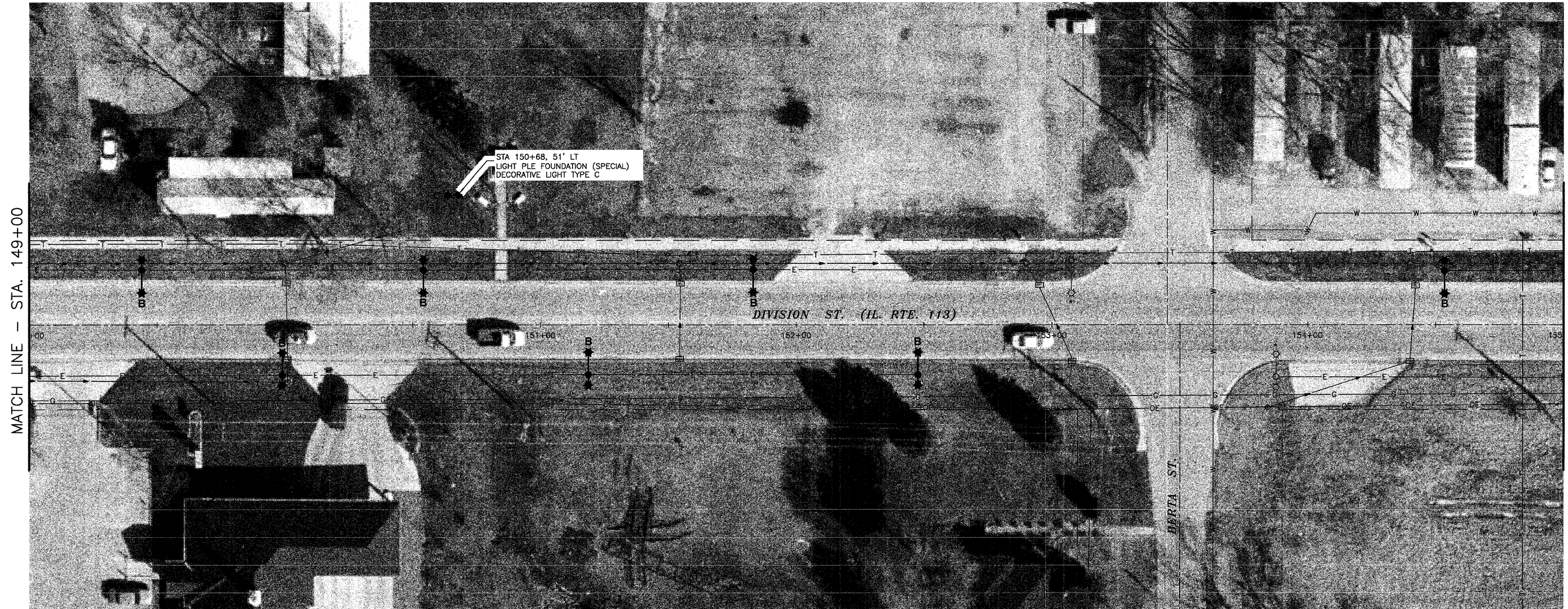

LIGHT NO. 68
(PROPOSED)
STA. 149+99
20' RT.

LIGHT NO. 69
(PROPOSED)
STA. 151+19
19' RT.

LIGHT NO. 70
(PROPOSED)
STA. 152+48
19' RT.

LIGHT NO. 71
(EXISTING)
STA. 153+88
20' RT.

NOTE: AERIAL PHOTOGRAPHS SUPPLIED BY THE SIDWELL COMPANY

DRAWN BY: RGP/JMT	6978-00 CAD/DWG: P149-155 BASE	REVISIONS	
		DATE	BY
CHECKED BY: MWP/DJD	DATE: 09-24-09		

CHAMLIN ASSOCIATES
PERU MORRIS ILLINOIS

**VILLAGE OF DIAMOND
DIVISION STREET LIGHTING IMPROVEMENTS - 2010**

PLAN SHEET - STA. 149+00 TO STA. 155+00

SCALE: AS NOTED	SHEET 11
FILE NO.: 6978-00	OF 12