

LEGEND

- | | |
|---|--|
| <ul style="list-style-type: none"> ☼-○-☼ PROPOSED ORNAMENTAL LIGHTING UNIT COMPLETE ☼ EXISTING LIGHT □ EXISTING BURIED WIRING JUNCTION BOX ○ EXISTING CATCH BASIN ○ EXISTING UTILITY POLE ○ EXISTING INLET ○ EXISTING MANHOLE ○ EXISTING GAS ○ EXISTING WATER — A — DECORATIVE LIGHT TYPE A — B — DECORATIVE LIGHT TYPE B — C — DECORATIVE LIGHT TYPE C | <ul style="list-style-type: none"> — T — EXISTING TELEPHONE — E — EXISTING ELECTRICAL — G — EXISTING GAS — OE — EXISTING OVERHEAD ELECTRICAL — EXISTING R.O.W. — EXISTING PIPE CULVERT — EXISTING STORMSEWER — EXISTING SANITARY SEWER — 4-1/C NO. 4, 4-1/C NO. 8 IN 2" DIA. PVC IN TRENCH — 4-1/C NO. 4, 4-1/C NO. 8 IN 2" DIA. PVC INTERMEDIATE METAL PUSHED |
|---|--|

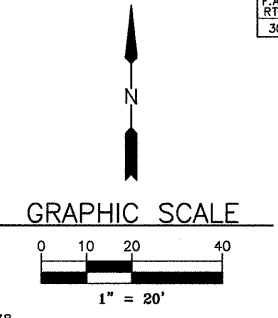

LIGHT NO. 35
(EXISTING)
STA. 155+85
21' LT.

LIGHT NO. 36
(PROPOSED)
STA. 157+20
21' LT.

LIGHT NO. 37
(PROPOSED)
STA. 158+60
21' LT.

LIGHT NO. 38
(EXISTING)
STA. 159+95
23' LT.

LIGHTING CONTROL PANEL NO. 4
CONTROLS LIGHTS 34-38 AND 71-76

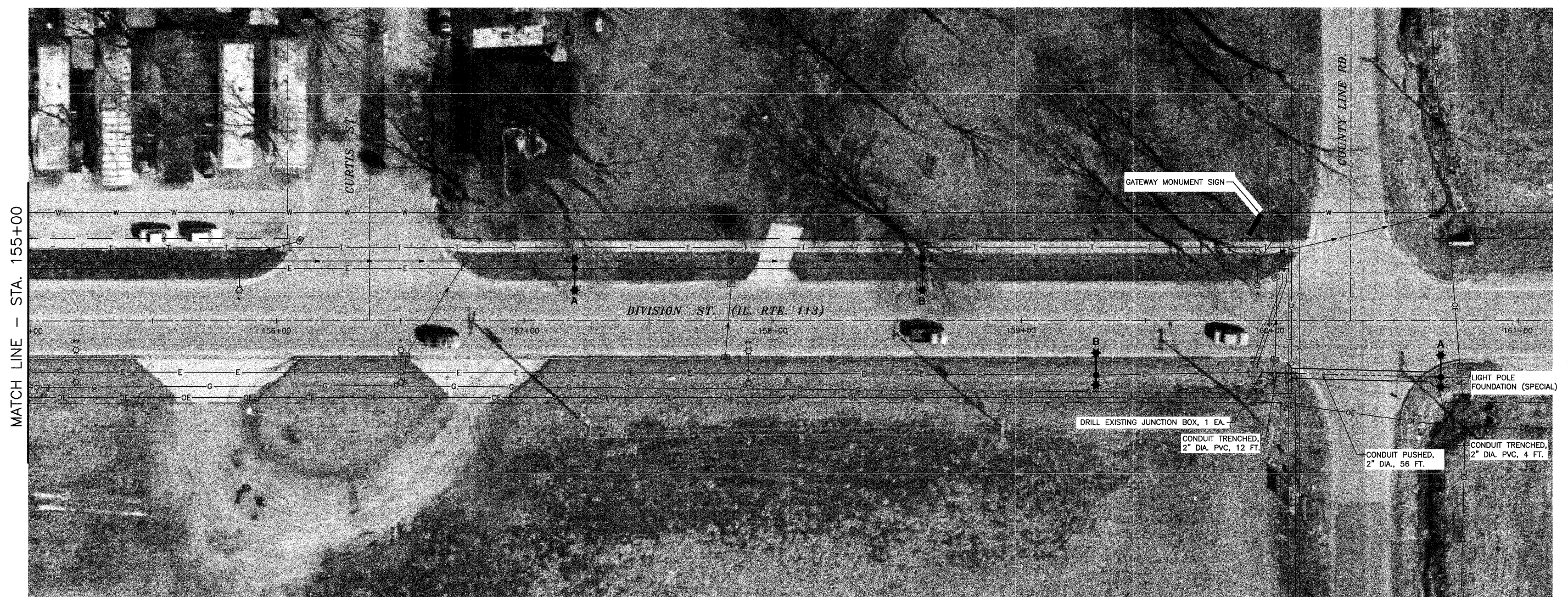

LIGHT NO. 72
(EXISTING)
STA. 155+19
21' RT.

LIGHT NO. 73
(EXISTING)
STA. 156+50
21' RT.

LIGHT NO. 74
(EXISTING)
STA. 157+90
21' RT.

LIGHT NO. 75
(PROPOSED)
STA. 159+30
22' RT.

LIGHT NO. 76
(PROPOSED)
STA. 160+69
23' RT.

NOTE: AERIAL PHOTOGRAPHS SUPPLIED BY THE SIDWELL COMPANY

DRAWN BY: RGP/JMT	#378-00 CAD/DWG: P155-161 BASE	REVISIONS			PERU MORRIS ILLINOIS	VILLAGE OF DIAMOND DIVISION STREET LIGHTING IMPROVEMENTS - 2010	PLAN SHEET - STA. 155+00 TO STA. 161+00	SCALE: AS NOTED	SHEET 12
		CHECKED BY: MWP/DJD	DATE: 09-24-09					FILE NO.: 6978-00	OF 12