

**LEGEND**

- S100 STORM STRUCTURE
- P100 STORM SEWER

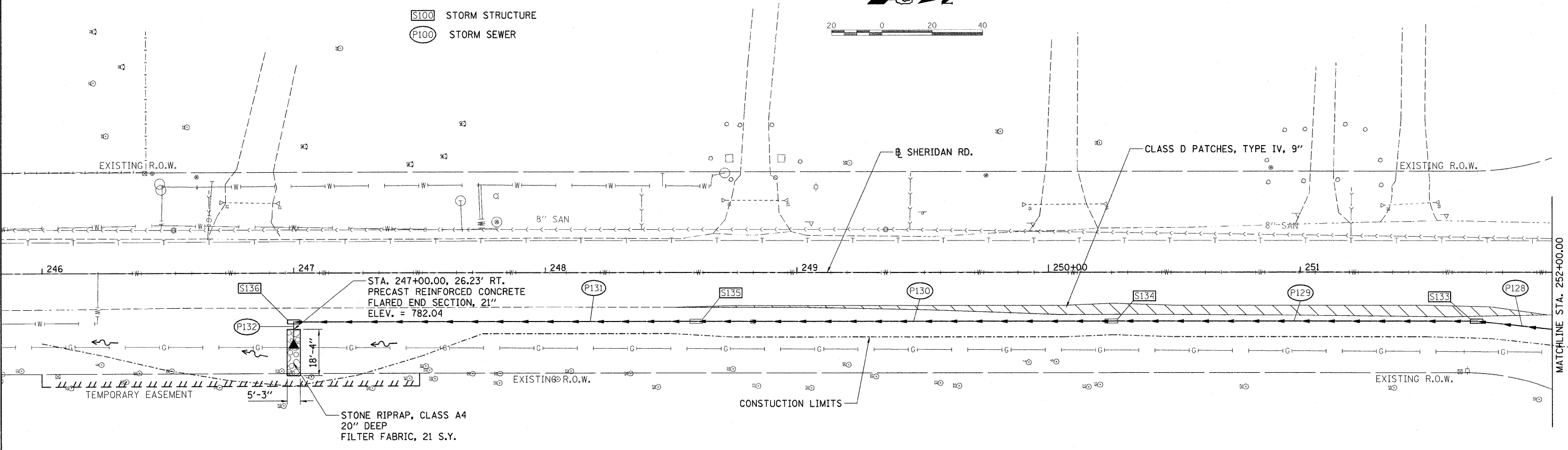
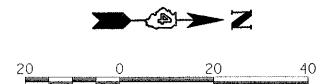

STRUCTURE NUMBER	STATION	OFFSET		TYPE	RIM ELEVATION	INVERT ELEVATIONS			
						N	S	E	W
S133	251+70.00	19.25	RT.	INLET-MANHOLE, TYPE G-1, 4' DIAMETER	795.93	783.27	783.17		
S134	250+25.00	19.25	RT.	INLET-MANHOLE, TYPE G-1, 4' DIAMETER	793.84	783.03		782.93	
S135	248+60.00	19.25	RT.	CATCH BASINS, TYPE G-1 (SEE SPECIAL PROVISION)	789.50	787.05	782.67		
S136	247+00.00	19.25	RT.	CATCH BASINS, TYPE G-1 (SEE SPECIAL PROVISION)	785.55	783.24	782.09		

PIPE NUMBER	FROM STRUCTURE	U/S INVERT	TO STRUCTURE	D/S INVERT	CLASS/TYPE	DIAMETER	LENGTH	SLOPE	TRENCH BACKFILL
P129	S133	783.17	S134	783.03	STORM SEWERS, TYPE 2, REINFORCED CONCRETE CULVERT, STORM DRAIN, AND SEWER PIPE, CLASS III	54	141.0	0.10%	359.6
P130	S134	782.93	S135	782.77	STORM SEWERS, TYPE 2, REINFORCED CONCRETE CULVERT, STORM DRAIN, AND SEWER PIPE, CLASS III	54	161.0	0.10%	309.1
P131	S135	782.67	S136	782.19	STORM SEWERS, TYPE 2, REINFORCED CONCRETE CULVERT, STORM DRAIN, AND SEWER PIPE, CLASS III	21	166.0	0.31%	161.1
P132	S136	782.09	OUTLET	782.04	STORM SEWERS, TYPE 2, REINFORCED CONCRETE CULVERT, STORM DRAIN, AND SEWER PIPE, CLASS III	21	4.5	1.11%	0.6

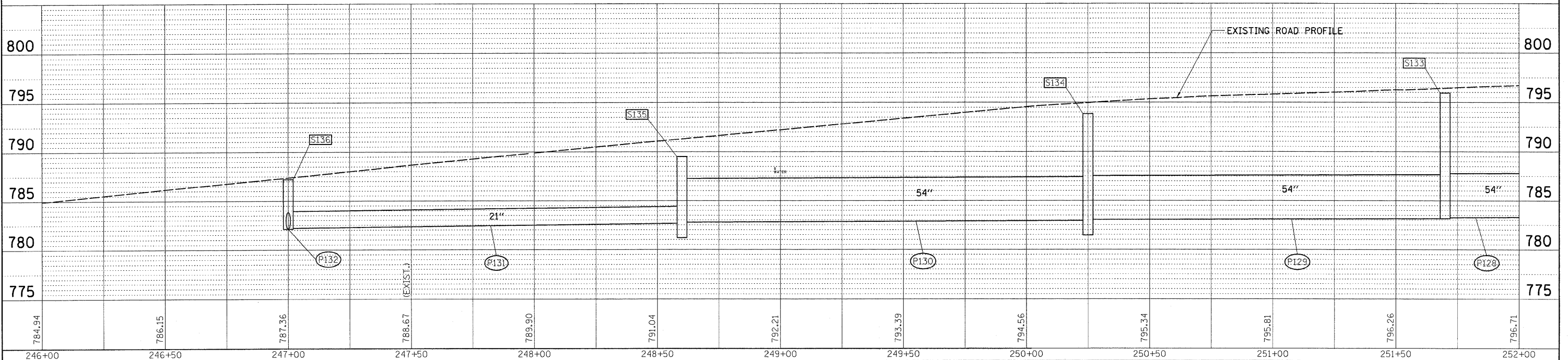

DATE: \_\_\_\_\_  
 BY: \_\_\_\_\_  
 SURVEYED: \_\_\_\_\_  
 PLOTTED: \_\_\_\_\_  
 ALIGNED: \_\_\_\_\_  
 CHECKED: \_\_\_\_\_  
 NOTE BOOK NO.: \_\_\_\_\_  
 CAD FILE NAME: \_\_\_\_\_

© Copyright Hanson Professional Services Inc. 2009  
**HANSON**  
 Hanson Professional Services Inc.

DATE: \_\_\_\_\_  
 BY: \_\_\_\_\_  
 PROFILE: \_\_\_\_\_  
 GRADES CHECKED: \_\_\_\_\_  
 PLOTTED: \_\_\_\_\_  
 NOTE BOOK NO.: \_\_\_\_\_  
 STRUCTURE NOTATIONS: \_\_\_\_\_