

ROUTE NO.	SECTION	CITY	TOTAL SHEETS	SHEET NO.
STEVENS CREEK BIKEWAY	99-P4000-00-BP	DECATUR PARK DIST	145	03
FED. ROAD DIST. NO.	ILLINOIS		PROJECT TE-00D7(27)	

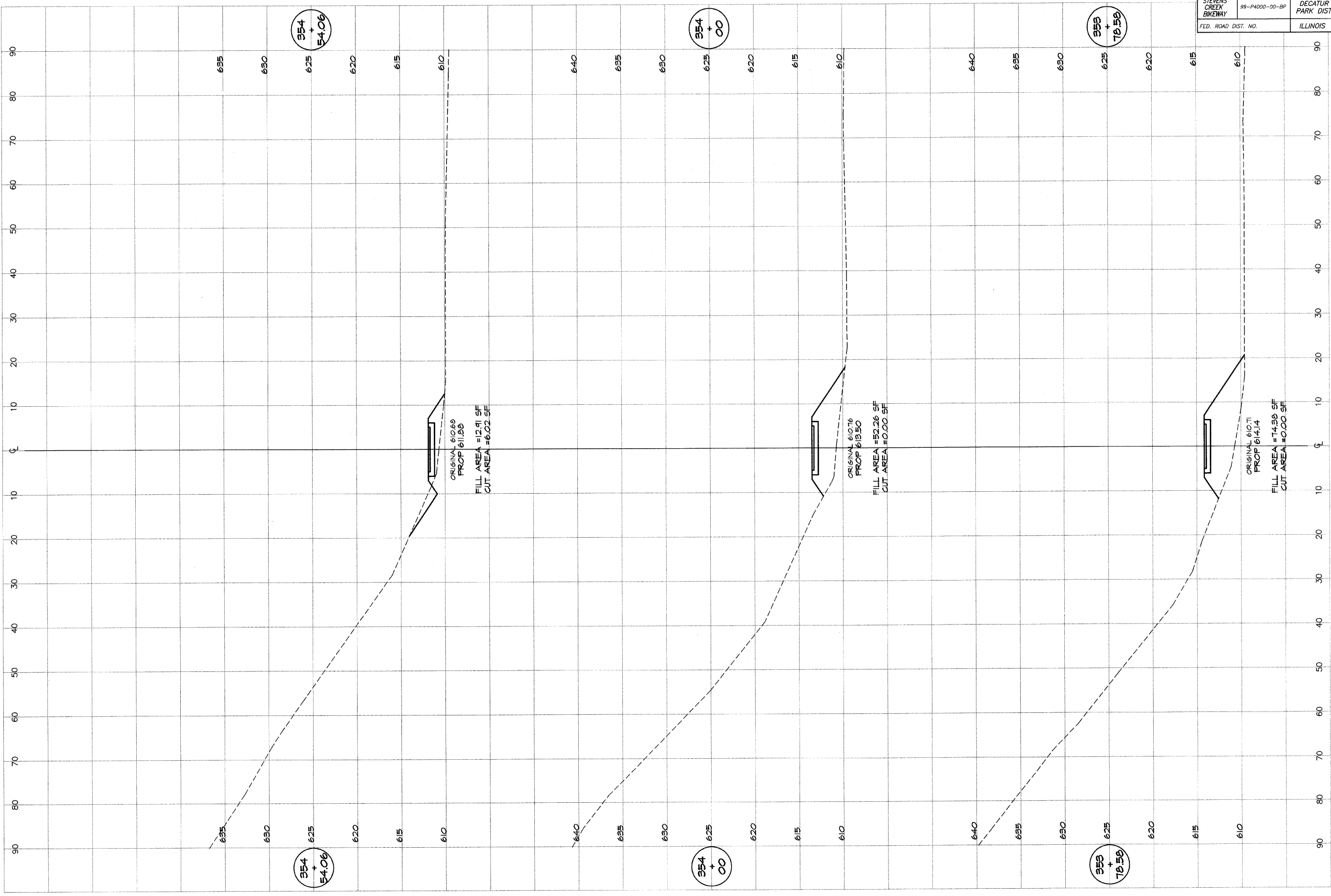

BARNARD & ASSOCIATES, INC.
G&B MILANSKI
 Consulting Engineers
 1870 SOUTH TAYLORVILLE ROAD
 DECATUR, ILLINOIS
 62526-1800

DESIGNED	SCALE	REVISIONS
MHP	as noted	NO. BY DATE
P. Mills	DATE	
FIELD BOOK	JAN 2004	
XXX	JOB NO. 99099	

DECATUR PARK DISTRICT
 STEVENS CREEK BIKEWAY - PHASE I
 CROSS SECTIONS
 CENTER TO SUMMIT