

| | | | | |
|-----------------------|----------------|-------------------|---------------------|-----------|
| ROUTE NO. | SECTION | CITY | TOTAL SHEETS | SHEET NO. |
| STEVENS CREEK BIKEWAY | 99-P4000-00-BP | DECATUR PARK DIST | 145 | 116 |
| FED. ROAD DIST. NO. | ILLINOIS | | PROJECT TE-0007(27) | |

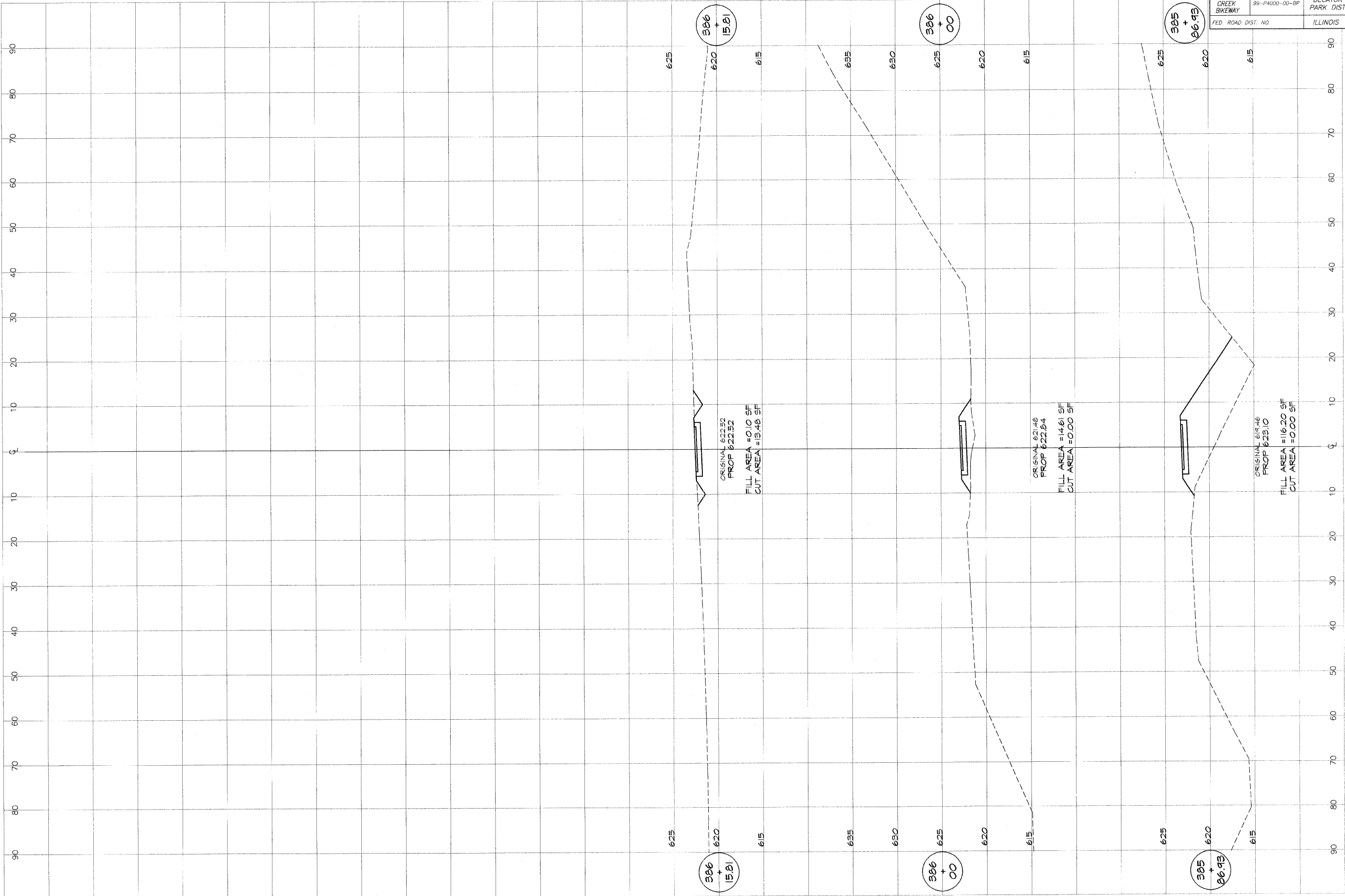

BATBRIDGE
GEB
MILANSKI
& ASSOCIATES, INC.
 Consulting Engineers

1970 SOUTH TAYLORVILLE ROAD
 DECATUR, ILLINOIS 62526

| REVISIONS | NO. | BY | DATE |
|-----------|-----|----|------|
| | | | |
| | | | |
| | | | |

| | | | |
|------------|----------|---------|----------|
| DESIGNED | MMP | SCALE | as noted |
| DRAWN | P. Mills | DATE | Jan 2004 |
| FIELD BOOK | | JOB NO. | 94099 |
| XXX | | | |

DECATUR PARK DISTRICT
 STEVENS CREEK BIKEWAY - PHASE I
 CROSS SECTIONS
 SUMMIT AVENUE ACCESS