

SECTION	08-00107-00-FP	TOTAL SHEETS	4
COUNTY	LAWRENCE	SHEET NO.	4
CONT. NO.	95605		
STA.	559+08	TO STA.	582+75

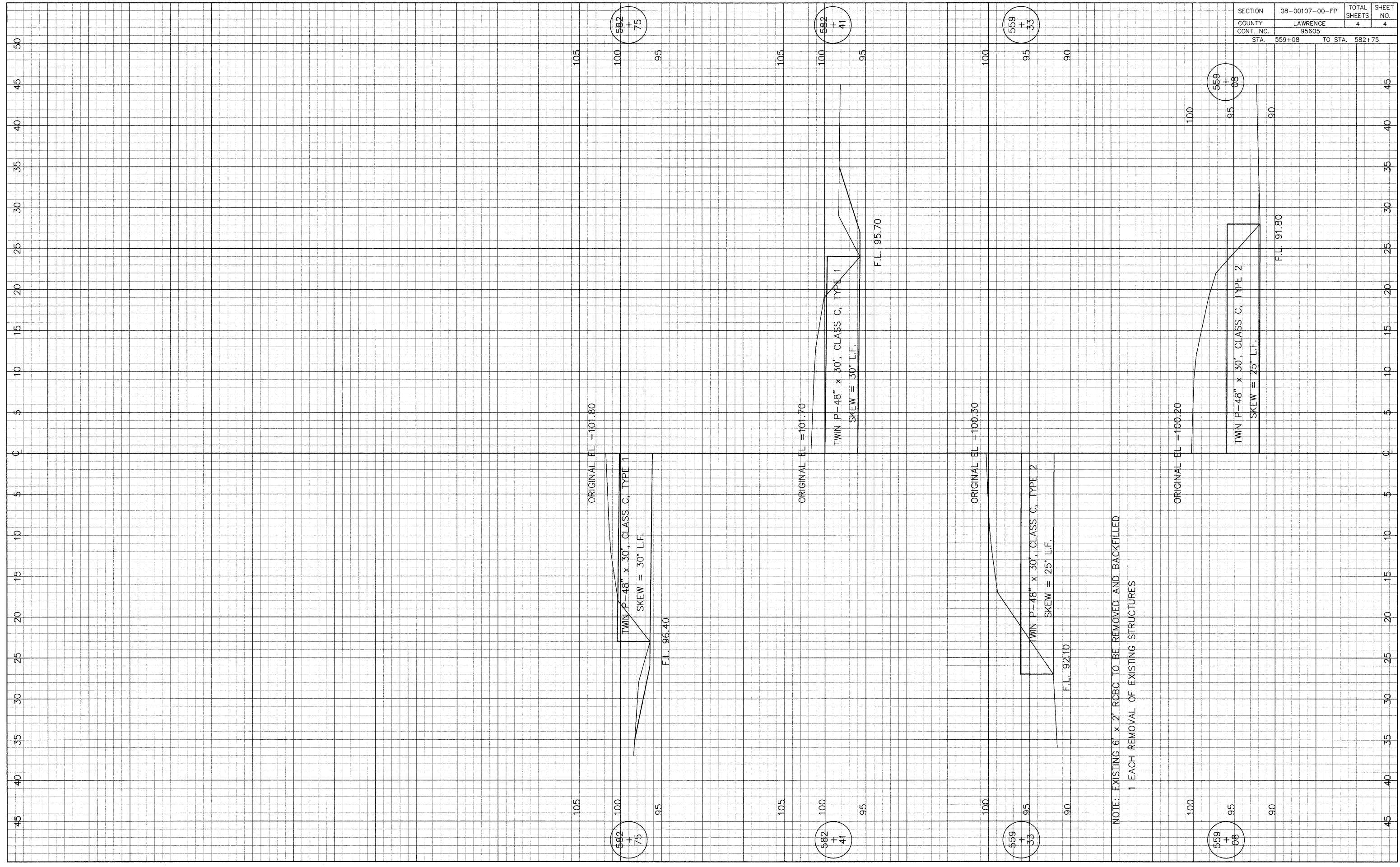

NOTE: EXISTING 6' x 2' RCBC TO BE REMOVED AND BACKFILLED
 1 EACH REMOVAL OF EXISTING STRUCTURES

582
+
75

582
+
41

559
+
33

559
+
08

582
+
75

582
+
41

559
+
33

559
+
08