

C.H.	SECTION	COUNTY	TOTAL SHEETS	SHEET NO.
4	07-00064-00-BR	EDWARDS	13	1
FED. ROAD DIST. NO. 7 ILLINOIS		FED. AID PROJECT		
PROJECT # ARA-047(032)		CONTRACT # 95606		
LEC JOB # H081009ED		BEAR CREEK		

323 W. 3RD ST.
P.O. BOX 160
MT. CARMEL, IL
62863
PHONE:
(618)-262-8651
FAX:
(618)-263-3327

405 W. STATE ST
SUITE 1
PRINCETON, IN
47670
PHONE:
(812)-386-7611
FAX:
(812)-385-2812



PROFESSIONAL DESIGN FIRM
LAND SURVEY &
PROFESSIONAL ENGINEERING CORPORATION
184-00087
(62-032435)(35-002769)

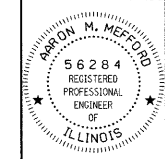

AARON M. MEFFORD
NAME
Aaron M. Mefford
SIGNATURE
DATE
10-26-09
11-30-11
EXPIRES

BEAR CREEK
COUNTY HIGHWAY 4
EDWARDS COUNTY, ILLINOIS

STATE OF ILLINOIS

DEPARTMENT OF TRANSPORTATION

PLANS FOR PROPOSED FEDERAL AID - A.R.R. PROJECT

C.H. 4 EDWARDS COUNTY SECTION 07-00064-00-BR

PROJECT NO. ARA-047(032) JOB NO. C-97-023-10

CONTRACT #95606 BEAR CREEK

INDEX OF SHEETS

SHEET NO.	DESCRIPTION
1	TITLE SHEET & SUMMARY OF QUANTITIES
2	PLAN & PROFILE, TYPICAL SECTIONS, GENERAL
3-4	NOTES & STONE RIPRAP DITCH DESIGN
5-13	ROADWAY CROSS SECTIONS BRIDGE DESIGN

STANDARDS

000001-05	STANDARD SYMBOLS, ABBREVIATIONS & PATTERNS (8 SHEETS)
280001-05	TEMPORARY EROSION CONTROL SYSTEMS (2 SHEETS)
515001-03	NAME PLATE FOR BRIDGES
666001-01	RIGHT OF WAY MARKERS
701901-01	TRAFFIC CONTROL DEVICES (3 SHEETS)
B.L.R. 21-8	TYPICAL APPLICATION OF TRAFFIC CONTROL DEVICES FOR CONSTRUCTION ON RURAL LOCAL HIGHWAYS
B.L.R. 22-6	TYPICAL APPLICATION OF TRAFFIC CONTROL DEVICES FOR CONSTRUCTION ON RURAL LOCAL HIGHWAYS (TWO-LANE TWO-WAY RURAL TRAFFIC) (ROAD CLOSED TO THRU TRAFFIC)

SUMMARY OF QUANTITIES

QUANTITY	UNIT	ITEM	CODE NO.
0.10	ACRE	TREE REMOVAL, ACRES	20100500
147.00	CU YD	EARTH EXCAVATION	20200100
95.00	CU YD	CHANNEL EXCAVATION	20300100
72.00	CU YD	FURNISHED EXCAVATION	20400800
0.20	ACRE	SEEDING, CLASS 2 (SPECIAL)	25001000
12.00	FEET	TEMPORARY DITCH CHECKS	28000305
18.00	TON	AGGREGATE (EROSION CONTROL)	28001000
650.00	TON	STONE DUMPED RIPRAP, CLASS A4	28100807
55.00	TON	STONE RIPRAP DITCH	28102600
270.00	TON	AGGREGATE SURFACE COURSE, TYPE B	40200800
1.00	EACH	REMOVAL OF EXISTING STRUCTURES	50100100
23.40	CU YD	CONCRETE STRUCTURES	50300225
2.80	CU YD	CONCRETE ENCASEMENT	50300280
1200.00	SQ FT	PRECAST PRESTRESSED CONCRETE DECK BEAMS (21" DEPTH)	50400405
2510.00	POUND	REINFORCEMENT BARS	50800105
97.00	FOOT	STEEL RAILING, TYPE S1	50900205 *
360.00	FOOT	FURNISHING STEEL PILES HP10X42	51201400
360.00	FOOT	DRIVING PILES	51202305
1.00	EACH	NAME PLATES	51500100
40.00	FOOT	PIPE CULVERTS, CLASS D, TYPE 1 15"	54200220
5.00	EACH	FURNISHING AND ERECTING RIGHT-OF-WAY MARKERS	66600105
1.00	L SUM	MOBILIZATION	67100100
1.00	L SUM	TRAFFIC CONTROL AND PROTECTION	70101700

* SPECIALTY ITEMS



DESIGN DESIGNATION:
DESIGN SPEED: 30 MPH
HIGHWAY CLASS - LOCAL ROAD
EXISTING STRUCTURE NO.: 024-3083
PROPOSED STRUCTURE NO.: 024-3137
CURRENT A.D.T. = 150
CONTRACT NO. 95606

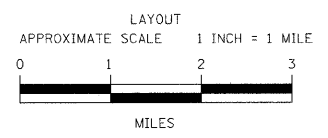
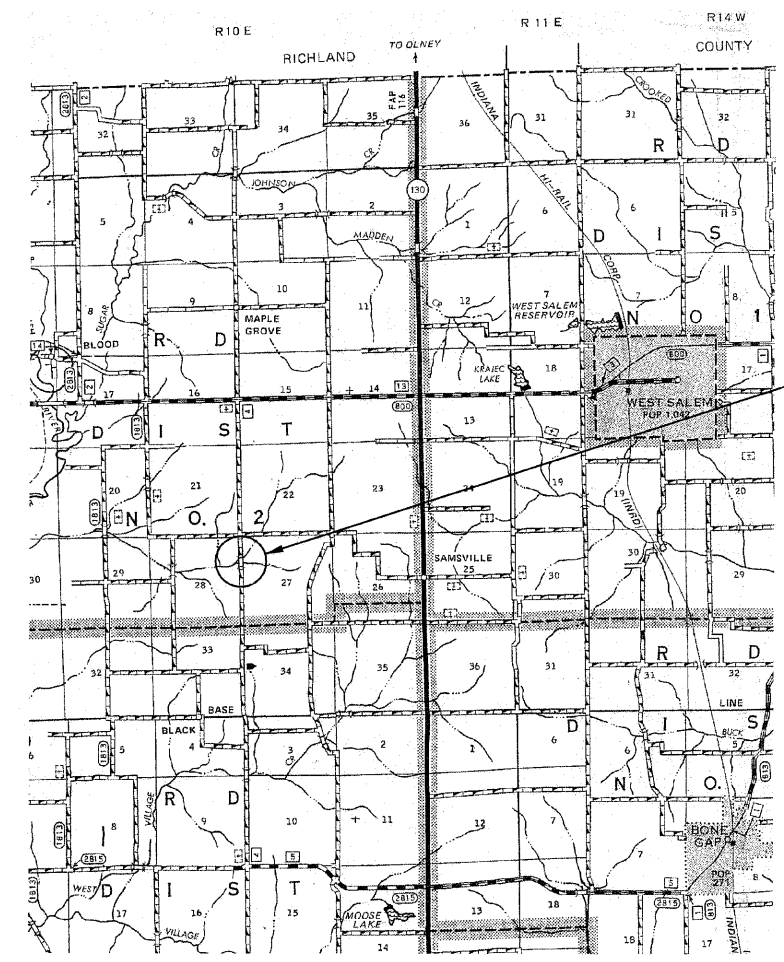

GROSS LENGTH	425.00 FT	0.080 MILES
OMISSIONS	0.00 FT	0.00 MILES
NET LENGTH	425.00 FT	0.080 MILES

PLAN	1" = 50'	
PROFILE	1" = 50'	
PROFILE VERT.	1" = 5'	

SECTION 07-00064-00-BR
BEGINS STATION 2+50

STATION 5+00, STRUCTURE NO. 024-3137
A 50' LONG SINGLE SPAN PRECAST
PRESTRESSED CONCRETE DECK BEAM BRIDGE
(21" DEPTH, 24" ROADWAY, 1.0% GRADE,
15° RT. FWD. SKEW.

SECTION 07-00064-00-BR
ENDS STATION 6+75

STATE OF ILLINOIS DEPARTMENT OF TRANSPORTATION	
APPROVED	<i>October 20th</i> 2009 <i>Dan K. Bl...</i> COUNTY ENGINEER
PASSED	<i>10/29</i> 2009 <i>Maureen E. Costl</i> DISTRICT SEVEN ENGINEER OF LOCAL ROADS & STREETS
Releasing For Bid Based on Limited Review	<i>10/29</i> 2009 <i>Roger L. Dushell</i> DEPUTY DIRECTOR OF HIGHWAYS, REGION FOUR ENGINEER

SHEET TITLE:	
TITLE SHEET	
SCALE:	VARIES
BY:	AMM
DATE:	10/29/09
REV:	
1	OF 13
SHEETS	
SHEET NO.	
1	