

P:\000184a\DWG\LATEST DWGS (BJG 11-06)\Sidewalk Plans\EROSION CONTROL PLAN.dwg 6/26/2009 2:17:13 PM CDT

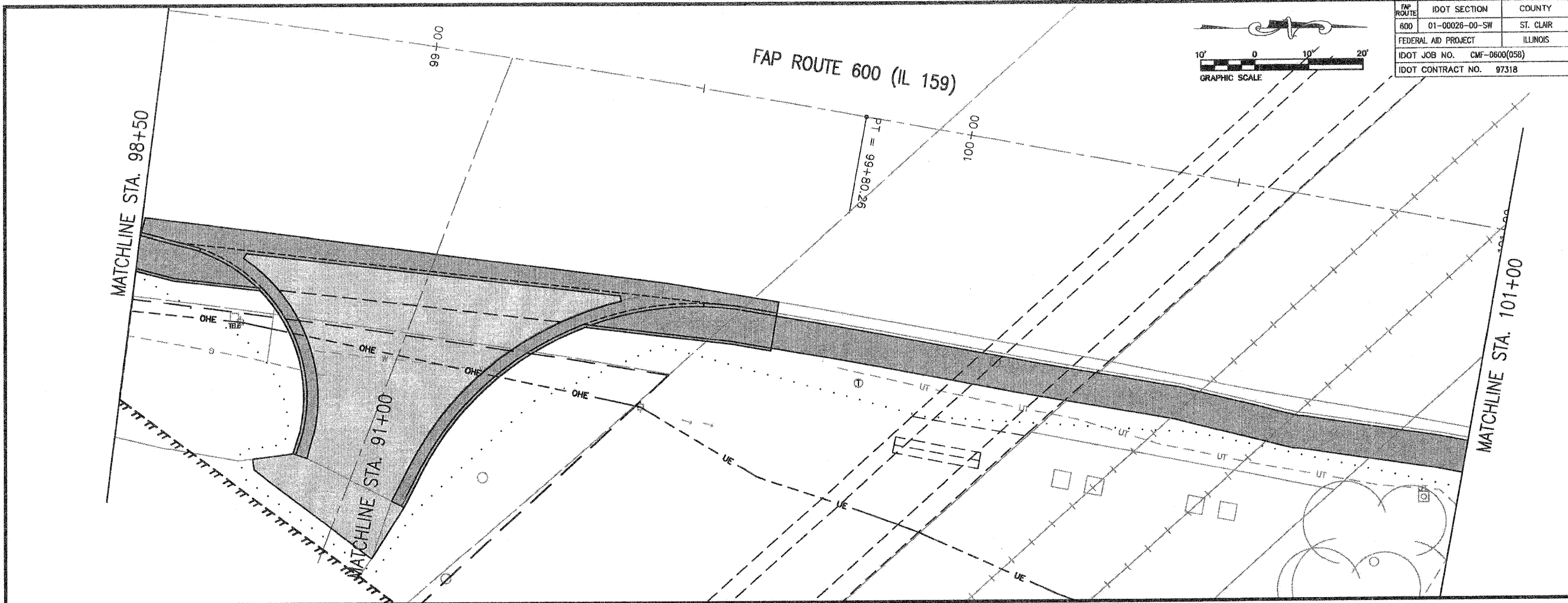

FAP ROUTE	IDOT SECTION	COUNTY
600	01-00026-00-SW	ST. CLAIR
FEDERAL AID PROJECT		ILLINOIS
IDOT JOB NO.	CMF-0600(058)	
IDOT CONTRACT NO.	97318	

**THOUVENOT, WADE & MOERCHEN, INC.**  
ENGINEERS ♦ SURVEYORS ♦ PLANNERS

- CORPORATE OFFICE**  
4940 OLD COLLINSVILLE RD.  
SWANSEA, ILLINOIS 62226  
TEL (618) 624-4488  
FAX (618) 624-6688  
corp@twm-inc.com
- CARBONDALE OFFICE**  
206 WEST COLLEGE STREET  
CARBONDALE, ILLINOIS 62901  
TEL (618) 549-8844  
FAX (618) 549-8450  
carbondale@twm-inc.com
- EDWARDSVILLE OFFICE**  
1015B CENTURY DRIVE  
EDWARDSVILLE, ILLINOIS 62025  
TEL (618) 656-4040  
FAX (618) 656-4343  
edwardsville@twm-inc.com
- ST. LOUIS OFFICE**  
1001 CRAIG ROAD, SUITE 260  
ST. LOUIS, MISSOURI 63146  
TEL (314) 236-5052  
FAX (314) 872-2194  
stlouis@twm-inc.com
- WATERLOO OFFICE**  
113 SOUTH MAIN STREET  
WATERLOO, ILLINOIS 62298  
TEL (618) 939-5050  
FAX (618) 939-3938  
waterloo@twm-inc.com

<b>PROFESSIONAL REGISTRATIONS:</b>	<b>LICENSE NO.</b>
ILLINOIS PROFESSIONAL DESIGN FIRM	184-001220
PROFESSIONAL ENGINEERING CORP.	62-005370
PROFESSIONAL STRUCTURAL ENGR. CORP.	81-000202
ILLINOIS PROF. LAND SURVEYING CORP.	048-000029
MISSOURI PROFESSIONAL ENGR. CORP.	HC 001528
MISSOURI LAND SURVEYING CORP.	HC 000346

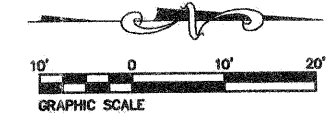
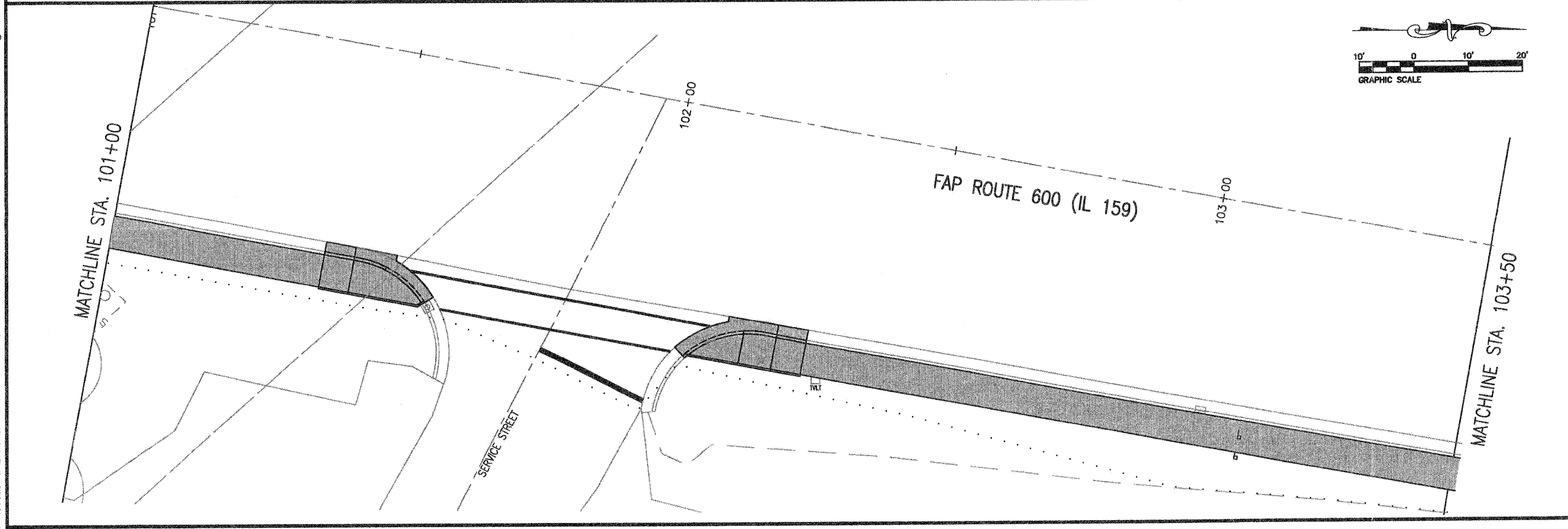

**EROSION CONTROL PLAN**

**PROJECT:**  
PEDESTRIAN SIDEWALKS  
ALONG ILLINOIS ROUTE 159  
VILLAGE OF SWANSEA  
ST. CLAIR COUNTY, ILLINOIS

REV	DATE	DESCRIPTION
△		
△		
△		

**PLAN STATUS:**  
**100%**  
**7/15/08**

ISSUED FOR REVIEW     ISSUED FOR BIDDING  
 ISSUED FOR CONTR.     RECORD DRAWING

DRAWN BY:	BJG	SHEET
DESIGNED BY:	BJG	<b>76</b>
CHECKED BY:	JWF	OF 83 SHEETS
APPROVED BY:	BJG	PROJECT DESCRIPTION
PROJECT NUMBER	T16000184A	SWANSEA SIDEWALKS