

STATE OF ILLINOIS
DEPARTMENT OF TRANSPORTATION
DIVISION OF HIGHWAYS

PLANS FOR PROPOSED
LOCAL AGENCY PROJECT

FAU 9167 (UNION HILL ROAD)
SECTION 09-00038-00-RS
PROJECT NO. ARA-5011 (296)
CITY OF FAIRVIEW HEIGHTS, ILLINOIS
ST. CLAIR COUNTY
JOB NO. C-98-372-09
ARRA RESURFACING

F.A.U. ROUTE	SECTION	COUNTY	TOTAL SHEETS	SHEET NUMBER
9167	09-00038-00-RS	ST. CLAIR	5	1
FEDERAL AID PROJECT			CONTRACT 97406	



APPLICABLE IDOT
HIGHWAY STANDARDS

- 424001-05
- 606001-04
- 701501-05
- 701901-01
- 780001-02

INDEX OF SHEETS

1. COVER SHEET
2. SUMMARY OF QUANTITIES, GENERAL NOTES & SCHEDULES
3. TYPICAL SECTIONS & MISCELLANEOUS DETAIL
4. PLAN VIEW
5. PAVEMENT MARKING PLAN

SCALES



ROADWAY DESIGNATION: URBAN LOCAL COLLECTORS
FAU 9167 (UNION HILL ROAD) ADT (2009) 10,200

WATER O'FALLON WATER COMPANY 255 SOUTH LINCOLN AVENUE O'FALLON, ILLINOIS 62269 1-618-624-4500	CABLE CHARTER COMMUNICATIONS 7645 MAGNA DRIVE BELLEVILLE, ILLINOIS 62223 1-618-277-0760	SEWER CASEVILLE TOWNSHIP SEWER 1 ECOLOGY DRIVE O'FALLON, ILLINOIS 62269 1-618-632-2414
GAS & ELECTRIC ILLINOIS POWER COMPANY 1050 WEST BOULEVARD P.O. BOX 428 BELLEVILLE, ILLINOIS 62221 1-618-755-6271 1-800-755-5000	TELEPHONE AT&T 203 CECHE COLLINSVILLE, ILLINOIS 62234 1-618-373-6494	

HOLD IT! CALL BEFORE YOU DIG!
Phone J.U.L.I.E.

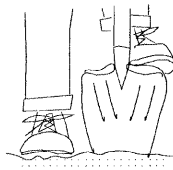

The owner would like to remind you that underground utility facilities can be damaged by shovel blades or other digging equipment. You can prevent damage or possible personal danger by phoning 800/892-0123 at least 48 hours before you dig. That's the toll-free number for "J.U.L.I.E.", which stands for Joint Utilities Location Information for Excavators.

If there are any pipes, cables, lines or mains in the excavation area, utility personnel will be out to mark the facilities so you can work around them.

Toll Free 800/892-0123

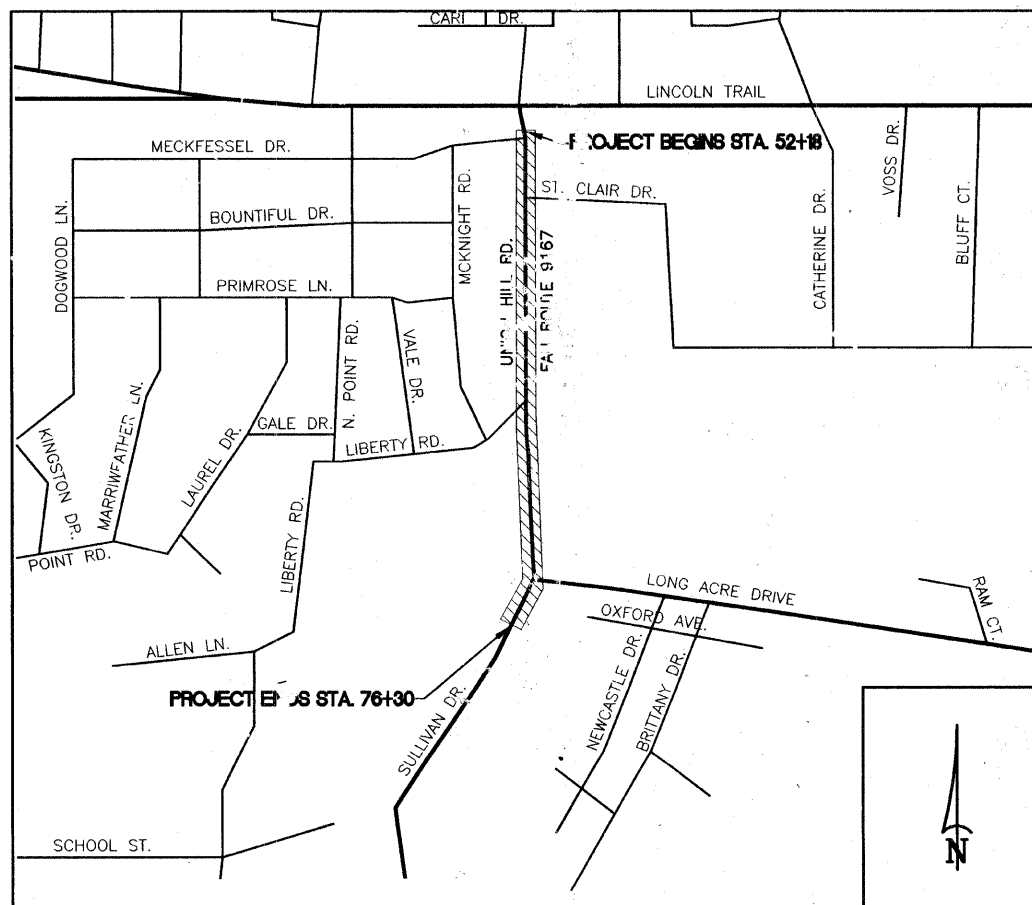

LOCATION MAP
NOT TO SCALE

LENGTH OF PROJECT

	GROSS / NET
UNION HILL ROAD = (Sta. 52+18 to Sta. 76+30)	2,412 FT. / 2,412 FT.
TOTAL GROSS LENGTH =	2,412 FT. = 0.45 MILES
TOTAL NET LENGTH =	2,412 FT. = 0.45 MILES

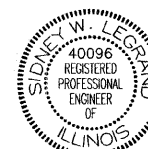

Sidney W. LeGrand
Date of Signing: 10/12/09
Date of License Expiration: 11/30/11

ILLINOIS DEPARTMENT OF TRANSPORTATION	
APPROVED	10-12-09 DATE
	<i>Gail Ann Stull</i> MAYOR, CITY OF FAIRVIEW HEIGHTS
PASSED	10-19-09 DATE
	<i>Frank...</i> DISTRICT EIGHT ENGINEER OF LOCAL ROADS & STREETS
RELEASING FOR BID BASED ON LIMITED REVIEW	10-19-09 DATE
	<i>Mary C. Ramirez</i> DEPUTY DIRECTOR OF HIGHWAYS, REGION FIVE ENGINEER

PREPARED BY:
RHUTASEL and ASSOCIATES, INC.
CONSULTING ENGINEERS • LAND SURVEYORS

CORPORATE OFFICE: 4 INDUSTRIAL DRIVE, FREEBURG, ILLINOIS 62243 (618) 539-3178
REGIONAL OFFICE: 201 SOUTH LOCUST STREET, CENTRALIA, ILLINOIS 62801 (618) 532-1992
ILL. LICENSE NO. 184-000287

SUMMARY OF QUANTITIES

CODE	PAY ITEM	UNIT	QUANTITY
40600100	BITUMINOUS MATERIALS (PRIME COAT)	GALLON	757
40600300	AGGREGATE (PRIME COAT)	TON	15
40600635	LEVELING BINDER (MACHINE METHOD), N70	TON	480
40600985	PORTLAND CEMENT CONCRETE SURFACE REMOVAL - BUTT JOINT	SQ YD	598
40603340	HOT-MIX ASPHALT SURFACE COURSE, MIX "D", N70	TON	1,148
40800050	INCIDENTAL HOT-MIX ASPHALT SURFACING	TON	84
42400100	PORTLAND CEMENT CONCRETE SIDEWALK, 4 INCH	SQ FT	448
42400800	DETECTABLE WARNINGS	SQ FT	32
44000500	COMBINATION CONCRETE CURB AND GUTTER REMOVAL	FOOT	2142
44000600	SIDEWALK REMOVAL	SQ FT	448
56109210	WATER VALVES TO BE ADJUSTED	EACH	6
60255500	MANHOLES TO BE ADJUSTED	EACH	4
60605400	COMBINATION CONCRETE CURB AND GUTTER, TYPE B-6.24 (SPECIAL)	FOOT	2142
67100100	MOBILIZATION	L SUM	1
70101700	TRAFFIC CONTROL AND PROTECTION	L SUM	1
70300100	SHORT-TERM PAVEMENT MARKING	FOOT	416
70301000	WORK ZONE PAVEMENT MARKING REMOVAL	SQ FT	139
70300220	TEMPORARY PAVEMENT MARKING - LINE 4"	FOOT	6,730
70300240	TEMPORARY PAVEMENT MARKING - LINE 6"	FOOT	300
70300280	TEMPORARY PAVEMENT MARKING - LINE 24"	FOOT	32
78000200	THERMOPLASTIC PAVEMENT MARKING - LINE 4"	FOOT	6,730
78000400	THERMOPLASTIC PAVEMENT MARKING - LINE 6"	FOOT	300
78000650	THERMOPLASTIC PAVEMENT MARKING - LINE 24"	FOOT	32
X0321020	PORTLAND CEMENT CONCRETE SURFACE REMOVAL (COLD MILLING) VARIABLE DEPTH	SQ YD	529
XX001484	ROOF DRAIN GUTTER OUTLET	EACH	5
X4421000	PARTIAL DEPTH PATCHING	TON	100
XX442027	PARTIAL DEPTH REMOVAL, 2.5"	SY	709

* SPECIALTY ITEM

PAVEMENT SCHEDULE

STATION	BITUMINOUS MATERIALS (PRIME COAT)	AGGREGATE (PRIME COAT)	HOT-MIX ASPHALT SURFACE COURSE, MIX "D", N70	LEVELING BINDER (MACHINE METHOD), N70	INCIDENTAL HOT-MIX ASPHALT SURFACING	PCC SURFACE REMOVAL (COLD MILLING) VARIABLE DEPTH
	GALLON	TON	TON	TON	TON	SQ YD
52+18 TO 76+30	757	15	1,148	480	84	529

ADJUSTMENT SCHEDULE

STATION	CENTERLINE OFFSET	LANE			WATER VALVES BE ADJUSTED	MANHOLES TO BE ADJUSTED	
		LEFT (NB)	CENTER (SB)	RIGHT (PARKING)			
					EACH	EACH	
52+77	14' RT.			X		1	
54+57	8' RT.		X			1	
54+77	22' LT.	X			1		
59+15	10' LT.	X			1		
63+93	8' LT.	X			1		
64+15	22' RT.			X		1	
72+40	8' LT.	X			1		
72+43	25' LT.	X			1		
72+46	15' LT.	X			1		
72+82	9' RT.		X			1	
TOTAL						6	4

PATCHING SCHEDULE

STATION	LANE			LENGTH	WIDTH	PAVEMENT PATCHING (PARTIAL DEPTH)
	LEFT (NB)	CENTER (SB)	RIGHT (PARKING)			
					FOOT	FOOT
52+49 to 52+55	X			6	12	8.0
52+49 to 52+55		X		6	12	8.0
52+49 to 52+55			X	6	8	5.3
52+98 to 53+04		X		6	12	8.0
52+98 to 53+04	X			6	12	8.0
53+17 to 53+23		X		6	12	8.0
53+48 to 53+54		X		6	12	8.0
53+60 to 53+66		X		6	12	8.0
54+09 to 54+15		X		6	12	8.0
54+86 to 55+02	X			16	12	21.3
54+88 to 55+02		X		14	12	18.7
55+44 to 55+50		X		6	12	8.0
55+96 to 56+02		X		6	12	8.0
56+08 to 56+14		X		6	12	8.0
56+66 to 56+72	X			6	12	8.0
57+46 to 57+52	X			6	6	4.0
57+46 to 57+52		X		6	12	8.0
57+58 to 57+64		X		6	12	8.0
58+43 to 58+51		X		8	6	5.3
59+45 to 59+51		X		6	12	8.0
60+07 to 60+11	X			4	4	1.8
61+44 to 61+50	X			6	12	8.0
61+44 to 61+50		X		6	12	8.0
61+93 to 61+99		X		6	12	8.0
61+93 to 61+99	X			6	12	8.0
62+05 to 62+11		X		6	12	8.0
62+43 to 62+49	X			6	12	8.0
62+43 to 62+49		X		6	12	8.0
63+43 to 63+49		X		6	12	8.0
63+55 to 63+61		X		6	12	8.0
63+84 to 63+92	X			8	4	3.5
63+92 to 63+98	X			6	12	8.0
63+92 to 63+98		X		6	12	8.0
64+14 to 64+20	X			6	12	8.0
64+42 to 64+48	X			6	12	8.0
64+42 to 64+48		X		6	12	8.0
64+91 to 64+97	X			6	12	8.0
65+41 to 65+47	X			6	12	8.0
67+91 to 67+97	X			6	12	8.0
68+41 to 68+47	X			6	12	8.0
68+53 to 68+59	X			6	4	3.6
69+41 to 69+47	X			6	12	8.0
69+91 to 69+97	X			6	12	8.0
69+91 to 69+97		X		6	12	8.0
70+03 to 70+09	X			6	12	8.0
70+51 to 70+57	X			6	12	8.0
70+90 to 70+96	X			6	12	8.0
71+40 to 71+46	X			6	12	8.0
71+55 to 71+66	X			11	12	14.7
71+88 to 71+96	X			8	12	10.7
71+88 to 71+96		X		8	12	10.7
72+02 to 72+10	X			8	12	10.7
72+02 to 72+10		X		8	12	10.7
72+30 to 72+40	X			10	2	2.2
72+40 to 72+46	X			6	12	8.0
72+40 to 72+46		X		6	12	8.0
72+52 to 72+58		X		6	12	8.0
72+54 to 72+84	X			30	12	40.0
73+15 to 73+26		X		11	12	14.7
73+26 to 73+51	X			25	12	33.3
73+46 to 73+52		X		6	12	8.0
73+56 to 73+62	X			6	12	8.0
73+56 to 73+62		X		6	12	8.0
73+90 to 73+96	X			6	12	8.0
74+01 to 74+07		X		6	12	8.0
74+40 to 74+6		X		6	12	8.0
74+52 to 74+58		X		6	12	8.0
74+90 to 74+96	X			6	12	8.0
74+90 to 74+96		X		6	12	8.0
75+01 to 75+07		X		6	12	8.0
75+44 to 75+50		X		6	12	8.0
75+51 to 75+57		X		6	12	8.0
75+87 to 75+93		X		6	12	8.0
75+99 to 76+30		X		31	12	41.3
TOTAL						708.5

F.A.U. ROUTE	SECTION	COUNTY	TOTAL SHEETS	SHEET NUMBER
9167	09-00038-00-RS	ST. CLAIR	5	2
FEDERAL AID PROJECT		CONTRACT 97406		

GENERAL NOTES

ALL CONSTRUCTION SHALL BE ACCORDING TO ILLINOIS DEPARTMENT OF TRANSPORTATION STANDARD SPECIFICATIONS FOR ROAD AND BRIDGE CONSTRUCTION, ADOPTED JANUARY 1, 2007.

EXISTING UTILITIES SHOWN ARE LOCATED FROM SURFACE OBSERVATIONS OR INFORMATION PROVIDED BY THE RESPECTIVE UTILITIES AND MUST BE CONSIDERED APPROXIMATE. THERE MAY BE OTHERS. THE EXACT LOCATION OF WHICH ARE UNKNOWN AND NOT SHOWN. THE CONTRACTOR WILL BE RESPONSIBLE FOR NOTIFYING THE RESPECTIVE UTILITIES BEFORE WORK IS BEGUN. FIELD MARKINGS OF UNDERGROUND UTILITIES MAY BE OBTAINED BY PROVIDING A MINIMUM OF 48 HOURS ADVANCE NOTICE THROUGH THE J.U.L.I.E. SYSTEM BY CALLING 1-800-892-0123 OR BY DIRECT CONTACT WITH NON-MEMBERS OF J.U.L.I.E.

THE THICKNESS OF THE HOT-MIX ASPHALT SHOWN ON THE PLANS IS THE NOMINAL THICKNESS. DEVIATIONS FROM THE NOMINAL THICKNESS WILL BE PERMITTED WHEN SUCH DEVIATIONS OCCUR DUE TO IRREGULARITIES IN THE EXISTING SURFACE ON WHICH THE HOT-MIX ASPHALT IS PLACED.

FACTORS USED FOR QUANTITY CALCULATIONS ARE AS FOLLOWS:

PAVING	
ALL HOT-MIX ASPHALT	0.056 TONS/SQ.YD./INCH
AGGREGATE (PRIME COAT)	0.0015 TONS/SQ.YD.
BITUMINOUS MATERIALS (PRIME COAT)	0.075 GAL./SQ.YD.

THE CONTRACTOR AND THE ENGINEER SHALL BE AWARE THAT ONLY SIMPLE SURVEY WAS PERFORMED FOR THIS PROJECT. THE STATIONING AND TOPO SHOWN IN THE PLANS WAS CREATED USING MEASUREMENTS MADE BY DESIGN PERSONNEL AND SHALL BE ASSUMED TO BE APPROXIMATE.

THE CONTRACTOR SHALL BE AWARE THAT THERE ARE MANHOLES AND VALVES LOCATED WITHIN THE RESURFACING LIMITS. CARE SHALL BE TAKEN IN THESE LOCATIONS TO ENSURE THESE ITEMS ARE NOT DAMAGED.

THE FOLLOWING MIXTURE REQUIREMENTS ARE APPLICABLE FOR THIS PROJECT:

MIXTURE USE(S)	SURFACE	LEVEL BINDER	INCIDENTAL
AC/PG	PG 64-22	PG 64-22	PG 64-22
RAP % (MAX.)	15%	25%	15%
DESIGN AIR VOIDS	4.0%@Ndes=70	4.0%@Ndes=70	4.0%@Ndes=70
MIX COMPOSITION (GRADATION MIXTURE)	IL-12.5	IL-9.5	IL-12.5
FRICITION AGG	MIXTURE D	MIXTURE B	MIXTURE D

WATER
O'FALLON WATER COMPANY
255 SOUTH LINCOLN AVENUE
O'FALLON, ILLINOIS 62269
1-618-624-4500

CABLE
CHARTER COMMUNICATIONS
7645 MAGNA DRIVE
BELLEVILLE, ILLINOIS 62223
1-618-277-0760

SEWER
CASEVILLE TOWNSHIP SEWER
1 ECOLOGY DRIVE
O'FALLON, ILLINOIS 62269
1-618-632-2414

GAS & ELECTRIC
ILLINOIS POWER COMPANY
1050 WEST BOULEVARD
P.O. BOX 428
BELLEVILLE, ILLINOIS 62221
1-618-236-6271
1-800-755-5000

TELEPHONE
AT&T
203 GOETHE
COLLINSVILLE, ILLINOIS 62234
1-618-346-6494

SIDEWALK REMOVAL & REPLACEMENT

LOCATION	PCC SIDEWALK, 4' SQ FT	
STA. 52+29.91 - 27.3' RT. TO 52+62.52 - 28.5' RT.	116	
STA. 53+12.62 - 29.0' RT. TO 53+29.06 - 28.7' RT.	54	
STA. 59+46.79 - 28.0' RT. TO 59+63.79 - 28.0' RT.	68	
STA. 59+94.57 - 28.0' RT. TO 60+06.92 - 28.0' RT.	42	
STA. 62+93.00 - 28.0' RT. TO 63+20.03 - 28.0' RT.	102	
STA. 64+02.58 - 28.0' RT. TO 64+17.28 - 28.0' RT.	33	
STA. 65+16.08 - 28.0' RT. TO 65+27.07 - 28.0' RT.	33	
TOTAL		448

F.A.U. ROUTE	SECTION	COUNTY	TOTAL SHEETS	SHEET NUMBER
9167	09-00038-00-RS	ST. CLAIR	5	3
FEDERAL AID PROJECT		CONTRACT 97406		

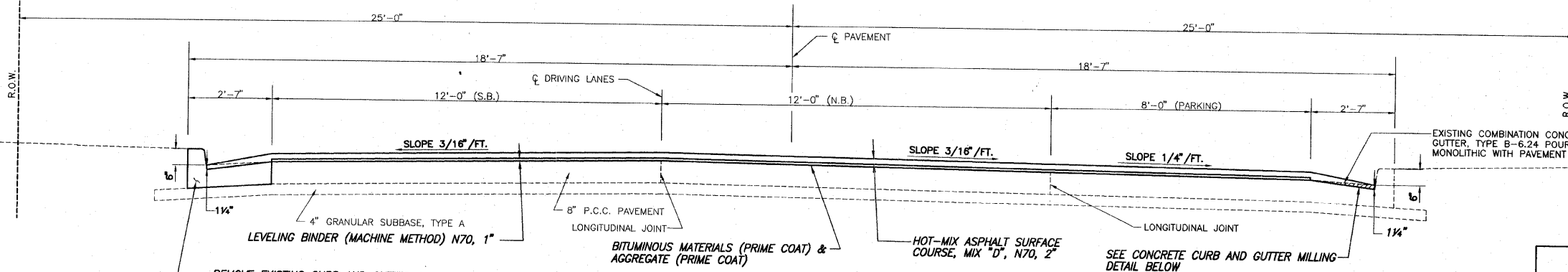

TYPICAL SECTION
(EXISTING & PROPOSED)
N.T.S.
STATION 52+18 TO 76+30

COMBINATION CONCRETE CURB & GUTTER REMOVAL & REPLACEMENT

LOCATION	CURB & GUTTER, TYPE B6.24 (FOOT)
STA. 52+18 - 12.0' LT. TO 52+48 - 12.0' LT.	30
STA. 52+18 - 20.0' RT. TO 52+48 - 20.0' RT.	30
STA. 52+54 - 21.3' RT. TO 52+66 - 29.1' RT.	14
STA. 52+60 - 12.0' LT. TO 53+04 - 12.0' LT.	44
STA. 53+10 - 28.5' RT. TO 53+30 - 20.0' RT.	14
STA. 53+10 - 12.0' LT. TO 53+54 - 12.0' LT.	44
STA. 53+60 - 12.0' LT. TO 54+04 - 12.0' LT.	44
STA. 53+60 - 20.0' RT. TO 53+90 - 20.0' RT.	30
STA. 54+09 - 12.0' LT. TO 54+19 - 12.0' LT.	10
STA. 54+34 - 20.0' RT. TO 54+49 - 20.0' RT.	15
STA. 54+96 - 12.0' LT. TO 55+06 - 12.0' LT.	10
STA. 55+08 - 12.0' LT. TO 55+50 - 12.0' LT.	42
STA. 55+08 - 20.0' RT. TO 55+63 - 20.0' RT.	55
STA. 55+56 - 12.0' LT. TO 55+70 - 12.0' LT.	14
STA. 55+72 - 12.0' LT. TO 56+02 - 12.0' LT.	30
STA. 56+08 - 12.0' LT. TO 56+52 - 12.0' LT.	44
STA. 56+08 - 20.0' RT. TO 56+52 - 20.0' RT.	44
STA. 56+58 - 12.0' LT. TO 57+02 - 12.0' LT.	44
STA. 56+87 - 20.0' RT. TO 57+02 - 20.0' RT.	15
STA. 57+08 - 12.0' LT. TO 57+52 - 12.0' LT.	44
STA. 57+08 - 20.0' RT. TO 57+52 - 20.0' RT.	44
STA. 57+58 - 12.0' LT. TO 58+02 - 12.0' LT.	44
STA. 58+08 - 12.0' LT. TO 58+52 - 12.0' LT.	44
STA. 58+31 - 20.0' RT. TO 58+52 - 20.0' RT.	21
STA. 58+57 - 12.0' LT. TO 59+01 - 12.0' LT.	44
STA. 58+57 - 20.0' RT. TO 58+87 - 20.0' RT.	30
STA. 58+99 - 20.0' RT. TO 59+11 - 20.0' RT.	12
STA. 59+08 - 12.0' LT. TO 59+52 - 12.0' LT.	44
STA. 59+52 - 12.0' LT. TO 60+01 - 12.0' LT.	44
STA. 60+06 - 12.0' LT. TO 60+50 - 12.0' LT.	44
STA. 60+56 - 12.0' LT. TO 61+00 - 12.0' LT.	44
STA. 60+56 - 20.0' RT. TO 60+66 - 20.0' RT.	10
STA. 61+06 - 12.0' LT. TO 61+50 - 12.0' LT.	44
STA. 61+06 - 20.0' RT. TO 61+27 - 20.0' RT.	21
STA. 61+56 - 12.0' LT. TO 61+99 - 12.0' LT.	44
STA. 61+56 - 20.0' RT. TO 61+99 - 20.0' RT.	44
STA. 62+05 - 12.0' LT. TO 62+49 - 12.0' LT.	44
STA. 62+55 - 12.0' LT. TO 62+85 - 12.0' LT.	30
STA. 62+55 - 20.0' RT. TO 62+85 - 20.0' RT.	30
STA. 63+28 - 12.0' LT. TO 63+49 - 12.0' LT.	21
STA. 63+28 - 20.0' RT. TO 63+49 - 20.0' RT.	21
STA. 63+54 - 12.0' LT. TO 63+98 - 12.0' LT.	44
STA. 63+90 - 20.0' RT. TO 64+00 - 20.0' RT.	10
STA. 64+01 - 22.1' RT. TO 64+19 - 28.4' RT.	18
STA. 64+04 - 12.0' LT. TO 64+48 - 12.0' LT.	44
STA. 64+54 - 12.0' LT. TO 64+98 - 12.0' LT.	44
STA. 65+14 - 28.9' RT. TO 65+23 - 22.1' RT.	12
STA. 65+03 - 12.0' LT. TO 65+47 - 12.0' LT.	44
STA. 65+53 - 12.0' LT. TO 65+97 - 12.0' LT.	44
STA. 66+04 - 12.0' LT. TO 66+48 - 12.0' LT.	44
STA. 66+53 - 12.0' LT. TO 66+97 - 12.0' LT.	44
STA. 67+03 - 12.0' LT. TO 67+47 - 12.0' LT.	44
STA. 67+53 - 12.0' LT. TO 67+97 - 12.0' LT.	44
STA. 68+03 - 12.0' LT. TO 68+47 - 12.0' LT.	44
STA. 68+13 - 12.0' LT. TO 68+97 - 12.0' LT.	44
STA. 69+03 - 12.0' LT. TO 69+47 - 12.0' LT.	44
STA. 69+53 - 12.0' LT. TO 69+97 - 12.0' LT.	44
STA. 70+03 - 12.0' LT. TO 70+96 - 12.0' LT.	93
STA. 71+02 - 12.0' LT. TO 71+46 - 12.0' LT.	44
STA. 71+52 - 12.0' LT. TO 71+96 - 12.0' LT.	44
STA. 72+02 - 12.0' LT. TO 72+10 - 12.0' LT.	8
TOTAL	2142

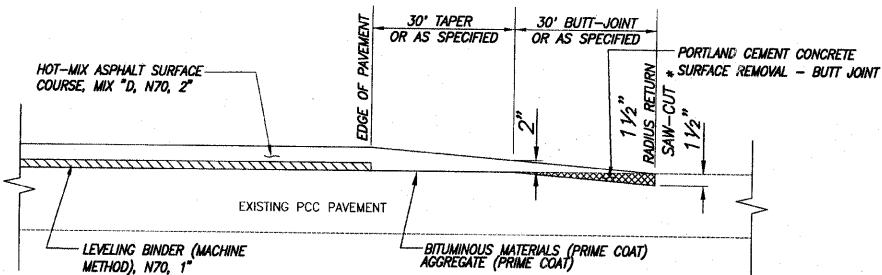

BUTT JOINT DETAIL
N.T.S.
LOCATED AT TERMINI OF PROJECT & LIBERTY RD, ST. CLAIR DR AND MECKFESSEL DR

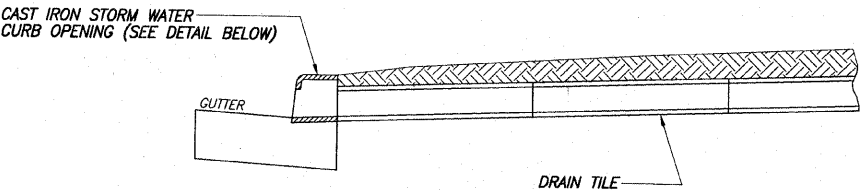

ROOF DRAIN GUTTER OUTLET DETAIL
N.T.S.

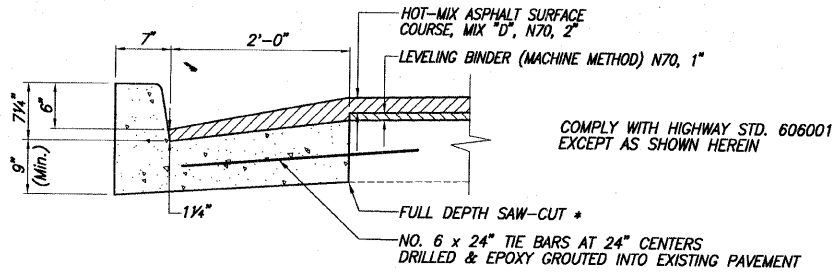

COMBINATION CONCRETE CURB & GUTTER, TYPE B-6.24 (SPECIAL)
N.T.S.
* SAW CUT TO BE CONSIDERED INCLUDED IN THE COST OF COMBINATION CONCRETE CURB & GUTTER, TYPE B-6.24 (SPECIAL)

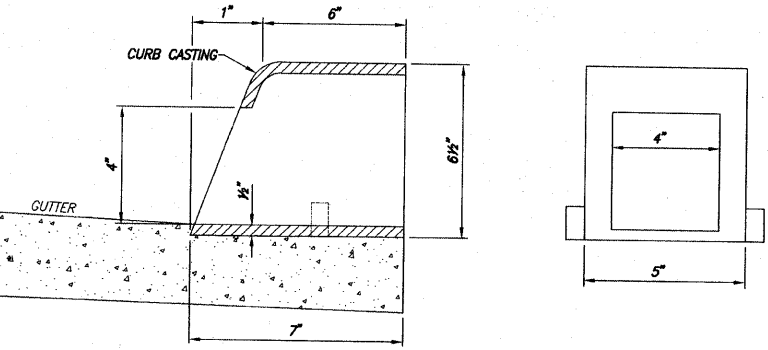

PAVEMENT MARKING SCHEDULE

ITEM	SHORT TERM PVMT. MARKING	WORK ZONE PVMT. MARKING REMOVAL	THERMOPLASTIC PVMT. MK LINE 4		THERMOPLASTIC PVMT. MK LINE 6	THERMOPLASTIC PVMT. MK LINE 24
			FOOT	FOOT	FOOT	FOOT
STA. 52+18 TO 72+20 @	360	120	---	4,004	---	---
STA. 73+02 TO 76+30 @	56	19	---	656	---	---
STA. 64+84 RT. (@ LIBERTY)	---	---	---	120	---	---
STA. 52+60 TO 53+15 RT.	---	---	---	---	95	---
STA. 64+05 TO 65+20 RT.	---	---	---	---	205	---
STA. 53+55 TO 63+60 RT.	---	---	1,021	---	---	---
STA. 65+95 TO 71+75 RT.	---	---	596	---	---	---
STA. 73+05 TO 76+30 RT.	---	---	333	---	---	---
STA. 72+20 @ - RT.	---	---	---	---	---	20
STA. 73+02 @ - LT.	---	---	---	---	---	12
TOTAL	416	139	1,950	4,780	300	32

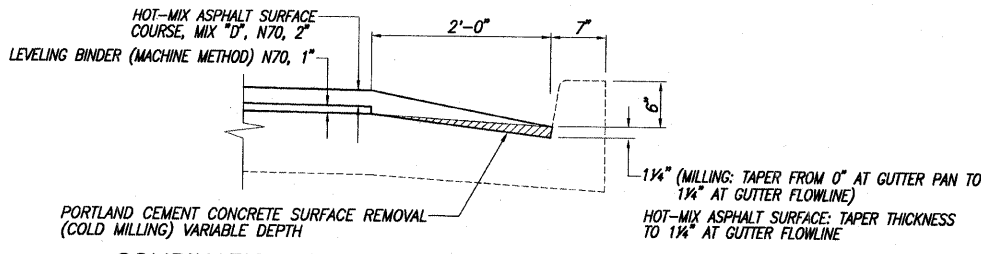

COMBINATION CONCRETE CURB & GUTTER MILLING DETAIL
N.T.S.

F.A.U. ROUTE	SECTION	COUNTY	TOTAL SHEETS	SHEET NUMBER
9167	09-00038-00-RS	ST. CLAIR	5	4
FEDERAL AID PROJECT		CONTRACT 97406		

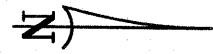
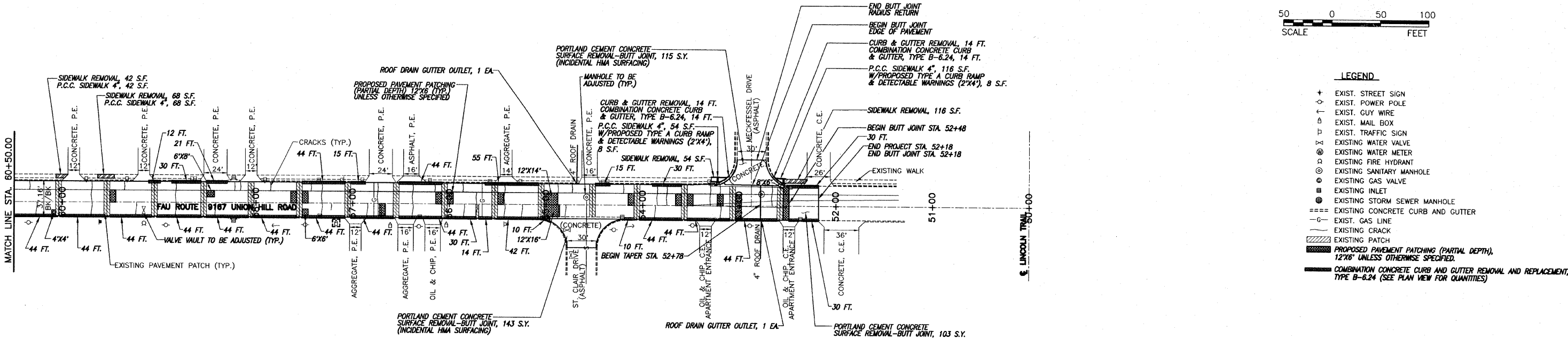
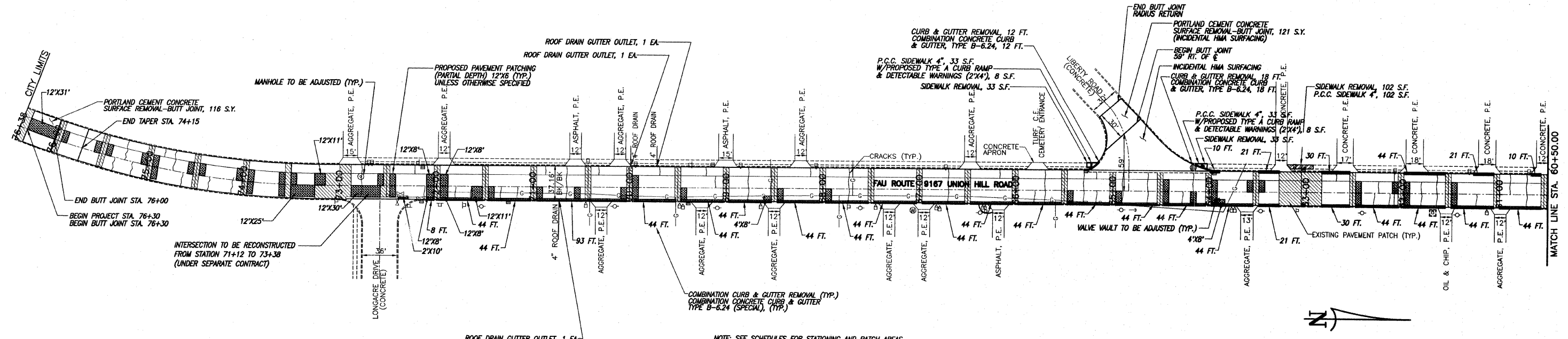

- LEGEND**
- + EXIST. STREET SIGN
 - o EXIST. POWER POLE
 - EXIST. GUY WIRE
 - EXIST. MAIL BOX
 - ⊕ EXIST. TRAFFIC SIGN
 - x EXISTING WATER VALVE
 - ⊙ EXISTING WATER METER
 - ⊕ EXISTING FIRE HYDRANT
 - ⊙ EXISTING SANITARY MANHOLE
 - ⊙ EXISTING GAS VALVE
 - ⊙ EXISTING INLET
 - ⊙ EXISTING STORM SEWER MANHOLE
 - === EXISTING CONCRETE CURB AND GUTTER
 - EXIST. GAS LINE
 - EXISTING CRACK
 - ▨ EXISTING PATCH
 - ▨ PROPOSED PAVEMENT PATCHING (PARTIAL DEPTH), 12'X6' UNLESS OTHERWISE SPECIFIED.
 - ▨ COMBINATION CONCRETE CURB AND GUTTER REMOVAL AND REPLACEMENT, TYPE B-6.24 (SEE PLAN VIEW FOR QUANTITIES)

NOTE: SEE SCHEDULES FOR STATIONING AND PATCH AREAS.

E:\10409 - Fairview Heights - Union Hill Road Resurfacing\dwg\103_04_Plan_View_TypSection.dwg, 10/9/2009 9:39:22 AM, Plotted by CAS.

F.A.U. ROUTE	SECTION	COUNTY	TOTAL SHEETS	SHEET NUMBER
9167	09-00038-00-RS	ST. CLAIR	5	5
FEDERAL AID PROJECT		CONTRACT 97406		

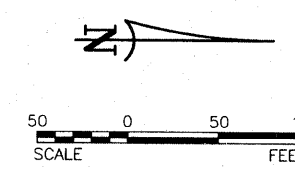
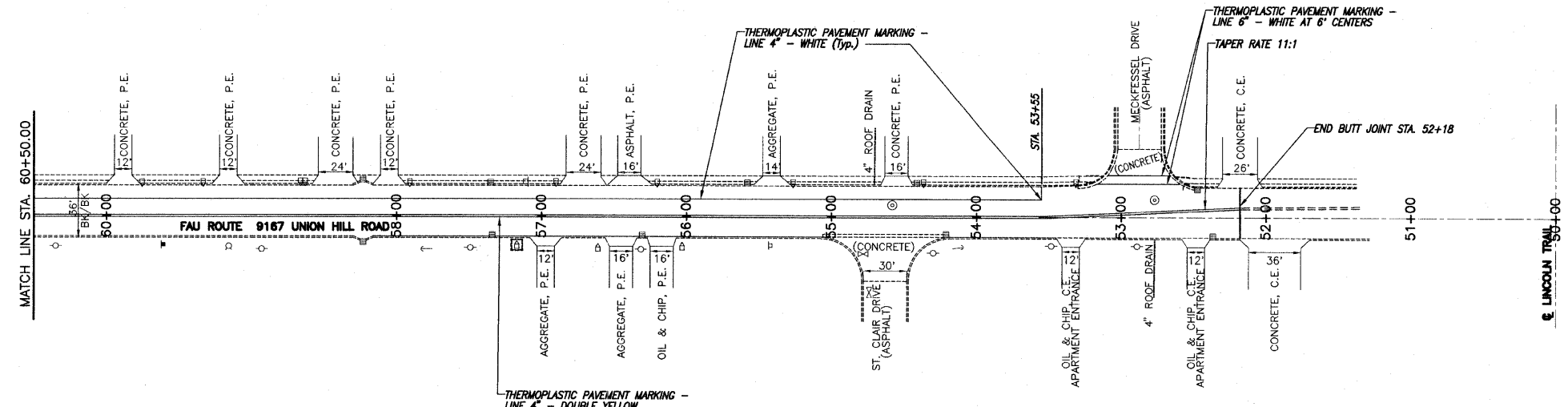
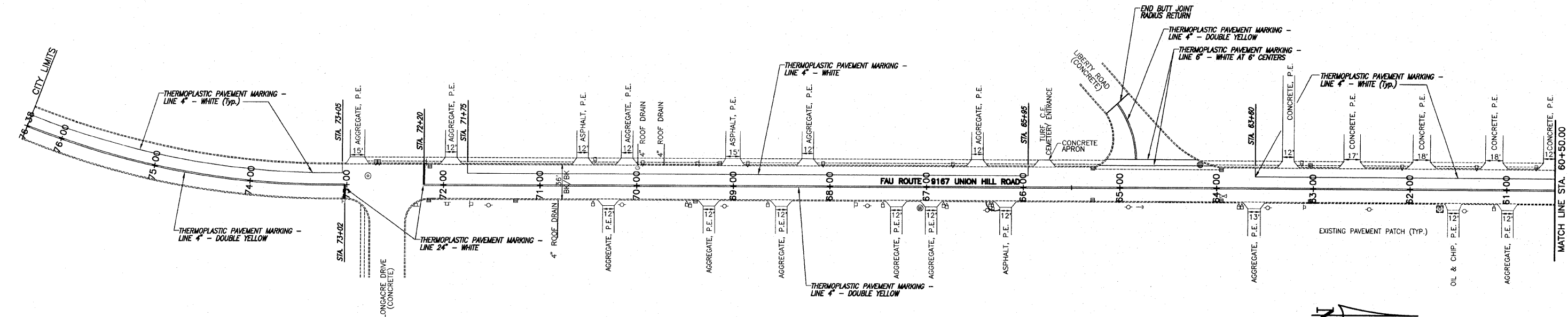

- LEGEND**
- + EXIST. STREET SIGN
 - EXIST. POWER POLE
 - ⊥ EXIST. GUY WIRE
 - ⊞ EXIST. MAIL BOX
 - ⊞ EXIST. TRAFFIC SIGN
 - ⊞ EXIST. WATER VALVE
 - ⊞ EXIST. WATER METER
 - ⊞ EXIST. FIRE HYDRANT
 - ⊞ EXIST. SANITARY MANHOLE
 - ⊞ EXIST. GAS VALVE
 - ⊞ EXIST. INLET
 - ⊞ EXIST. STORM SEWER MANHOLE
 - ==== EXISTING CONCRETE CURB AND GUTTER
 - EXIST. GAS LINE

E:\04\09 - Fairview Heights - Union Hill Road Resurfacing\dwg\05_PAVEMENT MARKING.dwg, 10/29/2009 9:45:38 AM, Plotted by C.A.S.