

SW RADIUS RETURN

PT. NO.	STATION	OFFSET	ELEVATION
1	17+20.30	16.22' LT	548.10 (EOP)
	17+20.30	18.73' LT	548.46 (BC)
2	17+27.02	16.22' LT	548.05 (EOP)
	17+27.02	18.77' LT	548.43 (BC)
3	17+32.02	16.22' LT	547.97 (EOP)
	17+32.02	18.80' LT	547.89 (BC)
	17+32.02	18.80' LT	547.89 (SW)
4	17+35.02	16.56' LT	547.94 (EOP)
	17+35.02	19.21' LT	547.86 (BC)
	17+35.02	19.21' LT	547.86 (SW)
5	17+41.07	19.16' LT	547.88 (EOP)
	17+39.60	21.28' LT	548.26 (BC)
6	17+44.43	22.27' LT	547.90 (EOP)
	17+42.44	23.89' LT	548.28 (BC)
7	17+47.56	28.27' LT	548.01 (EOP)
	17+44.86	28.27' LT	547.93 (BC)
	17+44.86	28.27' LT	547.93 (SW)
8	17+48.01	31.27' LT	548.06 (EOP)
	17+45.51	31.27' LT	547.98 (BC)
	17+45.51	31.27' LT	547.98 (SW)
9	17+48.16	36.21' LT	548.09 (EOP)
	17+45.58	36.41' LT	548.47 (BC)
10	17+48.33	39.69' LT	548.12 (EOP)
	17+45.74	39.74' LT	548.47 (BC)

SW RADIUS RETURN

PT. NO.	STATION	OFFSET	ELEVATION
11	17+41.74	39.83' LT	548.55 (SW)
12	17+41.70	37.81' LT	548.53 (SW)
13	17+39.56	31.28' LT	548.42 (SW)
14	17+39.56	28.28' LT	548.36 (SW)
15	17+39.79	26.93' LT	548.36 (SW)
16	17+36.87	24.21' LT	548.34 (SW)
17	17+35.02	25.21' LT	548.39 (SW)
18	17+32.02	25.21' LT	548.40 (SW)
19	17+24.74	22.76' LT	548.47 (SW)
20	17+20.28	22.73' LT	548.49 (SW)

NW RADIUS RETURN

PT. NO.	STATION	OFFSET	ELEVATION
1	17+80.58	30.27' LT	547.85 (EOP)
	17+83.08	31.00' LT	548.23 (BC)
2	17+81.80	26.22' LT	547.80 (EOP)
	17+84.16	27.26' LT	548.18 (BC)
3	17+88.02	18.89' LT	547.85 (EOP)
	17+89.43	21.05' LT	547.77 (BC)
	17+89.43	21.05' LT	547.77 (SW)
4	17+92.95	16.67' LT	547.93 (EOP)
	17+93.62	19.17' LT	547.85 (BC)
	17+93.62	19.17' LT	547.85 (SW)
5	18+00.85	16.07' LT	548.04 (EOP)
	18+00.85	18.65' LT	548.42 (BC)
6	18+00.88	23.65' LT	548.55 (SW)
			548.55 (TC)
7	17+94.91	23.98' LT	547.95 (SW)
			548.45 (TC)
8	17+92.54	25.00' LT	547.91 (SW)
			548.40 (TC)
9	17+89.61	25.00' LT	548.02 (SW)
10	17+89.61	27.72' LT	548.14 (SW)
11	17+88.94	28.87' LT	548.28 (SW)
			548.28 (TC)
12	17+88.05	32.69' LT	548.29 (SW)
13	17+86.48	31.96' LT	548.27 (SW)
14	17+87.49	28.14' LT	548.26 (SW)

NE RADIUS RETURN

PT. NO.	STATION	OFFSET	ELEVATION
1	17+25.67	15.78' RT	548.08 (EOP)
	17+25.67	18.36' RT	548.51 (BC)
2	17+31.67	15.78' RT	548.05 (EOP)
	17+31.67	18.36' RT	547.97 (BC)
	17+31.67	18.36' RT	547.97 (SW)
3	17+34.67	15.85' RT	548.04 (EOP)
	17+34.67	18.45' RT	547.98 (BC)
	17+34.67	18.45' RT	547.98 (SW)
4	17+42.47	19.40' RT	548.03 (EOP)
	17+40.71	21.28' RT	548.30 (BC)
5	17+46.57	27.09' RT	548.00 (EOP)
	17+44.04	27.51' RT	547.92 (BC)
	17+44.04	27.51' RT	547.92 (SW)
6	17+46.46	30.52' RT	547.99 (EOP)
	17+44.18	30.52' RT	547.91 (BC)
	17+44.18	30.52' RT	547.91 (SW)
7	17+46.73	35.94' RT	547.96 (EOP)
	17+44.19	35.94' RT	548.34 (BC)
	17+46.71	39.94' RT	547.96 (EOP)
	17+44.13	39.94' RT	548.34 (BC)
9	17+46.68	44.98' RT	547.98 (EOP)
	17+44.22	44.98' RT	548.36 (BC)
10	17+42.66	44.98' RT	548.38 (SW)
11	17+38.82	44.98' RT	548.53 (SW)
12	17+40.13	39.94' RT	548.40 (SW)
13	17+39.13	39.94' RT	548.42 (SW)
14	17+40.13	35.94' RT	548.42 (SW)
15	17+39.15	35.94' RT	548.43 (SW)
			548.43 (TC)
16	17+39.18	30.50' RT	548.14 (SW)
			548.48 (TC)
17	17+42.18	30.50' RT	548.08 (SW)
18	17+38.92	27.50' RT	548.15 (SW)
			548.51 (TC)

NE RADIUS RETURN

PT. NO.	STATION	OFFSET	ELEVATION
19	17+42.01	27.50' RT	548.09 (SW)
20	17+36.96	25.31' RT	548.39 (SW)
			548.52 (TC)
21	17+34.68	23.53' RT	548.21 (SW)
			548.54 (TC)
22	17+34.68	20.47' RT	548.15 (SW)
23	17+31.68	23.36' RT	548.20 (SW)
			548.55 (TC)
24	17+31.68	20.36' RT	548.14 (SW)
25	17+25.68	23.36' RT	548.56 (SW)
			548.56 (TC)

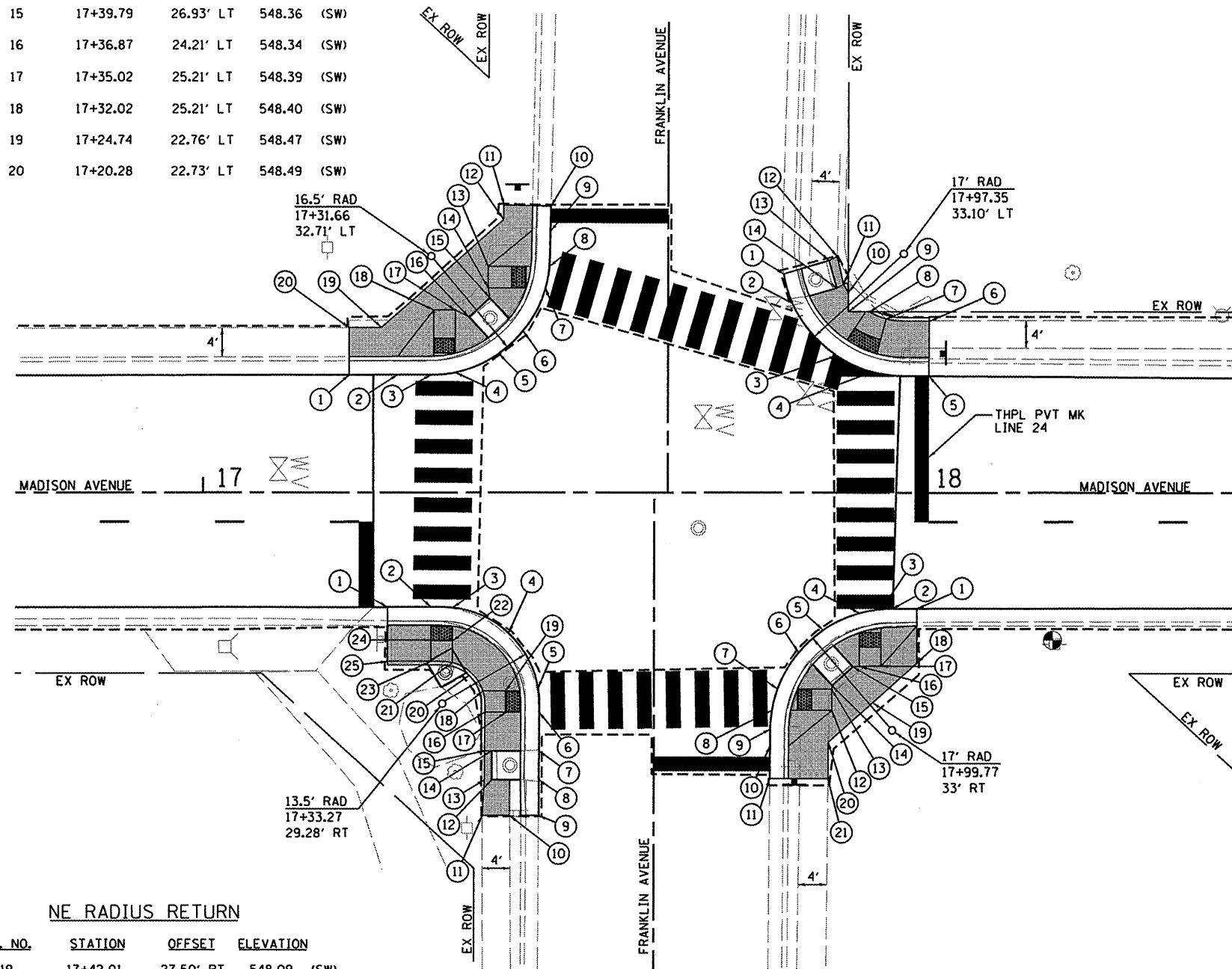

INTERSECTION LAYOUT  
MADISON AVENUE AND FRANKLIN AVENUE  
SCALE: 1"=10'

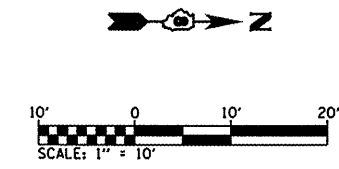

LEGEND

- EOP = EDGE OF PAVEMENT
- BC = BACK OF CURB
- SW = SIDEWALK
- TC = TOP OF CURB
- PROP. PCC SIDEWALK, 4"

NE RADIUS RETURN

PT. NO.	STATION	OFFSET	ELEVATION
1	17+99.23	16.00' RT	548.11 (EOP)
	17+99.23	18.39' RT	548.36 (BC)
2	17+95.77	16.00' RT	548.08 (EOP)
	17+95.77	18.58' RT	548.27 (BC)
3	17+94.24	16.07' RT	547.97 (EOP)
	17+94.23	18.66' RT	547.89 (BC)
	17+94.23	18.66' RT	547.89 (SW)
4	17+91.23	16.62' RT	547.72 (EOP)
	17+91.23	19.31' RT	547.64 (BC)
	17+91.23	19.31' RT	547.64 (SW)
5	17+86.19	18.96' RT	547.57 (EOP)
	17+87.65	21.09' RT	547.95 (BC)
6	17+82.69	22.15' RT	547.52 (EOP)
	17+84.67	23.80' RT	547.90 (BC)
7	17+79.79	27.20' RT	547.65 (EOP)
	17+82.57	27.20' RT	547.57 (BC)
	17+82.57	27.20' RT	547.57 (SW)
8	17+79.01	30.20' RT	547.68 (EOP)
	17+81.63	30.20' RT	547.60 (BC)
	17+81.63	30.20' RT	547.60 (SW)
9	17+78.77	32.85' RT	547.70 (EOP)
	17+81.35	32.85' RT	547.85 (BC)
10	17+78.75	35.17' RT	547.72 (EOP)
	17+81.33	35.19' RT	548.10 (BC)
11	17+78.71	39.75' RT	547.75 (EOP)
	17+81.30	39.75' RT	548.10 (BC)
12	17+87.37	30.21' RT	548.01 (SW)
13	17+87.37	27.27' RT	547.98 (SW)
14	17+87.40	26.71' RT	547.98 (SW)
15	17+90.30	24.08' RT	548.03 (SW)
16	17+91.23	24.01' RT	548.04 (SW)
17	17+94.23	24.01' RT	548.12 (SW)
18	17+99.22	23.56' RT	548.26 (SW)
19	17+90.05	29.12' RT	548.12 (SW)
20	17+86.88	34.68' RT	548.19 (SW)
21	17+86.83	39.79' RT	548.29 (SW)