

STATE OF ILLINOIS
DEPARTMENT OF TRANSPORTATION
DIVISION OF HIGHWAYS

**PROPOSED
HIGHWAY PLANS**

FAU ROUTE 9300 (PALMER RD.)
SECTION 09-00048-00-RS
PROJECT AREA - 5011(285)
JOB NO C-98-375-09

CITY OF COLUMBIA
MONROE COUNTY

F.A.U. RTE.	SECTION	COUNTY	TOTAL SHEETS	SHEET NO.
9300	09-00048-00-RS	MONROE	7	1
		ILLINOIS	CONTRACT NO. 97414	

FEDERAL AID PROJECT

INDEX OF SHEETS

- 1 COVER SHEET
- 2 SUMMARY OF QUANTITIES, GENERAL NOTES & HIGHWAY STANDARDS
- 3-4 TYPICAL SECTIONS
- 5 SCHEDULES
- 6 PLAN AND PROFILE SHEET
- 7 DETAIL SHEET

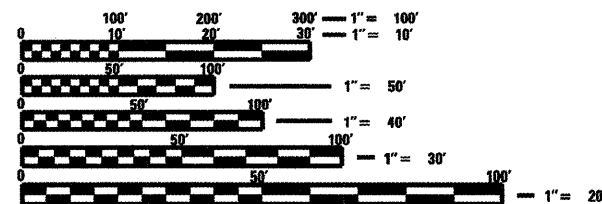
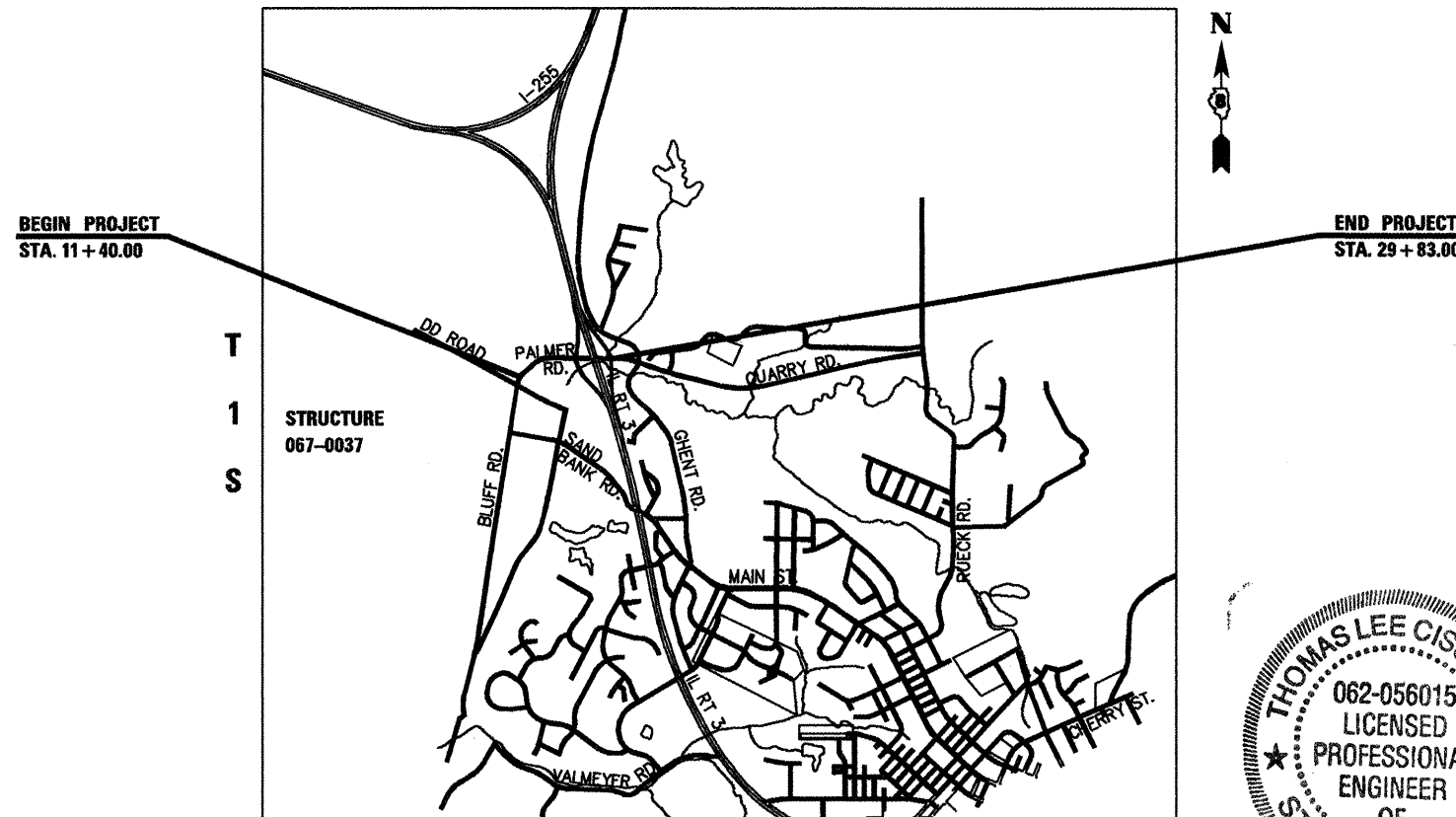

FULL SIZE PLANS HAVE BEEN PREPARED USING STANDARD ENGINEERING SCALES. REDUCED SIZED PLANS WILL NOT CONFORM TO STANDARD SCALES. IN MAKING MEASUREMENTS ON REDUCED PLANS, THE ABOVE SCALES MAY BE USED.

J.U.L.I.E.
JOINT UTILITY LOCATION INFORMATION FOR EXCAVATION
1-800-892-0123
OR 811

LOCATION MAP

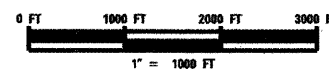

NET LENGTH OF PROJECT 1843.00 FT
0.35 MI

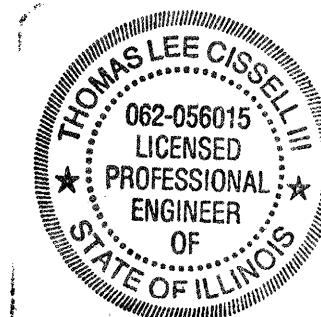

STATE OF ILLINOIS DEPARTMENT OF TRANSPORTATION	
APPROVED	<i>Karin Hultman</i> 11-4-09 MAYOR OF COLUMBIA
PASSED	11/9/09 <i>Jeffrey C. H.</i> DISTRICT 8 ENGINEER OF LOCAL ROADS & STREETS
RELEASING FOR BID BASED ON LIMITED REVIEW	<i>Mary C. Lamin</i> 11/9/09 DEPUTY DIRECTOR OF HIGHWAYS, REGION 5 ENGINEER

Thomas L. Cissell III 11/3/09 DATE
THOMAS L. CISSELL III, P.E.
I. P.E. NO. 062-056015
LICENSE EXPIRES 11/30/11

Eastport Business Center 1
100 Lanter Court, Suite 1
Collinsville, IL 62234
Phone: 618 345-2200
Facsimile: 618 345-7233

GENERAL NOTES

- UNDERGROUND FACILITIES, STRUCTURES AND UTILITIES HAVE BEEN PLOTTED FROM AVAILABLE SURVEYS AND RECORDS. THEIR LOCATIONS MUST BE CONSIDERED TO BE APPROXIMATE ONLY. IT IS POSSIBLE THERE MAY BE OTHERS, THE EXISTENCE OF WHICH IS NOT PRESENTLY KNOWN OR SHOWN. IT IS THE CONTRACTOR'S RESPONSIBILITY TO DETERMINE THEIR EXISTENCE AND EXACT LOCATION AND TO AVOID DAMAGE THERETO. ILLINOIS LAW REQUIRES A MINIMUM 48-HOUR NOTICE TO ALL UTILITY COMPANIES BEFORE DIGGING. FIELD LOCATIONS OF UNDERGROUND FACILITIES MAY BE OBTAINED BY CALLING THE J.U.L.I.E. SYSTEM AT 800-892-0123 AND PROVIDING 48 HOURS ADVANCE NOTICE. NON-J.U.L.I.E. MEMBERS MUST BE NOTIFIED INDIVIDUALLY. AGENCIES KNOWN TO HAVE FACILITIES WITHIN THE PROJECT LIMITS ARE LISTED BELOW.
- ANY FACILITIES OR APPURTENANCES WHICH ARE THE PROPERTY OF ANY PUBLIC UTILITY LOCATED WITHIN THE LIMITS OF CONSTRUCTION SHALL BE RELOCATED OR ADJUSTED BY THEIR RESPECTIVE OWNERS. THE CONTRACTOR SHALL NOTIFY AND COOPERATE WITH THE OWNERS OF ANY SUCH FACILITY IN THEIR REMOVAL AND REARRANGEMENT OPERATIONS IN ORDER THAT THESE OPERATIONS AND THE CONSTRUCTION OF THIS PROJECT MAY PROGRESS IN A REASONABLE MANNER. ALL ROADSIDE OBJECTS (UTILITY POLES, FIRE HYDRANTS, SIGNS, ETC.) SHALL BE RELOCATED TO PROVIDE A MINIMUM OF 1.5 FEET CLEARANCE, MEASURED FROM THE FACE OF CURB TO THE NEAR EDGE OF THE OBJECT.
- THE FOLLOWING UTILITY COMPANIES MAY HAVE FACILITIES LOCATED WITHIN THE LIMITS OF CONSTRUCTION WHICH MAY REQUIRE ADJUSTMENT, RELOCATION OR REMOVAL. ALL ARE MEMBERS OF J.U.L.I.E., UNLESS NOTED OTHERWISE.
 - AMEREN IP (GAS & ELECTRIC)
1050 WEST BOULEVARD
BELLEVILLE, IL 62222
(618) 236-4309
 - CHARTER COMMUNICATIONS (CABLE TV)
210 WEST DIVISION STREET
MARYVILLE, IL 62062
(618) 345-8121
 - CITY OF COLUMBIA (WATER & SEWER)
110 WEST SAND BANK ROAD
COLUMBIA, IL 62236
(618) 281-4264
 - HARRISONVILLE TELEPHONE COMPANY (TELEPHONE)
213 SOUTH MAIN STREET
WATERLOO, IL 62298-0149
(618) 938-4080
- THE ABOVE INFORMATION REPRESENTS THE BEST INFORMATION AVAILABLE TO THE LOCAL AGENCY AND IS ONLY INCLUDED FOR THE CONVENIENCE OF THE BIDDER. IT IS UNDERSTOOD AND AGREED THAT THE CONTRACTOR HAS TAKEN THE FOREGOING INTO CONSIDERATION IN PREPARING HIS/her BID, AND NO ADDITIONAL COMPENSATION WILL BE ALLOWED FOR ANY DELAYS OR INCONVENIENCE CAUSED BY SAME.
- THE CONTRACTOR SHALL VERIFY ALL DIMENSIONS AND CONDITIONS IN THE FIELD PRIOR TO ORDERING MATERIALS AND COMMENCING CONSTRUCTION.
- THE CONTRACTOR SHALL STAGE ALL WORK IN SUCH A WAY AS TO MAINTAIN INGRESS AND EGRESS TO ALL ABUTTING PROPERTIES AT ALL TIMES DURING CONSTRUCTION.
- THE CONTRACTOR SHALL CONFINE ALL OPERATIONS TO THE CONSTRUCTION LIMITS LINE SHOWN ON THE PLANS. ANY AREA DISTURBED BEYOND THESE LIMITS SHALL BE RESTORED TO ITS ORIGINAL CONDITION AT THE CONTRACTOR'S EXPENSE.
- THE CONTRACTOR SHALL FERTILIZE, SEED AND MULCH ALL EARTH SURFACES WITHIN CONSTRUCTION LIMITS DISTURBED BY CONSTRUCTION. SEE THE SEEDING SCHEDULE FOR ESTIMATED PLAN QUANTITIES.
- ANY UNSUITABLE MATERIAL ENCOUNTERED DURING CONSTRUCTION SHALL BE REMOVED BY THE CONTRACTOR AND REPLACED WITH SUITABLE MATERIAL AS APPROVED BY THE ENGINEER. THIS WORK WILL BE PAID FOR ACCORDING TO ARTICLE 109.04 OF THE "STANDARD SPECIFICATIONS FOR ROAD AND BRIDGE CONSTRUCTION."
- THE CONTRACTOR SHALL NOTE THE LOCATION OF ALL MANHOLE AND VALVE VAULT FRAMES AND LIDS LOCATED WITHIN THE RESURFACING LIMITS. APPROPRIATE CARE SHALL BE TAKEN TO PROTECT THESE ITEMS DURING MILLING OPERATIONS.
- ALL PATCHING ON THIS PROJECT SHALL BE COMPLETED AFTER MILLING OPERATIONS. MILLED SURFACE MUST BE RESURFACED WITHIN 10 WORKING DAYS. FULL DEPTH SAW CUTS SHALL BE REQUIRED ALONG THE LIMITS OF THE PATCH. FULL DEPTH SAW CUTS WILL NOT BE PAID FOR SEPARATELY, BUT SHALL BE INCLUDED IN THE CONTRACT UNIT COST BID OF THE PAVEMENT PATCHING INVOLVED AND NO ADDITIONAL COMPENSATION WILL BE ALLOWED.
- THE CONTRACTOR SHALL APPLY SHORT TERM PAVEMENT MARKINGS TO THE MILLED, PRIMED AND EACH HOT-MIX ASPHALT LAYER. A QUANTITY FOR SHORT TERM PAVEMENT MARKING HAS BEEN INCLUDED IN THE PLANS. ONLY THE FINAL APPLICATION OF SHORT TERM PAVEMENT MARKINGS SHALL BE REMOVED AND SEPARATE PAYMENT WILL BE MADE FOR WORK ZONE PAVEMENT MARKING REMOVAL.
- THE PAVEMENT MARKING LOCATIONS SHOWN IN THE PLANS ARE APPROXIMATE. PROPOSED STOP BARS SHALL BE PLACED AT THE SAME LOCATION AS EXISTING ON THE IL RTE 3 RAMPS.
- APPLICATION RATES USED FOR QUANTITY ESTIMATES ARE AS FOLLOWS:

BITUMINOUS MATERIALS (PRIME COAT)	0.075 GAL/SY
AGGREGATE (PRIME COAT)	3LBS/SY
HOT-MIX ASPHALT	0.056 TONS/SY/IN

COMMITMENTS

NONE

LIST OF HIGHWAY STANDARDS

000001-05	STANDARD SYMBOLS, ABBREVIATIONS, AND PATTERNS
280001-05	TEMPORARY EROSION CONTROL SYSTEMS
420001-07	PAVEMENT JOINTS
442201-03	CLASS C AND D PATCHES
482001-02	HMA SHOULDER ADJACENT TO FLEXIBLE PAVEMENT
701006-03	OFF-ROAD OPERATIONS, 2L, 2W, 15' TO 24" FROM PAVEMENT EDGE
701201-03	LANE CLOSURE, 2L, 2W, DAY ONLY, FOR SPEEDS ≤ 45 MPH
701301-03	LANE CLOSURE 2L, 2W, SHORT TIME OPERATIONS
701306-02	LANE CLOSURE, 2L, 2W, SLOW MOVING OPERATIONS DAY ONLY, FOR SPEEDS ≥ 45MPH
701311-03	LANE CLOSURE 2L, 2W, MOVING OPERATIONS-DAY ONLY
701336-05	LANE CLOSURE 2L, 2W, WORK AREAS IN SERIES, FOR SPEEDS ≥ 45 MPH
701601-06	URBAN LANE CLOSURE, MULTILANE, 1W OR 2W WITH NONTRAVERSABLE MEDIAN
701701-06	URBAN LANE CLOSURE, MULTILANE INTERSECTION
701901-01	TRAFFIC CONTROL DEVICES
780001-02	TYPICAL PAVEMENT MARKINGS
BLR 17-4	TRAFFIC CONTROL DEVICES-DAY LABOR CONSTRUCTION

HMA MIXTURE TABLE

	HMA SURFACE COURSE	HMA BINDER (FULL-DEPTH PATCHES)	HMA LEVEL BINDER	HMA SHOULDER, 1.5"	HMA SHOULDER, 6"
PG GRADE	PG64-22	PG64-22	PG64-22	PG64-22	PG58-22
MAX % RAP ALLOWABLE**	10%	10%	10%	40%	40%
DESIGN AIR VOIDS	4.0% @ N70	4.0% @ N70	4.0% @ N70	4.0% @ N50	2.0% @ N50
MIXTURE COMPOSITION	IL 9.5 or IL 12.5	IL 19.0 or IL 25.0		IL 9.5 or IL 12.5	
FRICTION AGGREGATE	MIXTURE D	MIXTURE B	MIXTURE B	MIXTURE C	BAM
DENSITY TEST METHOD	CORES/NUCLEAR	CORES/NUCLEAR	SATISFACTION OF ENGINEER	CORES/NUCLEAR	CORES/NUCLEAR

** IF RAP OPTION IS SELECTED, THE ASPHALT CEMENT GRADE MAY NEED TO BE ADJUSTED. THIS WILL BE DETERMINED BY THE ENGINEER.

SUMMARY OF QUANTITIES

CODE NO.	ITEM	UNIT	TOTAL QUANTITIES
S 25001020	SEEDING, CLASS 2A (SPECIAL)	ACRE	0.4
28000400	PERIMETER EROSION BARRIER	FOOT	2,070
40200500	AGGREGATE SURFACE COURSE, TYPE A 6"	SQ YD	61
40300100	BITUMINOUS MATERIALS (PRIME COAT)	GALLON	945
40600300	AGGREGATE (PRIME COAT)	TON	19
40600635	LEVELING BINDER (MACHINE METHOD), N70	TON	196
40603340	HOT-MIX ASPHALT SURFACE COURSE, MIX "D", N70	TON	676
S 44000155	HOT-MIX ASPHALT SURFACE REMOVAL, 1 1/2"	SQ YD	5,602
S 44000159	HOT-MIX ASPHALT SURFACE REMOVAL, 2 1/2"	SQ YD	3,496
S 44201976	CLASS D PATCHES, TYPE II	SQ YD	81
S 44201978	CLASS D PATCHES, TYPE III	SQ YD	115
S 44201980	CLASS D PATCHES, TYPE IV	SQ YD	576
44300200	STRIP REFLECTIVE CRACK CONTROL TREATMENT	FOOT	1,335
48102100	AGGREGATE WEDGE SHOULDER, TYPE B	TON	63
48203003	HOT-MIX ASPHALT SHOULDERS, 1 1/2"	SQ YD	1,046
S 48203021	HOT-MIX ASPHALT SHOULDERS, 6"	SQ YD	1,208
67100100	MOBILIZATION	LSUM	1
S 70101700	TRAFFIC CONTROL AND PROTECTION	L SUM	1
S 70300100	SHORT-TERM PAVEMENT MARKING	FOOT	1,140
S 70300210	TEMPORARY PAVEMENT MARKING - LETTERS AND SYMBOLS	SQ FT	31
S 70300220	TEMPORARY PAVEMENT MARKING - LINE 4"	FOOT	7,119
S 70300250	TEMPORARY PAVEMENT MARKING - LINE 8"	FOOT	247
S 70300260	TEMPORARY PAVEMENT MARKING - LINE 12"	FOOT	205
S 70301000	WORK ZONE PAVEMENT MARKING REMOVAL	SQ FT	127
* 78000100	THERMOPLASTIC PAVEMENT MARKING - LETTERS AND SYMBOLS	SQ FT	63
* 78000200	THERMOPLASTIC PAVEMENT MARKING - LINE 4"	FOOT	7,119
* 78000500	THERMOPLASTIC PAVEMENT MARKING - LINE 8"	FOOT	247
* 78000600	THERMOPLASTIC PAVEMENT MARKING - LINE 12"	FOOT	205
* 78200300	PRISMATIC CURB REFLECTOR	EACH	22
* 78300200	RAISED REFLECTIVE PAVEMENT MARKER REMOVAL	EACH	21

S - Special Provision

* - Specialty Items

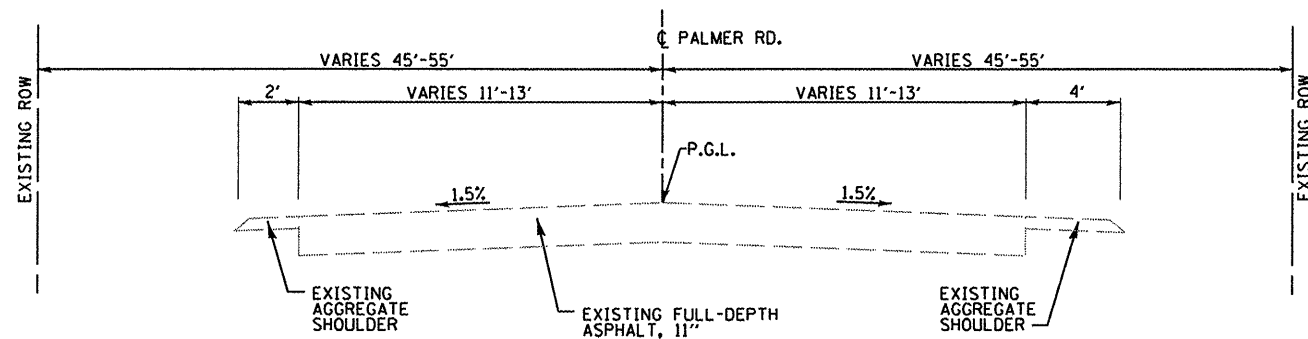

EXISTING TYPICAL SECTION
FROM STA. 11+40 TO STA. 13+25

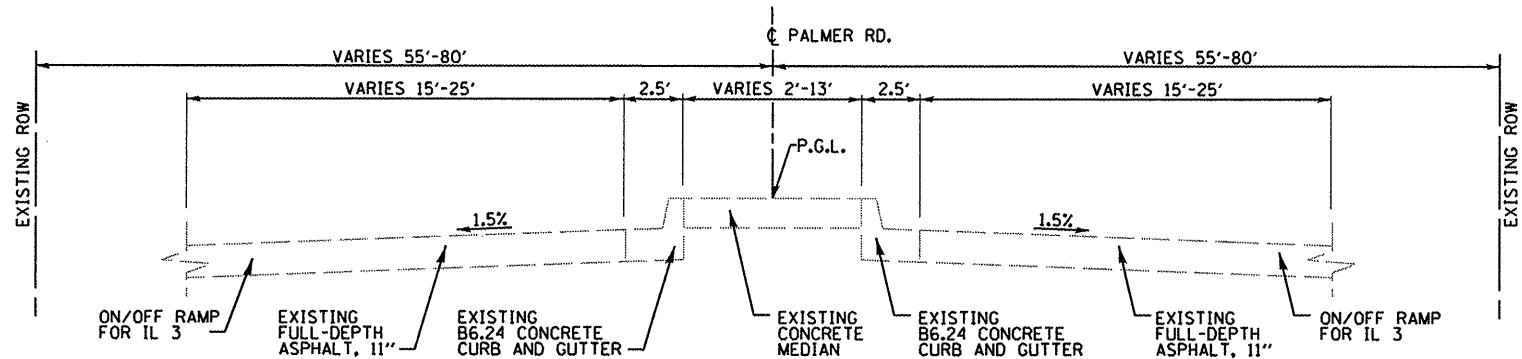

EXISTING TYPICAL SECTION
FROM STA. 22+00 TO STA. 23+50
FROM STA. 28+50 TO STA. 29+83

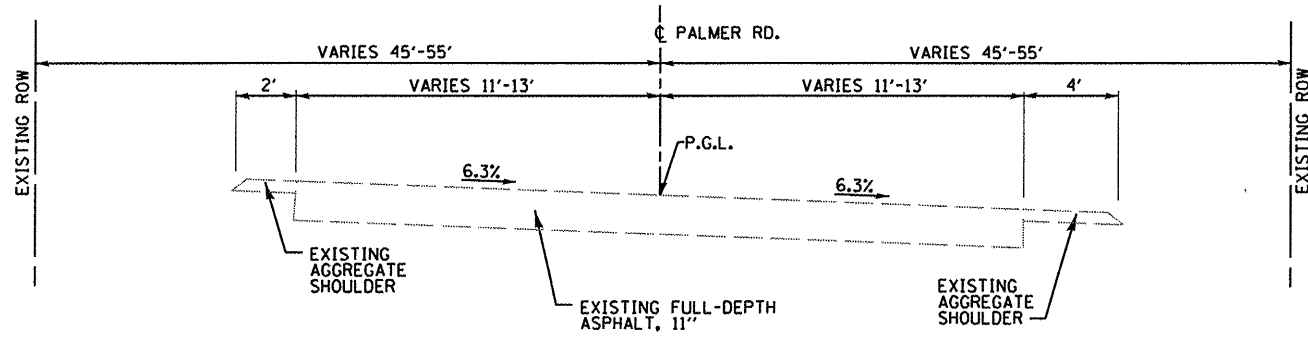

EXISTING TYPICAL SECTION
FROM STA. 13+25 TO STA. 17+56

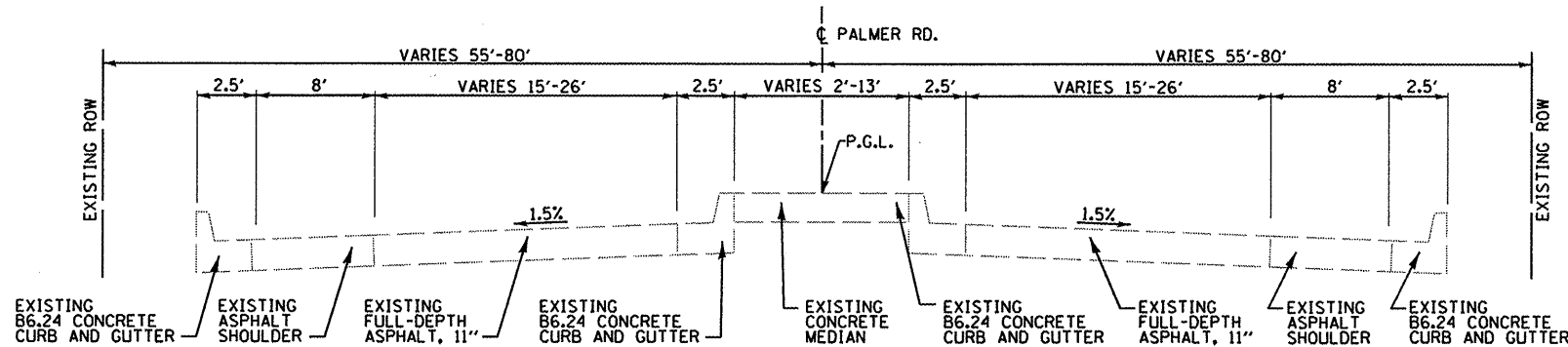

EXISTING TYPICAL SECTION
FROM STA. 23+50 TO STA. 28+50

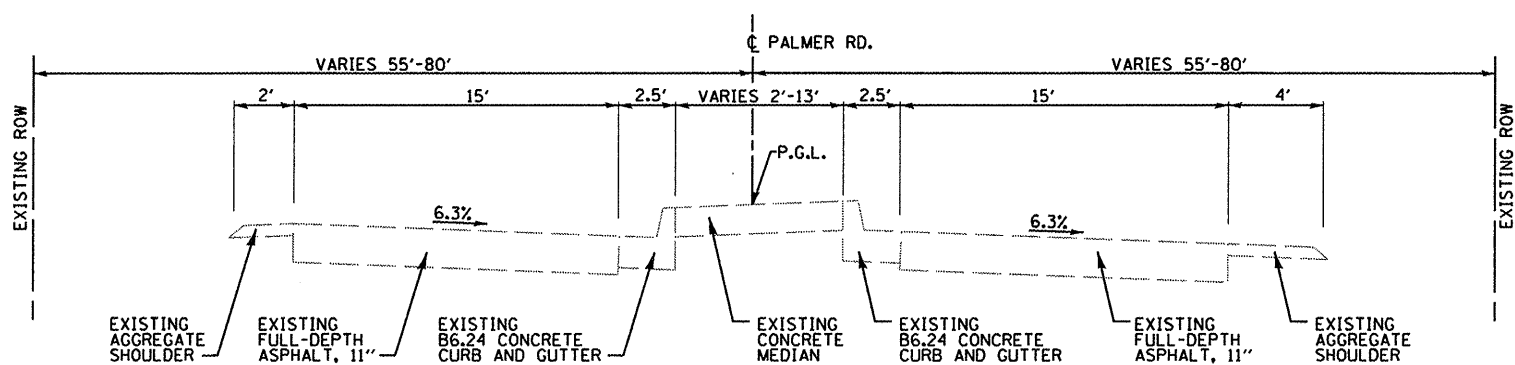

EXISTING TYPICAL SECTION
FROM STA. 17+56 TO STA. 22+00

FILE NAME =	USER NAME = default	DESIGNED -	REVISED -
H:\P\29017\Microstation\Copied from M	current files\29017 ts01.dgn	DRAWN -	REVISED -
	PLOT SCALE = 40.0000' / 1 IN.	CHECKED -	REVISED -
	PLOT DATE = 10/29/2009	DATE -	REVISED -

STATE OF ILLINOIS
DEPARTMENT OF TRANSPORTATION

TYPICAL SECTIONS

SCALE: SHEET NO. OF SHEETS STA. TO STA.

F.A.U. RTE.	SECTION	COUNTY	TOTAL SHEETS	SHEET NO.
9300	09-00048-00-R5	MONROE	7	3
CONTRACT NO. 97414				
ILLINOIS FED. AID PROJECT				

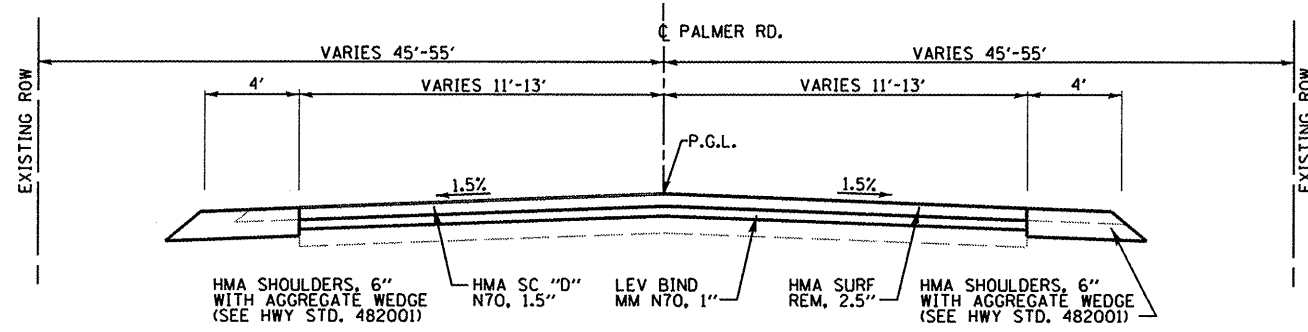

PROPOSED TYPICAL SECTION
FROM STA. 11+40 TO STA. 13+25

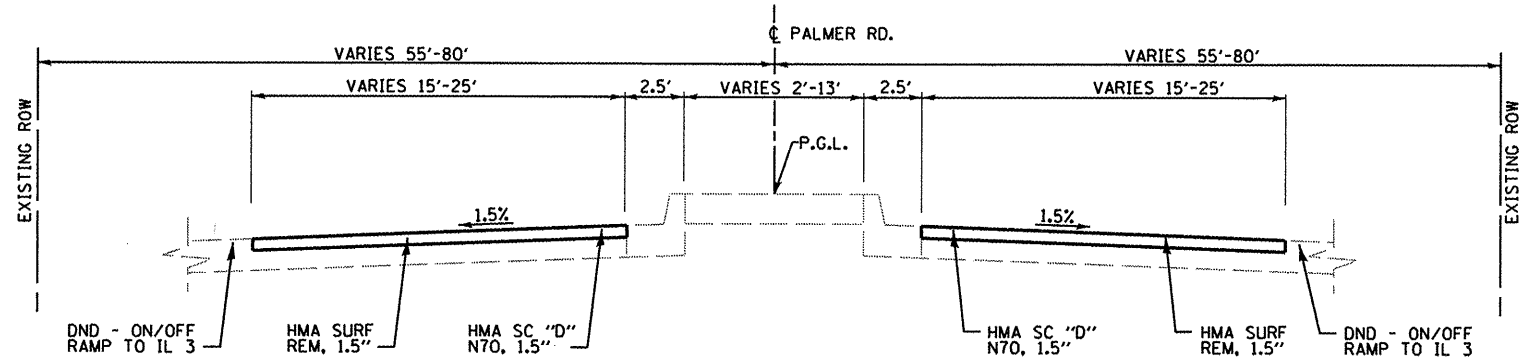

PROPOSED TYPICAL SECTION
FROM STA. 22+00 TO STA. 23+50
FROM STA. 28+50 TO STA. 29+83

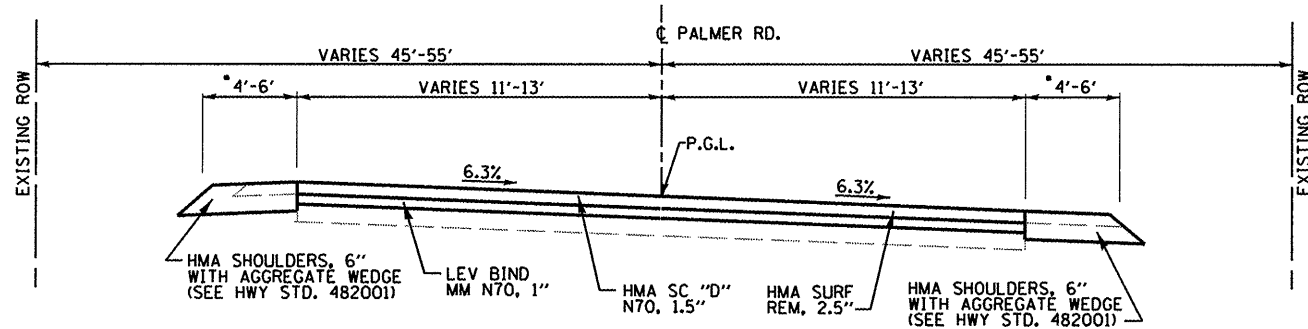

PROPOSED TYPICAL SECTION
FROM STA. 13+25 TO STA. 17+56

*NOTE: TRANSITION PROPOSED HMA SHOULDER FROM 4' AT STA. 15+70 RT TO 6' AT STA. 16+30 RT.

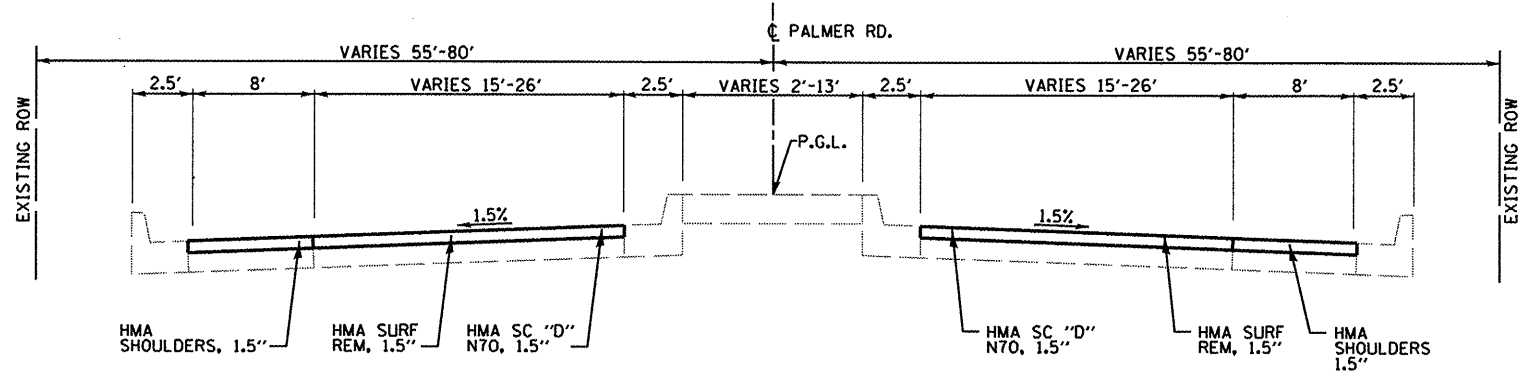

PROPOSED TYPICAL SECTION
FROM STA. 23+50 TO STA. 28+50

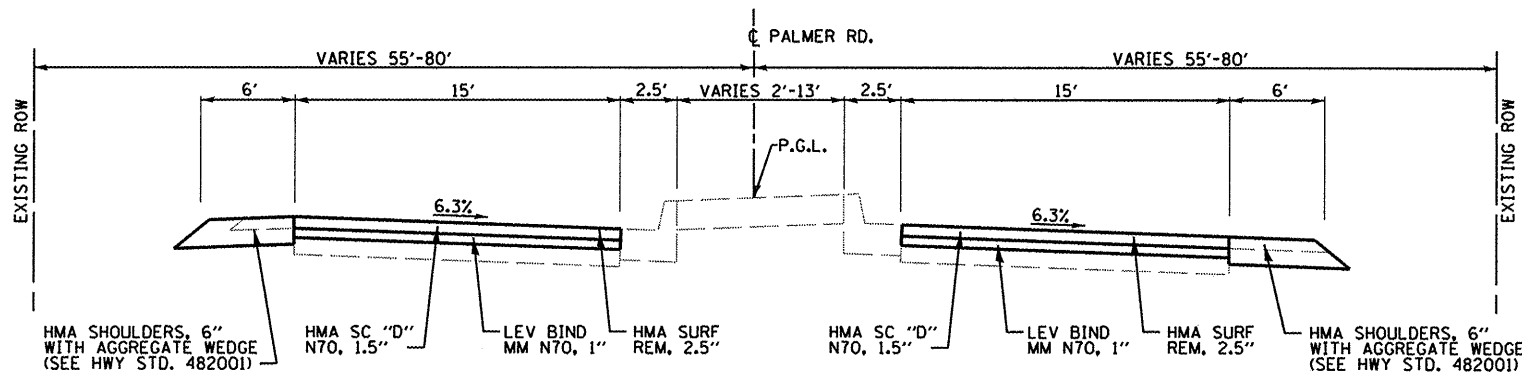

PROPOSED TYPICAL SECTION
FROM STA. 17+56 TO STA. 22+00

FILE NAME =	USER NAME = default	DESIGNED -	REVISED -	STATE OF ILLINOIS DEPARTMENT OF TRANSPORTATION	TYPICAL SECTIONS	F.A.U. RTE.	SECTION	COUNTY	TOTAL SHEETS	SHEET NO.	
H:\P\29017\Microstation\Copied from M	current files\29017 ts01.dgn	DRAWN -	REVISED -			9300	09-00048-00-RS	MONROE	7	4	
	PLOT SCALE = 40.0000' / IN.	CHECKED -	REVISED -			CONTRACT NO. 97414					
	PLOT DATE = 10/29/2009	DATE -	REVISED -			ILLINOIS FED. AID PROJECT					
						SCALE:	SHEET NO.	OF SHEETS	STA.	TO STA.	

PAVEMENT SCHEDULE

STATION	STATION	BIT MATLS PR CT (NOTE 1) (GAL)	AGG PR CT (TON)	LEV BIND MM N70 (TON)	HOT-MIX ASPHALT SC "D" N70 (TON)	HMA SURF REM 1 1/2 (SQ YD)	HMA SURF REM 2 1/2 (SQ YD)	AGG WEDGE SHLD TYPE B (TON)	HMA SHOULDERS 1 1/2 (SQ YD)	HMA SHOULDERS 6 (SQ YD)
11+40	20+00	423	8.5	158	236		2815	51		933
20+00	22+12	102	2.0				681	12		275
20+00	29+83			38	440					
22+00	29+83	420	8.5			5602				
22+85	28+70								498	
23+00	29+12								548	
TOTAL		945	19	196	676	5602	3496	63	1046	1208

PAVEMENT NOTES:

1. BITUMINOUS MATERIALS AND AGGREGATE PRIME COAT QUANTITIES WERE CALCULATED FOR APPLICATIONS OVER ALL MILLED SURFACES AND LEVELING BINDER AREAS.

SEEDING SCHEDULE

STATION	STATION	SEEDING CL 2A SPL (NOTE 2) (ACRE)	NITROGEN FERT NUTR (NOTE 1) (POUND)	PHOSPHORUS FERT NUTR (NOTE 1) (POUND)	POTASSIUM FERT NUTR (NOTE 1) (POUND)	MULCH METHOD 2 (NOTE 1) (TON)
11+40 RT	22+10 RT	0.2	17	17	17	0.4
11+40 LT	16+25 LT	0.1	8	8	8	0.2
16+70 LT	22+00 LT	0.1	9	9	9	0.2
TOTAL		0.4	34	34	34	0.8

SEEDING NOTES:

1. FERTILIZER AND MULCH QUANTITIES ARE SHOWN FOR INFORMATION ONLY. THE COST FOR FERTILIZER NUTRIENTS AND MULCH SHALL BE INCLUDED IN THE CONTRACT UNIT PRICE FOR SEEDING, CLASS 2A (SPECIAL).
2. SEEDING CLASS 2A (SPECIAL) QUANTITY WAS CALCULATED ASSUMING AN 8' STRIP BEYOND PROPOSED HMA SHOULDERS 6" WITH AGGREGATE WEDGE.

PAVEMENT PATCHING SCHEDULE

STATION	STATION	CL D PATCH T2 (SQ YD)	CL D PATCH T3 (SQ YD)	CL D PATCH T4 (SQ YD)	STRIP REF CR CON TR (NOTE 1) (FOOT)
11+70	11+82	7			35
11+85	11+90	13			46
12+36	12+50		23		55
12+61	12+70		23		45
12+99	13+03	10			46
13+20	13+73			51	94
13+96	14+36			63	124
14+52	14+56	11			47
15+21	15+26	12			50
15+59	15+82			36	70
16+21	16+25	14			65
16+80	16+84	14			64
17+43	17+60		24		44
17+57	17+86		23		44
18+38	18+64			43	30
19+11	19+39			45	30
19+93	20+13		22		40
20+82	21+00			29	30
21+35	21+65			49	30
22+04	22+30			44	56
23+05	23+46			53	103
23+71	24+01			50	60
28+55	29+01			113	127
TOTAL		81	115	576	1335

PAVEMENT PATCHING NOTES:

1. STRIP REFLECTIVE CRACK CONTROL IS TO BE PLACED AROUND THE PERIMETER OF EACH PATCH EXCEPT WHERE PATCH EDGE COINCIDES WITH THE EDGE OF PAVEMENT.

PAVEMENT MARKING SCHEDULE

STATION	STATION	SHORT-TERM PAVT MKING (FOOT)	TEMP PVT MK LTR & SYM (SQ FT)	TEMP PVT MK LINE 4 (FOOT)	TEMP PVT MK LINE 8 (FOOT)	TEMP PVT MK LINE 12 (FOOT)	WORK ZONE PAVT MK REM (SQ FT)	THPL PVT MK LTR & SYM (NOTE 1) (SQ FT)	THPL PVT MK LINE 4 (NOTE 1) (FOOT)	THPL PVT MK LINE 8 (NOTE 1) (FOOT)	THPL PVT MK LINE 12 (NOTE 1) (FOOT)	PRISMATIC CURB REFL (NOTE 2) (EACH)	RAISED REF PVT MK REM (EACH)
11+40 LT	16+16 LT			481					481				
11+40 CL	17+00 CL	370		1120			41		1120				
11+40 RT	22+12 RT			1057					1057				
16+89 LT	22+02 LT			522					522				
17+00 LT/RT	22+75 LT/RT			1154					1154				
22+34 LT	22+84 LT				40						40		
23+10 LT	28+71 LT		15.5	568					568				
23+60 LT	25+30 LT	360		170			40	31.5	170				
23+38 LT/RT	28+56 LT/RT			1060					1060			22	21
23+06 RT	29+12 RT			606					606				
26+10 RT	29+01 RT	410	15.5	181	160		46	31.5	181	160			
27+91 RT	29+01 RT					123					123		
27+91 RT	28+68 RT				87					87			
28+87 LT	29+70 LT			85					85				
28+87 RT	29+83 RT			115		42			115		42		
TOTAL		1140	31	7119	247	205	127	63	7119	247	205	22	21

PAVEMENT MARKING NOTES:

1. SEE HIGHWAY STANDARD 780001 FOR PAVEMENT MARKING DETAILS.
2. SEE DETAIL FOR PRISMATIC CURB REFLECTOR LAYOUT.

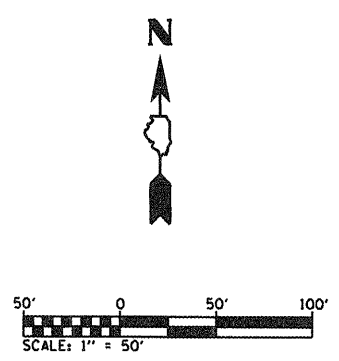
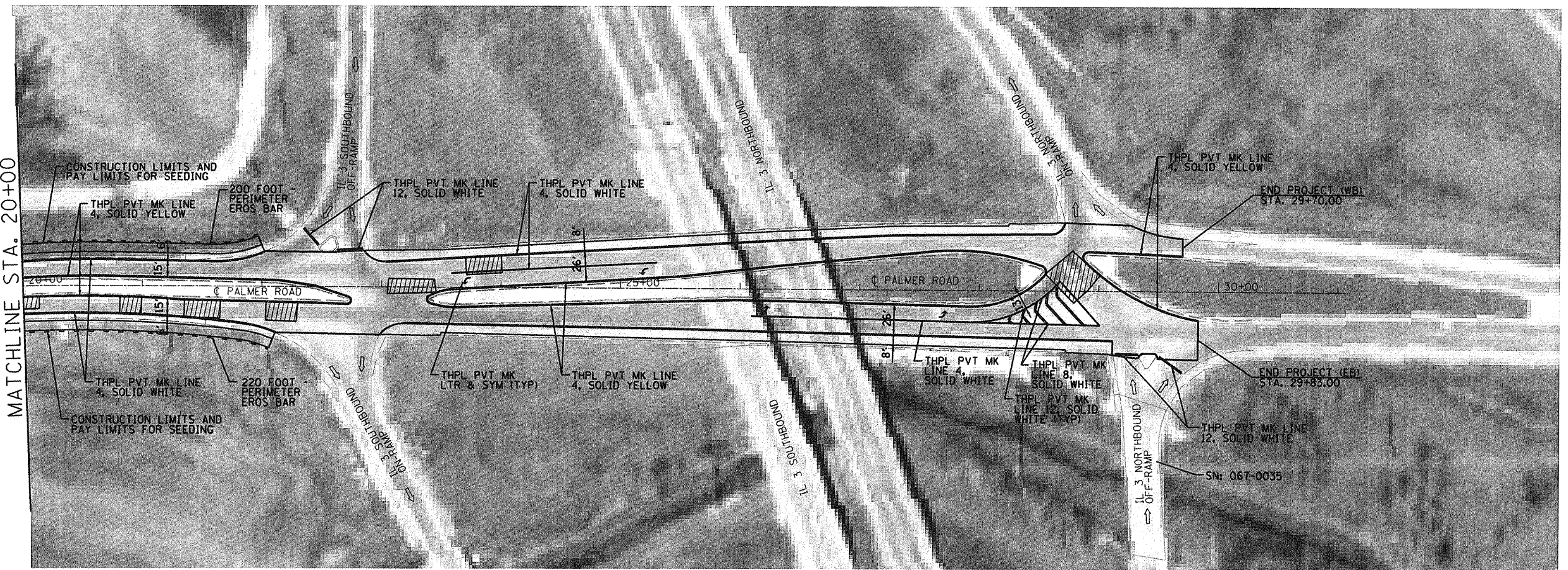
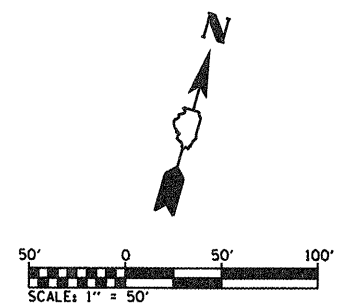
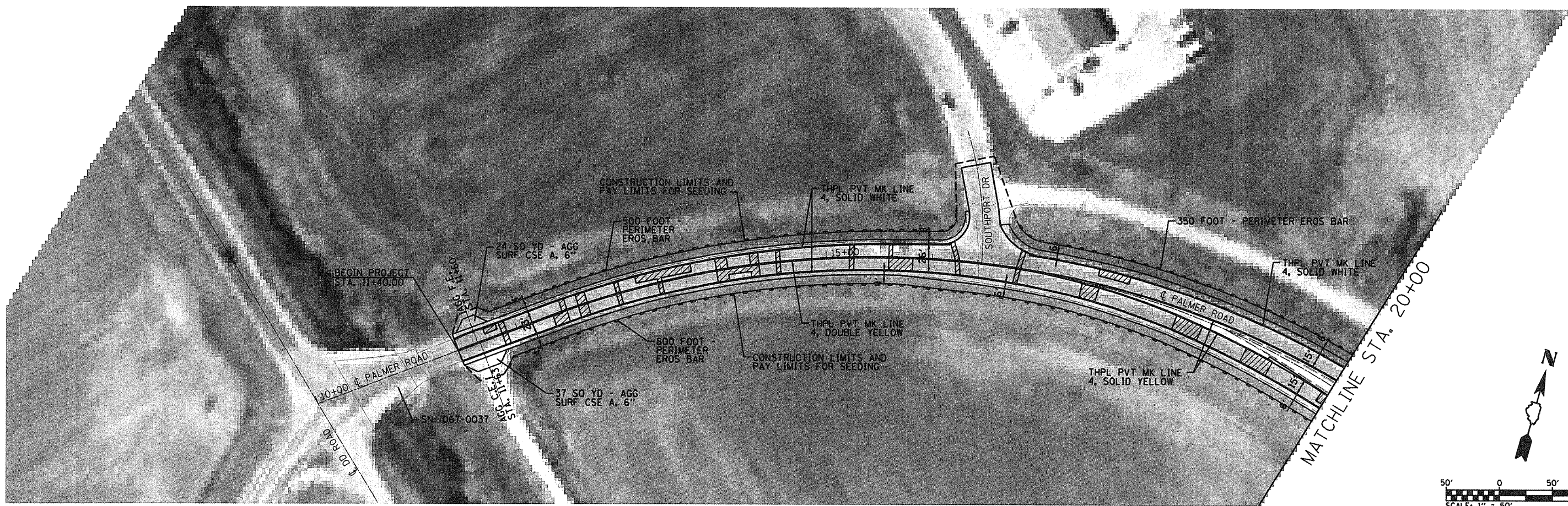

FILE NAME = H:\P\29017\Microstation\Copied from M	USER NAME = default current files\29017 pp01.dgn	DESIGNED - --- DRAWN - ---	REVISED - --- REVISED - ---	STATE OF ILLINOIS DEPARTMENT OF TRANSPORTATION	PLAN SHEET		F.A.U. RTE. 9300	SECTION 09-00048-00-RS	COUNTY MONROE	TOTAL SHEETS 7	SHEET NO. 6
	PLOT SCALE = 100.0000' / IN.	CHECKED - ---	REVISED - ---		SCALE: 1" = 50'	SHEET NO. ___ OF ___ SHEETS	STA. 10+00 TO STA. 30+00	CONTRACT NO. 97414		ILLINOIS	
	PLOT DATE = 11/2/2009	DATE - ---	REVISED - ---								

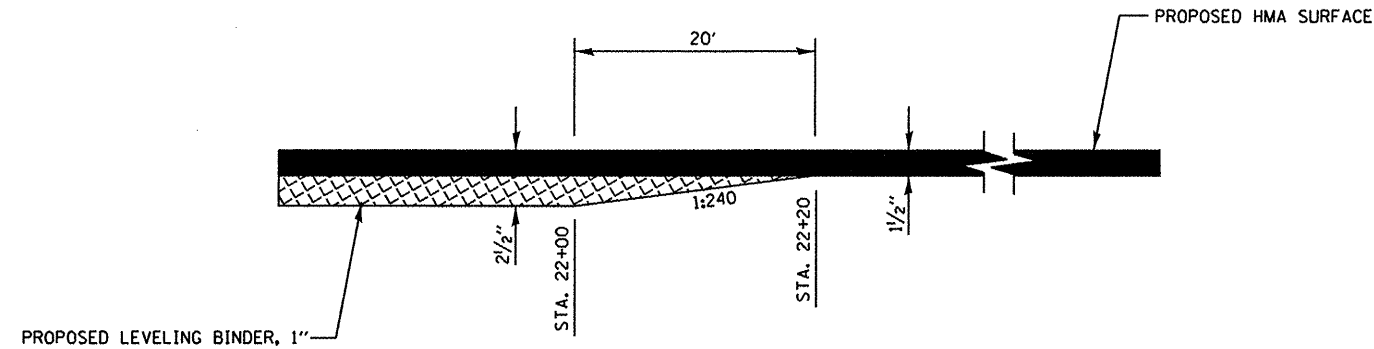

HMA SURFACE REMOVAL TRANSITION

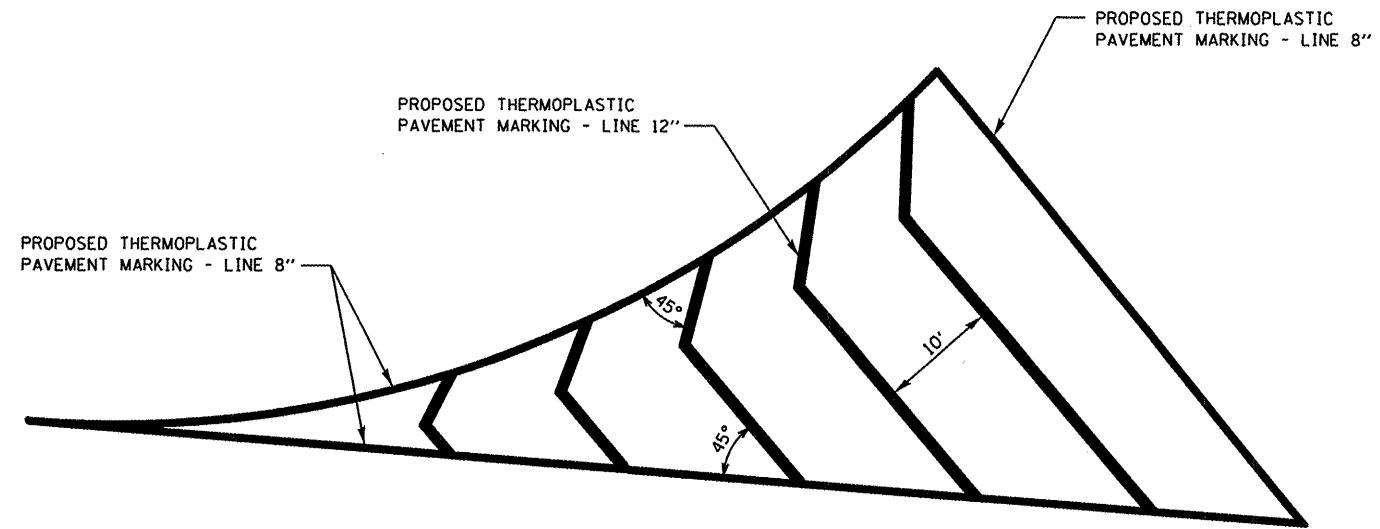

PAVEMENT STRIPING DETAIL
STA. 27+91 TO STA. 29+01

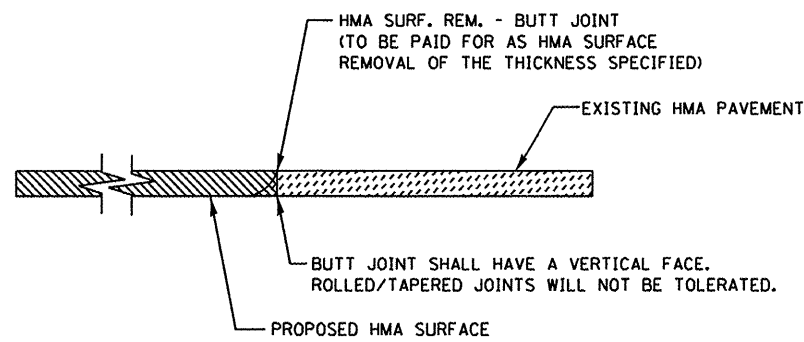

HMA BUTT JOINT

STA. 11+40
SOUTHPORT DRIVE
IL 3 SB OFF RAMP
IL 3 SB ON RAMP
IL 3 NB OFF RAMP
IL 3 NB ON RAMP
STA. 29+70 (WB)
STA. 29+83 (EB)

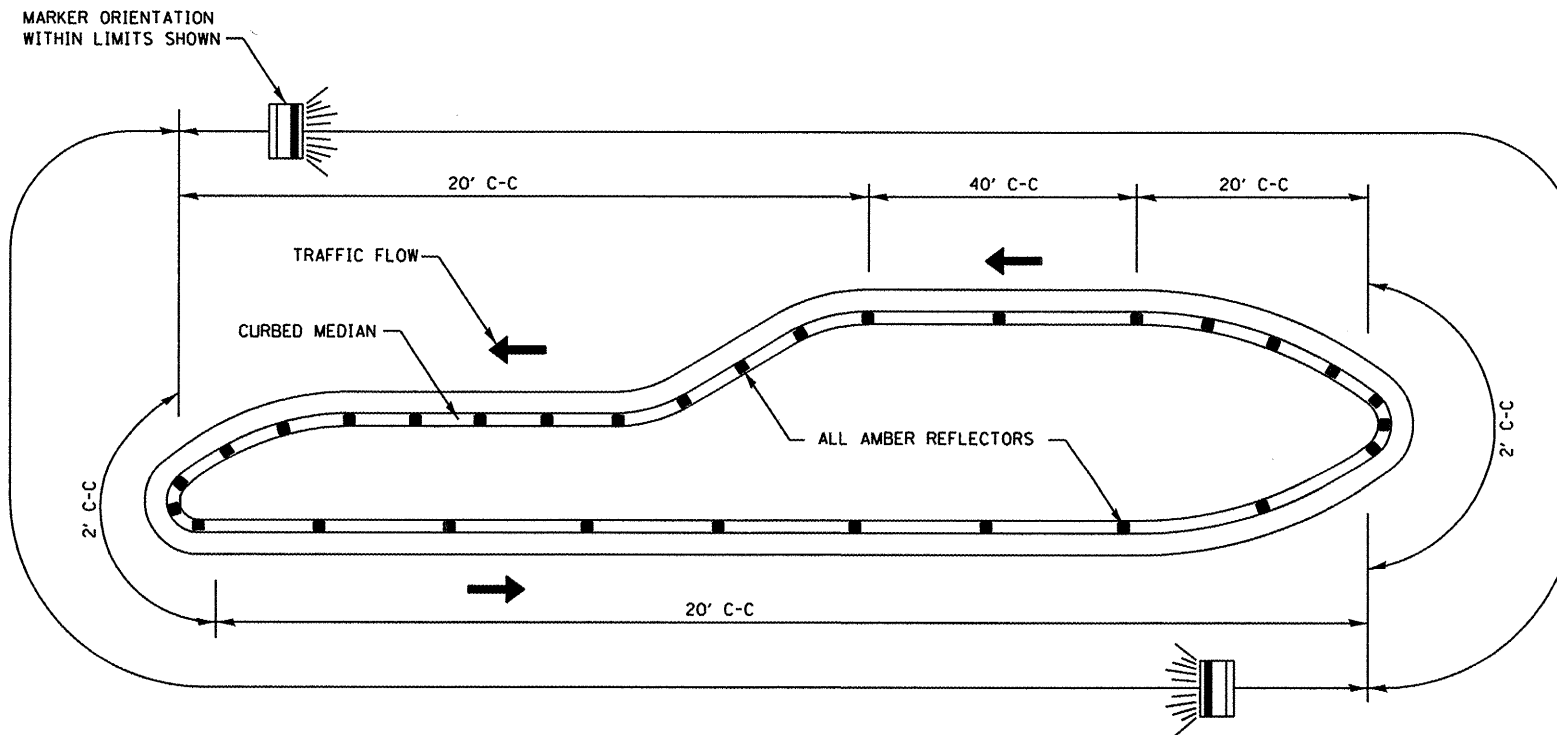

TYPICAL PLACEMENT OF PRISMATIC REFLECTORS ON CURBS
NOT TO SCALE

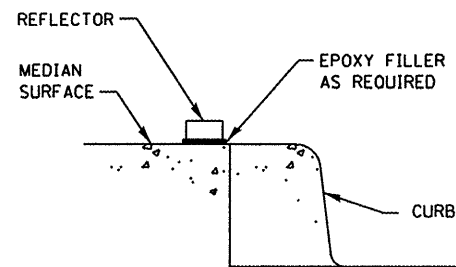

SECTION VIEW

NOTES

1. PRISMATIC REFLECTORS SHALL BE MONO-DIRECTIONAL AND POSITIONED SO THAT THE REFLECTIVE FACE IS FACING THE APPROACHING TRAFFIC.
2. PRISMATIC REFLECTORS SHALL BE SECURED IN PLACE WITH AN EPOXY ADHESIVE.
3. PRISMATIC REFLECTORS SHALL BE AMBER IN COLOR.

FILE NAME = H:\P\29017\Microstation\Copied from M	USER NAME = default current files\29017 cv01.dgn	DESIGNED -	REVISED -	STATE OF ILLINOIS DEPARTMENT OF TRANSPORTATION	MISCELLANEOUS DETAILS			F.A.U. RTE. 9300	SECTION 09-00048-00-RS	COUNTY MONROE	TOTAL SHEETS 7	SHEET NO. 7
	PLOT SCALE = 40.0000' / IN.	DRAWN -	REVISED -					SCALE:	SHEET NO. OF SHEETS	STA. TO STA.	CONTRACT NO. 97414	
	PLOT DATE = 11/2/2009	CHECKED -	REVISED -		ILLINOIS							
		DATE -	REVISED -									