

DATE \_\_\_\_\_  
 BY \_\_\_\_\_  
 SURVEYED \_\_\_\_\_  
 PLOTTED \_\_\_\_\_  
 TEMPLATE \_\_\_\_\_  
 NOTE BOOK \_\_\_\_\_  
 AREAS CHECKED \_\_\_\_\_

DATE \_\_\_\_\_  
 BY \_\_\_\_\_  
 SURVEYED \_\_\_\_\_  
 PLOTTED \_\_\_\_\_  
 TEMPLATE \_\_\_\_\_  
 NOTE BOOK \_\_\_\_\_  
 AREAS CHECKED \_\_\_\_\_

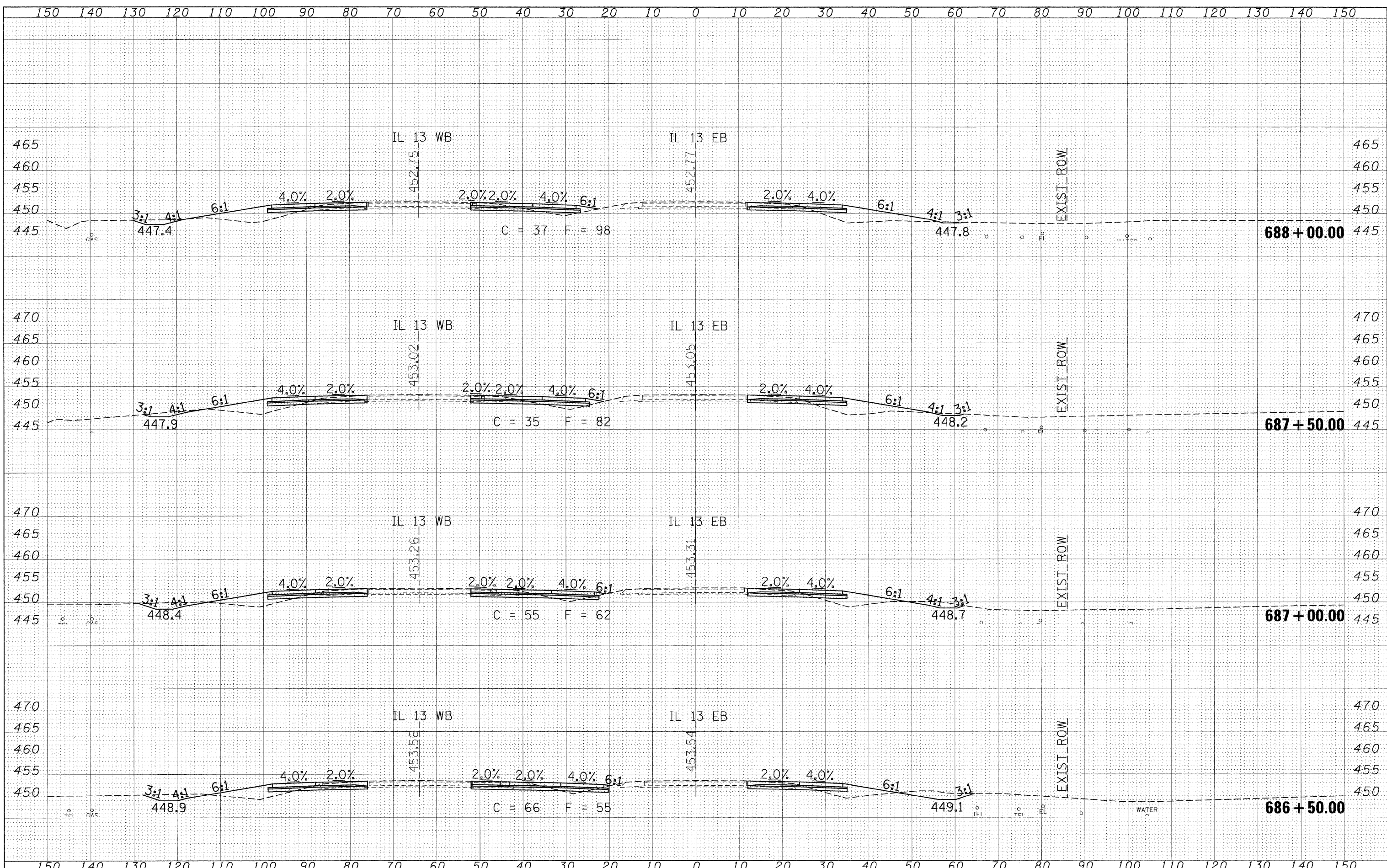

FILE NAME = c:\pwwork\pwwork\shpardgd\cns47330\Fedstml3  
 USER NAME = shpardgd  
 DESIGNED - ---  
 DRAWN - ---  
 CHECKED - ---  
 PLOT DATE = 10/14/2009

shst-xshst13main1ne2.dgn  
 PLOT SCALE = 10,0000' / IN.  
 DATE - ---

REVISED - ---  
 REVISED - ---  
 REVISED - ---  
 REVISED - ---

**STATE OF ILLINOIS**  
**DEPARTMENT OF TRANSPORTATION**

**IL 13 ACCELERATION LANES CROSS SECTION SHEETS**  
 SCALE: \_\_\_\_\_ SHEET NO. \_\_\_ OF \_\_\_ SHEETS STA. 686+50.00 TO STA. 688+00.00

F.A.P. RTE. 331	SECTION (1-2)N-2,R(1X-1)N-3,R-2	COUNTY WILLIAMSON	TOTAL SHEETS 202	SHEET NO. 169
				CONTRACT NO. 99857
ILLINOIS FED. AID PROJECT				