

STATE OF ILLINOIS
DEPARTMENT OF TRANSPORTATION
DIVISION OF HIGHWAYS

**PROPOSED
HIGHWAY PLANS**

FAP ROUTE 327 (US 50)
SECTION (12, 13, 14)RS-3
PROJECT ACF-0327 (066)
RESURFACING
CLAY COUNTY

C-97-011-15

FOR INDEX OF SHEETS, SEE SHEET NO. 2

STATION EQUATION:
STA 603+93.88BK = STA 117+21.40AH

2013 ADT = 2,400

F.A.P. RTE.	SECTION	COUNTY	TOTAL SHEETS	SHEET NO.
327	(12, 13, 14)RS-3	CLAY	27	1
		ILLINOIS	CONTRACT NO. 74704	

D-97-009-15

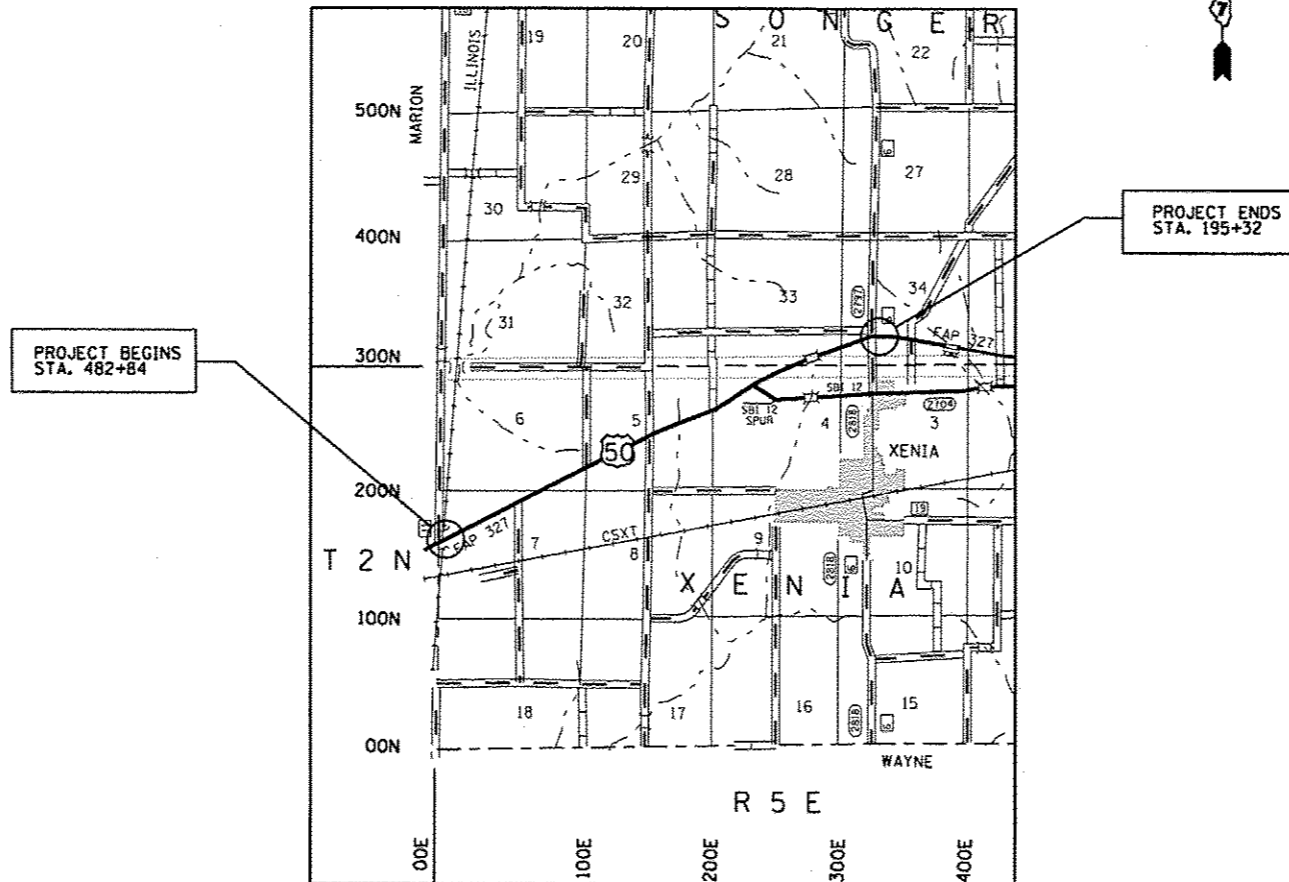
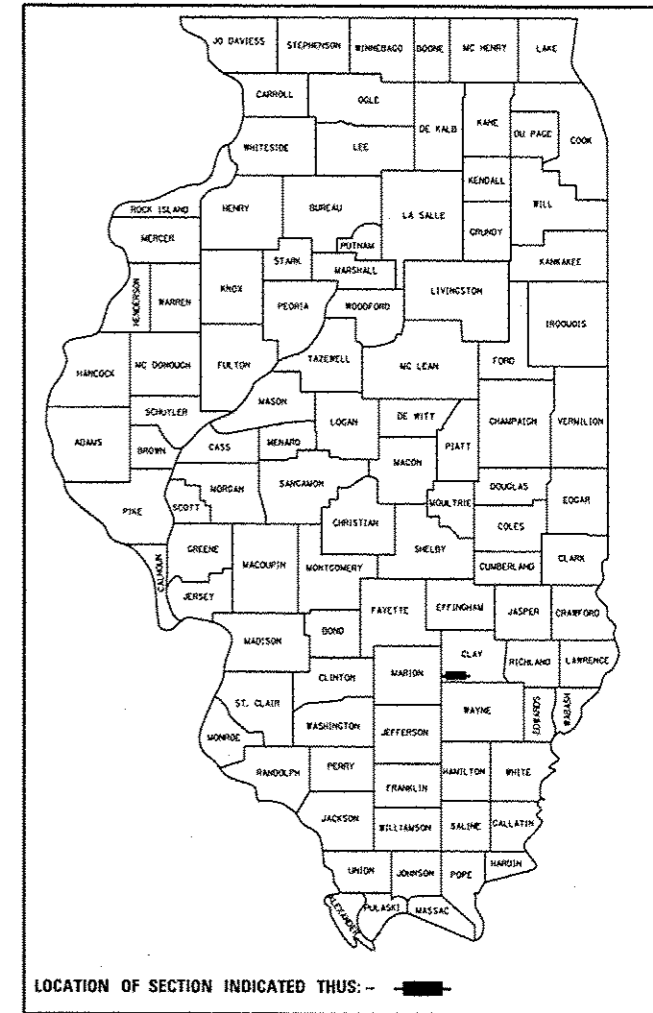

LENGTH = 21959.1 FT. = 4.16 MILE

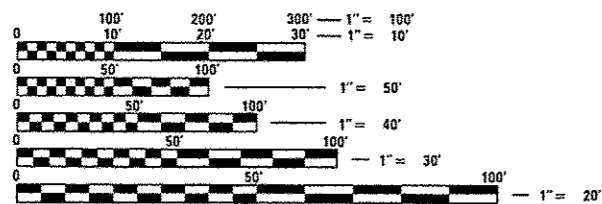

FULL SIZE PLANS HAVE BEEN PREPARED USING STANDARD ENGINEERING SCALES. REDUCED SIZED PLANS WILL NOT CONFORM TO STANDARD SCALES. IN MAKING MEASUREMENTS ON REDUCED PLANS, THE ABOVE SCALES MAY BE USED.

J.U.L.I.E.
JOINT UTILITY LOCATION INFORMATION FOR EXCAVATION
1-800-892-0123
OR 811

PROJECT ENGINEER: TOM RONAN
PROJECT MANAGER: KALEB HIRTZEL
PHONE: (217) 342-8320

CONTRACT NO. 74704

STATE OF ILLINOIS
DEPARTMENT OF TRANSPORTATION
DIVISION OF HIGHWAYS

SUBMITTED OCTOBER 14 2015
Roy L. Driskell, Jr.
DEPUTY DIRECTOR OF HIGHWAYS, REGION ENGINEER

Dec 4 2015
John D. Baramzelli, P.E./br
ENGINEER OF DESIGN AND ENVIRONMENT

Dec 4 2015
Omer Osman, P.E./br
DIRECTOR OF HIGHWAYS, CHIEF ENGINEER

**PRINTED BY THE AUTHORITY
OF THE STATE OF ILLINOIS**

INDEX OF SHEETS

SHEET NO.	ITEM
1	COVER SHEET
2	INDEX OF SHEETS AND GENERAL NOTES
3-5	SUMMARY OF QUANTITIES
6-7	TYPICAL SECTIONS
8-10	SCHEDULE OF QUANTITIES
11-18	PLAN SHEETS
19	CONSTRUCTION DETAILS
20-21	FLASHING BEACON DETAILS
22	INTERSECTION DETAILS
23	MEDIAN DETAILS
24-27	PAVEMENT MARKING DETAILS

THE FOLLOWING STANDARDS ARE A PART OF THESE PLANS AND ARE INCLUDED AFTER SHEET NO. 27:

STD. NO.	DESCRIPTION
000001-06	STANDARD SYMBOLS, ABBREVIATIONS AND PATTERNS
001001-02	AREAS OF REINFORCEMENT BARS
001006	DECIMAL OF AN INCH AND OF A FOOT
406201-01	MAILBOX TURNOUT
420701-02	PAVEMENT FABRIC
442101-07	CLASS B PATCHES
442201-03	CLASS C AND D PATCHES
482006-03	HMA SHOULDERS ADJACENT TO RIGID PAVEMENT
606301-04	PC CONCRETE ISLANDS AND MEDIANS
642006	SHOULDER RUMBLE STRIPS, 8 IN
667101-02	PERMANENT SURVEY MARKERS
701001-02	OFF-ROAD OPERATIONS, 2L, 2W, MORE THAN 15' AWAY
701006-05	OFF-ROAD OPERATIONS, 2L, 2W, 15' TO 24" FROM PAVEMENT EDGE
701011-04	OFF-ROAD MOVING OPERATIONS, 2L, 2W, DAY ONLY
701201-04	LANE CLOSURE, 2L, 2W, DAY ONLY, FOR SPEEDS >= 45 MPH
701301-04	LANE CLOSURE, 2L, 2W, SHORT TIME OPERATIONS
701306-03	LANE CLOSURE, 2L, 2W, SLOW MOVING OPERATIONS DAY ONLY, FOR SPEEDS >= 45 MPH
701311-03	LANE CLOSURE 2L, 2W, MOVING OPERATIONS - DAY ONLY
701326-04	LANE CLOSURE, 2L, 2W, PAVEMENT WIDENING, FOR SPEEDS >= 45 MPH
701901-04	TRAFFIC CONTROL DEVICES
720001-01	SIGN PANEL MOUNTING DETAILS
720006-04	SIGN PANEL ERECTION DETAILS
780001-05	TYPICAL PAVEMENT MARKINGS
781001-03	TYPICAL APPLICATIONS RAISED REFLECTIVE PAVEMENT MARKERS
782001	PRISMATIC CURB REFLECTORS
805001-01	ELECTRICAL SERVICE INSTALLATION DETAILS
814001-03	HANDHOLES
880001-01	SPAN WIRE MOUNTED SIGNALS AND FLASHING BEACON INSTALLATION

GENERAL NOTES

THIS SECTION SHALL BE CONSTRUCTED IN ACCORDANCE WITH THE PLANS; THE "STANDARD SPECIFICATIONS FOR ROAD AND BRIDGE CONSTRUCTION" ADOPTED JANUARY 1, 2012; AND THE SPECIAL PROVISIONS INCLUDED IN THE PROPOSAL.

THIS PROJECT IS LOCATED ON FAP ROUTE 327 (US 50) IN CLAY COUNTY, FROM THE MARION COUNTY LINE TO COUNTY HIGHWAY 6 AT XENIA. THE WORK INCLUDED IN SECTION (12,13,14)RS-3 CONSISTS OF PAVEMENT PATCHING, MILLING, HOT-MIX ASPHALT RESURFACING, HOT-MIX ASPHALT SHOULDERS, AGGREGATE WEDGE SHOULDER, MEDIAN REMOVAL AND REPLACEMENT, PAVEMENT MARKING, AND ANY OTHER WORK NECESSARY TO COMPLETE THE SECTION.

OMIT RUMBLE STRIPS ON ALL SIDEROADS, PRIVATE, AND COMMERCIAL ENTRANCES AT RADIUS RETURNS. OMIT RUMBLE STRIPS AT MAILBOX TURNOUTS 60' BOTH SIDES OF THE MAILBOX OR AS DETERMINED BY THE ENGINEER. THE 60' OMISSIONS EACH SIDE OF A MAILBOX TURNOUT WILL NOT BE MEASURED FOR PAYMENT.

THE MATERIAL USED FOR AGGREGATE WEDGE SHOULDERS, TYPE B SHALL BE CRUSHED STONE, CRUSHED CONCRETE, OR RAP. THE MATERIAL USED FOR AGGREGATE SURFACE COURSE, TYPE B SHALL BE CRUSHED STONE OR CRUSHED CONCRETE.

THE EXISTING PAVEMENT SHALL BE PATCHED IN ACCORDANCE WITH SECTION 442 OF THE STANDARD SPECIFICATIONS AND THE SPECIAL PROVISIONS. THE QUANTITY OF PATCHING SHOWN ON THE PLANS IS AN ESTIMATE ONLY AND THE FINAL LOCATIONS AND QUANTITY SHALL BE DETERMINED BY THE ENGINEER IN THE FIELD. CLASS B PATCHES ARE INCLUDED FOR PATCHING COUNTY HIGHWAY 6 AND CLASS D PATCHES ARE INCLUDED FOR PATCHING U.S. ROUTE 50. PARTIAL DEPTH PAVEMENT PATCHING SHALL BE COMPLETED, AS DETERMINED BY THE RESIDENT ENGINEER, ON BOTH COUNTY HIGHWAY 6 AND U.S. ROUTE 50.

GENERAL NOTES (Cont'd)

THE PAY ITEM TEMPORARY RAMP HAS BEEN INCLUDED FOR THE CONSTRUCTION OF TEMPORARY RAMPS IN ACCORDANCE WITH ARTICLE 406.08 OF THE STANDARD SPECIFICATIONS. THE COST SHALL INCLUDE BOTH THE INSTALLATION AND THE REMOVAL OF THE TEMPORARY RAMPS.

THE RESIDENT ENGINEER SHALL BE THE SOLE JUDGE CONCERNING THE CURING TIME FOR ALL HOT-MIX ASPHALT.

PAVEMENT MARKING SHALL BE APPLIED IN ACCORDANCE WITH SECTION 780 OF THE STANDARD SPECIFICATIONS. SHORT TERM PAVEMENT MARKING SHALL BE APPLIED TO THE MILLED SURFACE, BITUMINOUS MATERIALS (PRIME COAT), LEVELING BINDER AND HOT-MIX ASPHALT SURFACE COURSE AS SPECIFIED IN SECTION 703 OF THE STANDARD SPECIFICATIONS. TEMPORARY TAPE SHALL BE USED ON THE SURFACE COURSE AND PAINT SHALL BE USED ON MILLED SURFACES.

THE TOTAL QUANTITY OF PAINT PAVEMENT MARKING-LINE 4" CONSISTS OF 42,768 FEET OF WHITE AND 14,448 FEET OF YELLOW.

THE TOTAL QUANTITY OF THERMOPLASTIC PAVEMENT MARKING - LINE 8" CONSISTS OF 347 FEET OF WHITE.

THE TOTAL QUANTITY OF THERMOPLASTIC PAVEMENT MARKING - LINE 12" CONSISTS OF 297 FEET OF WHITE.

THE TOTAL QUANTITY OF THERMOPLASTIC PAVEMENT MARKING - LINE 24" CONSISTS OF 60 FEET OF WHITE.

THE TOTAL QUANTITY OF RAISED REFLECTIVE PAVEMENT MARKERS IS 255 TWO-WAY AMBER MARKERS.

THE CONTRACTOR SHALL PROVIDE INTERNET ACCESSIBILITY TO THE HOT-MIX ASPHALT PLANT QUALITY CONTROL LAB SO THAT HOT-MIX ASPHALT PLANT REPORTS CAN BE E-MAILED TO THE DISTRICT HEADQUARTERS. THIS WORK SHALL BE INCLUDED IN THE COST OF ALL HOT-MIX ASPHALT ITEMS.

A UNIFORMLY STRAIGHT SAW CUT SHALL BE MADE AT LOCATIONS WHERE PROPOSED NEW CONSTRUCTION WILL ABUT EXISTING HOT-MIX ASPHALT SURFACES. THE SAW CUT SHALL BE MADE FULL DEPTH THROUGH THE EXISTING SURFACE. THIS WORK WILL BE CONSIDERED INCLUDED IN THE COST OF THE CONTRACT ITEMS INVOLVED AND NO EXTRA COMPENSATION WILL BE ALLOWED.

THE FOLLOWING MIXTURE REQUIREMENTS ARE APPLICABLE FOR THIS PROJECT:

MIXTURE USE:	SURFACE COURSE (1 1/2")	LEVELING BINDER (3/4")
PG GRADE:	PG 64-22	PG 64-22
DESIGN AIR VOIDS:	4.0% @ NDESIGN = 90	4.0% @ NDESIGN = 90
MIXTURE COMPOSITION:	IL-9.5	IL-9.5
FRICTION AGGREGATE:	MIXTURE D	N/A
MIXTURE USE:	INCIDENTAL	CLASS D PATCHING (12")
PG GRADE:	PG 64-22	PG 64-22
DESIGN AIR VOIDS:	4.0% @ NDESIGN = 70	4.0% @ NDESIGN = 70
MIXTURE COMPOSITION:	IL-9.5	IL-19.0
FRICTION AGGREGATE:	MIXTURE C	N/A
MIXTURE USE:	PARTIAL DEPTH PATCHING	HMA SHOULDERS, 8" (TOP 2")
PG GRADE:	PG 64-22	PG 64-22
DESIGN AIR VOIDS:	4.0% @ NDESIGN = 70	4.0% @ NDESIGN = 30
MIXTURE COMPOSITION:	IL-19.0	IL-9.5L
FRICTION AGGREGATE:	N/A	MIXTURE C
MIXTURE USE:	HMA SHOULDERS, 8" (BOTTOM 6")	
PG GRADE:	PG 64-22	
DESIGN AIR VOIDS:	4.0% @ NDESIGN = 30	
MIXTURE COMPOSITION:	IL-19.0L	
FRICTION AGGREGATE:	N/A	

THE FOLLOWING RATES OF APPLICATION HAVE BEEN USED IN CALCULATING PLAN QUANTITIES:

AGGREGATE SURFACE COURSE	2.05 TONS/CU YD
AGGREGATE WEDGE SHOULDERS	2.05 TONS/CU YD
BITUMINOUS MATERIALS (PRIME COAT)	0.05 LBS/SO FT (MILLED SURFACE)
	0.025 LBS/SO FT (BETWEEN HMA LIFTS)
HOT-MIX ASPHALT	112 LBS/SO YD/INCH

FILE NAME =	USER NAME = staffennh	DESIGNED -	REVISED -	STATE OF ILLINOIS DEPARTMENT OF TRANSPORTATION	INDEX OF SHEETS, STANDARDS & GENERAL NOTES	F.A.P. RTE.	SECTION	COUNTY	TOTAL SHEETS	SHEET NO.
p:\VL084EBID\INTEG.illinois.gov\1007\Documents\1007 Offices\District 7\Projects\7479-DRAWING\CD\Drawings\074784-sht-index.dwg	PROJECT = 1007 Offices\District 7\Projects\7479-DRAWING\CD\Drawings\074784-sht-index.dwg	CHECKED -	REVISED -			327	12,13,14RS-3	CLAY	27	2
PLT SCALE = 1/8"=1'-0"	PLT DATE = 10/13/2015	CHECKED -	REVISED -			CONTRACT NO. 74704				
PLT DATE = 10/13/2015	DATE -	CHECKED -	REVISED -			ILLINOIS FED. AID PROJECT				
SCALE: N/A	SHEET 1	OF 1	SHEETS	STA.	TO STA.					

80% FED
20% STATE

80% FED
20% STATE

SUMMARY OF QUANTITIES			TOTAL QUANTITIES	CONSTRUCTION TYPE CODE		
CODE NO	ITEM	UNIT		0005	0021	
35101600	AGGREGATE BASE COURSE, TYPE B 4"	SO YD	26	26		
35300300	PORTLAND CEMENT CONCRETE BASE COURSE 8"	SO YD	26	26		
40200800	AGGREGATE SURFACE COURSE, TYPE B	TON	40	40		
40600275	BITUMINOUS MATERIALS (PRIME COAT)	POUND	39223	39223		
40600645	LEVELING BINDER (MACHINE METHOD), N90	TON	1566	1566		
40600982	HOT-MIX ASPHALT SURFACE REMOVAL - BUTT JOINT	SO YD	276	276		
40600990	TEMPORARY RAMP	SO YD	60	60		
40603345	HOT-MIX ASPHALT SURFACE COURSE, MIX "D", N90	TON	5766	5766		
40800050	INCIDENTAL HOT-MIX ASPHALT SURFACING	TON	57	57		
44003100	MEDIAN REMOVAL	SO FT	236	236		
44004250	PAVED SHOULDER REMOVAL	SO YD	126	126		
44200934	CLASS B PATCHES, TYPE II, 8 INCH	SO YD	240	240		
44201299	DOWEL BARS 1 1/2"	EACH	600	600		
44201789	CLASS D PATCHES, TYPE II, 12 INCH	SO YD	538	538		

SUMMARY OF QUANTITIES			TOTAL QUANTITIES	CONSTRUCTION TYPE CODE		
CODE NO	ITEM	UNIT		0005	0021	
44201794	CLASS D PATCHES, TYPE III, 12 INCH	SO YD	147	147		
44201796	CLASS D PATCHES, TYPE IV, 12 INCH	SO YD	294	294		
44213200	SAW CUTS	FOOT	1440	1440		
48102100	AGGREGATE WEDGE SHOULDER, TYPE B	TON	1898	1898		
48203029	HOT-MIX ASPHALT SHOULDERS, 8"	SO YD	126	126		
64200116	SHOULDER RUMBLE STRIPS, 16 INCH	FOOT	38366	38366		
66700205	PERMANENT SURVEY MARKERS, TYPE I	EACH	7	7		
66700305	PERMANENT SURVEY MARKERS, TYPE II	EACH	2	2		
67000500	ENGINEER'S FIELD OFFICE, TYPE B	CAL MO	4	4		
67100100	MOBILIZATION	L SUM	1	1		
70100450	TRAFFIC CONTROL AND PROTECTION, STANDARD 701201	L SUM	1	1		
70100460	TRAFFIC CONTROL AND PROTECTION, STANDARD 701306	L SUM	1	1		

12

80% FED
20% STATE

80% FED
20% STATE

SUMMARY OF QUANTITIES			TOTAL QUANTITIES	CONSTRUCTION TYPE CODE	
CODE NO	ITEM	UNIT		0005	0021
70100500	TRAFFIC CONTROL AND PROTECTION, STANDARD	L-SUM	1	1	
	701326				
70300100	SHORT TERM PAVEMENT MARKING	FOOT	7234	7234	
70300220	TEMPORARY PAVEMENT MARKING - LINE 4"	FOOT	53620	53620	
70300280	TEMPORARY PAVEMENT MARKING - LINE 24"	FOOT	60	60	
70301000	WORK ZONE PAVEMENT MARKING REMOVAL	SO FT	680	680	
* 73000100	WOOD SIGN SUPPORT	FOOT	67	67	
* 78000500	THERMOPLASTIC PAVEMENT MARKING - LINE 8"	FOOT	347	347	
* 78000600	THERMOPLASTIC PAVEMENT MARKING - LINE 12"	FOOT	297	297	
* 78000650	THERMOPLASTIC PAVEMENT MARKING - LINE 24"	FOOT	60	60	
* 78001110	PAINT PAVEMENT MARKING - LINE 4"	FOOT	57216	57216	
* 78100100	RAISED REFLECTIVE PAVEMENT MARKER	EACH	255	255	
* 78200300	PRISMATIC CURB REFLECTOR	EACH	20	20	
* 81028340	UNDERGROUND CONDUIT, PVC, 1 1/2" DIA.	FOOT	1612	1612	

SUMMARY OF QUANTITIES			TOTAL QUANTITIES	CONSTRUCTION TYPE CODE	
CODE NO	ITEM	UNIT		0005	0021
* 81028350	UNDERGROUND CONDUIT, PVC, 2" DIA.	FOOT	35	35	
* 81100500	CONDUIT ATTACHED TO STRUCTURE, 1 1/2" DIA., GALVANIZED STEEL	FOOT	59	59	
* 81400100	HANDHOLE	EACH	1	1	
* 81500100	GULFBOX JUNCTION	EACH	5	5	
* 85800100	FLASHER CONTROLLER	EACH	1	1	
* 87301225	ELECTRIC CABLE IN CONDUIT, SIGNAL NO. 14	30 FOOT	1766	1766	
* 87301805	ELECTRIC CABLE IN CONDUIT, SERVICE, NO. 6	FOOT	42	42	
	2 C				
* 88040030	SIGNAL HEAD, POLYCARBONATE, LED, 1-FACE, 1-SECTION, POST MOUNTED	EACH	4	4	
* 89502400	REMOVE EXISTING FLASHING BEACON INSTALLATION	EACH	1	1	
	COMPLETE				
X4401198	HOT-MIX ASPHALT SURFACE REMOVAL, VARIABLE DEPTH	SO YD	68366	68366	
X4406210	PARTIAL DEPTH REMOVAL, TYPE II, VARIABLE DEPTH	SO YD	746	746	

* SPECIALTY ITEM

80% FED
20% STATE

SUMMARY OF QUANTITIES			TOTAL QUANTITIES	CONSTRUCTION TYPE CODE		
CODE NO	ITEM	UNIT		0005	0021	
X4406410	PARTIAL DEPTH REMOVAL, TYPE III, VARIABLE DEPTH	SO YD	1119	1119		
X4406610	PARTIAL DEPTH REMOVAL, TYPE IV, VARIABLE DEPTH	SO YD	5593	5593		
X4421000	PARTIAL DEPTH PATCHING	TON	1671	1671		
X6061702	CONCRETE MEDIAN, TYPE SM (DOWELLED)	SO FT	257	257		
X7015005	CHANGEABLE MESSAGE SIGN	CAL DA	28	28		
* X7240600	REMOVE AND RE-ERECT EXISTING SIGN	EACH	8		8	
* X7830076	GROOVING FOR RECESSED PAVEMENT MARKING 9"	FOOT	347	347		
* X7830078	GROOVING FOR RECESSED PAVEMENT MARKING 13"	FOOT	297	297		
* X7830090	GROOVING FOR RECESSED PAVEMENT MARKING 25"	FOOT	60	60		
* X8050115	SERVICE INSTALLATION, TYPE A (MODIFIED)	EACH	1		1	

SUMMARY OF QUANTITIES			TOTAL QUANTITIES	CONSTRUCTION TYPE CODE		
CODE NO	ITEM	UNIT		0005	0021	

TYPICAL CROSS SECTION

STA. 482+84 TO STA. 491+00

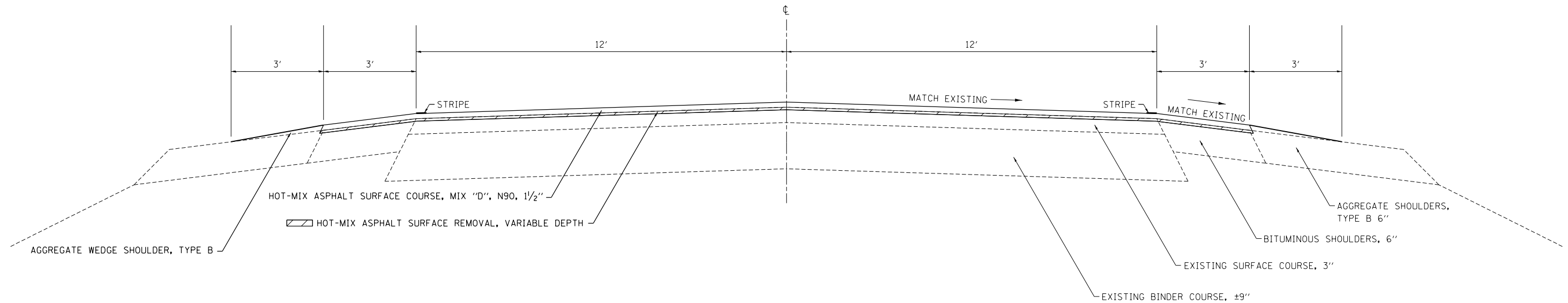

NOTE: NOT DRAWN TO SCALE

TYPICAL CROSS SECTION

STA. 491+00 TO STA. 602+85

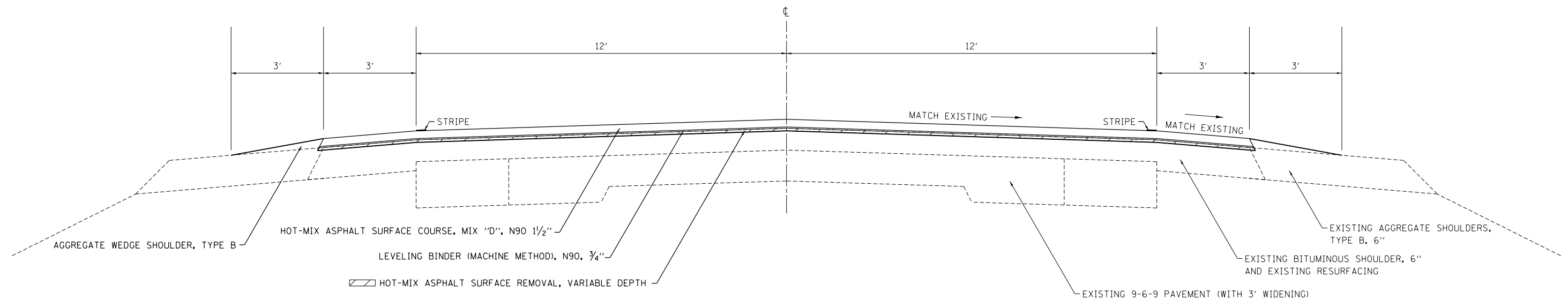

NOTE: NOT DRAWN TO SCALE

FILE NAME =	USER NAME = steffenmk	DESIGNED -	REVISED -
pw:\IL\084EBIDINTEG\illinois.gov\PWIDOT\Documents\IDOT Offices\District 7\Projects\7479\Drawings\CAD\Sheets\0774704-sht-typicals.dwg		DRAWN -	REVISED -
Default	PLOT SCALE = 100.0000' / in.	CHECKED -	REVISED -
	PLOT DATE = 10/13/2015	DATE -	REVISED -

STATE OF ILLINOIS
DEPARTMENT OF TRANSPORTATION

TYPICAL CROSS SECTIONS

SCALE: N/A SHEET 1 OF 2 SHEETS STA. TO STA.

F.A.P. RTE.	SECTION	COUNTY	TOTAL SHEETS	SHEET NO.
327	(12,13,14)RS-3	CLAY	27	6
CONTRACT NO. 74704				
ILLINOIS FED. AID PROJECT				

TYPICAL CROSS SECTION

STATION EQUATION: STA. 602+85 TO STA. 603+94.49
 STA. 603+94.49BK = STA. 117+21.40AH
 STA. 117+21.40 TO STA. 195+32

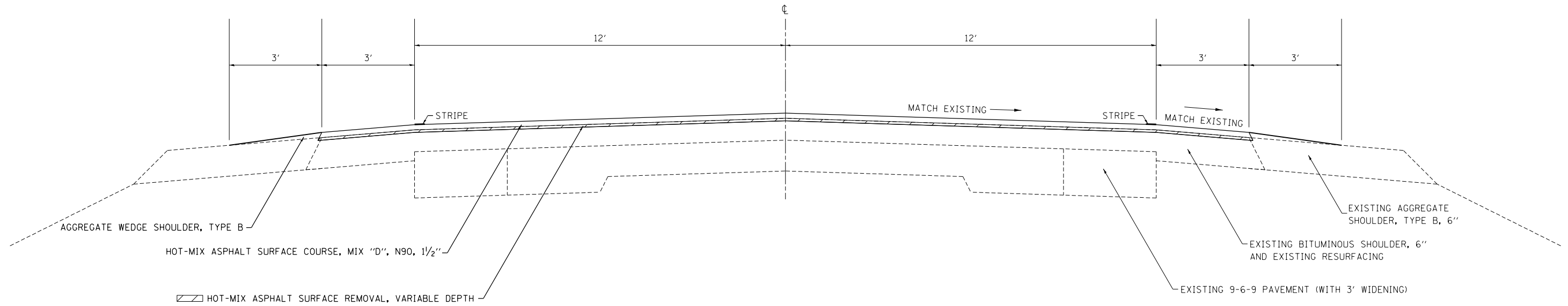

NOTE: NOT DRAWN TO SCALE

TYPICAL CROSS SECTION - C.H. 6

STA. 56+52 TO STA. 60+62

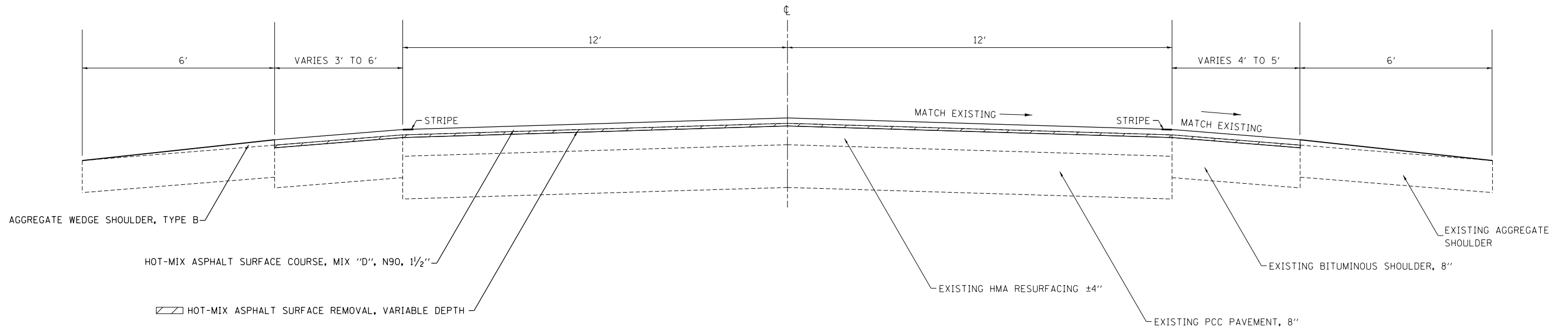

NOTE: NOT DRAWN TO SCALE

FILE NAME =	USER NAME = steffenmk	DESIGNED -	REVISED -
pw:\IL\084EBIDINTEG\illinois.gov\PWIDOT\Documents\IDOT Offices\District 7\Projects\7479\Drawings\CAD\Sheets\0774704-sht-typicals.dwg		DRAWN -	REVISED -
Default	PLOT SCALE = 100.0000' / 1in.	CHECKED -	REVISED -
	PLOT DATE = 10/13/2015	DATE -	REVISED -

STATE OF ILLINOIS
 DEPARTMENT OF TRANSPORTATION

TYPICAL CROSS SECTIONS

SCALE: N/A SHEET 2 OF 2 SHEETS STA. TO STA.

F.A.P. RTE.	SECTION	COUNTY	TOTAL SHEETS	SHEET NO.
327	(12,13,14)RS-3	CLAY	27	7
CONTRACT NO. 74704				
ILLINOIS FED. AID PROJECT				

RESURFACING SCHEDULE			LENGTH	WIDTH	AREA	HOT-MIX ASPHALT SURFACE REMOVAL - BUTT JOINT	TEMPRARY RAMPS	HOT-MIX ASPHALT SURFACE REMOVAL, VARIABLE DEPTH	BITUMINOUS MATERIALS (PRIME COAT)	LEVEING BINDER (MACHINE METHOD), N90	HOT-MIX ASPHALT SURFACE COURSE, MIX "D", N90	PAVED SHOULDER REMOVAL	HOT-MIX ASPHALT SHOULDERS, 8"	SHOULDER RUMBLE STRIPS, 8 INCH	AGGREGATE WEDGE SHOULDER, TYPE B	
STATION TO	STATION	FOOT	FOOT	SQ YD	SQ YD	SQ YD	SQ YD	SQ YD	POUND	TON	TON	SQ YD	SQ YD	FOOT	TON	
US 50																
482+84	TO 483+04	20.0	30	66.7	66.7	16.7	-	30.0	-	5.6	-	-	-	40.0	1.9	
483+04	TO 491+00	796.0	30	2653.3	-	-	2653.3	1194.0	-	222.9	-	-	-	1592.0	75.5	
491+00	TO 602+85	11185.0	30	37283.3	-	-	37283.4	25166.3	1565.9	3131.8	-	-	-	21712.0	1032.7	
602+85	TO 603+93.88	108.9	30	362.9	-	-	362.9	163.3	-	30.5	-	-	-	217.8	10.3	
603+93.88	TO 117+21.40	STATION EQUATION				-	-	-	-	-	-	-	-	-	-	-
117+21.40	TO 191+47.6	7426.2	30	24754.0	-	-	24754.0	11139.3	-	2079.3	-	-	-	14540.4	691.4	
191+47.6	TO 192+08.9	61.3	27	183.9	-	-	183.9	82.8	-	15.4	-	-	-	61.3	2.9	
192+08.9	TO 192+21.7	12.8	27	38.4	-	-	34.1	15.4	-	2.9	6.5	6.5	-	12.8	0.7	
192+21.7	TO 193+96.6	174.9	24	466.4	-	-	466.4	209.9	-	39.2	-	-	-	-	-	
193+96.6	TO 194+77.3	80.7	27	242.1	-	-	242.1	108.9	-	20.3	-	-	-	80.7	3.8	
194+77.3	TO 195+12	34.7	30	115.7	-	-	115.7	52.1	-	9.7	-	-	-	69.4	3.3	
195+12	TO 195+32	20.0	30	66.7	66.7	16.7	-	30.0	-	5.6	-	-	-	40.0	1.9	
US 50 TOTALS:		19920.5	-	66233.4	133.4	33.4	66095.8	38192.0	1565.9	5563.2	6.5	6.5	38366.4	1824.4		
C. H. 6																
56+52	TO 56+72	20.0	32	71.1	71.1	13.3	-	32.0	-	6.0	-	-	-	-	3.8	
56+72	TO 57+10	38.0	32	135.1	-	-	135.1	6.8	-	11.3	-	-	-	-	7.2	
57+10	TO 57+41.9	31.9	32	113.4	-	-	99.3	44.7	-	8.3	17.7	17.7	-	-	6.1	
57+41.9	TO 58+54.3	112.4	VARIES	949.4	-	-	874.6	393.6	-	73.5	102.0	102.0	-	-	21.3	
58+54.3	TO 58+78.4	US 50				-	-	-	-	-	-	-	-	-	-	
58+78.4	TO 59+89.8	111.4	VARIES	975.2	-	-	975.2	438.8	-	81.9	-	-	-	-	21.1	
59+89.8	TO 60+42	52.2	32	185.6	-	-	185.6	83.5	-	15.6	-	-	-	-	9.9	
60+42	TO 60+62	20.0	32	71.1	71.1	13.3	-	32.0	-	6.0	-	-	-	-	3.8	
C. H. 6 TOTALS:		385.9	-	2501.0	142.2	26.6	2269.8	1031.4	0.0	202.6	119.7	119.7	0.0	73.2		
TOTALS:		20306	-	68734	276	60	68366	39223	1566	5766	126	126	38366	1898		

SURVEY MARKER SCHEDULE		PERMANENT SURVEY MARKERS, TYPE I	PERMANENT SURVEY MARKERS, TYPE II	
STATION	OFFSET (FOOT)	DESCRIPTION	QUANTITY (EACH)	QUANTITY (EACH)
498+00.09	0	IDOT DISK	1	
518+00.09	2.0' RT.	IDOT DISK	1	
571+00.09	0	IDOT DISK	1	
588+20.09	16.5' LT.	BENT PIN BURIED 8"		1
592+41.08	0	IDOT DISK	1	
603+93.88 (FAP 327) = 451+02.40 (SBI 12) = 117+21.40 (FAP 99)	0	IDOT DISK (PC)	1	
120+93	18.0' RT.	IDOT DISK IN CONCRETE IN AGGREGATE SHOULDER		1
124+63	0	IDOT DISK	1	
136+00	0	IDOT DISK	1	
TOTAL =			7	2

MEDIAN SCHEDULE		MEDIAN REMOVAL	AGGREGATE BASE COURSE, TYPE B, 4"	PORTLAND CEMENT CONCRETE BASE COURSE, 8"	CONCRETE MEDIAN, TYPE SM (DOWELLED)	PRISMATIC CURB REFLECTORS
STATION	(SQ FT)	(SQ YD)	(SQ YD)	(SQ FT)	(EACH)	
C. H. 6						
58+34	112.8	12.5	12.5	-	-	
58+38	-	-	-	129.7	10	
58+95	-	-	-	127.2	10	
59+05	123.2	13.7	13.7	-	-	
TOTALS:	236	26	26	257	20	

PAVEMENT MARKING SCHEDULE			LENGTH	SHORT-TERM PAVEMENT MARKING	WORK ZONE PAVEMENT MARKING REMOVAL	PAINT PAVEMENT MARKING - LINE 4"	TEMPORARY PAVEMENT MARKING - LINE 4"	THERMOPLASTIC PAVEMENT MARKING - LINE 8"	GROOVING FOR RECESSED PAVEMENT MARKING 9"	THERMOPLASTIC PAVEMENT MARKING - LINE 12"	GROOVING FOR RECESSED PAVEMENT MARKING 13"	THERMOPLASTIC PAVEMENT MARKING - LINE 24"	GROOVING FOR RECESSED PAVEMENT MARKING 25"	TEMPORARY PAVEMENT MARKING - LINE 24"	RAISED REFLECTIVE PAVEMENT MARKERS
STATION	TO	STATION	FOOT	FOOT	SQ FT	FOOT	FOOT	FOOT	FOOT	FOOT	FOOT	FOOT	FOOT	FOOT	EACH
US 50															
482+84	TO	491+40	856.0	260.8	28.5	2782.0	2782.0	-	-	-	-	-	-	-	11.0
491+40	TO	560+27	6887.0	2754.8	229.6	15366.8	15366.8	-	-	-	-	-	-	-	86.0
560+27	TO	566+14	587.0	234.8	19.6	1907.8	1907.8	-	-	-	-	-	-	-	7.0
566+14	TO	570+02	388.0	155.2	12.9	873.0	873.0	-	-	-	-	-	-	-	5.0
570+02	TO	576+24	622.0	248.7	20.7	2643.5	2643.5	-	-	-	-	-	-	-	8.0
576+24	TO	603+93.88	2769.9	1097.1	92.3	6064.2	6064.2	-	-	-	-	-	-	-	35.0
603+93.88	TO	117+21.40	STATION EQUATION			-	-	-	-	-	-	-	-	-	-
117+21.40	TO	123+22	600.6	180.2	20.0	1351.4	1351.4	-	-	-	-	-	-	-	8.0
123+22	TO	133+14	992.0	297.6	33.1	3224.0	3224.0	-	-	-	-	-	-	-	12.0
133+14	TO	136+99	385.0	115.5	12.8	1300.0	1300.0	-	-	-	-	-	-	-	5.0
136+99	TO	145+92	893.0	267.9	29.8	2902.3	2902.3	-	-	-	-	-	-	-	11.0
145+92	TO	169+64	2372.0	711.6	79.1	5337.0	5337.0	-	-	-	-	-	-	-	30.0
169+64	TO	179+88	1024.0	307.2	34.1	3328.0	3328.0	-	-	-	-	-	-	-	13.0
179+88	TO	195+32	1544.0	463.2	51.5	5672.0	5672.0	-	-	-	-	-	-	-	19.0
US 50 TOTALS:			19920.5	7094.6	664.0	52752.0	52752.0	0.0	0.0	0.0	0.0	0.0	0.0	0.0	250.0
C. H. 6															
40+54	TO	56+52	1598.0	-	-	3595.5	-	-	-	-	-	-	-	-	-
56+52	TO	58+54.3	202.3	84.7	9.4	455.2	455.2	172.0	172.0	154.0	154.0	30.0	30.0	30.0	3.0
58+54.3	TO	58+78.4	US 50			-	-	-	-	-	-	-	-	-	-
58+78.4	TO	60+62	183.6	55.1	6.1	413.1	413.1	175.0	175.0	143.0	143.0	30.0	30.0	30.0	2.0
C. H. 6 TOTALS:			1983.9	139.8	15.5	4463.8	868.3	347.0	347.0	297.0	297.0	60.0	60.0	60.0	5.0
TOTALS:			21904	7234	680	57216	53620	347	347	297	297	60	60	60	255

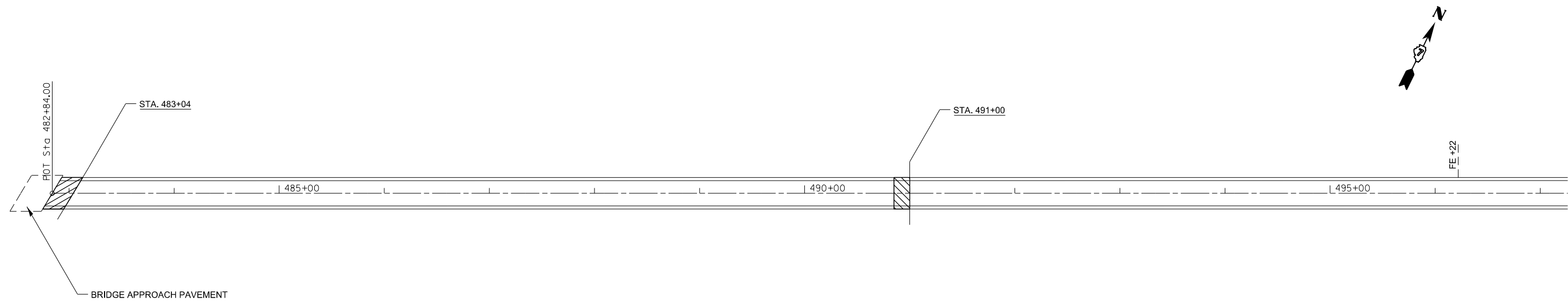

- HOT-MIX ASPHALT SURFACE REMOVAL - BUTT JOINT
- SEE TRANSITION DETAIL PG. 19

NOTE: STATION ON PLAQUE OF SN 013-0036 DOES NOT MATCH ROADWAY STATIONING

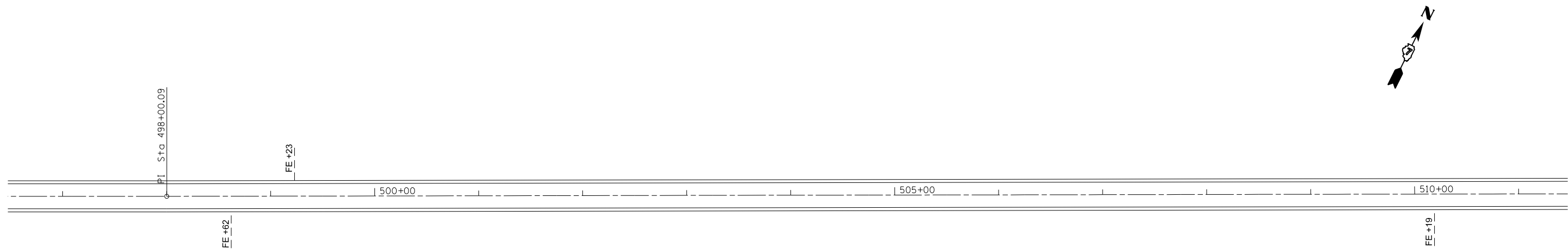

FILE NAME =	USER NAME = steffenmk	DESIGNED -	REVISED -
p:\11\084EBIDINTEG.illinois.gov\PI\DOT\Documents\DOT Offices\District 7\Projects\7479\Drawings\CAD\Sheets\0774704-sht-plan.dgn		DRAWN -	REVISED -
Default	PLOT SCALE = 100.0000' / in.	CHECKED -	REVISED -
	PLOT DATE = 10/13/2015	DATE -	REVISED -

**STATE OF ILLINOIS
DEPARTMENT OF TRANSPORTATION**

PLAN SHEET

SCALE: 50 SHEET 1 OF 8 SHEETS STA. 482+84 TO STA. 511+00

F.A.P. RTE.	SECTION	COUNTY	TOTAL SHEETS	SHEET NO.
327	(12,13,14)RS-3	CLAY	27	11
				CONTRACT NO. 74704
ILLINOIS FED. AID PROJECT				

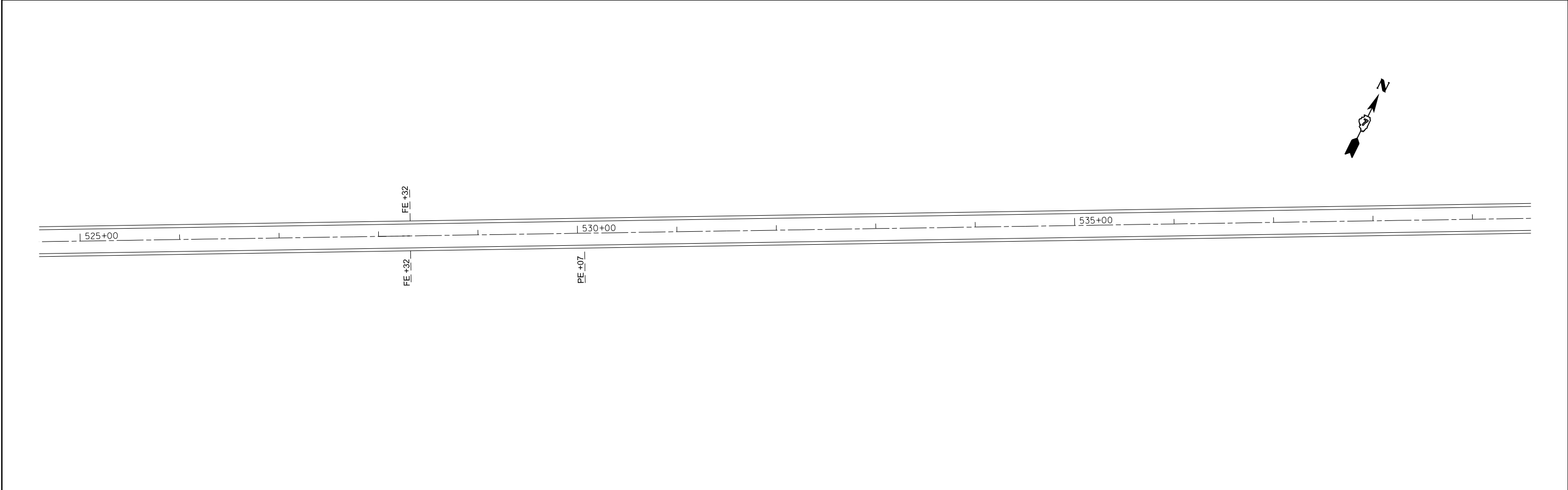
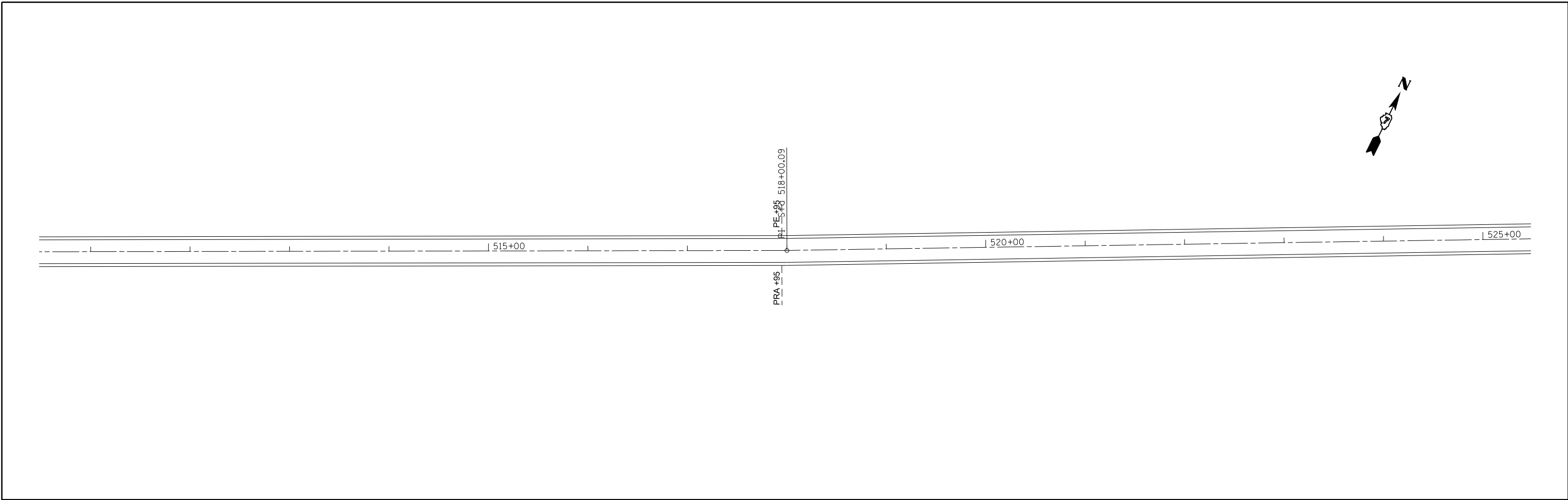

FILE NAME =	USER NAME = steffenk	DESIGNED -	REVISED -
p:\11\084EBIDINTEG.illinois.gov\PWIDOT\Documents\IDOT Offices\District 7\Projects\7479\Drawings\CADsheets\0774704-sht-plan.dgn		DRAWN -	REVISED -
Default	PLOT SCALE = 100.0000' / in.	CHECKED -	REVISED -
	PLOT DATE = 10/13/2015	DATE -	REVISED -

**STATE OF ILLINOIS
DEPARTMENT OF TRANSPORTATION**

PLAN SHEET

SCALE: 50 SHEET 2 OF 8 SHEETS STA. 511+00 TO STA. 539+00

F.A.P. RTE.	SECTION	COUNTY	TOTAL SHEETS	SHEET NO.
327	(12,13,14)RS-3	CLAY	27	12
CONTRACT NO. 74704				
ILLINOIS FED. AID PROJECT				

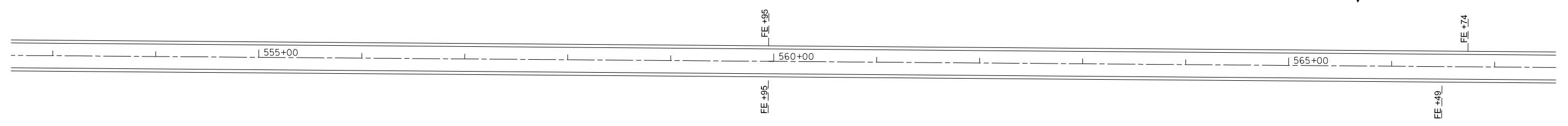
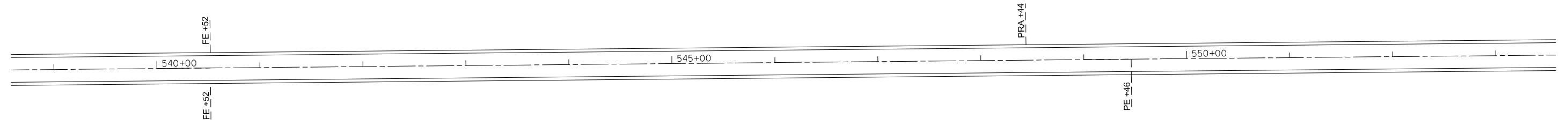

FILE NAME =	USER NAME = steffenmk	DESIGNED -	REVISED -
p:\11\084EBIDINTEG.illinois.gov\PWIDOT\Documents\IDOT Offices\District 7\Projects\74704\Drawings\CAD\Sheets\0774704-sht-plan.dgn		DRAWN -	REVISED -
Default	PLOT SCALE = 100.0000' / in.	CHECKED -	REVISED -
	PLOT DATE = 10/13/2015	DATE -	REVISED -

**STATE OF ILLINOIS
DEPARTMENT OF TRANSPORTATION**

PLAN SHEET

SCALE: 50 SHEET 3 OF 8 SHEETS STA. 539+00 TO STA. 567+00

F.A.P. RTE.	SECTION	COUNTY	TOTAL SHEETS	SHEET NO.
327	(12,13,14)RS-3	CLAY	27	13
CONTRACT NO. 74704				
ILLINOIS FED. AID PROJECT				

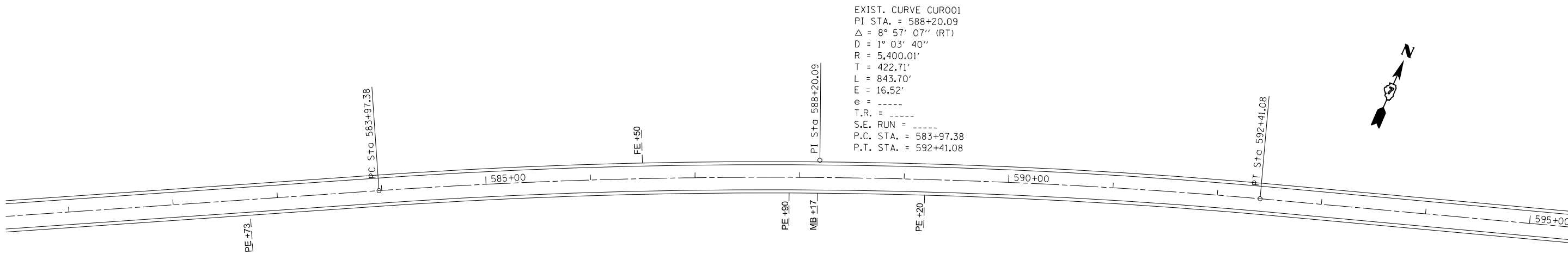
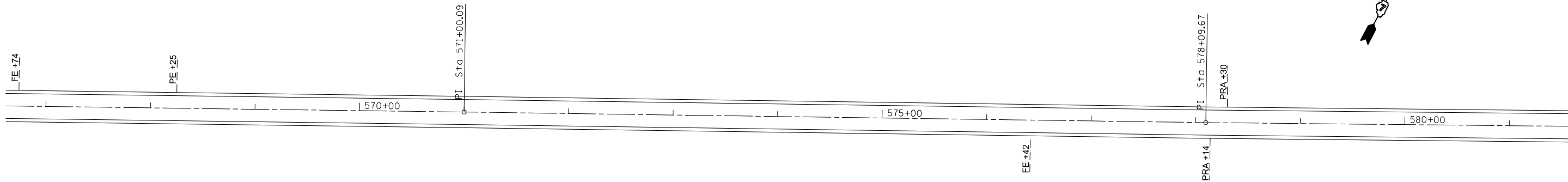

EXIST. CURVE CUR001
 PI STA. = 588+20.09
 Δ = 8° 57' 07" (RT)
 D = 1° 03' 40"
 R = 5,400.01'
 T = 422.71'
 L = 843.70'
 E = 16.52'
 e = -----
 T.R. = -----
 S.E. RUN = -----
 P.C. STA. = 583+97.38
 P.T. STA. = 592+41.08

FILE NAME =	USER NAME = steffenmk	DESIGNED -	REVISED -
p:\11\084EBIDINTEG.illinois.gov\PWIDOT\Documents\DOT Offices\District 7\Projects\7479\Drawings\CAD\Sheets\0774704-sht-plan.dgn		DRAWN -	REVISED -
Default	PLOT SCALE = 100.0000' / in.	CHECKED -	REVISED -
	PLOT DATE = 10/13/2015	DATE -	REVISED -

**STATE OF ILLINOIS
 DEPARTMENT OF TRANSPORTATION**

PLAN SHEET

SCALE: 50 SHEET 4 OF 8 SHEETS STA. 567+00 TO STA. 595+00

F.A.P. RTE.	SECTION	COUNTY	TOTAL SHEETS	SHEET NO.
327	(12,13,14)RS-3	CLAY	27	14
CONTRACT NO. 74704				
ILLINOIS FED. AID PROJECT				

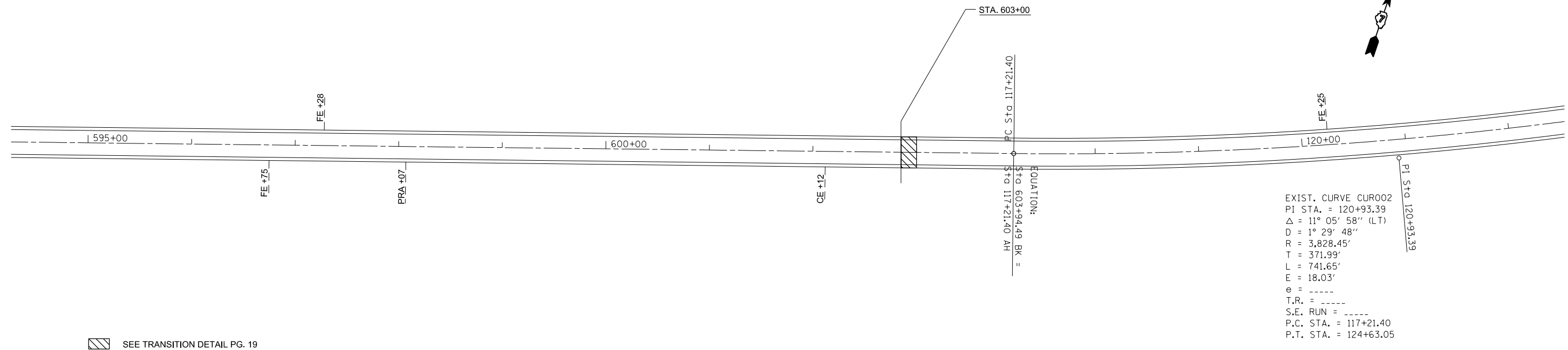

SEE TRANSITION DETAIL PG. 19

EXIST. CURVE CUR002
 PI STA. = 120+93.39
 Δ = 11° 05' 58" (LT)
 D = 1° 29' 48"
 R = 3,828.45'
 T = 371.99'
 L = 741.65'
 E = 18.03'
 e = -----
 T.R. = -----
 S.E. RUN = -----
 P.C. STA. = 117+21.40
 P.T. STA. = 124+63.05

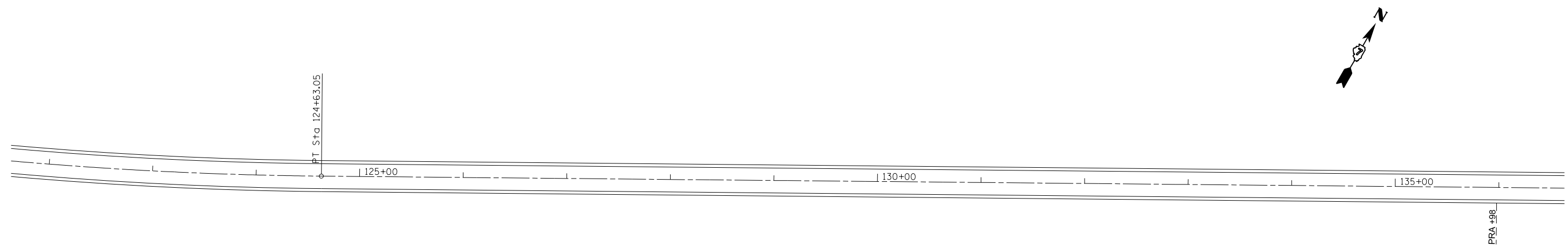

FILE NAME =	USER NAME = steffenmk	DESIGNED -	REVISED -
pw:\IL\084EBIDINTEG.illinois.gov\PWIDOT\Documents\DOT Offices\District 7\Projects\7479\Drawings\CAD\Sheets\0774704-sht-plan.dgn	DRAWN	CHECKED -	REVISED -
Default	PLOT SCALE = 100.0000' / in.	DATE -	REVISED -
	PLOT DATE = 10/13/2015		

**STATE OF ILLINOIS
 DEPARTMENT OF TRANSPORTATION**

PLAN SHEET
 SCALE: 50 SHEET 5 OF 8 SHEETS STA. 595+00 TO STA. 136+00

F.A.P. RTE.	SECTION	COUNTY	TOTAL SHEETS	SHEET NO.
327	(12,13,14)RS-3	CLAY	27	15
CONTRACT NO. 74704				
ILLINOIS FED. AID PROJECT				

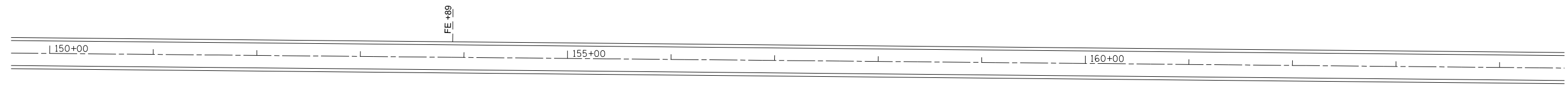
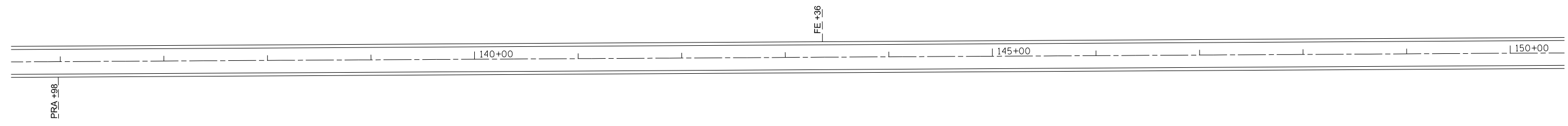

FILE NAME =	USER NAME = steffenk	DESIGNED -	REVISED -
pw:\IL084EBIDINTEG.illinois.gov\PWIDOT\Documents\IDOT Offices\District 7\Projects\7479\Drawings\CAD\Sheets\0774704-sht-plan.dgn		DRAWN -	REVISED -
Default	PLOT SCALE = 100.0000' / in.	CHECKED -	REVISED -
	PLOT DATE = 10/13/2015	DATE -	REVISED -

**STATE OF ILLINOIS
DEPARTMENT OF TRANSPORTATION**

PLAN SHEET

SCALE: 50 SHEET 6 OF 8 SHEETS STA. 136+00 TO STA. 164+00

F.A.P. RTE.	SECTION	COUNTY	TOTAL SHEETS	SHEET NO.
327	(12,13,14)RS-3	CLAY	27	16
				CONTRACT NO. 74704
ILLINOIS FED. AID PROJECT				

EXIST. CURVE CUR003
 PI STA. = 177+92.49
 Δ = 31° 49' 58" (RT)
 D = 1° 30' 00"
 R = 3,820.00'
 T = 1,089.34'
 L = 2,122.35'
 E = 152.29'
 e = -----
 T.R. = -----
 S.E. RUN = -----
 P.C. STA. = 167+03.15
 P.T. STA. = 188+25.49



PI Sta 177+92.49

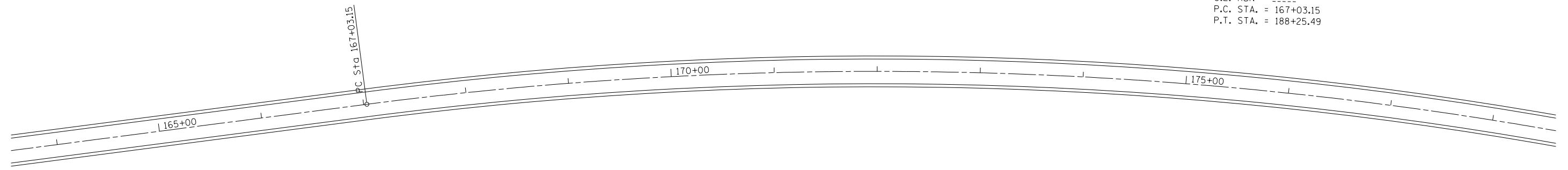

PI Sta 177+92.49

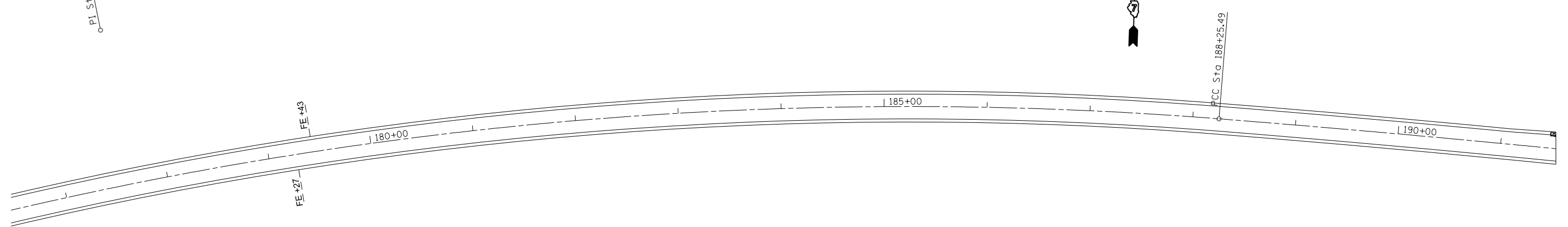

FILE NAME =	USER NAME = steffenmk	DESIGNED -	REVISED -
pw:\IL084EBIDINTEG.illinois.gov\PWIDOT\Documents\IDOT Offices\District 7\Projects\7479\Drawings\CAD\Sheets\0774704-sht-plan.dgn		DRAWN -	REVISED -
Default	PLOT SCALE = 100.0000' / in.	CHECKED -	REVISED -
	PLOT DATE = 10/13/2015	DATE -	REVISED -

**STATE OF ILLINOIS
 DEPARTMENT OF TRANSPORTATION**

PLAN SHEET

SCALE: 50 SHEET 7 OF 8 SHEETS STA. 164+00 TO STA. 188+00

F.A.P. RTE.	SECTION	COUNTY	TOTAL SHEETS	SHEET NO.
327	(12,13,14)RS-3	CLAY	27	17
				CONTRACT NO. 74704
ILLINOIS FED. AID PROJECT				

DETAIL A

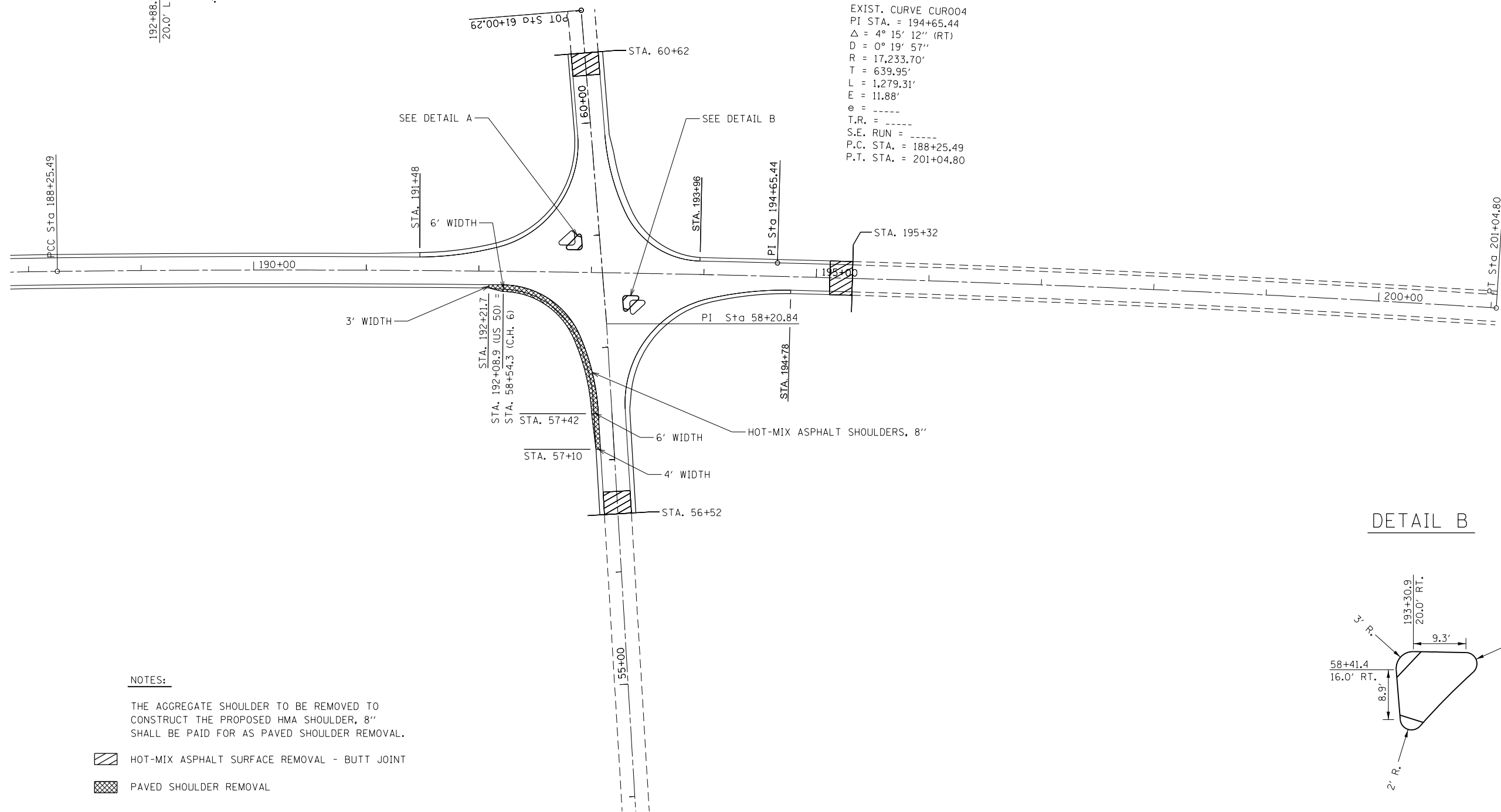
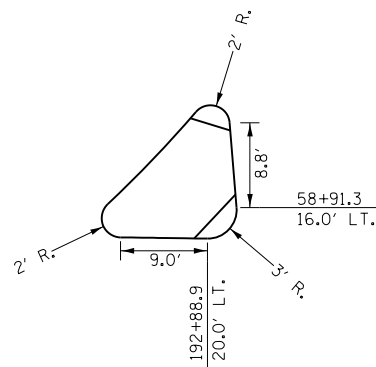

EXIST. CURVE CUR004
 PI STA. = 194+65.44
 $\Delta = 4^\circ 15' 12''$ (RT)
 $D = 0^\circ 19' 57''$
 $R = 17,233.70'$
 $T = 639.95'$
 $L = 1,279.31'$
 $E = 11.88'$
 $e = \text{-----}$
 $T.R. = \text{-----}$
 $S.E. \text{ RUN} = \text{-----}$
 $P.C. \text{ STA.} = 188+25.49$
 $P.T. \text{ STA.} = 201+04.80$



NOTES:

THE AGGREGATE SHOULDER TO BE REMOVED TO CONSTRUCT THE PROPOSED HMA SHOULDER, 8" SHALL BE PAID FOR AS PAVED SHOULDER REMOVAL.

- HOT-MIX ASPHALT SURFACE REMOVAL - BUTT JOINT
- PAVED SHOULDER REMOVAL

DETAIL B

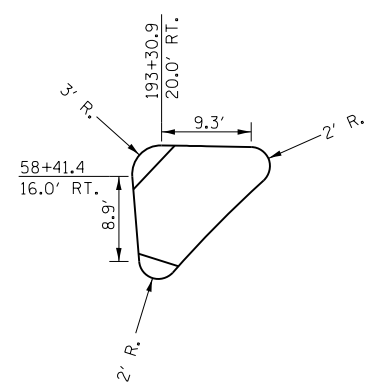

FILE NAME =	USER NAME = steffenmk	DESIGNED -	REVISED -	STATE OF ILLINOIS DEPARTMENT OF TRANSPORTATION	PLAN SHEET			F.A.P. RTE.	SECTION	COUNTY	TOTAL SHEETS	SHEET NO.				
pw:\IL\084EBIDINTEG\Illinois.gov\PI\DOT\Documents\DOT Offices\District 7\Projects\7479\Drawings\CAD\Sheets\0774704-sht-plan.dgn								SCALE: 50			SHEET 8	OF 8 SHEETS	STA. 188+00	TO STA. 201+00	327	(12,13,14)RS-3
Default	PLOT SCALE = 100.0000' / in.	CHECKED -	REVISED -		CONTRACT NO. 74704			ILLINOIS FED. AID PROJECT								
	PLOT DATE = 10/13/2015	DATE -	REVISED -													

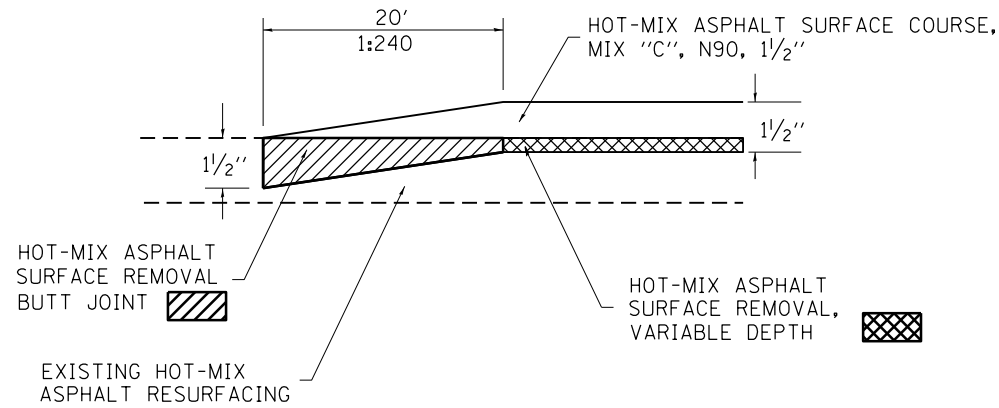

BUTT JOINT DETAIL

US 50
 STA. 482+84.0 TO STA. 483+04.0
 STA. 195+12.0 TO STA. 195+32.0
 CH 6
 STA. 56+52 TO STA. 56+72
 STA. 60+42 TO STA. 60+62

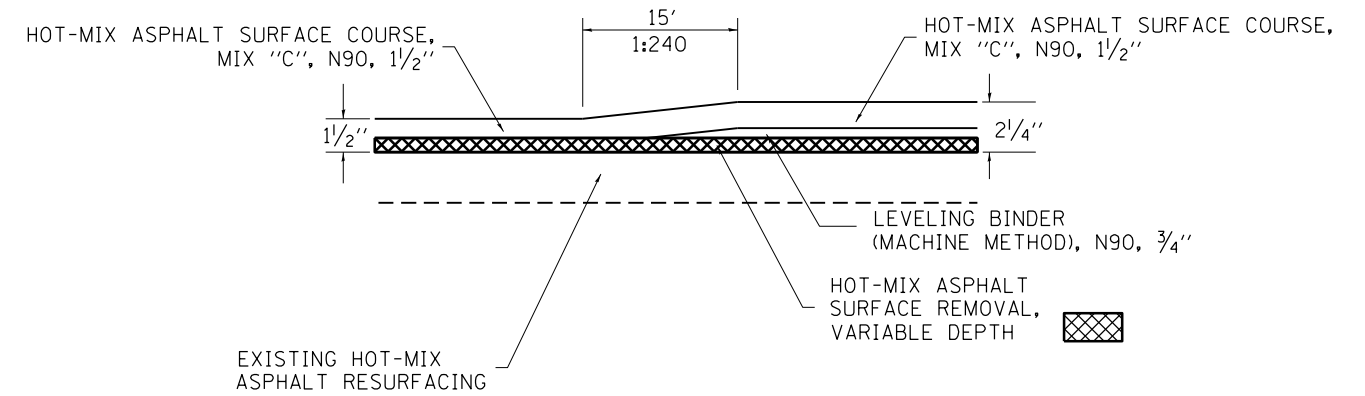

TRANSITION DETAIL

STA. 490+85.0 TO STA. 491+00.0
 STA. 602+85.0 TO STA. 603+00.0

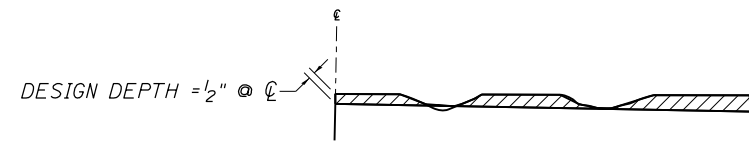

NOTES:

1. MILLING SHALL BE DONE TO ATTAIN A 3/16 "/FT. SLOPE IN CROWN SECTIONS
2. EXISTING S.E. AND S.E. TRANSITIONS SHALL BE MAINTAINED UNLESS OTHERWISE SHOWN ON THE PLANS.
3. MILLING TO THE BOTTOM OF WHEEL RUTS SHALL NOT BE NECESSARY UNLESS REQUIRED TO OBTAIN SLOPE OR THE DESIGN DEPTH AT CENTERLINE.
4. THE AVERAGE DEPTH OF MILLING IS ESTIMATED TO BE 1/2" BUT MAY VARY IN ISOLATED LOCATIONS.

HOT-MIX ASPHALT SURFACE REMOVAL (VARIABLE DEPTH) DETAIL

FILE NAME =	USER NAME = steffenmk	DESIGNED -	REVISED -	STATE OF ILLINOIS DEPARTMENT OF TRANSPORTATION	CONSTRUCTION DETAILS			F.A.P. RTE.	SECTION	COUNTY	TOTAL SHEETS	SHEET NO.
pw:\11\084EBIDINTEG.illinois.gov\PWIDOT\Documents\IDOT Offices\District 7\Projects\7479\Drawings\CABsheets\0774704-sht-details.dgn	DATE = 10/13/2015	CHECKED -	REVISED -					327	(12,13,14)RS-3	CLAY	27	19
PLOT SCALE = 100.0000' / in.	DATE -	REVISIONS	REVISIONS		CONTRACT NO. 74704							
PLOT DATE = 10/13/2015	DATE -	REVISIONS	REVISIONS		SCALE: NA	SHEET NO. 1 OF 1 SHEETS	STA.	TO STA.	ILLINOIS FED. AID PROJECT			

GENERAL NOTES

THIS PROJECT IS LOCATED AT THE INTERSECTION OF FAP 327 (US RTE 50) AND CH 6 (XENIA ROAD), NORTH OF THE VILLAGE OF XENIA, COUNTY OF CLAY. THIS PORTION OF THE PROJECT CONSISTS OF THE INSTALLATION OF A NEW FLASHING BEACON SYSTEM AND ALL OTHER WORK NECESSARY TO COMPLETE THE SYSTEM.

THE LOCATIONS OF ALL FLASHING BEACON COMPONENTS AS SHOWN ON THE PLANS ARE APPROXIMATE ONLY. THE FINAL LOCATIONS SHALL BE DETERMINED BY THE ENGINEER IN THE FIELD.

THE EXISTING UTILITY LINES ARE SHOWN ON THE PLANS TO INDICATE THEIR PRESENCE AND APPROXIMATE LOCATION. THE CONTRACTOR SHALL VERIFY THE EXACT LOCATION OF ALL UNDERGROUND UTILITIES PRIOR TO BEGINNING CONSTRUCTION. CALL J.U.L.I.E. AT 1-800-892-0123.

THE TRAFFIC SIGNAL ENGINEER AT THE ILLINOIS DEPARTMENT OF TRANSPORTATION SHALL BE NOTIFIED AT 217-342-3951 AT LEAST 72 HOURS PRIOR TO TURNING ON ANY FLASHER OR CONTROLLER UNIT.

THE SIZE OF THE CABLE SUPPLIED SHALL BE EQUAL TO OR GREATER THAN THE SIZE OF THE CABLE REQUIRED TO CARRY THE LOAD BETWEEN THE CONTROLLER AND THE SERVICE INSTALLATION.

ALL HARDWARE SHALL BE TIGHTENED AND WELL SECURED. CABLES SHALL BE NEATLY WOUND IN HANDHOLES AND GULFBOXES. CABLES SHALL BE NEATLY TRAINED IN THE CONTROLLER CABINET.

NO ADDITIONAL COMPENSATION WILL BE ALLOWED FOR PLACING CONDUIT AT GREATER THAN 2 FOOT MINIMUM DEPTH TO AVOID OBSTACLES SUCH AS UNDERGROUND UTILITIES.

THE CONTRACTOR IS RESPONSIBLE FOR UNCOVERING OR HAND DIGGING AROUND UTILITIES AS NECESSARY. THE COST OF THIS WORK IS TO BE INCLUDED WITH THE ELECTRICAL WORK PAY ITEM.

THE NUMBER OF CONDUCTORS FOR ELECTRIC CABLES AS SHOWN ON THE PLANS SHALL BE THE MINIMUM NUMBER OF CONDUCTORS FURNISHED FOR EACH LOCATION. THE CONTRACTOR MAY SUBSTITUTE AN ELECTRIC CABLE WITH MORE CONDUCTORS THAN SPECIFIED BUT NO ADDITIONAL COMPENSATION WILL BE MADE FOR THE EXTRA CONDUCTORS.

THE EXISTING SIGN PANELS SHALL BE REMOVED AND RE-ERECTED ON THE PROPOSED SIGN SUPPORTS. SIGN PANELS SHALL BE STORED IN SUCH A MANNER AS TO PROTECT THEM FROM DAMAGE. THE CONTRACTOR SHALL BE RESPONSIBLE FOR ALL COSTS TO REPAIR AND/OR REPLACE ANY SIGN PANEL THAT IS DAMAGED IN A MANNER MAKING THE SIGN PANEL UNACCEPTABLE FOR USE ON THE PROJECT. THIS WORK SHALL BE PAID FOR AT THE CONTRACT UNIT PRICE PER EACH FOR REMOVE AND RE-ERECT EXISTING SIGN.

ALL NEW SIGNAL WIRING SHALL EXTEND FROM CONTROLLER TO SIGNAL. SPLICES IN HANDHOLES OR GULFBOXES WILL NOT BE ALLOWED.

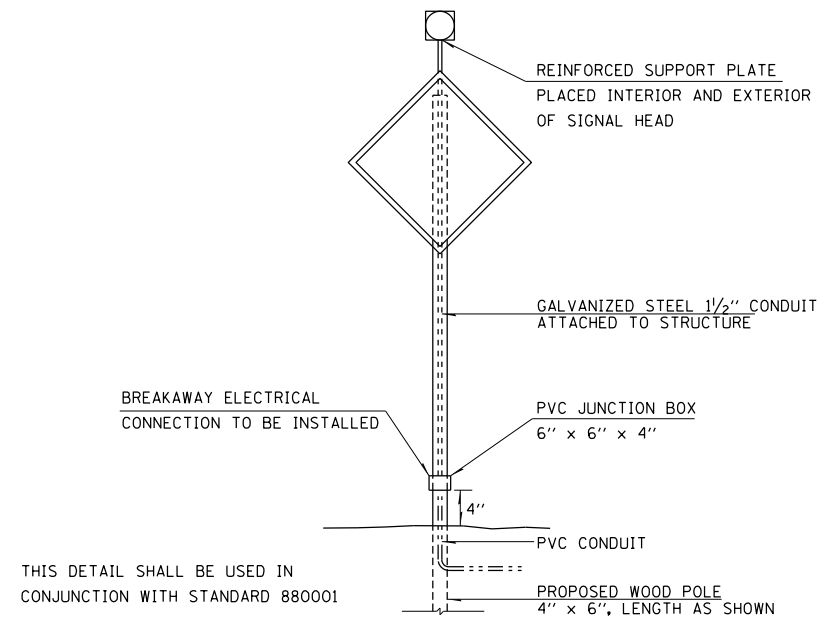

POST MOUNTED FLASHING BEACON

FILE NAME =	USER NAME = steffenmk	DESIGNED -	REVISED -
p:\11\084EBIDINTEG.illinois.gov\PIWIDOT\Documents\IDOT Offices\District 7\Projects\7479\Drawings\CAD\Sheets\0774704-sht-fb.dgn		CHECKED -	REVISED -
Default	PLOT SCALE = 80.0000' / in.	DATE -	REVISED -
	PLOT DATE = 10/14/2015		

**STATE OF ILLINOIS
DEPARTMENT OF TRANSPORTATION**

**FLASHING BEACONS-DETAILS
& GENERAL NOTES**

SCALE: N/A SHEET 1 OF 2 SHEETS STA. TO STA.

F.A.P. RTE.	SECTION	COUNTY	TOTAL SHEETS	SHEET NO.
327	(12,13,14)RS-3	CLAY	27	20
CONTRACT NO. 74704				
ILLINOIS FED. AID PROJECT				

US 50 AND XENIA RD
DESIGN VEHICLE: RB-67

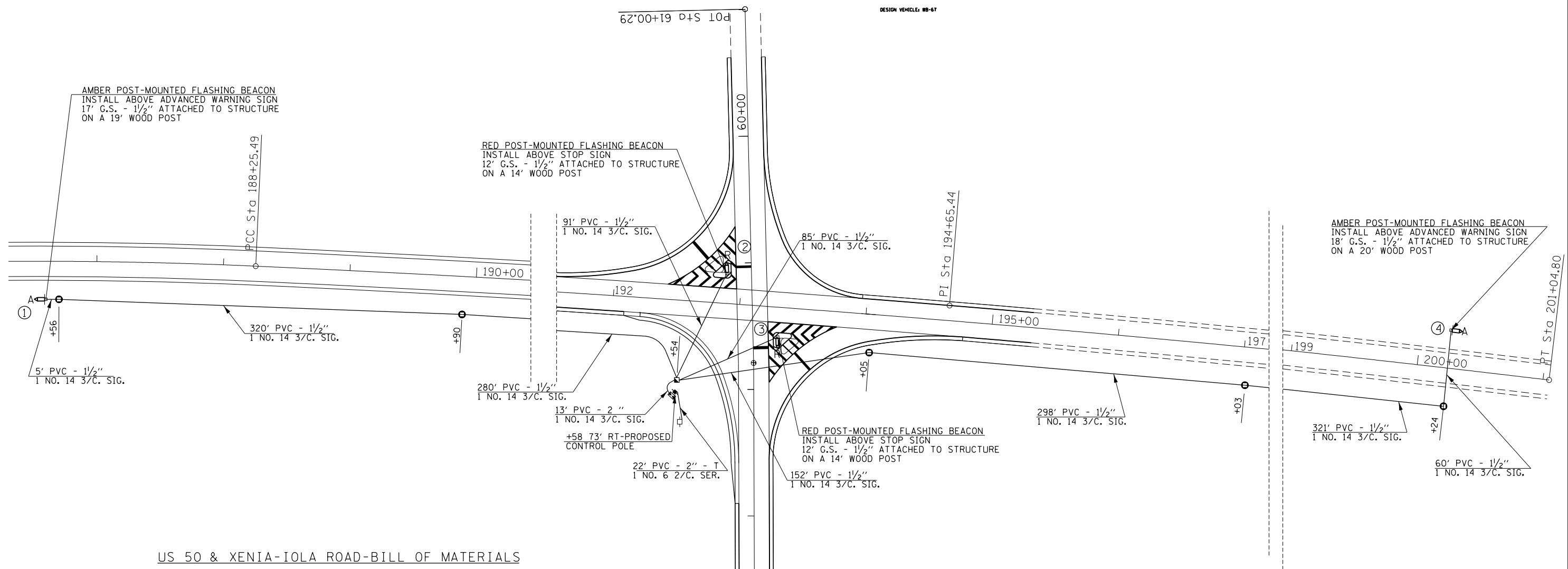

US 50 & XENIA-IOLA ROAD-BILL OF MATERIALS

ITEM	UNIT	QUANTITY
WOOD SIGN SUPPORT	FOOT	67
SERVICE INSTALLATION, TYPE A (MODIFIED)	EACH	1
UNDERGROUND CONDUIT, PVC, 1/2" DIA.	FOOT	1612
UNDERGROUND CONDUIT, PVC, 2" DIA.	FOOT	35
CONDUIT ATTACHED TO STRUCTURE, 1/2" DIA., GALVANIZED STEEL	FOOT	59
HANDHOLE	EACH	1
GULFBOX JUNCTION	EACH	5
FLASHER CONTROLLER	EACH	1
ELECTRIC CABLE IN CONDUIT, SIGNAL NO. 14 3C	FOOT	1766
ELECTRIC CABLE IN CONDUIT, SERVICE NO. 6 2C	FOOT	42
SIGNAL HEAD, POLYCARBONATE, LED 1-FACE, 1-SECTION, POST MOUNTED	EACH	4
REMOVE EXISTING FLASHING BEACON INSTALLATION COMPLETE	EACH	1
REMOVE AND RE-ERECT EXISTING SIGN	EACH	8

EXIST. CURVE CUR004
PI STA. = 194+65.44
Δ = 4° 15' 12" (RT)
D = 0° 19' 57"
R = 17,233.70'
T = 639.95'
L = 1,279.31'
E = 11.88'
θ = -----
T.R. = -----
S.E. RUN = -----
P.C. STA. = 188+25.49
P.T. STA. = 201+04.80

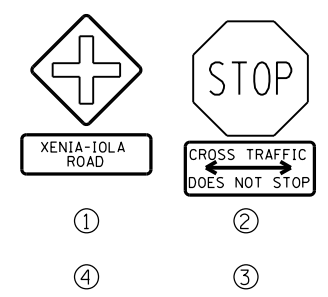

LEGEND

- PROPOSED FLASHING BEACON R-RED (LOCATIONS 2 & 3)
- PROPOSED FLASHING BEACON A-AMBER (LOCATIONS 1 & 4)
- ELECTRICAL CABLE IN CONDUIT
- GULFBOX
- HANDHOLE

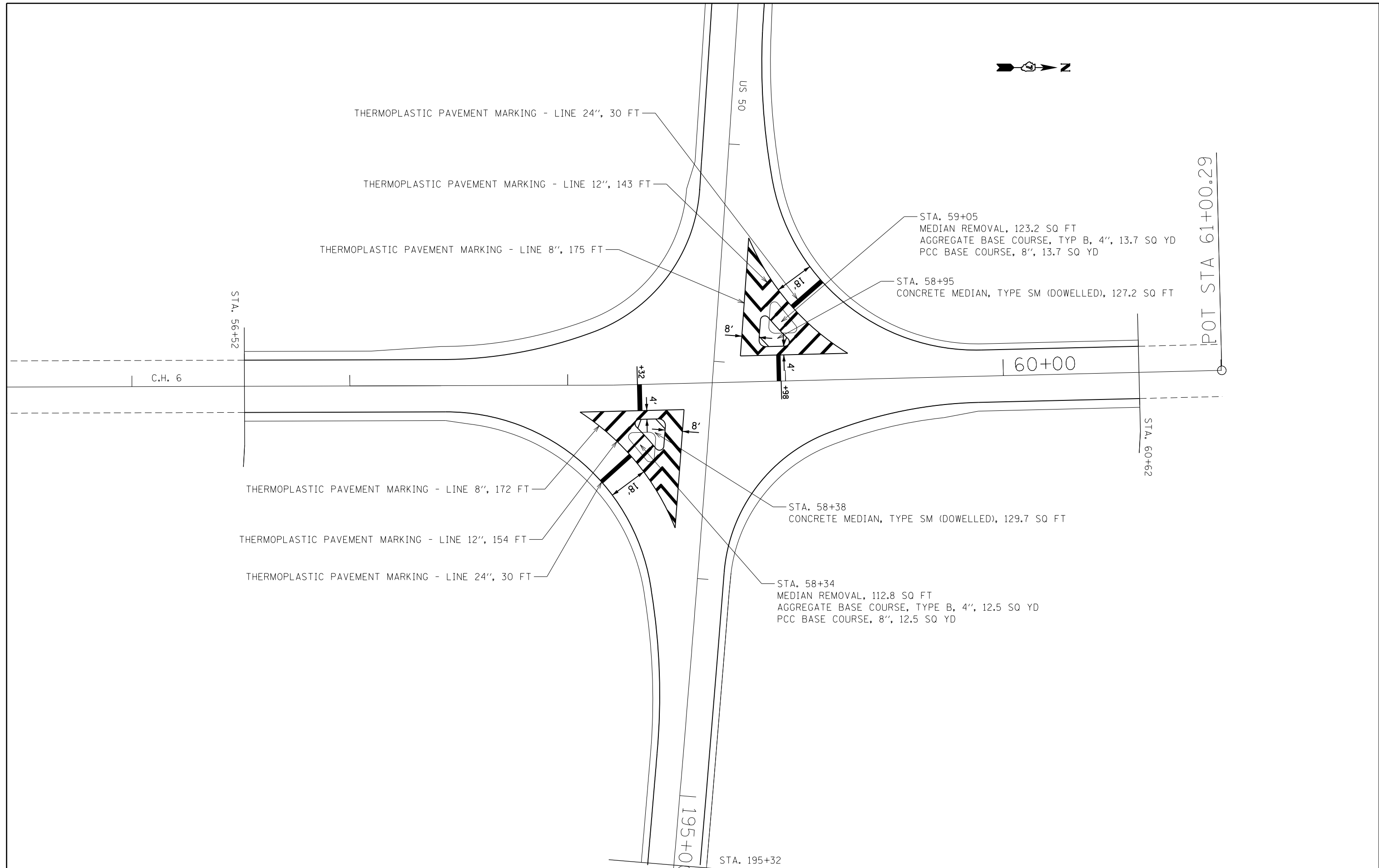

FILE NAME =	USER NAME = steffenmk	DESIGNED -	REVISED -
pw:\IL\084EBIDINTEG.illinois.gov\PWIDOT\Documents\IDOT Offices\District 7\Projects\7479\Drawings\CAD\Sheets\0774704-sht-intdet.dwg		DRAWN -	REVISED -
Default	PLOT SCALE = 40.0000' / in.	CHECKED -	REVISED -
	PLOT DATE = 10/13/2015	DATE -	REVISED -

**STATE OF ILLINOIS
DEPARTMENT OF TRANSPORTATION**

**C.H. 6 & US 50
INTERSECTION DETAIL**

F.A.P. RTE.	SECTION	COUNTY	TOTAL SHEETS	SHEET NO.
327	(12,13,14)RS-3	CLAY	27	22
CONTRACT NO. 74704				
ILLINOIS FED. AID PROJECT				

SCALE: 20 SHEET 1 OF 1 SHEETS STA. TO STA.

DETAIL OF CONCRETE MEDIAN, TYPE SM (DOWELLED)

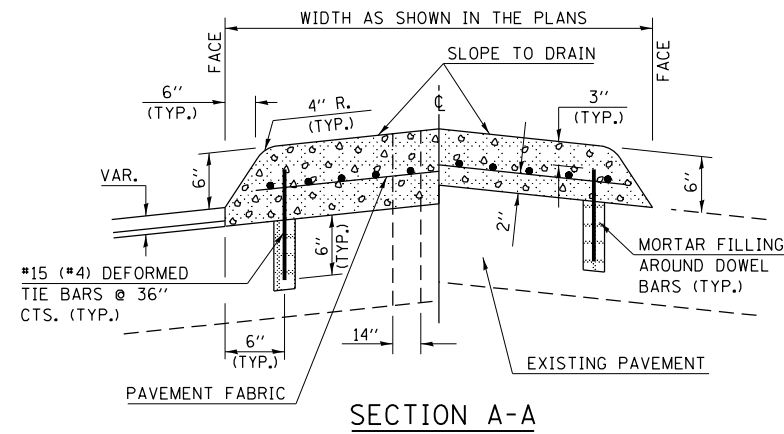

GENERAL NOTES

1. THE GENERAL NOTES FOR STANDARD 606301 SHALL APPLY.
2. SECTION G-G SHALL BE THE SAME AS SHOWN ON STANDARD 606301.
3. DOWEL BARS @ 36" CTS. OR AS DIRECTED BY THE ENGINEER.
4. THIS WORK WILL BE PAID FOR AT THE CONTRACT UNIT PRICE PER SQ FT FOR CONCRETE MEDIAN, TYPE SM (DOWELLED), INCLUDING THE COST OF FURNISHING AND INSTALLING THE DOWEL BARS, MORTAR FILLING, PAVEMENT FABRIC AND THE REMOVAL AND DISPOSAL OF THE EXISTING PAVEMENT FOR THE 14" X 14" OPENING, IF REQUIRED, AND NO ADDITIONAL COMPENSATION WILL BE ALLOWED.

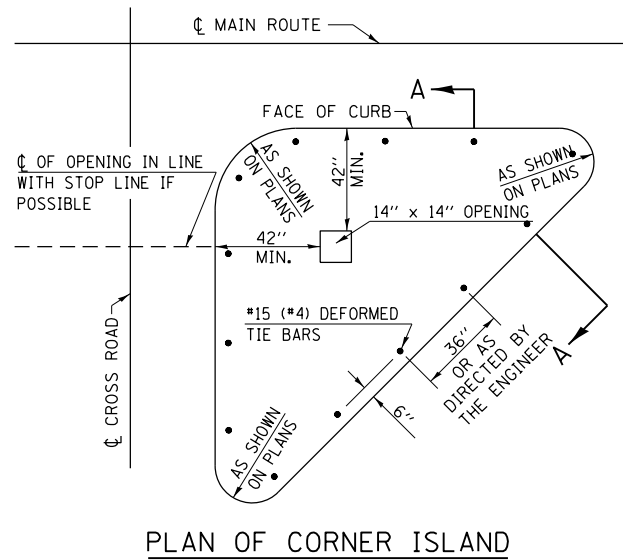

FILE NAME =	USER NAME = steffenk	DESIGNED -	REVISED -	STATE OF ILLINOIS DEPARTMENT OF TRANSPORTATION	CONCRETE MEDIAN, TYPE SM (DOWELLED)	F.A.P. RTE.	SECTION	COUNTY	TOTAL SHEETS	SHEET NO.
pw:\IL\084EBIDINTEG.illinois.gov\PI\DOT\Documents\DOT Offices\District 7\Projects\7479\Drawings\CAD\Sheets\0774704-sht-mediandp	DESIGNED -	REVISED -	327			(12,13,14)RS-3	CLAY	27	23	
Default	PLOT SCALE = 100.0000' / in.	CHECKED -	REVISED -			CONTRACT NO. 74704				
	PLOT DATE = 10/13/2015	DATE -	REVISED -			ILLINOIS FED. AID PROJECT				
				SCALE: N/A		SHEET 1 OF 1 SHEETS		STA. TO STA.		

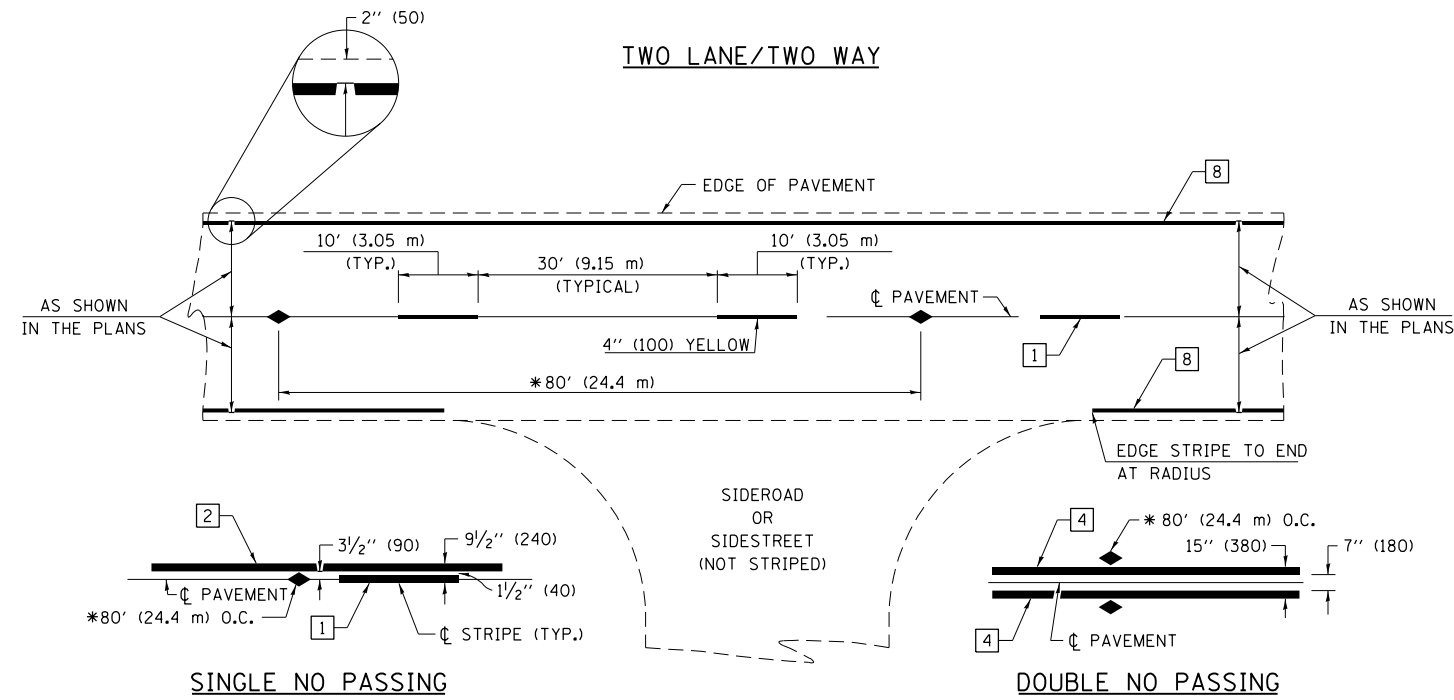

* REDUCE TO 40' (12.2 m) O.C. ON CURVES WITH POSTED OR ADVISORY SPEEDS OF 45 mph (70 km/h) OR LESS.

PAVEMENT MARKING LEGEND

- 1 4" (100) SKIP-DASH (YELLOW)
- 2 4" (100) SOLID (YELLOW)
- 3 12" (300) DIAGONAL (YELLOW)
- 4 4" (100) DOUBLE YELLOW (NARROW)
- 5 12" (300) SOLID WHITE
- 6 RESERVED
- 7 6" (150) SKIP-DASH (WHITE)
- 8 4" (100) SOLID (WHITE)
- 9 12" (300) DIAGONAL (WHITE)
- 10 6" (150) SOLID (WHITE)
- 11 24" (600) STOP BAR (WHITE)
- 12 8" (200) SOLID (WHITE)
- 13 4" (100) PARKING WHITE

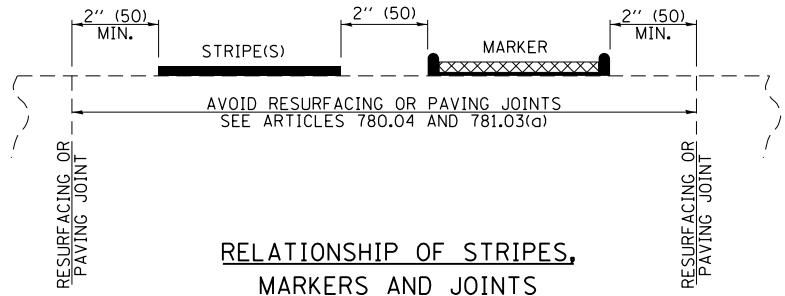

RELATIONSHIP OF STRIPES, MARKERS AND JOINTS

TYPICAL PAVEMENT MARKERS LEGEND

- ◆ TWO-WAY AMBER MARKER
- ▶ ONE-WAY AMBER MARKER
- ▷ ONE-WAY CRYSTAL MARKER

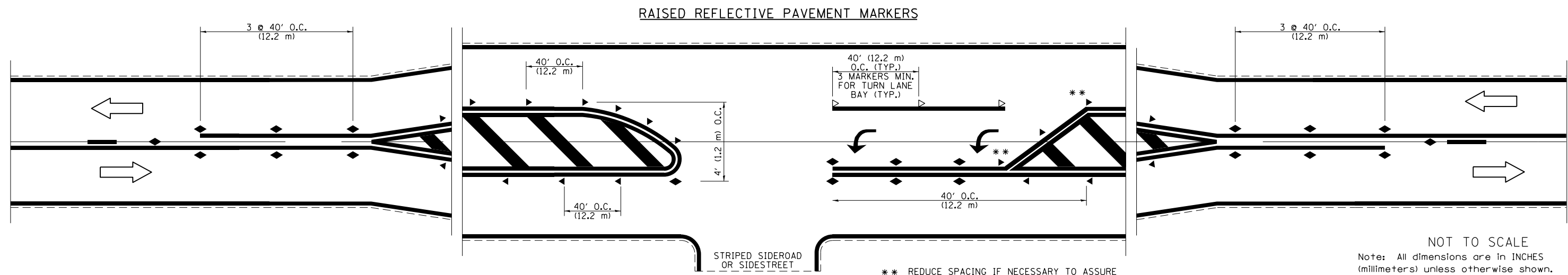

NOT TO SCALE
Note: All dimensions are in INCHES (millimeters) unless otherwise shown.

FILE NAME =	USER NAME = steffenmk	DESIGNED -	REVISED -
pw:\IL\084EBIDINTEG\illinois.gov\PWIDOT\Documents\DOT Offices\District 7\Projects\7479\Drawings\CABsheets\D774704-sht-details.dwg		CHECKED -	REVISED -
		DATE -	REVISED -

STATE OF ILLINOIS
DEPARTMENT OF TRANSPORTATION

PAVEMENT MARKING AND RAISED REFLECTIVE PAVEMENT MARKERS
(RURAL & URBAN APPLICATIONS)
SCALE: N/A SHEET NO. 1 OF 4 SHEETS STA. TO STA.

DISTRICT 7 DETAIL NO. 7800001				
F.A.P. RTE.	SECTION	COUNTY	TOTAL SHEETS	SHEET NO.
327	(12,13,14)RS-3	CLAY	27	24
CONTRACT NO. 74704				
ILLINOIS FED. AID PROJECT				

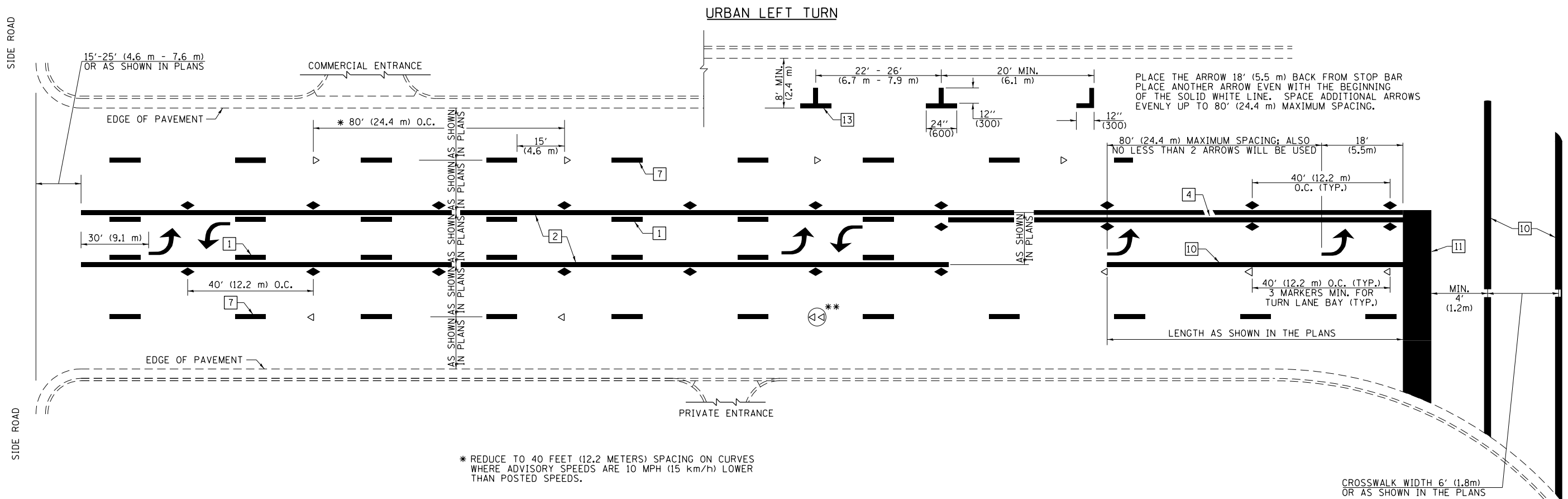

* REDUCE TO 40 FEET (12.2 METERS) SPACING ON CURVES WHERE ADVISORY SPEEDS ARE 10 MPH (15 km/h) LOWER THAN POSTED SPEEDS.

** DOUBLE LANE LINE MARKERS SHALL BE SPECIFIED AND SPACED AS SHOWN IN HIGHWAY STANDARD 781001 FOR MULTI-LANE DIVIDED AND UNDIVIDED HIGHWAYS.

PAVEMENT MARKING LEGEND

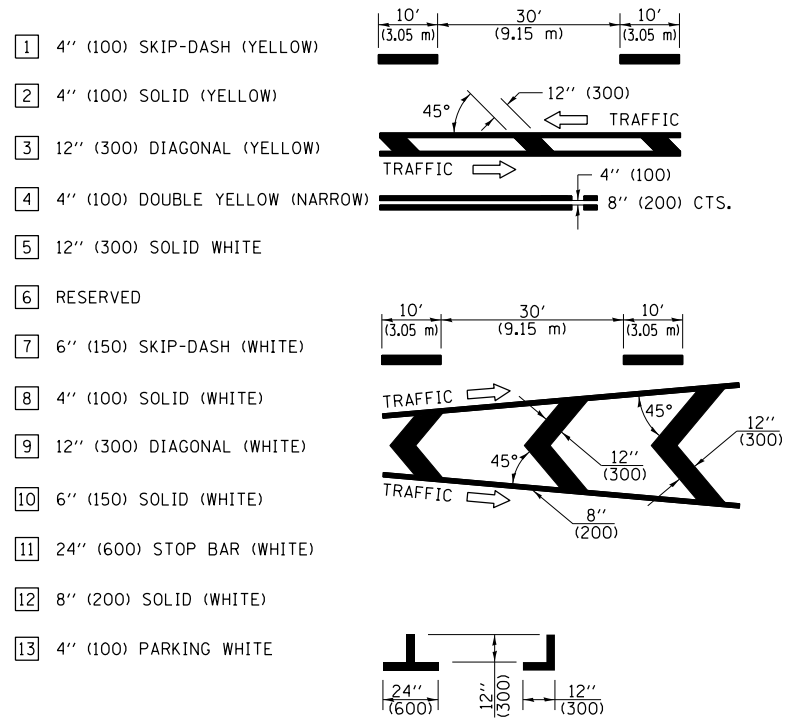

GENERAL NOTES

- TURN ARROW PAIRS SHALL BE PLACED AT 250' (75 m) INTERVALS AND SHALL BE EVENLY SPACED BETWEEN BOTH ENDS OF THE BIDIRECTIONAL LEFT TURN LANE. USE A MINIMUM OF TWO PAIRS PER BLOCK.
- THE SOLID YELLOW PAVEMENT MARKINGS [2] SHOULD GENERALLY START OR END NEAR THE RADIUS POINT OF EACH STREET RETURN EXCEPT WHERE ONE OR BOTH ENDS WOULD INCLUDE STOP BARS.
- THE SKIP-DASH PAVEMENT MARKINGS [1] OR [7] SHOULD BE CENTERED BETWEEN BOTH ENDS OF EACH CITY BLOCK AND SHALL BE PLACED SO THEY LINE UP ACROSS FROM EACH OTHER.
- USE LARGE ARROW SIZE FOR BOTH RURAL AND URBAN LOCATIONS. (SEE LAST PAGE OF SECTION 780x FOR SYMBOLS TABLE)
- LANE LINE EXTENSIONS SHALL BE THE SAME COLOR AND WIDTH AS THE LANE LINE BEING EXTENDED.

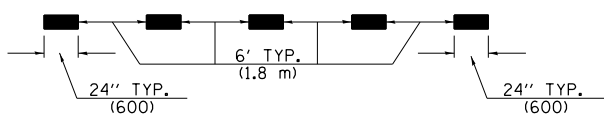

LANE LINE EXTENSIONS

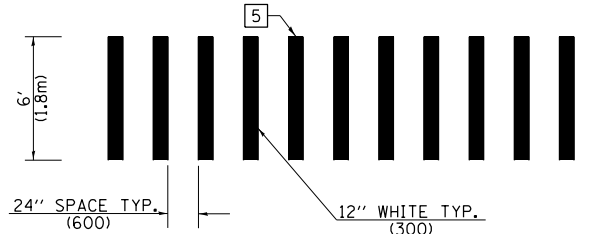

CROSSWALK DETAIL (DECATUR CITY LIMITS ONLY)

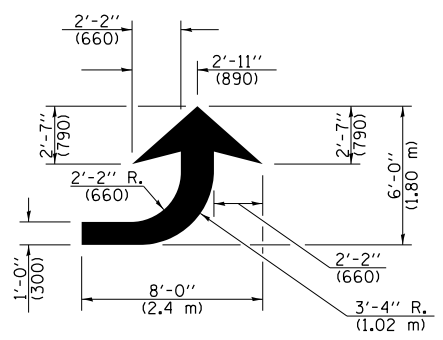

LEFT ARROW

REVERSE FOR RIGHT ARROW
AREA = 15.6 SQ. FT. (1.47 m²)
(WHITE)

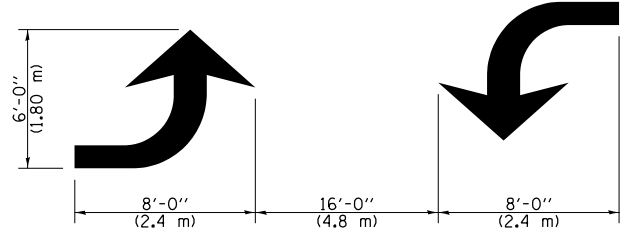

TYPICAL DOUBLE TURN ARROWS (WHITE)

NOT TO SCALE

Note: All dimensions are in INCHES (millimeters) unless otherwise shown.

DISTRICT 7 DETAIL NO. 78000001

FILE NAME =	USER NAME = steffenmk	DESIGNED -	REVISED -	STATE OF ILLINOIS DEPARTMENT OF TRANSPORTATION	PAVEMENT MARKING AND RAISED REFLECTIVE PAVEMENT MARKERS (RURAL & URBAN APPLICATIONS)		F.A.P. RTE.	SECTION	COUNTY	TOTAL SHEETS	SHEET NO.
pw\11084EBIDINTEG.illinois.gov\PIWIDOT\Documents\DOT Offices\District 7\Projects\7479\Drawings\CABsheets\0774704-sht-details.dgn	PLotted SCALE = 100.0000' / in.	CHECKED -	REVISED -				327	(12,13,14)RS-3	CLAY	27	25
PLOT DATE = 10/13/2015	DATE -	REVISED -	REVISED -				CONTRACT NO. 74704			ILLINOIS FED. AID PROJECT	
							SCALE: N/A	SHEET NO. 2 OF 4 SHEETS	STA.	TO STA.	

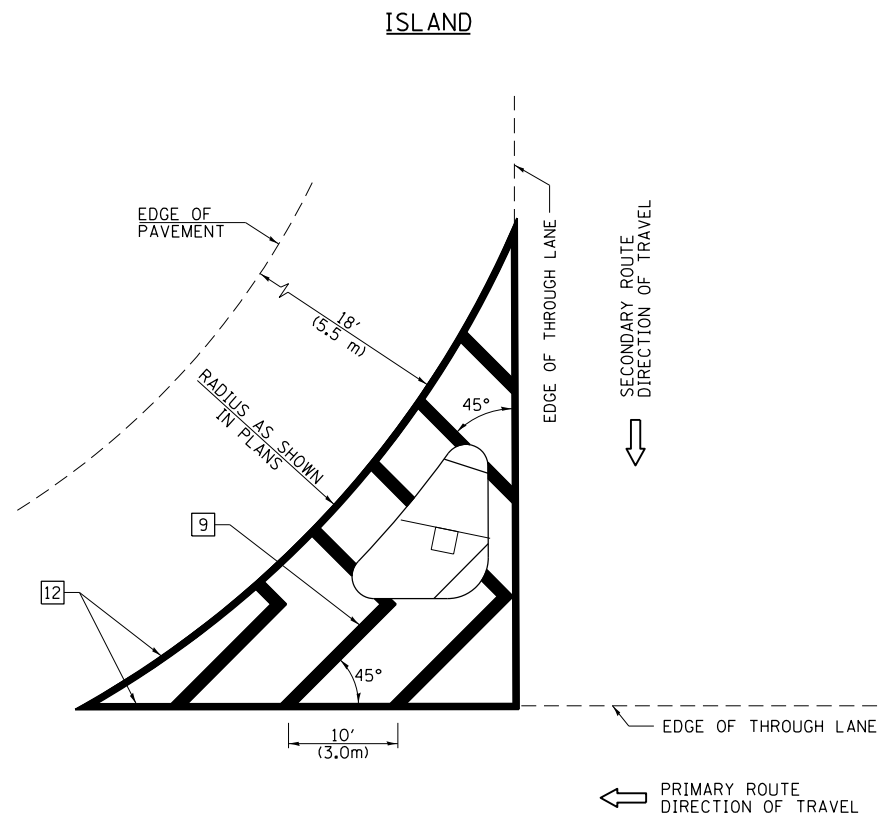

GENERAL NOTES

1. RAISED AND CORRUGATED MEDIANS SHALL BE OUTLINED WITH [2] IF PRESENT.
2. SOME OF THE INFORMATION INCLUDED WITH THIS DETAIL MAY NOT BE APPLICABLE TO THIS IMPROVEMENT.
3. PAVEMENT MARKINGS ARE TO BE EXTENDED THROUGH OMISSIONS WHEN APPLICABLE.
4. FINAL PAVEMENT MARKINGS SHALL BE IN PLACE PRIOR TO PLACING ANY RAISED REFLECTIVE PAVEMENT MARKERS.
5. THE FOLLOWING CRITERIA SHALL BE USED FOR SELECTING THE DIAGONAL PAVEMENT MARKING SPACING:

< 30 MPH (< 50 km/h)	15' (4.5 m)
30-45 MPH (50-75 km/h)	20' (6.0 m)
> 45 MPH (> 75 km/h)	30' (9.0 m)

PAVEMENT MARKING LEGEND

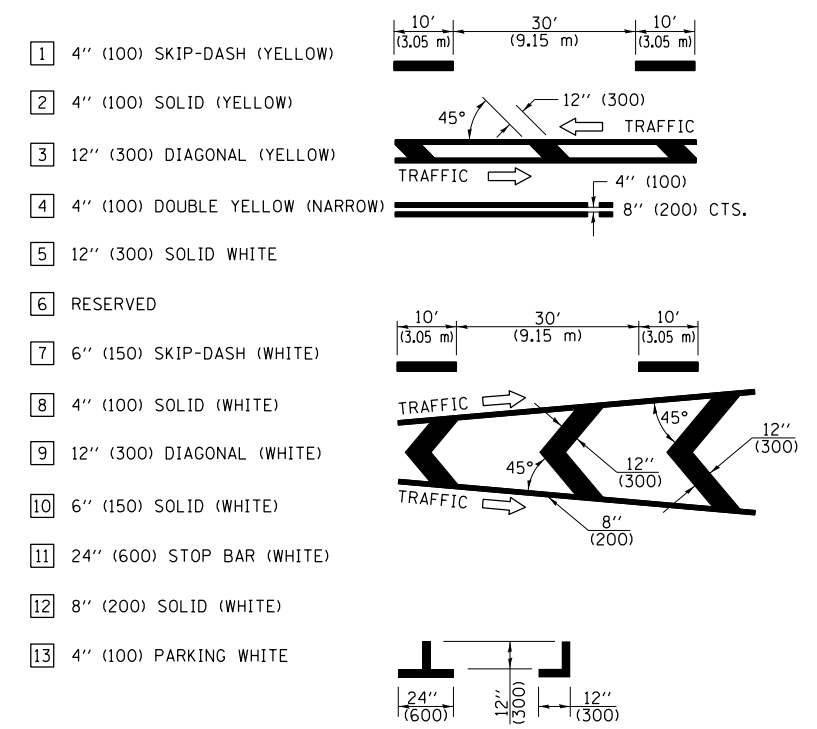

RURAL LEFT TURN STRIPING

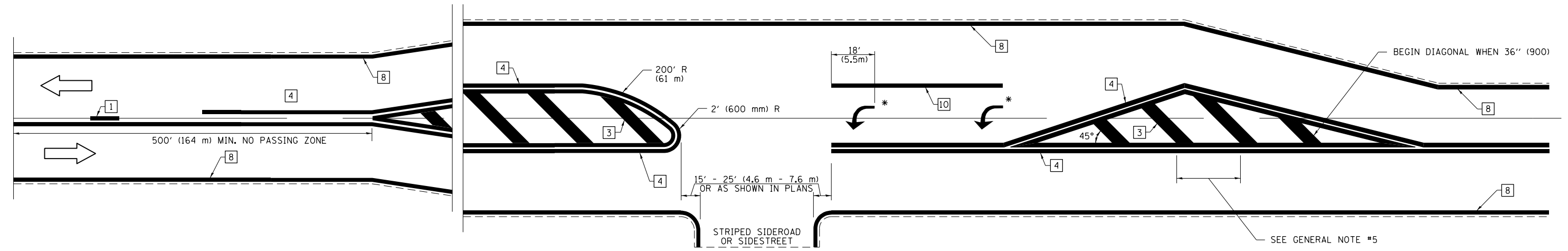

* PLACE AN ARROW 18' (5.5 m) BACK FROM STOP BAR. PLACE ANOTHER ARROW EVEN WITH THE BEGINNING OF THE SOLID WHITE LINE. SPACE ADDITIONAL ARROWS EVENLY UP TO 80' (24.4 m) MAXIMUM SPACING. USE MINIMUM OF 2 ARROWS.

NOT TO SCALE
 Note: All dimensions are in INCHES (millimeters) unless otherwise shown.

DISTRICT 7 DETAIL NO. 7800001

FILE NAME =	USER NAME = steffenmk	DESIGNED -	REVISED -
pw:\IL\084EBIDINTEG\illinois.gov\PWIDOT\Documents\IDOT Offices\District 7\Projects\7479\084EBIDINTEG\CAB\Drawings\084EBIDINTEG\084EBIDINTEG-D774704-sht-details.dwg		DRAWN -	REVISED -
	PLOT SCALE = 100.0000' / 1in.	CHECKED -	REVISED -
	PLOT DATE = 10/13/2015	DATE -	REVISED -

**STATE OF ILLINOIS
 DEPARTMENT OF TRANSPORTATION**

**PAVEMENT MARKING AND RAISED REFLECTIVE PAVEMENT MARKERS
 (RURAL & URBAN APPLICATIONS)**
 SCALE: N/A SHEET NO. 3 OF 4 SHEETS STA. TO STA.

F.A.P. RTE.	SECTION	COUNTY	TOTAL SHEETS	SHEET NO.
327	(12,13,14)RS-3	CLAY	27	26
CONTRACT NO. 74704				
ILLINOIS FED. AID PROJECT				

PAVEMENT MARKINGS AT RAILROAD-HIGHWAY GRADE CROSSING

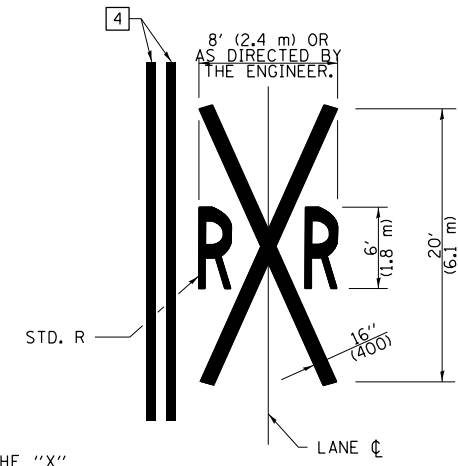
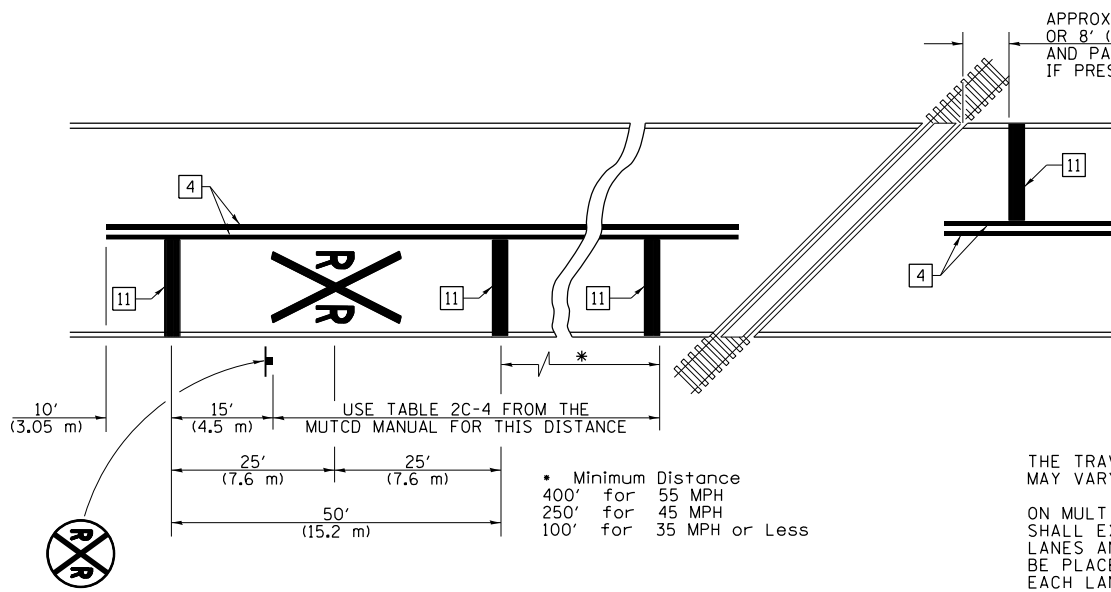

NOTES

THE TRAVERSE SPREAD OF THE "X" MAY VARY ACCORDING TO LANE WIDTH.

ON MULTI-LANE ROADS, THE STOP LINES SHALL EXTEND ACROSS ALL APPROACH LANES AND SEPARATE RXR SYMBOLS SHALL BE PLACED ADJACENT TO EACH OTHER IN EACH LANE.

WHEN THE PAVEMENT MARKING SYMBOL IS USED, A PORTION OF THE SYMBOL SHOULD BE LOCATED DIRECTLY ADJACENT TO THE ADVANCE WARNING SIGN (W10-1) AS PLACED BY TABLE II-1, CONDITION B OF THE MUTCD.

PAVEMENT MARKING LEGEND

- 1 4" (100) SKIP-DASH (YELLOW)
 - 2 4" (100) SOLID (YELLOW)
 - 3 12" (300) DIAGONAL (YELLOW)
 - 4 4" (100) DOUBLE YELLOW (NARROW)
 - 5 12" (300) SOLID WHITE
 - 6 RESERVED
 - 7 6" (150) SKIP-DASH (WHITE)
 - 8 4" (100) SOLID (WHITE)
 - 9 12" (300) DIAGONAL (WHITE)
 - 10 6" (150) SOLID (WHITE)
 - 11 24" (600) STOP BAR (WHITE)
 - 12 8" (200) SOLID (WHITE)
 - 13 4" (100) PARKING WHITE
-

RAILROAD CROSSING WITH INTERCONNECT ONLY

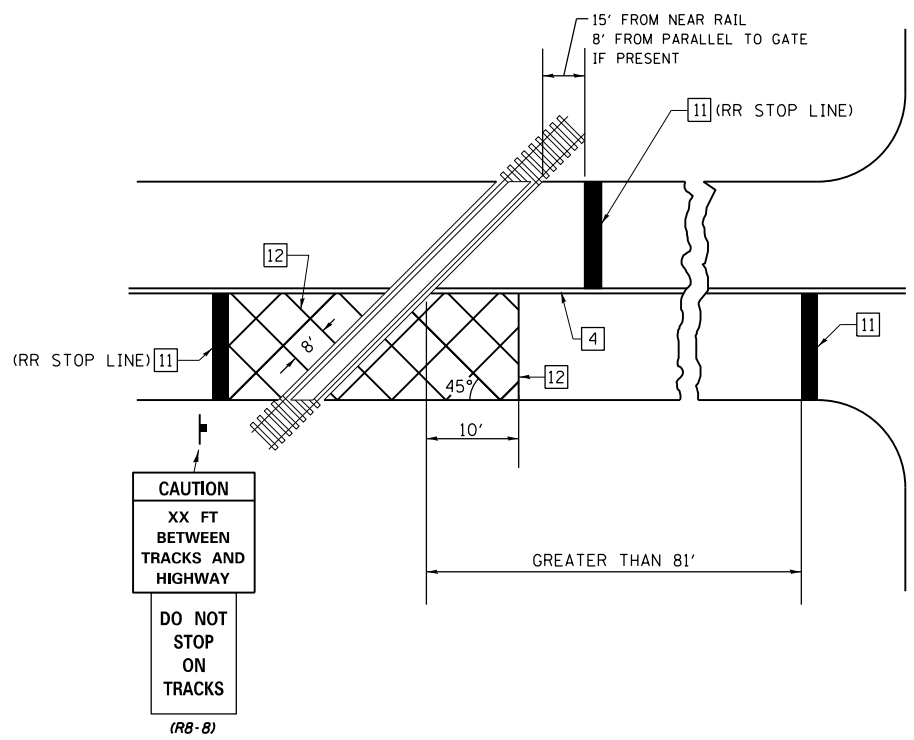

RAILROAD CROSSING WITH INTERCONNECT AND PRE-SIGNALS

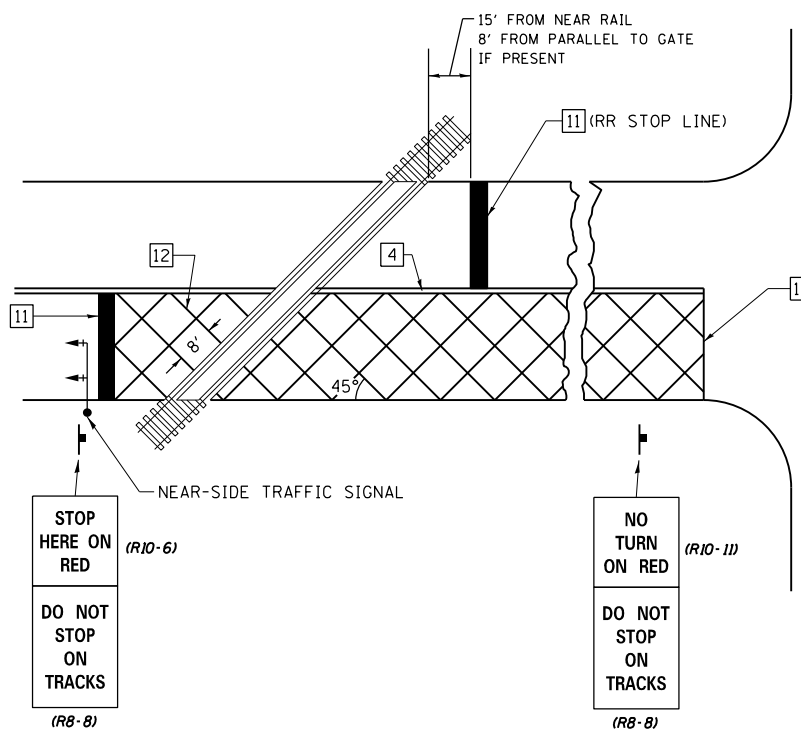

SUPPLEMENTAL PAVEMENT MARKING TREATMENT FOR RAILROAD-HIGHWAY GRADE CROSSING

GENERAL NOTES

1. SUPPLEMENTAL PAVEMENT MARKINGS TO BE INSTALLED ONLY ON APPROACHES TO INTERSECTIONS CONTROLLED BY TRAFFIC SIGNALS WHICH ARE INTERCONNECTED WITH THE RAILROAD WARNING SIGNALS.
2. EXTEND PAVEMENT MARKINGS TO THE INTERSECTION ONLY WHERE NEAR-SIDE TRAFFIC SIGNALS ARE USED.

NOT TO SCALE

Note: All dimensions are in INCHES (millimeters) unless otherwise shown.

DISTRICT 7 DETAIL NO. 7800001

FILE NAME =	USER NAME = steffenmk	DESIGNED -	REVISED -	STATE OF ILLINOIS DEPARTMENT OF TRANSPORTATION	PAVEMENT MARKING AND RAISED REFLECTIVE PAVEMENT MARKERS (RURAL & URBAN APPLICATIONS)			F.A.P. R.T.E.	SECTION	COUNTY	TOTAL SHEETS	SHEET NO.
pw:\IL\084EBIDINTEG.illinois.gov\PIWIDOT\Documents\IDOT Offices\District 7\Projects\7479\Drawings\CABsheets\0774704-sht-details.dwg	DATE = 10/13/2015	CHECKED -	REVISED -					327	(12,13,14)RS-3	CLAY	27	27
PLOT SCALE = 100.0000' / 1in.	DATE -	REVISOR -	REVISOR -		CONTRACT NO. 74704							
					ILLINOIS FED. AID PROJECT							