

STATE OF ILLINOIS  
DEPARTMENT OF TRANSPORTATION  
DIVISION OF HIGHWAYS

**PROPOSED  
HIGHWAY PLANS**

MAIN STREET (OR 4103)  
SECTION 83RS-3  
PROJECT ACRS-4103 (005)  
RESURFACING & PATCHING  
JEFFERSON COUNTY

C-99-058-15

FOR INDEX OF SHEETS, SEE SHEET NO. 03

ADT 1000 (2016)  
PV = 875  
MU = 30  
SU = 130

EQUATION STATIONS:  
NONE

OMISSIONS: RAILROAD  
STA. 38 + 32 TO STA. 38 + 42

TOWNSHIPS:  
WEBBER

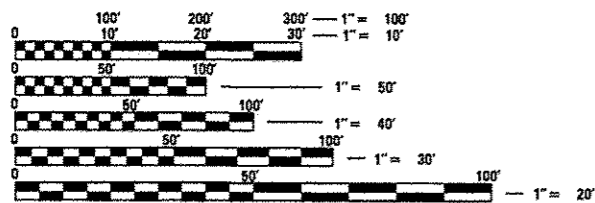

FULL SIZE PLANS HAVE BEEN PREPARED USING STANDARD ENGINEERING SCALES. REDUCED SIZED PLANS WILL NOT CONFORM TO STANDARD SCALES. IN MAKING MEASUREMENTS ON REDUCED PLANS, THE ABOVE SCALES MAY BE USED.

J.U.L.I.E.  
JOINT UTILITY LOCATION INFORMATION FOR EXCAVATION  
1-800-892-0123  
OR 811

PROJECT ENGINEER: CHARLES STEIN (618)351-5210  
PROJECT MANAGER: AESHA JACKSON (618)351-5215

CONTRACT NO. 78490

GROSS LENGTH = 10300 FT. = 1.95 MILE  
OMISSIONS LENGTH = 10 FT. = 0.00 MILE  
NET LENGTH = 10290 FT. = 1.95 MILE

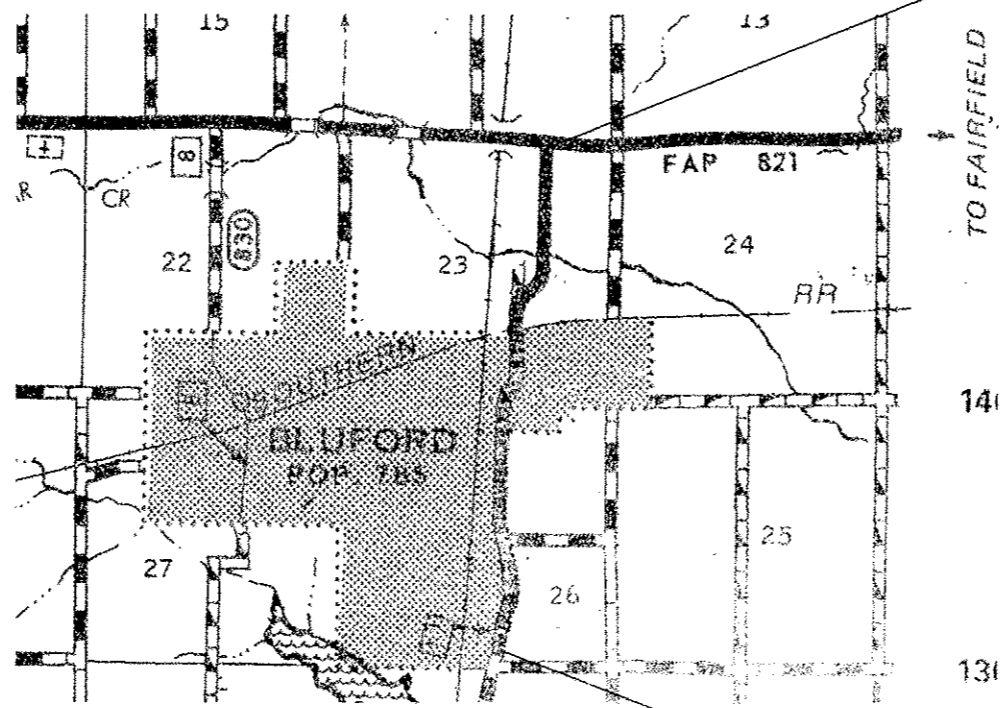

BEGIN PROJECT  
STA. 0 + 00  
(MAIN STREET)

END PROJECT  
STA. 103 + 00  
(MAIN STREET)

F.A. RTE.	SECTION	COUNTY	TOTAL SHEETS	SHEET NO.
4103	83RS-3	JEFFERSON	18	1
		ILLINOIS	CONTRACT NO. 78490	

D-99-050-15

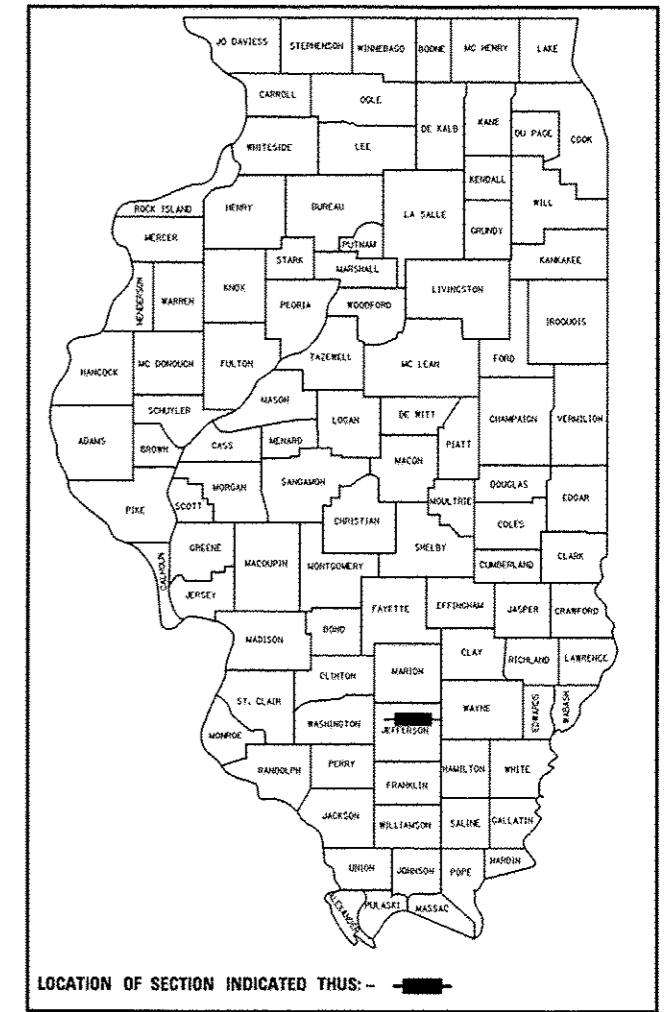

LOCATION OF SECTION INDICATED THUS: - [black rectangle] -

STATE OF ILLINOIS  
DEPARTMENT OF TRANSPORTATION  
DIVISION OF HIGHWAYS

SUBMITTED Oct 13 20 15

Jeffrey Keim  
DEPUTY DIRECTOR OF HIGHWAYS, REGION ENGINEER

Dec 4 20 15  
John D. Baranzelli PE  
ENGINEER OF DESIGN AND ENVIRONMENT

Dec 4 20 15  
Omer Cannon PE  
DIRECTOR OF HIGHWAYS, CHIEF ENGINEER

PRINTED BY THE AUTHORITY  
OF THE STATE OF ILLINOIS



## INDEX OF SHEETS

### SHEET NO.

### DESCRIPTION

1	COVER SHEET
2	SIGNATURE SHEET
3	INDEX OF SHEETS, STANDARDS & GENERAL NOTES
4	MIXTURE REQUIREMENTS
5 - 6	SUMMARY OF QUANTITIES
7	TYPICAL SECTION
8	RESURFACING SCHEDULE - MAINLINE
9	RESURFACING SCHEDULE - SIDE ROADS AND ENTRANCES
10	PAVEMENT MARKING SCHEDULE
11 - 14	PLAN SHEETS
15	DETAILS - BUTT JOINTS, INLAY TRANSITION & MAILBOX TURNOUT
16	DETAILS - SIDE ROADS AND ENTRANCES
17	DETAIL - TEMPORARY HOT-MIX ASPHALT TRANSITIONS
18	UNEVEN LANES & ROUGH GROOVED SURFACE SIGNS

**STANDARDS:**

000001-06	STANDARD SYMBOLS ABBREVIATIONS & PATTERNS
701001-02	OFF-ROAD OPERATIONS, 2L, 2W, MORE THAN 15' (4.5 m) AWAY.
701006-05	OFF-ROAD OPERATIONS, 2L, 2W, 15' (4.5 m) TO 24' (600 mm) FROM PAVEMENT EDGE.
701201-04	LANE CLOSURE, 2L, 2W, DAY ONLY, FOR SPEEDS $\geq$ 45 MPH FOR PAVEMENT PATCHING
701301-04	LANE CLOSURE, 2L, 2W, SHORT TIME OPERATIONS.
701306-03	LANE CLOSURE, 2L, 2W, SLOW MOVING OPERATIONS DAY ONLY, FOR SPEEDS $\geq$ 45 MPH
701311-03	LANE CLOSURE, 2L, 2W, MOVING OPERATIONS-DAY ONLY
701901-04	TRAFFIC CONTROL DEVICES
780001-05	TYPICAL PAVEMENT MARKINGS
781001-03	TYPICAL APPLICATIONS RAISED REFLECTIVE PAVEMENT MARKERS

### GENERAL NOTES

THE THICKNESS OF HOT-MIX ASPHALT MIXTURE SHOWN ON THE PLANS IS THE NOMINAL THICKNESS. DEVIATIONS FROM THE NOMINAL THICKNESS WILL BE PERMITTED WHEN SUCH DEVIATIONS OCCUR DUE TO IRREGULARITIES IN THE EXISTING SURFACE OR BASE ON WHICH THE HOT-MIX ASPHALT MIXTURE IS PLACED.

FACTORS USED FOR ESTIMATING PLAN QUANTITIES ARE AS FOLLOWS AND SHALL NOT BE USED FOR THE BASIS OF FINAL QUANTITIES:

ALL HOT MIX ASPHALT:	2.016 TONS / CU. YD.
ALL AGGREGATE	2.05 TONS/CU. YD.

AT ALL LOCATIONS WHERE THE PROPOSED HOT MIX ASPHALT OR CONCRETE PAVEMENT JOINS AN EXISTING HOT MIX ASPHALT OR CONCRETE PAVEMENT, A FULL DEPTH SAWED JOINT SHALL BE CONSTRUCTED. THE COST OF THIS JOINT WILL BE INCLUDED IN THE COST OF THE TYPE OF PAVEMENT BEING CONSTRUCTED.

THE CONTRACTOR SHALL STAMP STATIONING IN THE PROPOSED HOT MIX ASPHALT SURFACE AS 100m (300 FT.) INTERVALS ON ALTERNATING SIDES OF THE PAVEMENT AND AS DIRECTED BY THE ENGINEER. THE STATION SYMBOL STAMPS USED SHALL BE FURNISHED BY THE CONTRACTOR. THEY SHALL BE 140mm (5 IN.) TALL, OF A DESIGN APPROVED BY THE ENGINEER, AND SHALL REMAIN THE PROPERTY OF THE CONTRACTOR.

THE QUANTITIES SHOWN IN THE PLANS FOR PATCHING AREA ESTIMATES. THE ACTUAL AMOUNT OF PATCHING REQUIRED SHALL BE DETERMINED BY THE ENGINEER IN THE FIELD. PATCHING SURVEY WAS DONE ON SEPTEMBER 1, 2015.

THE QUANTITY FOR PRIME COAT WAS CALCULATED IN TWO LAYERS. ONE APPLICATION AFTER MILLING THE EXISTING SURFACE AND ONE APPLICATION AFTER PLACING THE BINDER COURSE AND SHALL BE USED AS DIRECTED BY THE ENGINEER.

THE QUANTITY OF SHORT-TERM PAVEMENT MARKING SHOWN IN THE PLANS IS BASED ON ONE APPLICATION EACH FOR THE HMA SURFACE REMOVAL, SURFACE COURSE AND BINDER COURSE.

BITUMINOUS RESURFACING SHALL BE PLACED IN A SEQUENCE THAT WILL MINIMIZE THE TIME THE CENTERLINE EDGE IS EXPOSED TO TRAFFIC. WHEN AT THE END OF A DAY'S OPERATION THE EXPOSED CENTERLINE EDGE IS GREATER THAN 600 METTERS (2,000 FT.), THE CONTRACTOR SHALL BE REQUIRED TO PAVE IN THE ADJACENT LANE ON THE FOLLOWING WORK DAY.

COMMITMENTS: NONE

FILE NAME =	USER NAME = jachernod	DESIGNED -	REVISED -	<b>STATE OF ILLINOIS DEPARTMENT OF TRANSPORTATION</b>	<b>INDEX OF SHEETS, STANDARDS &amp; GENERAL NOTES</b>		F.A. RTE.	SECTION	COUNTY	TOTAL SHEETS	SHEET NO.
p:\11284581\DOT\Illinois.gov\PWIDOT\O...	Documents\DOT Offices\District 9\Projects\784...	DRAWN	REVISED -		4103	83RS-3	JEFFERSON	18	3		
Default	PLOT SCALE = 10+6285' / 1"	CHECKED -	REVISED -		SCALE: SHEET OF SHEETS STA. 0+00 TO STA. 103+00		CONTRACT NO. 78490		ILLINOIS FED. AID PROJECT		
	PLOT DATE = 10/16/2015	DATE -	REVISED -								

MIXTURE REQUIREMENTS

Locations	Hot-Mix Asphalt Surface Course and Incidental HMA Surfacing
Mixture Use(s):	Hot-Mix Asphalt Surface Course, Mix C, N70
AC/PG:	PG64-22
ABR % (Max):	See Special Provision
Design Air Voids:	4.0 %, 70 Gyration Design
Mixture Composition: (Gradation Mixture)	IL-9.5 mm
Friction Aggregate:	C Surface
Quality Management Program:	QCQA

Locations	Hot-Mix Asphalt Leveling Binder Course
Mixture Use(s):	Hot-Mix Asphalt Leveling Binder, N70, IL-9.5mm Fine Grade
AC/PG:	PG64-22
ABR % (Max):	See Special Provision
Design Air Voids:	4.0 %, 70 Gyration Design
Mixture Composition: (Gradation Mixture)	IL-9.5mm Fine Grade
Friction Aggregate:	None
Quality Management Program:	QCQA

Locations	Pavement Patching
Mixture Use(s):	Hot-Mix Asphalt Binder Course, N70, IL-19.0mm
AC/PG:	PG64-22
ABR % (Max):	See Special Provision
Design Air Voids:	4.0 %, 70 Gyration Design
Mixture Composition: (Gradation Mixture)	IL-19.0mm
Friction Aggregate:	None
Quality Management Program:	QC/OA

Locations	Hot-Mix Asphalt Binder Course
Mixture Use(s):	Hot-Mix Asphalt Binder Course, N70, IL-19.0mm
AC/PG:	PG64-22
ABR % (Max):	See Special Provision
Design Air Voids:	4.0 %, 70 Gyration Design
Mixture Composition: (Gradation Mixture)	IL-19.0mm
Friction Aggregate:	None
Quality Management Program:	QC/OA

# SUMMARY OF QUANTITIES

COUNTY:	Jefferson
ROUTE:	Main Street, OR 4103
FUNDING:	80%FED20% STATE
LOCATION:	RURAL
TOTAL QUANTITY	ROADWAY 0005

CODE NUMBER	ITEM DESCRIPTION	UNIT	TOTAL QUANTITY	
40600275	BITUMINOUS MATERIALS (PRIME COAT)	POUND	17401	17401
40600635	LEVELING BINDER (MACHINE METHOD), N70	TON	1070	1070
40600990	TEMPORARY RAMP	SQ YD	52	52
40603085	HOT-MIX ASPHALT BINDER COURSE, IL-19.0, N70	TON	200	200
40603315	HOT-MIX ASPHALT SURFACE COURSE, MIX "C", N70	TON	2127	2127
40800050	INCIDENTAL HOT-MIX ASPHALT SURFACING	TON	74	74
44000155	HOT-MIX ASPHALT SURFACE REMOVAL, 1 1/2"	SQ YD	25153	25153
44200140	PAVEMENT PATCHING, TYPE I, 12 INCH	SQ YD	113	113
44200144	PAVEMENT PATCHING, TYPE II, 12 INCH	SQ YD	172	172
44200150	PAVEMENT PATCHING, TYPE IV, 12 INCH	SQ YD	16	16
48102100	AGGREGATE WEDGE SHOULDER, TYPE B	TON	380	380
67100100	MOBILIZATION	LSUM	1	1
70100450	TRAFFIC CONTROL AND PROTECTION, STANDARD 701201	LSUM	1	1
70100455	TRAFFIC CONTROL AND PROTECTION, STANDARD 701206	LSUM	1	1

14



# TYPICAL SECTION

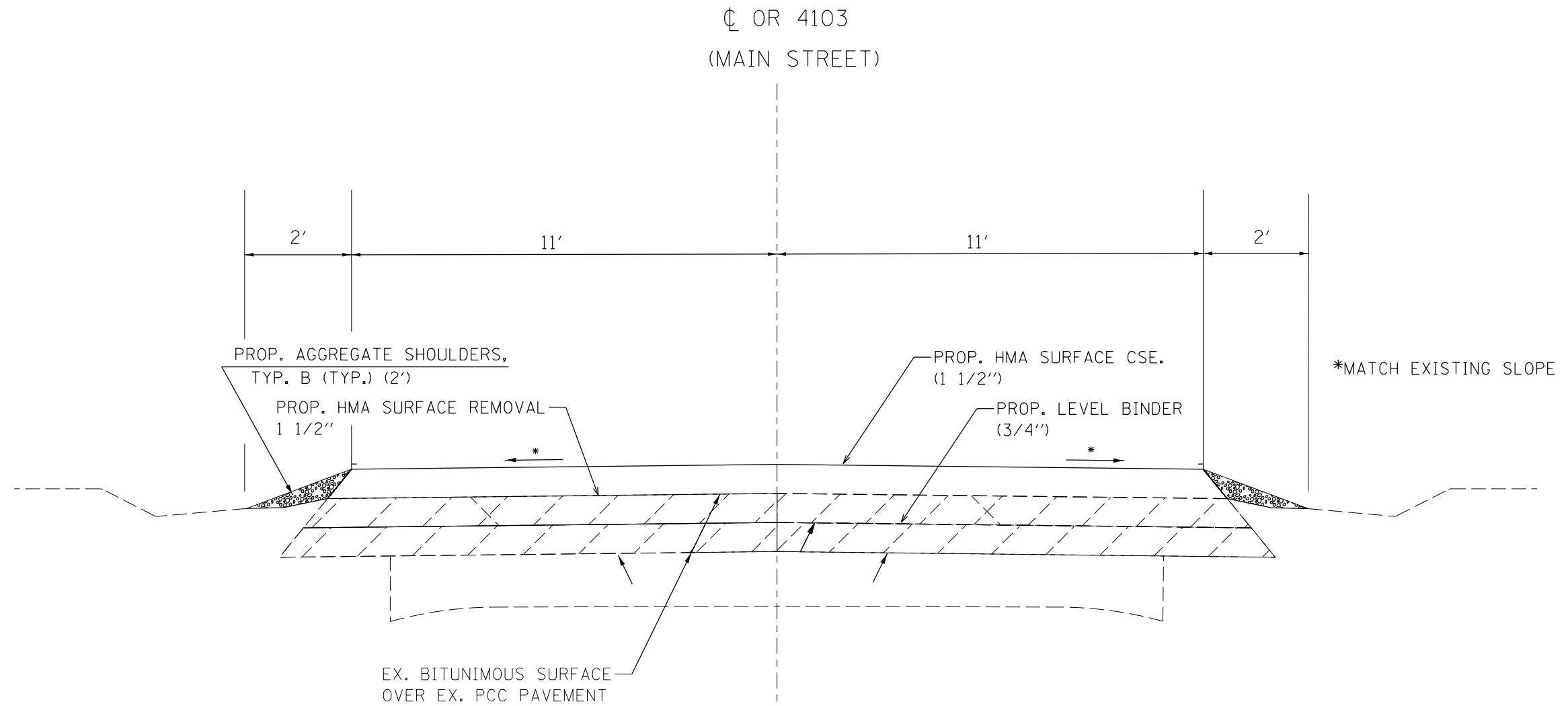

TO BE USED:  
STA. 0+00 to STA. 38+32  
STA. 38+42 to STA. 103+00

FILE NAME =	USER NAME = jacksonec	DESIGNED -	REVISED -	<b>STATE OF ILLINOIS DEPARTMENT OF TRANSPORTATION</b>	<b>INDICATED SHEETS, STANDARDS &amp; GENERAL NOTES</b>	F.A. RTE.	SECTION	COUNTY	TOTAL SHEETS	SHEET NO.	
pw:\IL\084EBIDINTEG\illinois.gov\PWIDOT\Documents\DOT Offices\District 9\Projects\78490\Drawings\CADsheets\78490.sht.dgn						4103	83RS-3	JEFFERSON	18	7	
PLOT SCALE = 100.0000' / 1in.						CHECKED -	CONTRACT NO. 78490				
Default						DATE -	SCALE:	SHEET	OF	SHEETS	STA. 0+00

## MAIN STREET (IL 15) MAINLINE RESURFACING SCHEDULE

LOCATION STATION TO STATION	LENGTH			ROADWAY WIDTH	SHOULDER WIDTH	HOT-MIX ASP. SURF. REMOV. - BUTT JT.	TEMP RAMP	HMA SUR. REMOV. 1 1/2"	HOT-MIX ASP. SUR. CSE., MIX C, N 70 (1 1/2")	HOT MIX ASPHALT BINDER COURSE, N70	LEVELING BINDER (MM) N70 (3/4")	BIT. MAT. (PRIME COAT)	AGG. WEDGE SHOULDERS, TY. B *	NOTES
	FOR INFORMATIONAL PURPOSE ONLY													
	(FT)	(FT)	(FT)	(FT)	(FT)	(SO YD)	(SO YD)	(SO YD)	(TON)	(TON)	(TON)	(LBS)	(TON)	
<b>MAINLINE: STA. 0+00 TO STA. 103+00</b>														
	+00	TO	35+00.00	3500	22		37	13	8,556	723		364	5,775	
LT	+00	TO	35+00.00	3500		2							66	
RT	+00	TO	35+00.00	3500		2							64	
	35+00.00	TO	38+32.00	332	22		37	13	812	68		35	548	
LT	35+00.00	TO	38+32.00	332		2							6	
RT	35+00.00	TO	38+32.00	332		2							6	
<b>OMISSION-STA. 38+32 TO STA. 38+42 (RAILROAD)</b>											200			FOR GRADE RAISE FROM STA.36+50 TO STA. 39+75
	38+42.00	TO	43+70.00	528	22		37	13	1291	110		55	871	
LT	38+42.00	TO	43+70.00	528		2							9	
RT	38+42.00	TO	43+70.00	528		2							9	
	43+70.00	TO	50+00.00	630	22				1,540	131		66	1,040	
LT	43+70.00	TO	50+00.00	630		2							10	
RT	43+70.00	TO	50+00.00	630		2							12	
	50+00.00	TO	60+00.00	1000	22				2,444	207		104	1,650	
LT	50+00.00	TO	60+00.00	1000		2							16	
RT	50+00.00	TO	60+00.00	1000		2							19	
	60+00.00	TO	103+00.00	4300	22		37	13	10511	888		447	7,095	
LT	60+00.00	TO	103+00.00	4300		2							80	
RT	60+00.00	TO	103+00.00	4300		2							82	
<b>MAINLINE TOTALS</b>							147	52	25,153	2,127	200	1,071	16,979	380

• NOTE: ADDITIONAL QUANTITY INCLUDED FOR LOW SHOULDERS.



### SIDE ROAD SCHEDULE

LOCATION			EXIST. SURFACE	EP WIDTH	WIDTH AT 15' OFFSET	ROADWAY AREA	INCIDENTAL HMA SURFACING	BIT. MAT. (PRIME COAT)
			FOR INFORMATIONAL PURPOSE ONLY					
				( FT )	( FT )	( SQ YD )	( TON )	( LBS )
OR 4103 MAIN STREET ( IL. 15 )								
Rt.	35+00	N. Markhan City Ln.	Aggregate	113	25	115	10	52
Lt.	43+70	E. Short Street	Oil & Chip	60	25	71	6	32
Rt.	43+70	W. Short Street	Oil & Chip	79	38	98	9	44
Lt.	47+15	E. North Street	Oil & Chip	88	30	98	9	44
Rt.	50+83	Hickory Street	Aggregate	55	24	66	6	30
Lt.	55+70	South Ave.	Oil & Chip	70	26	80	7	36
Lt.	58+12	Third Street	Oil & Chip	70	30	83	7	38
Lt.	81+67	E. Prairie Rd.	Oil & Chip	60	25	71	6	32
TOTALS							60	307

### ENTRANCE SCHEDULE

ENTRANCE TYPE	AMOUNT	EXIST. SURFACE	EP WIDTH	WIDTH AT APRON	ROADWAY AREA	INCIDENTAL HMA SURFACING	BIT. MAT. (PRIME COAT)
		FOR INFORMATIONAL PURPOSE ONLY					
		( TYPE )	( FT )	( FT )	( SQ FT )		
PE	16	Agg.	24	17	82	8	66
PE	0	O&C	24	17	82	0	0
PE	1	Bit	24	17	82	1	4
PE	0	PCC	24	17	82	0	0
CE	6	Agg.	35	30	130	5	39
CE	0	Bit.	35	30	130	0	0
CE	1	PCC	35	30	130	1	7
SUBTOTALS						14	115

## PAVEMENT MARKING SCHEDULE

US 51 CARBONDALE  LOCATION STATION TO STATION  STA      TO      STA	LENGTH  (INFO ONLY)  FEET	DESCRIPTION	PAINT PAVEMENT MARKING					LETTERS AND SYMBOLS  SQ FT	SHORT TERM PVMT MRK  FT	TEMP PVMT MRK 4"  FT	TEMP PVMT MRK 24"  FT	WORK ZONE PAVT MK REM  SQ FT	RAISED REF PVMT MKR  EACH	DESCRIPTION
			SOLID WHITE 4"	LINE - YELLOW 4"			SOLID WHITE 24"							
				LEFT SOLID FT	CENTER DASHED FT	RIGHT SOLID FT								
<b>MAIN STREET URBAN SECTION</b>														
STA 0+00.00 TO STA 35+00.00	3500	HMA	6887	1343	875	1150		420	10255		3558	44		
STA 35+00.00 TO STA 38+32.00	332	HMA	664	439	83			40	1186	22	453	4	RR CROSSING	
STA 38+42.00 TO STA 50+00.00	1158	HMA	2092		290	1460		139	3842	22	1371	14	RR CROSSING	
STA 50+00.00 TO STA 60+00.00	1000	HMA	1860		250	865		120	2975		1032	13		
STA 60+00.00 TO STA 70+00.00	1000	HMA	1940		250			120	2190		770	13		
STA 70+00.00 TO STA 80+00.00	1000	HMA	2000		250			120	2250		790	13		
STA 80+00.00 TO STA 90+00.00	1000	HMA	2000		250			120	2250		790	13		
STA 90+00.00 TO STA 100+00.00	1000	HMA	2000		250			120	2250		790	13		
STA 100+00.00 TO STA 103+00.00	300	HMA	600		75			36	675		237	4		
<b>URBAN TOTALS</b>			<b>20043</b>	<b>1782</b>	<b>2573</b>	<b>3475</b>		<b>122</b>	<b>1235</b>	<b>27873</b>	<b>44</b>	<b>9790</b>	<b>129</b>	
<b>PROJECT TOTALS</b>			<b>20043</b>	<b>1782</b>	<b>2573</b>	<b>3475</b>		<b>122</b>	<b>1235</b>	<b>27873</b>	<b>44</b>	<b>9791</b>	<b>129</b>	
			<b>27873</b>											

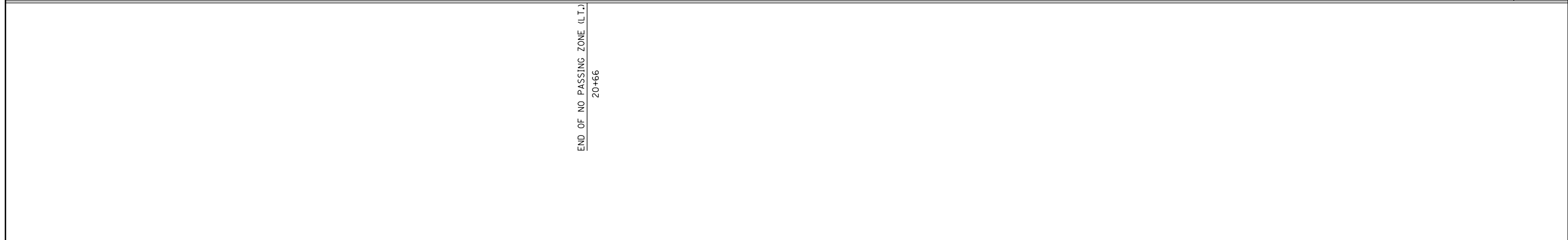
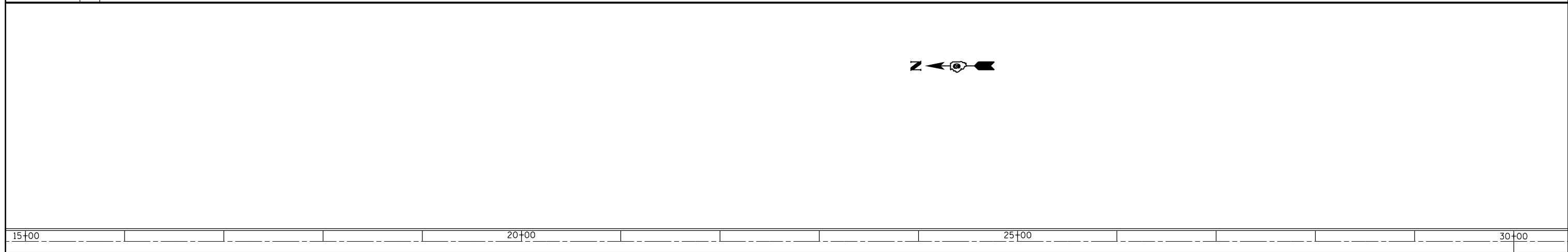
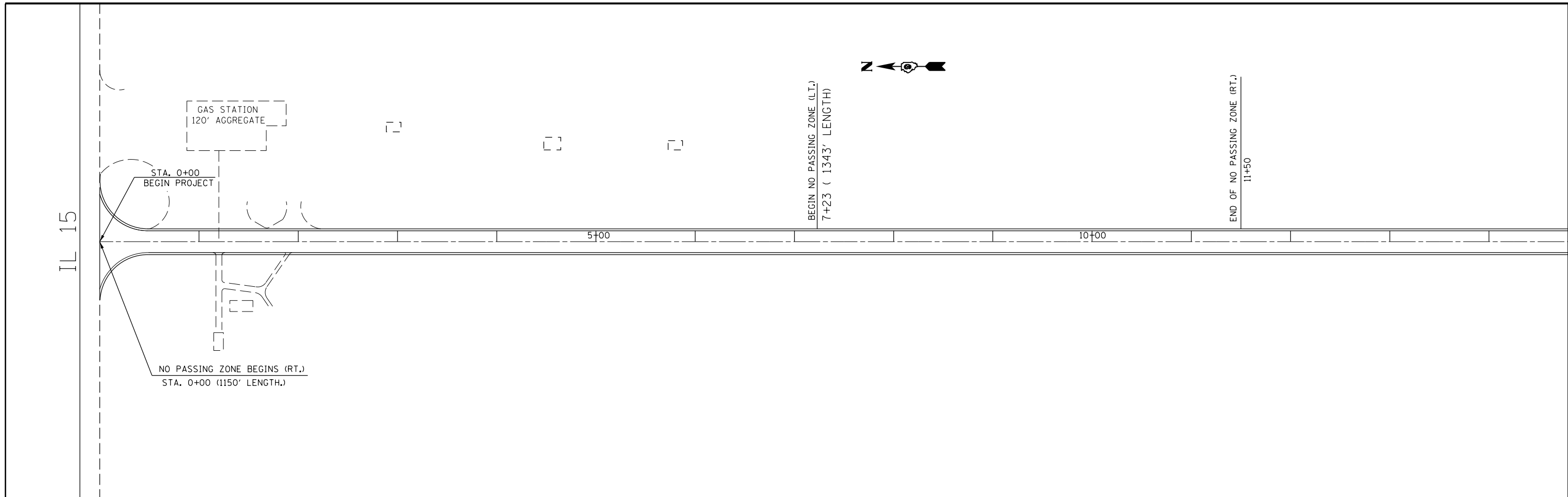

FILE NAME =	USER NAME = jacksonec	DESIGNED -	REVISED -	<b>STATE OF ILLINOIS DEPARTMENT OF TRANSPORTATION</b>	<b>PLAN LAYOUT STA. 0 + 00 TO STA. 30 + 55</b>			F.A. RTE.	SECTION	COUNTY	TOTAL SHEETS	SHEET NO.
p:\11\084EBIDINTEG.illinois.gov\PWIDOT\Documents\DOT Offices\District 9\Projects\78490\Drawings\CAD\Sheets\78490.sht.dgn		CHECKED -	REVISED -		4103	83RS-3	JEFFERSON	18	11			
Default	PLOT SCALE = 100.0000' / 1in.	DATE -	REVISED -		CONTRACT NO. 78490			ILLINOIS FED. AID PROJECT				
	PLOT DATE = 10/16/2015				SCALE:	SHEET OF SHEETS	STA. 0+00 TO STA. 103+00					

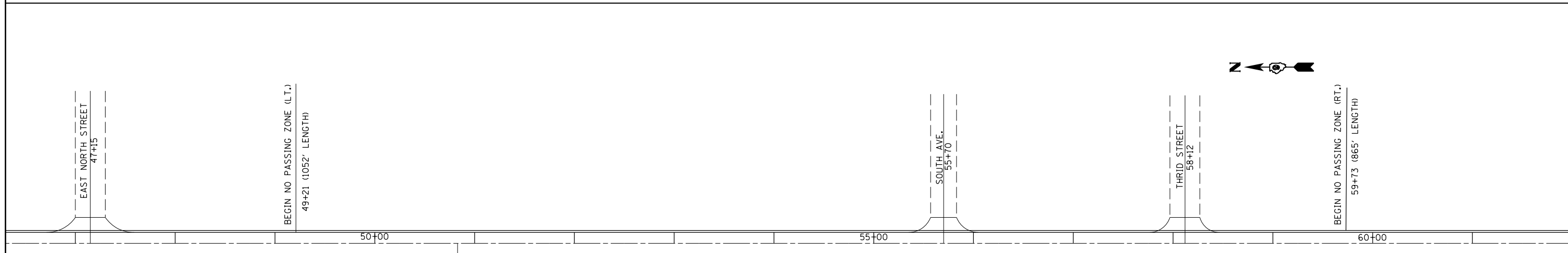
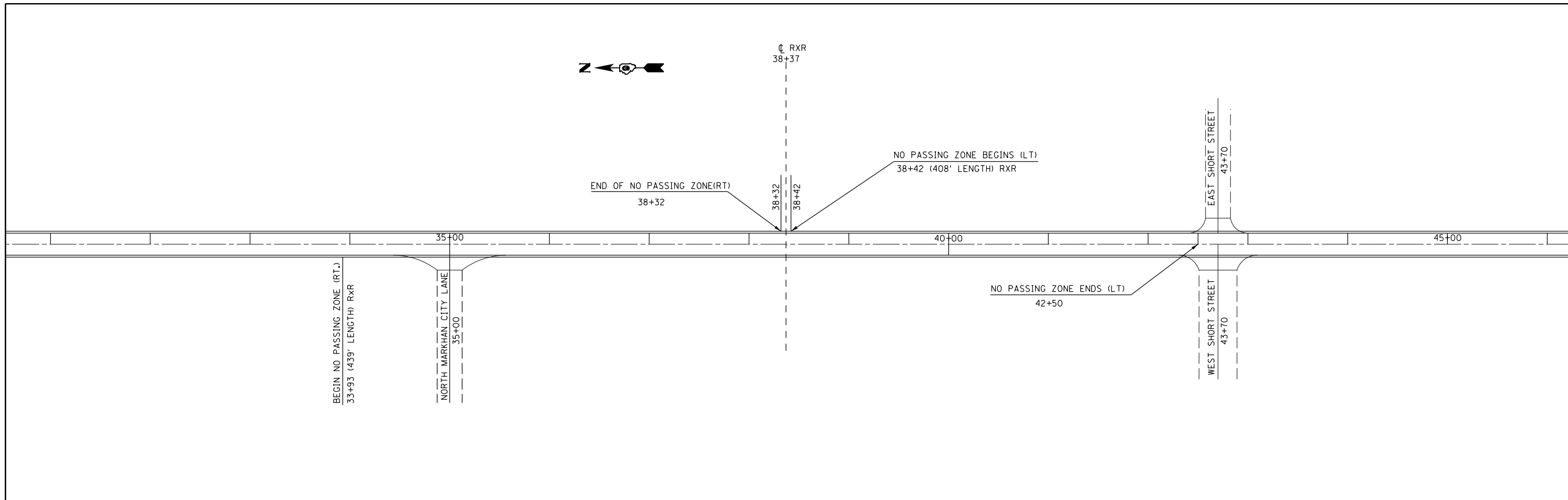

FILE NAME =	USER NAME = jacksonec	DESIGNED -	REVISED -	<b>STATE OF ILLINOIS DEPARTMENT OF TRANSPORTATION</b>	<b>PLAN LAYOUT STA. 30+55 TO STA. 62+05</b>			F.A. RTE.	SECTION	COUNTY	TOTAL SHEETS	SHEET NO.
pw:\IL\084EBIDINTEG.illinois.gov\PWIDOT\Documents\IDOT Offices\District 9\Projects\78490\Drawings\CAD\Sheets\78490.sht.dgn		CHECKED -	REVISED -		4103	83RS-3	JEFFERSON	18	12			
PLOT SCALE = 100.0000' / in.		DATE -	REVISED -		CONTRACT NO. 78490			ILLINOIS FED. AID PROJECT				
Default					SCALE:	SHEET OF SHEETS	STA. 0+00 TO STA. 103+00					



65+00

70+00

75+00

NO PASSING ZONE ENDS (RT.)  
68+38



EAST PRAIRIE ROAD  
81+67

80+00

85+00

90+00

FILE NAME =	USER NAME = jacksonec	DESIGNED -	REVISED -
p:\11\084EBIDINTEG.illinois.gov\PWIDOT\Documents\IDOT Offices\District 9\Projects\78490\CAD\Drawings\78490.sht.dgn		CHECKED -	REVISED -
Default	PLOT DATE = 10/16/2015	DATE -	REVISED -

**STATE OF ILLINOIS  
DEPARTMENT OF TRANSPORTATION**

**PLAN LAYOUT  
STA. 62 + 05 TO STA. 93 + 55**

SCALE: SHEET OF SHEETS STA. 0+00 TO STA. 103+00

F.A. RTE.	SECTION	COUNTY	TOTAL SHEETS	SHEET NO.
4103	83RS-3	JEFFERSON	18	13
ILLINOIS FED. AID PROJECT			CONTRACT NO. 78490	



DETAILS FOR  
BUTT JOINTS AT RAILROAD

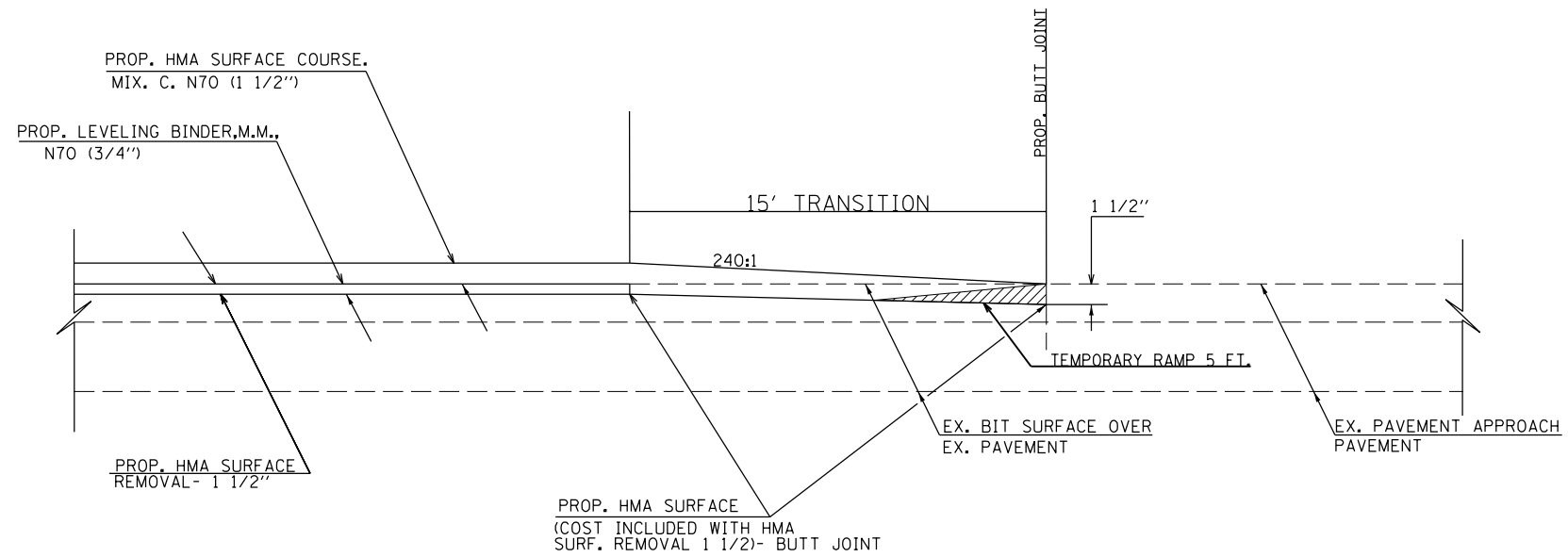

TO BE USED:  
STA. 38+32 & STA. 38+42  
(RAILROAD CROSSING)

DETAILS FOR  
BUTT JOINTS AT BEGINNING AND END  
OF PROJECT

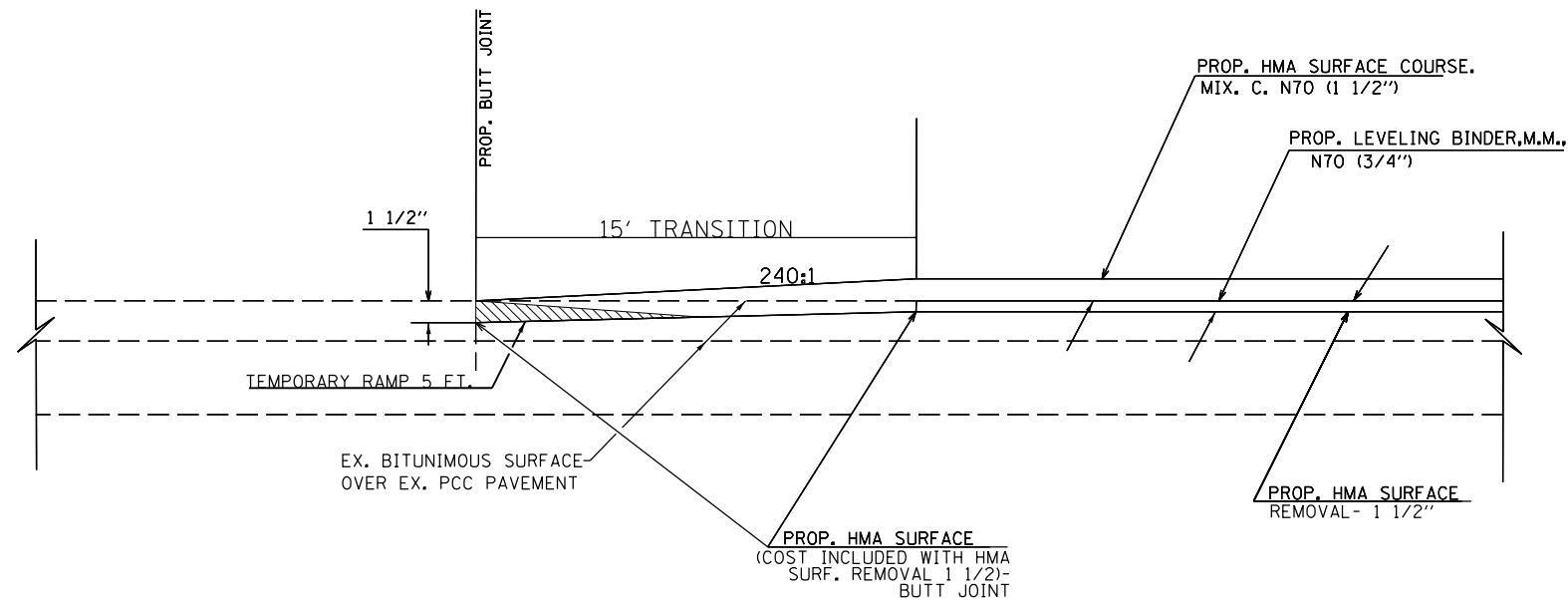

TO BE USED:  
STA. 0+00 & STA. 103+00

FILE NAME =	USER NAME = jacksonec	DESIGNED -	REVISED -	<b>STATE OF ILLINOIS DEPARTMENT OF TRANSPORTATION</b>	<b>DETAILS - BUTT JOINTS, INLAY TRANSITION AND MAILBOX TURNOUT</b>	F.A. RTE.	SECTION	COUNTY	TOTAL SHEETS	SHEET NO.	
p:\1\084EBIDINTEG.illinois.gov\PIDOT\Documents\DOT Offices\District 9\Projects\78490\Drawings\CD\Sheets\78490_sht.dgn	PLLOT SCALE = 117.2752' / in.	CHECKED -	REVISED -			4103	83RS-3	JEFFERSON	18	15	
Default	PLLOT DATE = 10/16/2015	DATE -	REVISED -			ILLINOIS FED. AID PROJECT					
						SCALE:	SHEET OF SHEETS		STA. 0+00 TO STA. 103+00		CONTRACT NO. 78490

# SIDEROAD AND ENTRANCE DETAILS

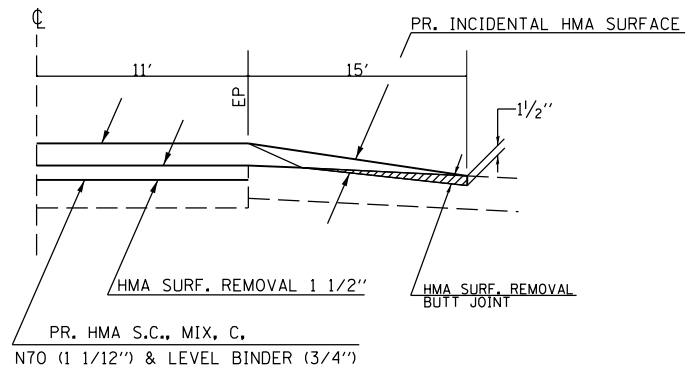

SIDEROAD SECTION B-B  
EX. BIT. OR CONC. SURFACE

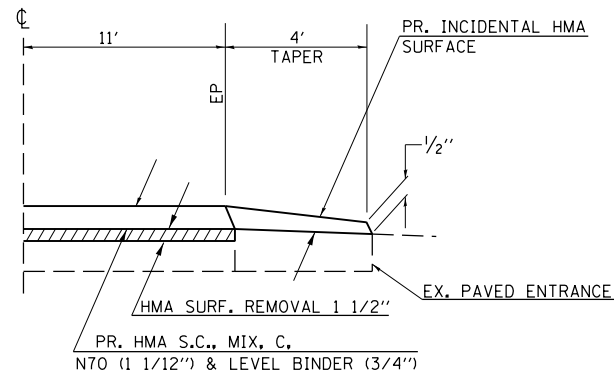

BIT. OR CONC. PE OR CE  
SIDEROAD SECTION A-A

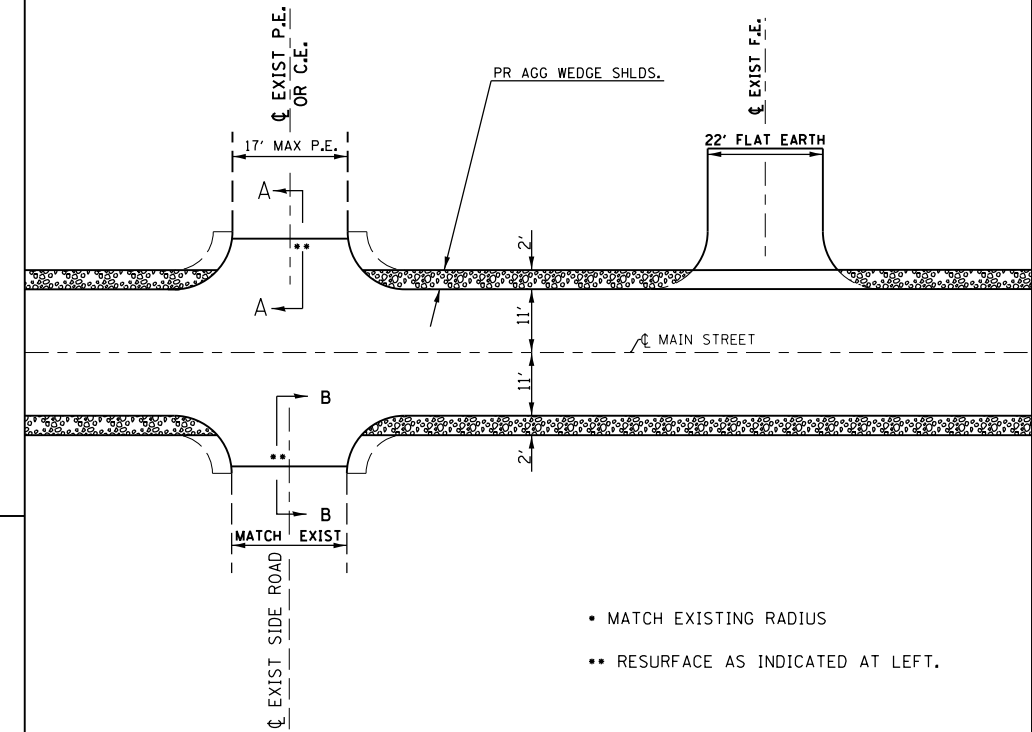

- MATCH EXISTING RADIUS
- RESURFACE AS INDICATED AT LEFT.

ENTRANCE SCHEDULE

TYPE	NUMBER OF ENTRANCES
P.E.	17
C.E.	7

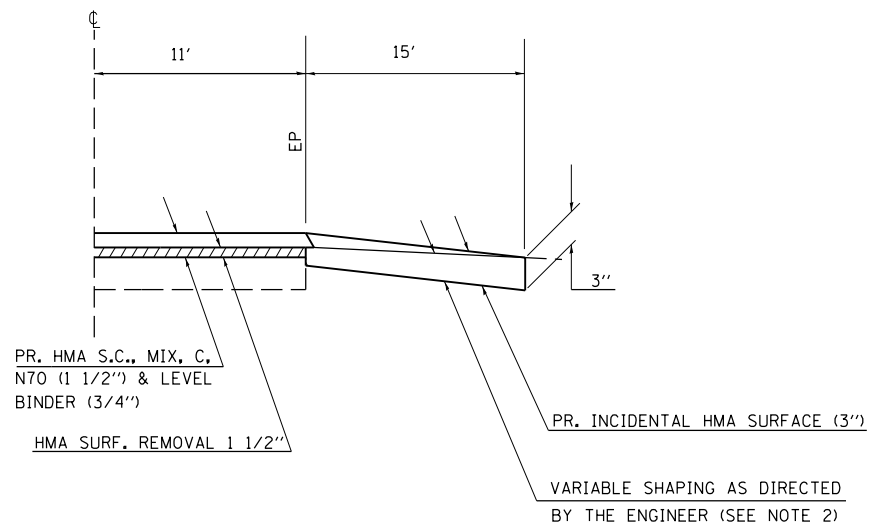

SIDEROAD SECTION B-B  
EX. AGGREGATE SURFACE  
(SEE NOTE 1)

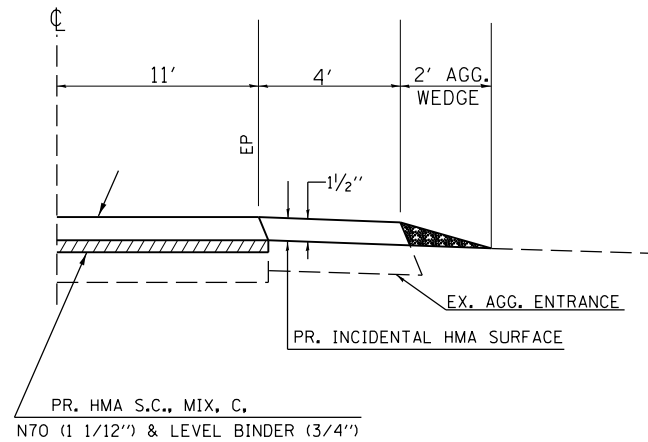

AGGREGATE PE OR CE  
SIDEROAD SECTION A-A

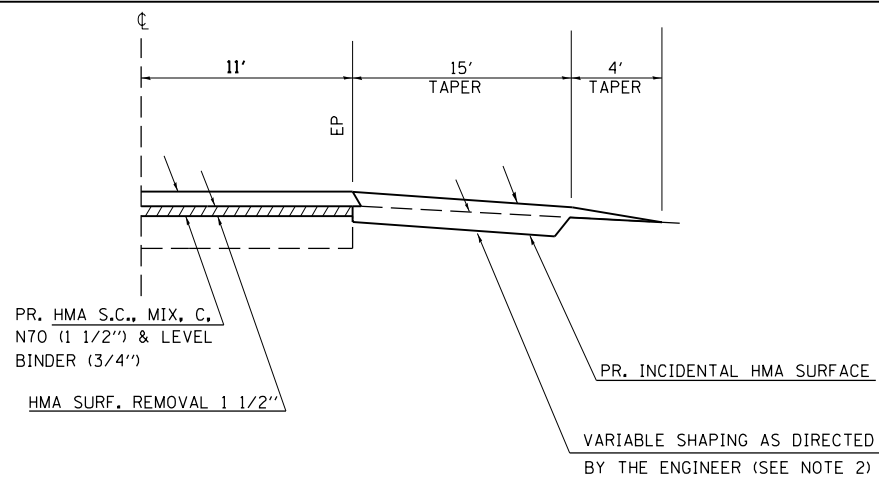

SIDEROAD SECTION B-B  
EX. OIL & CHIP SURFACE  
(SEE NOTE 1)

### NOTES

1. IF EXISTING SUB-BASE IS INADEQUATE, AS DETERMINED BY THE ENGINEER, THE SIDEROADS SHALL BE CORED OUT AND AGGREGATE SUB-BASE, TYPE B SHALL BE PLACED FOR BASE. THE COST OF CORING OUT THE SIDEROAD SHALL BE INCLUDED IN THE COST OF THE AGGREGATE BASE COURSE. IF EXISTING SUB-BASE IS DETERMINED TO BE ADEQUATE, THE AGGREGATE BASE COURSE SHALL BE DELETED AND THE PREPARATION OF THE BASE SHALL BE CONSTRUCTED ACCORDING TO ARTICLE 406.09. VARIABLE SHAPING IS INCLUDED IN THE COST OF BITUMINOUS CONCRETE SURFACE COURSE.
2. VARIABLE SHAPING IS INCLUDED IN THE COST OF INCIDENTAL HOT-MIX ASPHALT SURFACE COURSE.

FILE NAME =	USER NAME = jacksonc	DESIGNED -	REVISED -
p:\11084EBIDINTEG\illinois.gov\PIWIDOT\Documents\DOT Offices\District 9\Projects\78490\Drawings\CADsheets\78490.sht.dgn		CHECKED -	REVISED -
Default	PLOT SCALE = 100.0000' / in.	DATE -	REVISED -
	PLOT DATE = 10/16/2015		

**STATE OF ILLINOIS  
DEPARTMENT OF TRANSPORTATION**

**DETAILS - BUTT JOINTS, INLAY TRANSITION & MAILBOX TURNOUT**

SCALE: SHEET OF SHEETS STA. 0+00 TO STA. 103+00

F.A. RTE.	SECTION	COUNTY	TOTAL SHEETS	SHEET NO.
4103	83RS-3	JEFFERSON	18	16
CONTRACT NO. 78490				
ILLINOIS FED. AID PROJECT				



# TEMPORARY HOT-MIX ASPHALT TRANSITIONS

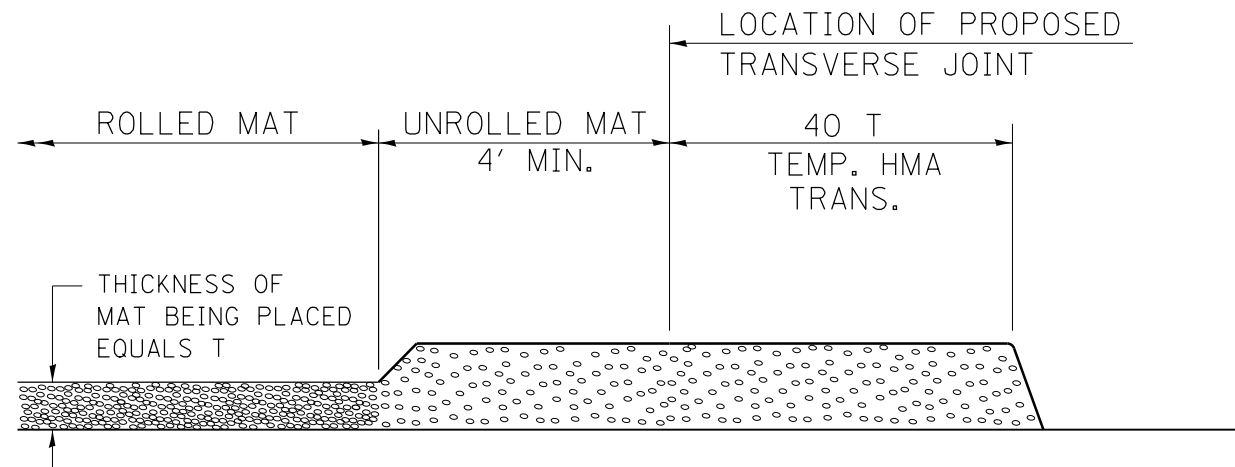

## STEP I

1. PLACE HOT-MIX ASPHALT MAT, LENGTH 40 TIMES THE THICKNESS OF THE MAT BEING PLACED PAST THE PROPOSED TRANSVERSE JOINT LOCATION USING NORMAL OPERATING PROCEDURES.
2. EXTREME CARE SHOULD BE TAKEN TO MAINTAIN ENOUGH MATERIAL IN FRONT OF THE SCREED TO MAINTAIN REQUIRED PAVING DEPTH.

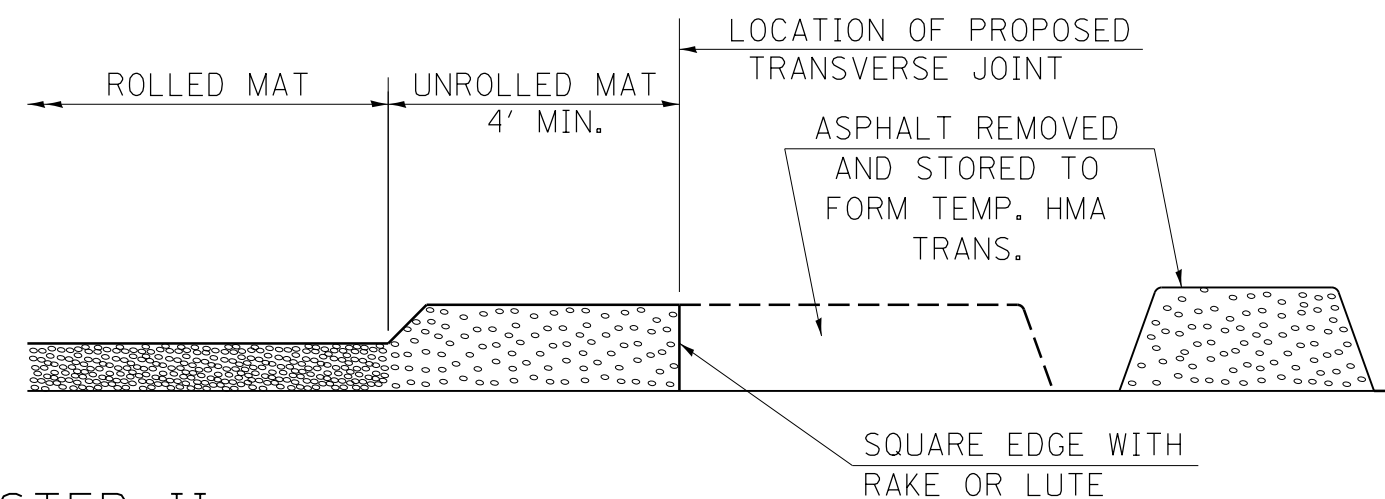

## STEP II

1. MOVE THE PAVER OUT OF THE WAY AND REMOVE THE ASPHALT FROM THE AREA OF THE PROPOSED TEMPORARY HOT-MIX ASPHALT TRANSITION.
2. SQUARE UP THE END OF THE MAT WITH A RAKE OR LUTE.
3. NOTE THAT THE MAT WITHIN 4' OF THE END OF JOINT IS NOT TO BE ROLLED AT THIS TIME.

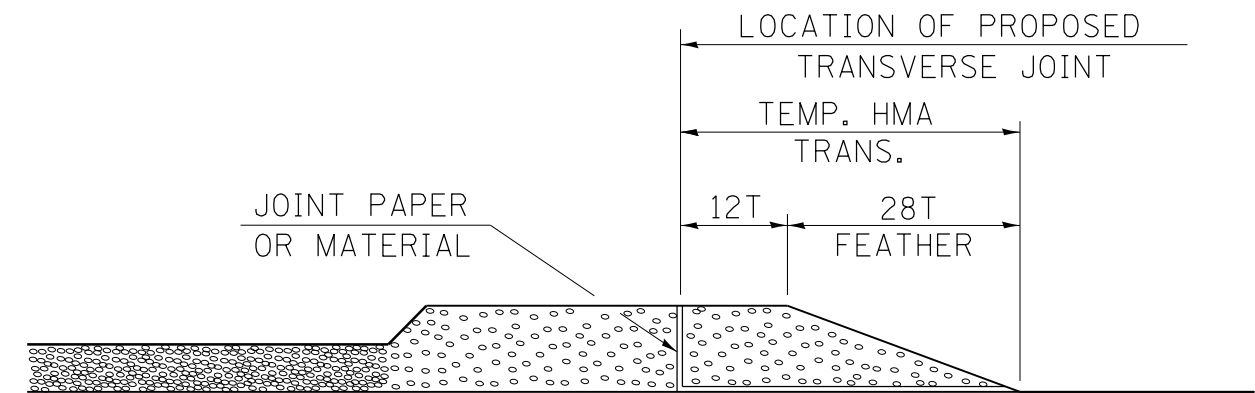

## STEP III

1. JOINT PAPER OR OTHER PRESELECTED JOINT MATERIAL IS THEN PLACED IN THE CLEARED AREA AND THE EXCESS ASPHALT USED TO HAND FORM A TRANSITION TO THE DIMENSIONS SHOWN ABOVE.
2. NOTE THAT IN CONSTRUCTING THE TRANSITION, THE MAT DEPTH IS CONTINUED AS PART OF THE TRANSITION BEFORE FORMING THE FEATHER.

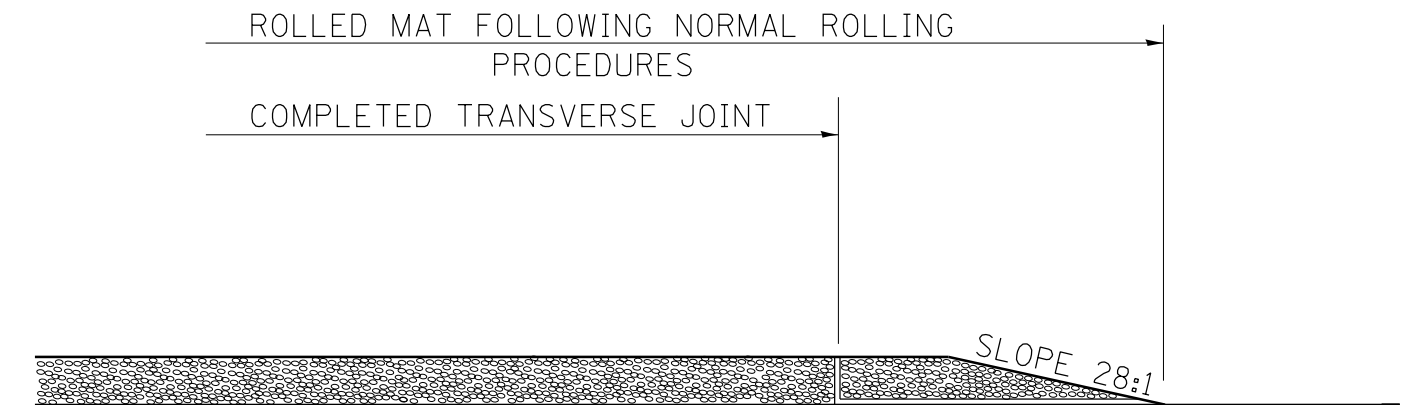

## STEP IV

1. COMPLETE TEMPORARY TRANSITION BY ROLLING.
2. TO RESUME PAVING, AT THE JOINT, REMOVE TEMPORARY TRANSITION AND DISPOSE OF THE MATERIAL ACCORDING TO ART. 202.03 OF THE STD. SPECS. (COST INCLUDED IN THE CONTRACT).
3. CONSTRUCTING THE TEMPORARY TRANSITIONS WILL NOT BE PAID FOR SEPARATELY IN ACCORDANCE WITH ARTICLE 406.14 OF THE STANDARD SPECIFICATIONS.

### REVISIONS

REDRAWN	2-15-89
REVISED	8-16-94
REVISED	01-09-07
RESIZED	
REVISED	05-16-13

FILE NAME =	USER NAME = jacksonc	DESIGNED -	REVISED -	<b>STATE OF ILLINOIS DEPARTMENT OF TRANSPORTATION</b>	<b>TEMP. HOT-MIX ASPHALT TRANSITION</b>	F.A. RTE.	SECTION	COUNTY	TOTAL SHEETS	SHEET NO.
pw:\IL\084EBIDINTEG.illinois.gov\PIWIDOT\Documents\IDOT Offices\District 9\Projects\78490\Drawings\CADsheets\78490.sht.dgn	PLOT SCALE = 100.0000' / in.	CHECKED -	REVISED -			4103	83RS-3	JEFFERSON	18	17
Default	PLOT DATE = 10/16/2015	DATE -	REVISED -			CONTRACT NO. 78490			ILLINOIS FED. AID PROJECT	
						SCALE:	SHEET	OF	SHEETS	STA. 0+00

**ILLINOIS STANDARD**

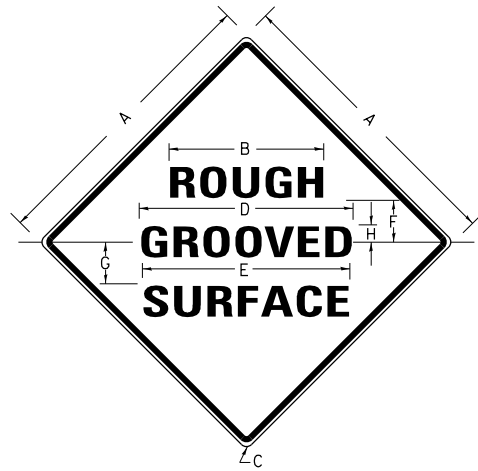

**COLORS:**

LEGEND AND BORDER- BLACK NON-REFLECTORIZED  
BACKGROUND- ORANGE REFLECTORIZED

SIGN SIZE	DIMENSIONS							
	A	B	C	D	E	F	G	H
48X48	48.0	24.1	3.0	34.0	33.0	6.0	13.0	3.5

SIGN SIZE	SERIES LINES			MAR-GIN	BOR- DER	BLANK STD.
	1	2	3			
48X48	7C	7C	7C	0.8	1.2	B4-48D

ALL DIMENSIONS IN INCHES

**NOTES:**

PRIOR TO ALLOWING TRAFFIC ON ANY PORTION OF THE ROADWAY THAT HAS BEEN COLDMILLED, THE CONTRACTOR SHALL HAVE ERECTED "ROUGH GROOVED SURFACE" SIGNS THAT CONFORM TO THE ABOVE DETAILS. A MINIMUM OF ONE SIGN AT EACH END OF THE IMPROVEMENT WILL BE REQUIRED. THE CONTRACTOR SHALL MAINTAIN THE "ROUGH GROOVED SURFACE" SIGNS UNTIL THE COLDMILLED SURFACE IS COVERED WITH LEVELING BINDER OR SURFACE COURSE.

IF AT ANY TIME THE SIGNS ARE IN PLACE BUT NOT APPLICABLE, THEY SHALL BE TURNED FROM THE VIEW OF MOTORISTS OR COVERED AS DIRECTED BY THE ENGINEER.

THE COST OF FURNISHING, ERECTING, MAINTAINING, AND REMOVING THE REQUIRED SIGNS SHALL BE INCLUDED IN THE CONTRACT.

REVISIONS	
REDRAWN	2-15-89
REVISED	4-6-93
REVISED	3-27-08
REVIEWED	5-17-13

STD. 9-39

**UNEVEN LANES SIGN**

W8-11 (48" x 48")

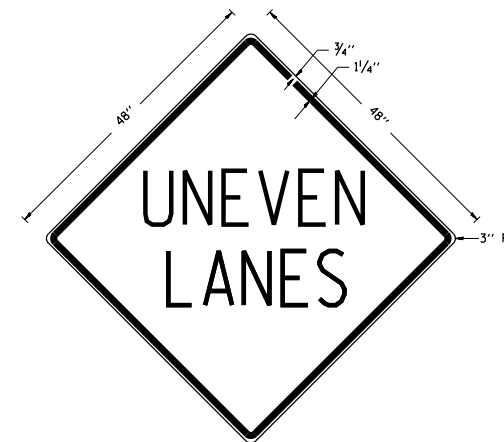

**COLORS:**

LEGEND AND BORDER - BLACK NON-REFLECTORIZED  
BACKGROUND - ORANGE REFLECTORIZED

**NOTE:** PRIOR TO ALLOWING TRAFFIC ON ANY PORTION OF THE ROADWAY THAT HAS BEEN COLDMILLED OR BEFORE RESURFACING OPERATIONS BEGIN, THE CONTRACTOR SHALL HAVE ERECTED "UNEVEN PAVEMENT" SIGNS THAT CONFORM TO THE ABOVE DETAILS. A MINIMUM OF ONE SIGN AT EACH END OF THE IMPROVEMENT WILL BE REQUIRED. THE CONTRACTOR SHALL MAINTAIN THE "UNEVEN PAVEMENT" SIGNS UNTIL THE RESURFACING OPERATIONS ARE COMPLETED.

IF AT ANY TIME THE SIGNS ARE IN PLACE BUT NOT APPLICABLE, THEY SHALL BE TURNED FROM THE VIEW OF MOTORISTS OR COVERED AS DIRECTED BY THE ENGINEER.

THE COST OF FURNISHING, ERECTING, MAINTAINING, AND REMOVING THE REQUIRED SIGNS SHALL BE INCLUDED IN THE CONTRACT.

REVISIONS	
DRAWN	2-15-89
REVISED	4-06-93
REDESIGNED	7-23-04
RESIZED	5-08-08
REVIEWED	5-17-13

STD. 9-41

FILE NAME =	USER NAME = jacksonc	DESIGNED -	REVISED -
p:\11\084EBIDINTEG.illinois.gov\PIWIDOT\Documents\DOT Offices\District 9\Projects\78490\Drawings\CAD\Sheets\78490.sht.dgn		DRAWN -	REVISED -
Default	PLOT SCALE = 100.0000' / 1in.	CHECKED -	REVISED -
	PLOT DATE = 10/16/2015	DATE -	REVISED -

**STATE OF ILLINOIS  
DEPARTMENT OF TRANSPORTATION**

**DETAIL: UNEVEN LANES SIGN;  
ROUGH GROOVED SURFACE SIGN**

SCALE: SHEET OF SHEETS STA. 0+00 TO STA. 103+00

F.A. * RTE.	SECTION	COUNTY	TOTAL SHEETS	SHEET NO.
4103	83RS-3	JEFFERSON	18	18
CONTRACT NO. 78490				
ILLINOIS FED. AID PROJECT				