

1. COVER SHEET
2. GENERAL NOTES
- 3 - 4. SUMMARY OF QUANTITIES
5. TYPICAL SECTIONS
6. SCHEDULES FOR LOCATION NO. 1, 006-0041(SB) AND LOCATION NO. 2, 006-0042 (NB)
7. SCHEDULES FOR LOCATION NO. 3, 006-0043(NB) AND LOCATION NO. 4, 006-0044 (SB)
8. TRAFFIC CONTROL AND PROTECTION, STANDARD 701400
9. TRAFFIC CONTROL AND PROTECTION, STANDARD 701402 - STAGE I
10. TRAFFIC CONTROL AND PROTECTION, STANDARD 701402 - STAGE II
- 11 - 14. EXISTING STRUCTURE DETAILS: LOCATION NO. 1, STRUCTURE NO. 006-0041 (SB) AND LOCATION NO. 2, STRUCTURE NO. 006-0042 (NB)
- 15 - 17. EXISTING STRUCTURE DETAILS: LOCATION NO. 3, STRUCTURE NO. 006-0043 (NB) AND LOCATION NO. 2, STRUCTURE NO. 006-00442 (SB)

STANDARDS

- | | |
|-----------|--|
| 000001-08 | STANDARD SYMBOLS, ABBREVIATIONS AND PATTERNS |
| 001006 | DECIMAL OF AN INCH AND OF A FOOT |
| 701101-05 | OFF-ROAD OPERATIONS, MULTILANE, 15' (4.5 m) TO 24" (600 mm) FROM PAVEMENT EDGE |
| 701106-02 | OFF-ROAD OPERATIONS, MULTILANE, MORE THAN 15' (4.5 m) AWAY |
| 701426-09 | LANE CLOSURE, MULTILANE INTERMITTENT OR MOVING OPERATION, FOR SPEEDS ≥ 45 MPH |
| 701428-01 | TRAFFIC CONTROL, SETUP AND REMOVAL, FREEWAY/EXPRESSWAY |
| 701901-08 | TRAFFIC CONTROL DEVICES |
| 704001-08 | TEMPORARY CONCRETE BARRIER |
| 782006-01 | GUARDRAIL AND BARRIER WALL REFLECTOR MOUNTING DETAILS |

**STATE OF ILLINOIS
DEPARTMENT OF TRANSPORTATION**

**PROPOSED
HIGHWAY PLANS**

**F.A.I. ROUTE 180 (I-180)
SECTION (06-1B)BP & (06-1B-1)BP
PROJECT NHPP-69JS(086)
BRIDGE PAINTING
BUREAU COUNTY**

C-93-112-20

F.A.I. RTE.	SECTION	COUNTY	TOTAL SHEETS	SHEET NO.
180	(06-1B)BP & (06-1B-1)BP	BUREAU	17	1
		ILLINOIS	CONTRACT NO. 66L26	

D-93-078-20



FUNCTIONAL CLASSIFICATION
RURAL
INTERSTATE
F.A.I. ROUTE 180 (I-180)
2017 ADT = 2650
P.V. 61.5% S.U. 6.4% M.U. 32.1%

STATE OF ILLINOIS
DEPARTMENT OF TRANSPORTATION

SUBMITTED October 15, 2020
Muhammad Ahmad
REGIONAL ENGINEER

December 4, 2020
Saeed A. Elk
ENGINEER OF DESIGN AND ENVIRONMENT

December 4, 2020
James J. Quinn
DIRECTOR OF HIGHWAYS PROJECT IMPLEMENTATION 13

**PRINTED BY THE AUTHORITY
OF THE STATE OF ILLINOIS**

PROJECT LOCATION

LOCATION 1: STRUCTURE NO. 006-0041 (SB)
LOCATION 2: STRUCTURE NO. 006-0042 (NB)
CARRYING FAI 180 (I-180) OVER
EAST BUREAU CREEK 2.54 MILES NORTH OF IL 26

PROJECT LOCATION

LOCATION 3: STRUCTURE NO. 006-0043 (NB)
LOCATION 4: STRUCTURE NO. 006-0044 (SB)
CARRYING FAI 180 (I-180) OVER
BRUSH CREEK 2.04 MILES NORTH OF IL 26

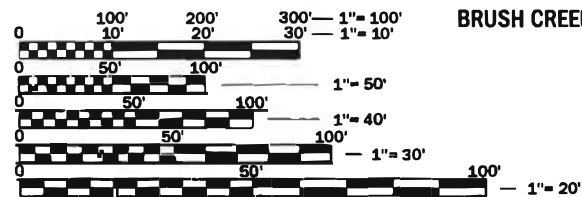

FULL SIZE PLANS HAVE BEEN PREPARED USING STANDARD ENGINEERING SCALES. REDUCED SIZED PLANS WILL NOT CONFORM TO STANDARD SCALES. IN MAKING MEASUREMENTS ON REDUCED PLANS, THE ABOVE SCALES MAY BE USED.

J.U.L.I.E.
JOINT UTILITY LOCATION INFORMATION FOR EXCAVATION
1-800-892-0123
OR 811

PROJECT ENGINEER JOE KANNEL P.E.
UNIT CHIEF RON WOODSHANK
DISTRICT 3 NO. (815) 434-6131
CONTRACT NO. 66L26

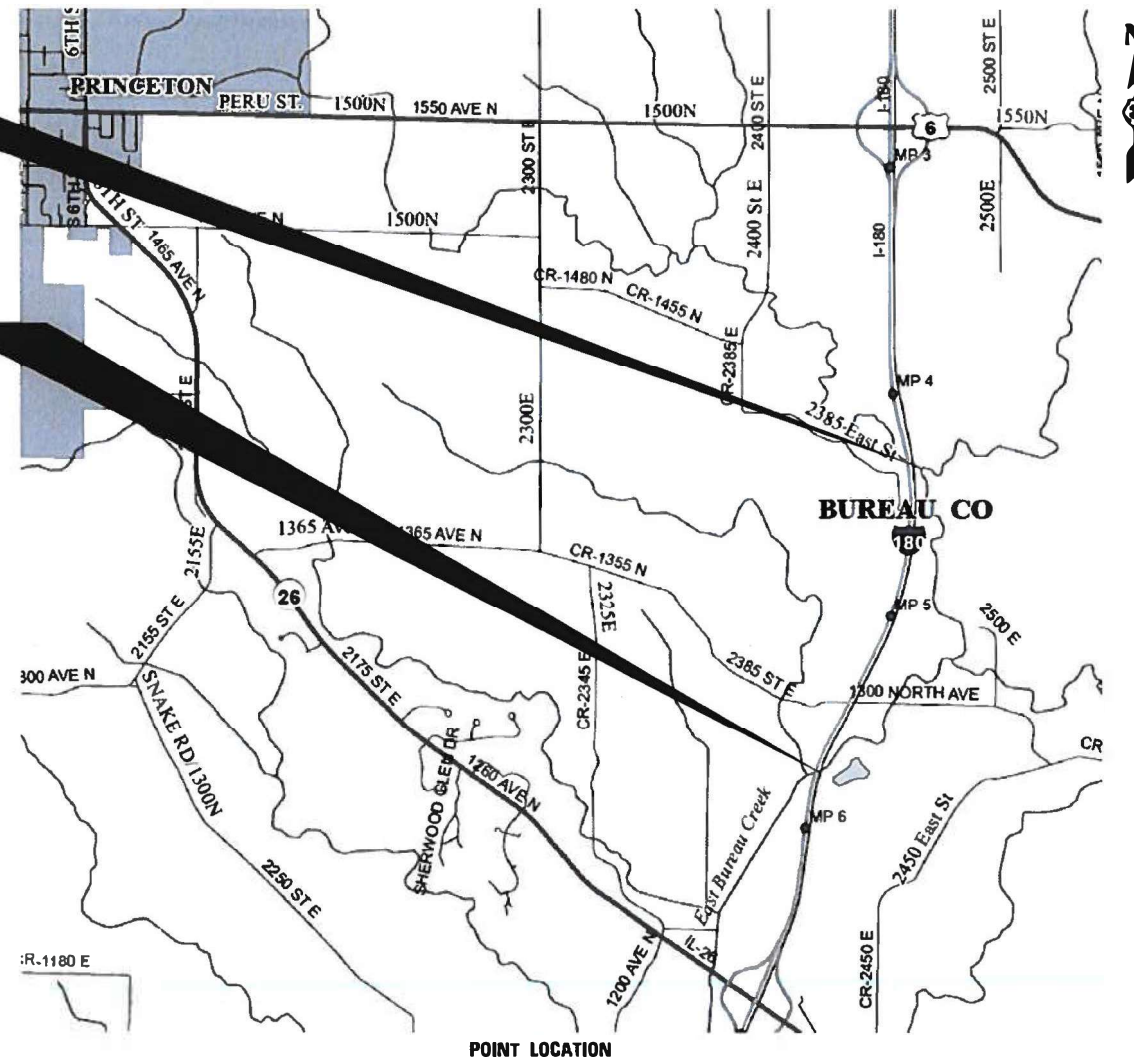

CONSTRUCTION CODE
BRIDGE PAINTING
90% FED. 10% STATE
BRIDGE
0047
RURAL

CODE NO.	ITEM	UNIT	TOTAL QUANTITY	
67100100	MOBILIZATION	L SUM	1	1
70100207	TRAFFIC CONTROL AND PROTECTION, STANDARD 701402	EACH	2	2
70107025	CHANGEABLE MESSAGE SIGN	CAL DA	28	28
70400100	TEMPORARY CONCRETE BARRIER	FOOT	800	800
70400200	RELOCATE TEMPORARY CONCRETE BARRIER	FOOT	800	800
70600250	IMPACT ATTENUATORS, TEMPORARY (NON- REDIRECTIVE), TEST LEVEL 3	EACH	4	4
70600350	IMPACT ATTENUATORS, RELOCATE (NON- REDIRECTIVE), TEST LEVEL 3	EACH	4	4
* 78008210	POLYUREA PAVEMENT MARKING TYPE I - LINE 4"	FOOT	6680	6680
* 78008230	POLYUREA PAVEMENT MARKING TYPE I - LINE 6"	FOOT	2332	2332
* X0327980	PAVEMENT MARKING REMOVAL - WATER BLASTING	SQ FT	2204	2204
X0970001	WORK ZONE SPEED LIMIT SIGN ASSEMBLY	CAL DA	81	81
X2700001	TEMPORARY RUMBLE STRIPS (SPECIAL)	EACH	8	8
X5067501	BRIDGE CLEANING AND PAINTING WARRANTY NUMBER 1	L SUM	1	1
X5067502	BRIDGE CLEANING AND PAINTING WARRANTY NUMBER 2	L SUM	1	1

*= SPECIALTY ITEM

MODEL: Default
 FILE: Model: P:\pub\lanroom.dwg
 PROJECT: R:\Projects\66L26\CADD\66L26\CADD\66L26\cover.dgn

USER NAME = MARINIEJ	DESIGNED -	REVISED -
PLOT SCALE = 3.9370 ' / mm	DRAWN -	REVISED -
PLOT DATE = 10/15/2020	CHECKED -	REVISED -
	DATE -	REVISED -

**STATE OF ILLINOIS
DEPARTMENT OF TRANSPORTATION**

SUMMARY OF QUANTITIES

SCALE: SHEET 1 OF 2 SHEETS STA. TO STA.

F.A.J RTE.	SECTION	COUNTY	TOTAL SHEETS	SHEET NO.
180	(06-1B)BP & (06-1B-1)BP	BUREAU	17	3
CONTRACT NO. 66L26			ILLINOIS FED. AID PROJECT	

CONSTRUCTION CODE
BRIDGE PAINTING
90% FED. 10% STATE
BRIDGE
0047
RURAL

CODE NO.	ITEM	UNIT	TOTAL QUANTITY	
X5067503	BRIDGE CLEANING AND PAINTING WARRANTY NUMBER 3	L SUM	1	1
X5067504	BRIDGE CLEANING AND PAINTING WARRANTY NUMBER 4	L SUM	1	1
Z0007101	CONTAINMENT AND DISPOSAL OF LEAD PAINT CLEANING RESIDUES NO. 1	L SUM	1	1
Z0007102	CONTAINMENT AND DISPOSAL OF LEAD PAINT CLEANING RESIDUES NO. 2	L SUM	1	1
Z0007103	CONTAINMENT AND DISPOSAL OF LEAD PAINT CLEANING RESIDUES NO. 3	L SUM	1	1
Z0007104	CONTAINMENT AND DISPOSAL OF LEAD PAINT CLEANING RESIDUES NO. 4	L SUM	1	1
Z0010501	CLEANING AND PAINTING STEEL BRIDGE NO. 1	L SUM	1	1
Z0010502	CLEANING AND PAINTING STEEL BRIDGE NO. 2	L SUM	1	1
Z0010503	CLEANING AND PAINTING STEEL BRIDGE NO. 3	L SUM	1	1
Z0010504	CLEANING AND PAINTING STEEL BRIDGE NO. 4	L SUM	1	1

MODEL: Default
 FILE: \\marie2-pub\lanroom\data\illinois.gov\RWIDOT\Documents\DOT_Offices\District 3\Projects\0366L26\CADD\data\0366L26-cover.dgn

USER NAME = MARINIEJ	DESIGNED -	REVISED -
	DRAWN -	REVISED -
PLOT SCALE = 3.9370 ' / mm	CHECKED -	REVISED -
PLOT DATE = 10/15/2020	DATE -	REVISED -

**STATE OF ILLINOIS
DEPARTMENT OF TRANSPORTATION**

SUMMARY OF QUANTITIES

SCALE: SHEET 2 OF 2 SHEETS STA. TO STA.

F.A.J RTE.	SECTION	COUNTY	TOTAL SHEETS	SHEET NO.
180	(06-1B)BP & (06-1B-1)BP	BUREAU	17	4
ILLINOIS FED. AID PROJECT			CONTRACT NO. 66L26	

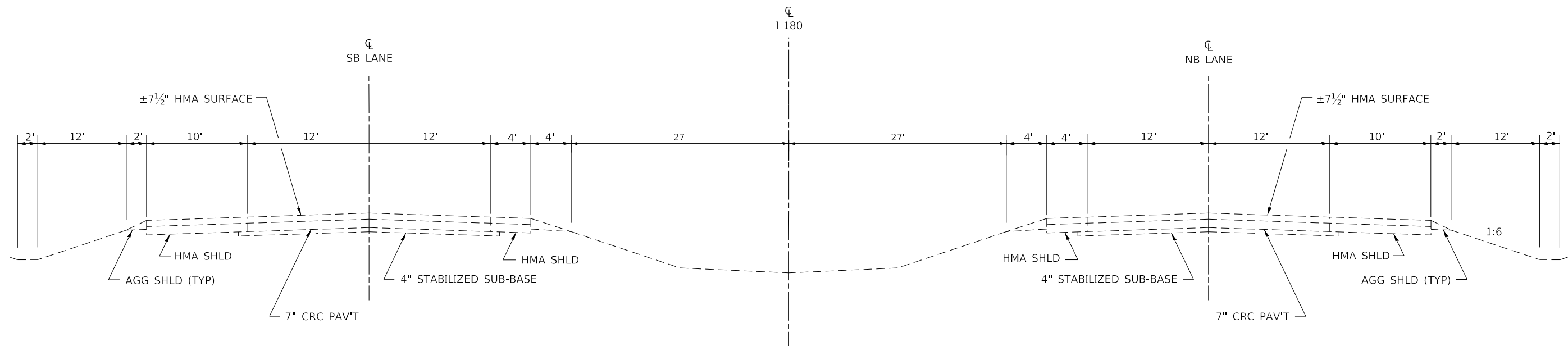

**TYPICAL SECTION
I-180**

MODEL: Default
FILE: h:\m\c\p\suplanroom.d\illinois.gov\RWIDOT\Documents\DOT_Offices\District_3\Projects\I180\66L26\CADD\data\366L26\cover.dgn

USER NAME = MARINIEJ	DESIGNED -	REVISED -
	DRAWN -	REVISED -
PLOT SCALE = 3.9370' / mm	CHECKED -	REVISED -
PLOT DATE = 10/15/2020	DATE -	REVISED -

**STATE OF ILLINOIS
DEPARTMENT OF TRANSPORTATION**

TYPICAL SECTIONS	
SCALE:	SHEET 1 OF 1 SHEETS STA. TO STA.

F.A.J RTE.	SECTION	COUNTY	TOTAL SHEETS	SHEET NO.
180	(06-1B)BP & (06-1B-1)BP	BUREAU	17	5
CONTRACT NO. 66L26				
ILLINOIS FED. AID PROJECT				

**SCHEDULE
TRAFFIC CONTROL AND PROTECTION**

LOCATION	TRAFFIC CONTROL AND PROTECTION STANDARD 701402	CHANGEABLE MESSAGE SIGN	TEMPORARY CONCRETE BARRIER	RELOCATE TEMPORARY CONCRETE BARRIER	IMPACT ATTENUATORS, TEMPORARY (NON-REDIRECTIVE), TEST LEVEL 3	IMPACT ATTENUATORS, RELOCATE (NON-REDIRECTIVE), TEST LEVEL 3
	EACH	CAL DA	FOOR	FOOT	EACH	EACH
STRUCTURE NO. 006-0041 (SB)	1	36	400		2	
STRUCTURE NO. 006-0042 (NB)				400		2
TOTAL	1	36	400	400	2	2

**SCHEDULE
PAVEMENT MARKING**

LOCATION	PAVEMENT MARKING REMOVAL WATERBLASTING	POLYUREA PAVEMENT MARKING TYPE I LINE 4"	POLYUREA PAVEMENT MARKING TYPE I LINE 6"
	EACH	EACH	EACH
STRUCTURE NO. 006-0041 (SB)	551	1670	583
STRUCTURE NO. 006-0042 (NB)	551	1670	583
TOTAL	1102	3340	1166

**SCHEDULE
BRIDGE PAINTING**

LOCATION	BRIDGE CLEANING AND PAINTING WARRANTY NUMBER 1	BRIDGE CLEANING AND PAINTING WARRANTY NUMBER 2	CONTAINMENT AND DISPOSAL LEAD PAINT CLEANING RESIDUES NO. 1	CONTAINMENT AND DISPOSAL LEAD PAINT CLEANING RESIDUES NO. 2	CLEANING AND PAINTING STEEL BRIDGE NO. 1	CLEANING AND PAINTING STEEL BRIDGE NO. 2
	L SUM	L SUM	L SUM	L SUM	L SUM	L SUM
STRUCTURE NO. 006-0041 (SB)	1		1		1	
STRUCTURE NO. 006-0042 (NB)		1		1		1
TOTAL	1	1	1	1	1	1

MODEL: Default
FILE: \\nas101.psu.edu\pub\baronm\data\illinois\pwr\DOT\Documents\DOT_Offices\Dir\trct_3\Project\0366L26\CADD\0366L26-cover.dgn

SCHEDULE
TRAFFIC CONTROL AND PROTECTION

LOCATION	TRAFFIC CONTROL AND PROTECTION STANDARD 701402	CHANGEABLE MESSAGE SIGN	TEMPORARY CONCRETE BARRIER	RELOCATE TEMPORARY CONCRETE BARRIER	IMPACT ATTENUATORS, TEMPORARY (NON-REDIRECTIVE), TEST LEVEL 3	IMPACT ATTENUATORS, RELOCATE (NON-REDIRECTIVE), TEST LEVEL 3
	EACH	CAL DA	FOOR	FOOT	EACH	EACH
STRUCTURE NO. 006-0043 (NB)	1	45	400		2	
STRUCTURE NO. 006-0044 (SB)				400		2
TOTAL	1	45	400	400	2	2

SCHEDULE
PAVEMENT MARKING

LOCATION	PAVEMENT MARKING REMOVAL WATERBLASTING	POLYUREA PAVEMENT MARKING TYPE I LINE 4"	POLYUREA PAVEMENT MARKING TYPE I LINE 6"
	EACH	EACH	EACH
STRUCTURE NO. 006-0043 (NB)	551	1670	583
STRUCTURE NO. 006-0044 (SB)	551	1670	583
TOTAL	1102	3340	1166

SCHEDULE
BRIDGE PAINTING

LOCATION	BRIDGE CLEANING AND PAINTING WARRANTY NUMBER 3	BRIDGE CLEANING AND PAINTING WARRANTY NUMBER 4	CONTAINMENT AND DISPOSAL LEAD PAINT CLEANING RESIDUES NO. 3	CONTAINMENT AND DISPOSAL LEAD PAINT CLEANING RESIDUES NO. 4	CLEANING AND PAINTING STEEL BRIDGE NO. 3	CLEANING AND PAINTING STEEL BRIDGE NO. 4
	L SUM	L SUM	L SUM	L SUM	L SUM	L SUM
STRUCTURE NO. 006-0041 (SB)	1		1		1	
STRUCTURE NO. 006-0042 (NB)		1		1		1
TOTAL	1	1	1	1	1	1

MODEL: Default
FILE: \\nas101.psw.ibm.com\data\illinois.gov\PROJECTS\DOT Documents\DOT Office\District 3\Project\0366L26\CADD\data\0366L26-cover.dgn

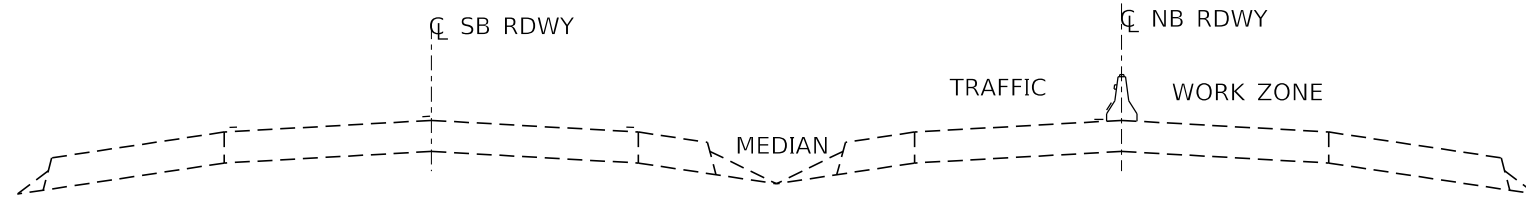

CROSS SECTION
STAGE I

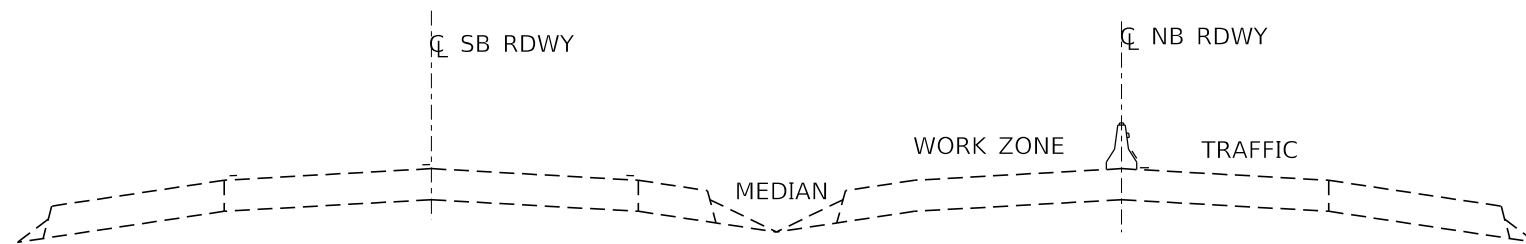

CROSS SECTION
STAGE II

STAGE II RELOCATE TEMPORARY CONCRETE BARRIER - TAPER ONLY (175')

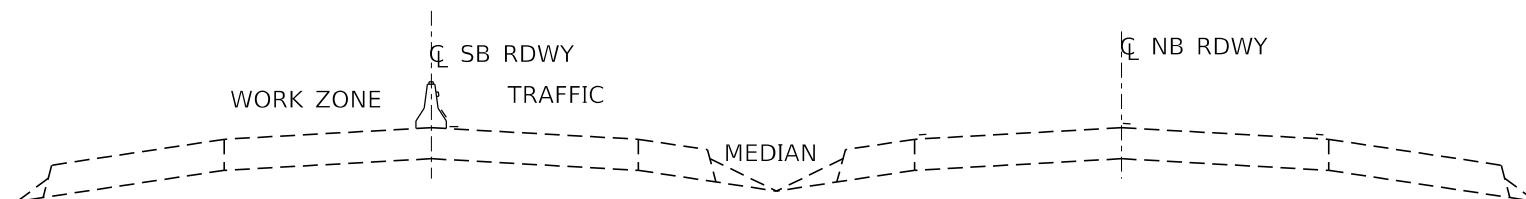

CROSS SECTION
STAGE III

STAGE III - RELOCATE TEMPORARY CONCRETE BARRIER WALL, TAPER AND TANGENT SECTION (325')

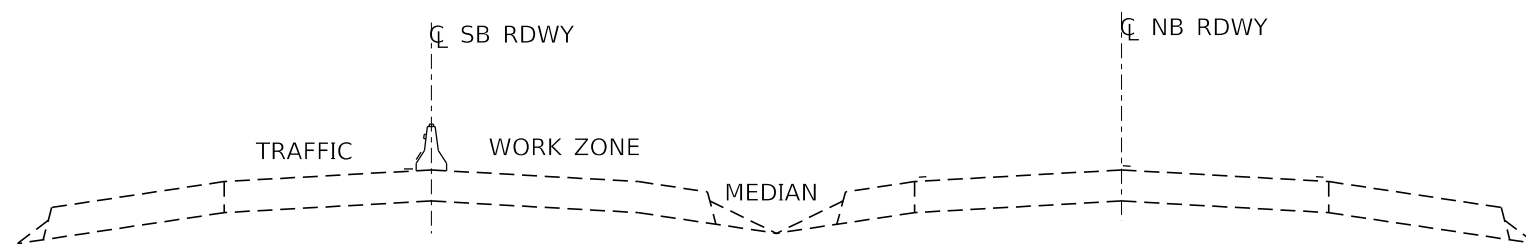

CROSS SECTION
STAGE IV

STAGE IV - RELOCATE TEMPORARY CONCRETE BARRIER WALL - TAPER ONLY (175')

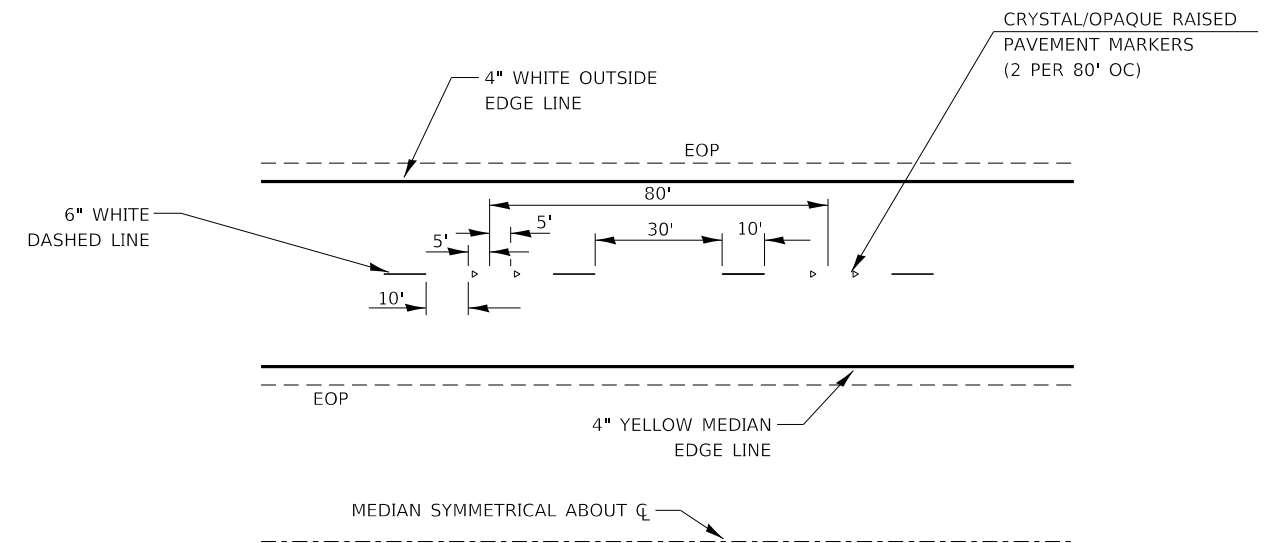

TYPICAL PAVEMENT MARKINGS

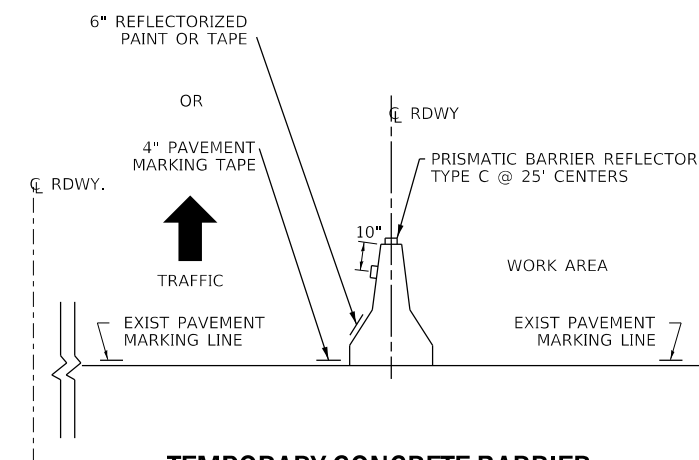

TEMPORARY CONCRETE BARRIER

1. THE CONTRACTOR HAS THE OPTION OF USING EITHER THE LINE ON THE TEMPORARY CONCRETE BARRIER OR ON THE PAVEMENT.
2. THE COLOR OF THE REFLECTORS AND PAVEMENT/BARRIER MARKING LINE WILL VARY WITH STAGING AND SHALL MATCH THE EXISTING LINE IN THE WORK AREA.
3. THE COST OF THE REFLECTORS AND THE PAVEMENT/BARRIER MARKING LINE IS INCLUDED IN THE COST OF THE TEMPORARY CONCRETE BARRIER.

GENERAL NOTES

THESE DETAILS SHALL BE USED WHERE AT ANY TIME ANY VEHICLE, EQUIPMENT, WORKERS OR THEIR ACTIVITIES WILL ENCROACH ON THE PAVEMENT OR ON THE SHOULDER WITHIN 24 (600) OF THE EDGE OF PAVEMENT FOR DAYLIGHT OPERATION EXCEEDING ONE DAY AND WHERE TEMPORARY CONCRETE BARRIER IS UTILIZED.

THESE DETAILS MUST ALWAYS BE USED IN COMBINATION WITH STANDARD 701400 AND 701402.

WHEN WORK IS BEING PERFORMED IN THE LEFT LANE, THE SET UP WOULD BE A MIRROR IMAGE TO WHAT IS SHOWN.

TEMPORARY CONCRETE BARRIER SHALL BE ACCORDING TO STANDARD 704001.

MODEL: Default
FILE: 66L25 - 20190808.dwg
PROJECT: 66L25 - 20190808.dwg
OFFICE: 66L25 - 20190808.dwg
DATE: 10/15/2020

USER NAME = MARINIEJ	DESIGNED -	REVISED -
PLOT SCALE = 3.9370' / mm	DRAWN -	REVISED -
PLOT DATE = 10/15/2020	CHECKED -	REVISED -
	DATE -	REVISED -

STATE OF ILLINOIS
DEPARTMENT OF TRANSPORTATION

STAGING DETAILS	
SCALE:	SHEET 1 OF 1 SHEETS STA. TO STA.

F.A.I. RTE.	SECTION	COUNTY	TOTAL SHEETS	SHEET NO.
180	(06-2HB-2)BP	BUREAU	17	8
CONTRACT NO. 66L25				
ILLINOIS FED. AID PROJECT				

ROUTE NO.	SEC.	COUNTY	TOTAL SHEETS	SHEET NO.
FAI 180	*	*	277	101

* (06-1 & 06-2) (18-2 & 18-3, 18-4, 18-5) - 1
 * BUREAU AND PUTNUM SHEET NO. 2
 & SHEETS

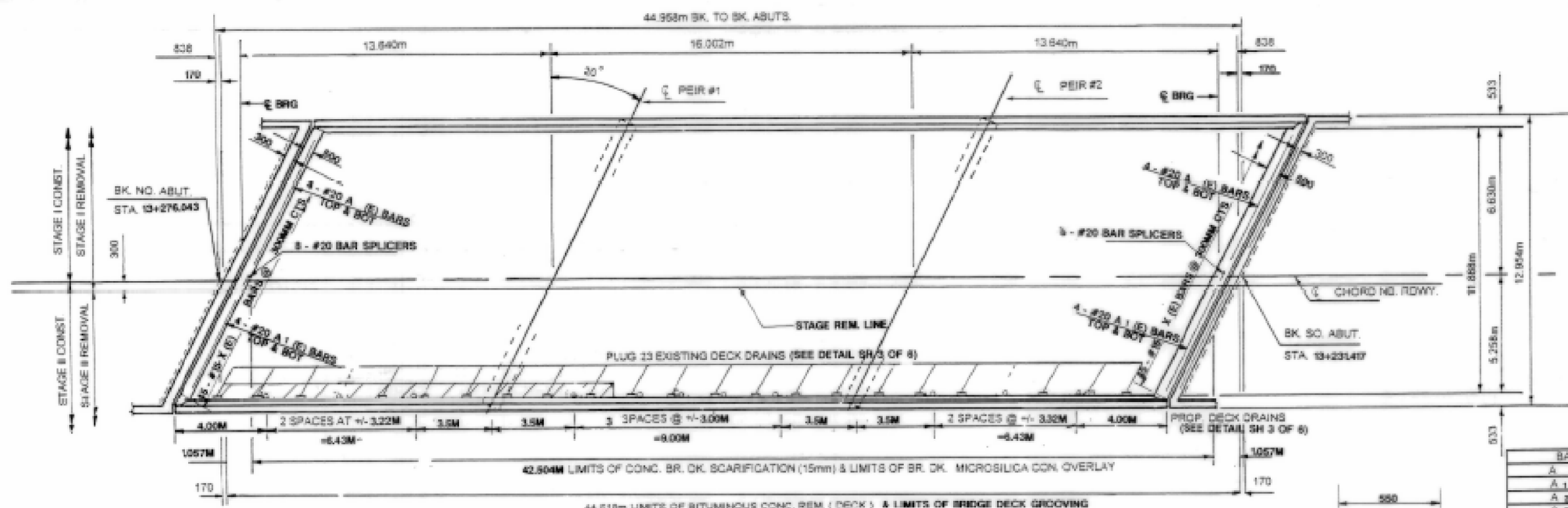

PLAN
SN 006-0042

BILL OF MATERIALS (2 DECKS)

BAR	NO.	SIZE	LENGTH (M)	SHAP
A-1 (E)	16	20	7.51	
A-2 (E)	18	20	8.00	
A-3 (E)	16	20	7.37	
A-4 (E)	10	20	5.05	
X (E)	180	15	0.74	
REINFORCEMENT BARS, EPOXY CTG.			KG	713
BAR SPLICERS			EACH	32
CONCRETE REMOVAL			C.U.M.	8.5
CONCRETE SUPERSTRUCTURE			C.U.M.	9.8
BRIDGE DECK GROOVING			SQ. M.	1072
BIT. CONC. REM. (DECK)			SQ. M.	1072
CONC. BR. DK. SOAR (15MM)			SQ. M.	1021
BR. DK. MICROSILICA CONC. OVRLY.			SQ. M.	1021
F & E STRUCTURAL STEEL			KG	3458
SILICONE JOINT SEALER			METER	82
PLUG EXIST. DECK DRAINS			EACH	45
FLOOR DRAINS			EACH	29
DECK SLAB REP (PART I)			SQ. M.	10

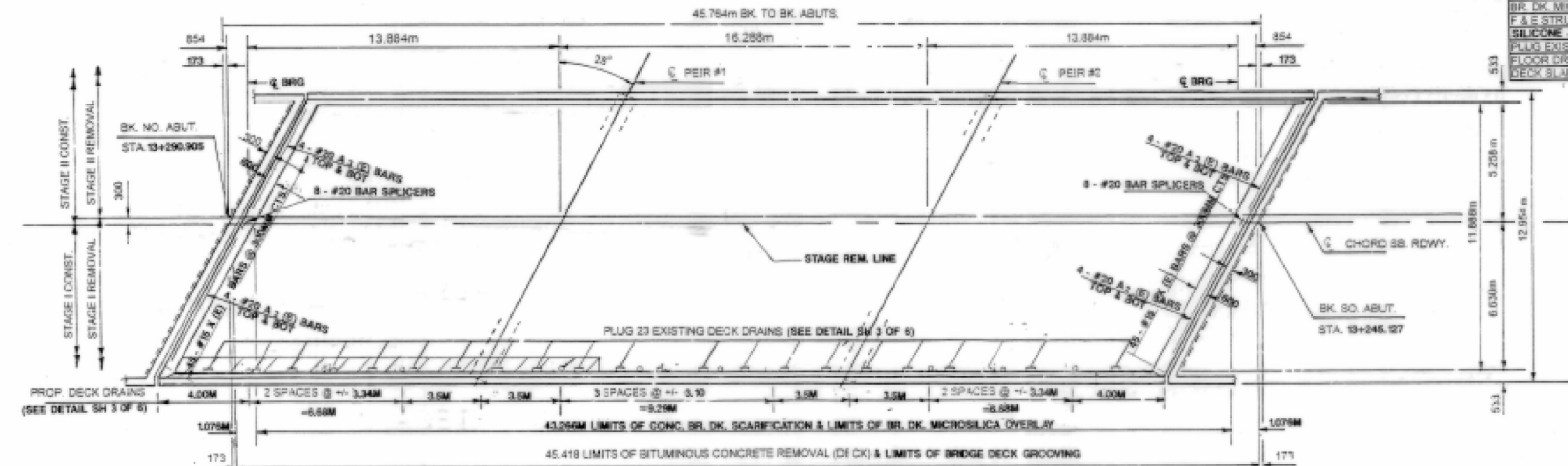

PLAN
SN 006-0041

LEGEND
 [Hatched Box] - DECK SLAB REP (PART)

NOTE: AREA OF DECK REPAIRS ARE ESTIMATED. THE PROJECT ENGINEER SHALL SHOW THE ACTUAL LOCATION OF ALL TYPES OF DECK REPAIRS ON AS-BUILT PLANS.

DECK SURVEY 9-23-95

DECK PLAN
 FAI RTE. I-180, SEC. 06-1B
 S.N. 006-0041 & 006-0042

DISTRICT NO. 2 DIXON

DESIGNED M. ETEMADI
 DRAWN J. ADAMS
 CHECKED
 REVISED 3/05/99

DATE 7/98
 SCALE 1:100

MODEL: Default
 FILE: 180662.ctb
 PROJECT: 180662.ctb
 PLOT DATE: 10/15/2020

USER NAME = MARINEJ	DESIGNED -	REVISED -
	DRAWN -	REVISED -
PLOT SCALE = 3.9370' / mm	CHECKED -	REVISED -
PLOT DATE = 10/15/2020	DATE -	REVISED -

**STATE OF ILLINOIS
 DEPARTMENT OF TRANSPORTATION**

**EXISTING STRUCTURE PLANS FOR
 STRUCTURE NO. 006-0041 (SB) & STRUCTURE NO. 006-0042 (NB)
 "FOR INFORMATION ONLY"**

SCALE: SHEET 2 OF 4 SHEETS STA. TO STA.

F.A.I. RTE.	SECTION	COUNTY	TOTAL SHEETS	SHEET NO.
180	(06-1B)BP & (06-1B-1)BP	BUREAU	17	10
ILLINOIS FED. AID PROJECT			CONTRACT NO. 66L26	

ROUTE NO.	SEC.	COUNTY	TOTAL SHEETS	SHEET NO.
I-180	06-1B	BUREAU	162	52
FED. ROAD DIST. NO. 1	ALIGNED	PROJECT		

SHEET 3 OF 6

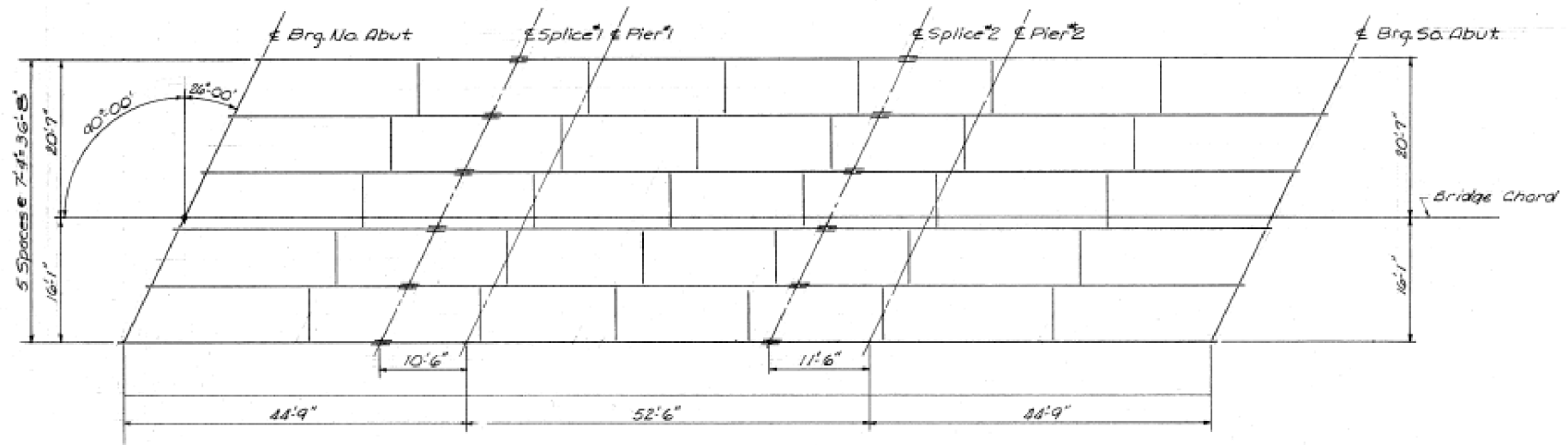

FRAMING PLAN - EAST BRIDGE

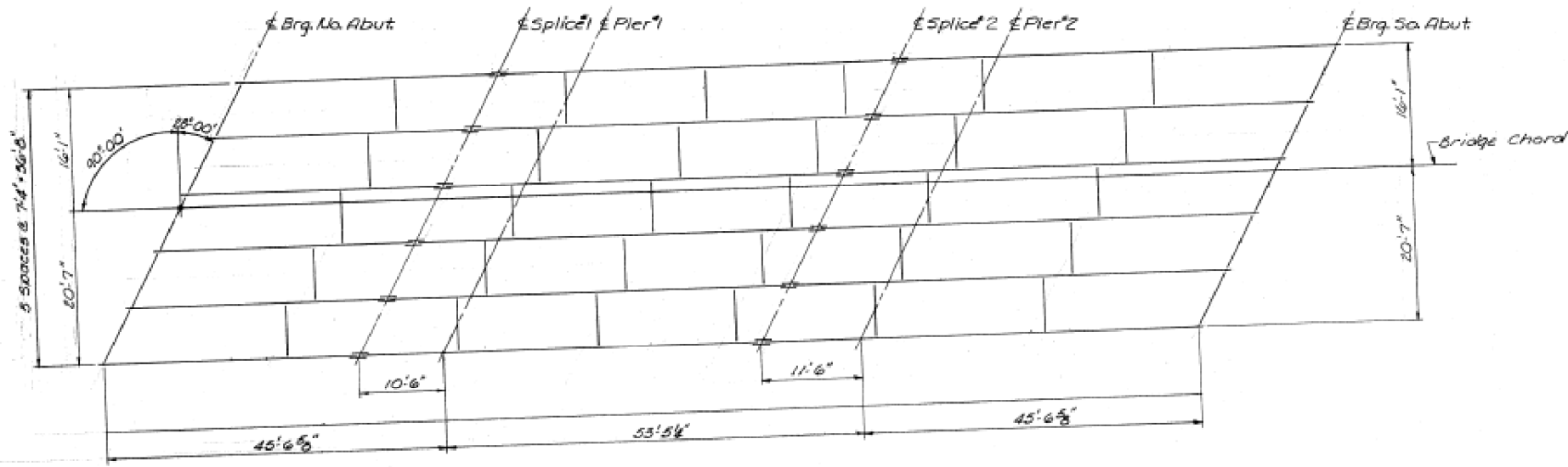

FRAMING PLAN - WEST BRIDGE

Note:
 All Beams 55 WF 118
 All interior diaphragms 16 WF 36
 with connection angles top & bottom.
 All end diaphragms 12 WF 40
 with seat type connection

STRUCTURAL STEEL
 FA.I. RT. 180 SEC.06-1B
 BUREAU COUNTY
 STA. 283+00

MODEL: Default
 FILE: Model - 20140601.dwg
 PROJECT: I:\Projects\180\180-06-1B\180-06-1B-1B.dwg
 PLOT DATE: 10/15/2020

USER NAME = MARINEJ	DESIGNED -	REVISED -
	DRAWN -	REVISED -
PLOT SCALE = 3.9370' / mm	CHECKED -	REVISED -
PLOT DATE = 10/15/2020	DATE -	REVISED -

STATE OF ILLINOIS
 DEPARTMENT OF TRANSPORTATION

EXISTING STRUCTURE PLANS FOR
 STRUCTURE NO. 006-0041 (SB) & STRUCTURE NO. 006-0042 (NB)
 "FOR INFORMATION ONLY"
 SCALE: SHEET 3 OF 4 SHEETS STA. TO STA.

F.A.J. RTE.	SECTION	COUNTY	TOTAL SHEETS	SHEET NO.
180	(06-1B)BP & (06-1B-1)BP	BUREAU	17	11
CONTRACT NO. 66L26			ILLINOIS FED. AID PROJECT	

STATE OF ILLINOIS
DEPARTMENT OF PUBLIC WORKS & BUILDINGS
DIVISION OF HIGHWAYS

DATE	REVISION	BY	NO.	DATE	SHEET NO.
F.A.J. 180	06-18	BUREAU	162	53	3 SHEETS
F.A.J. 180		BUREAU		162	
F.A.J. 180		BUREAU		162	

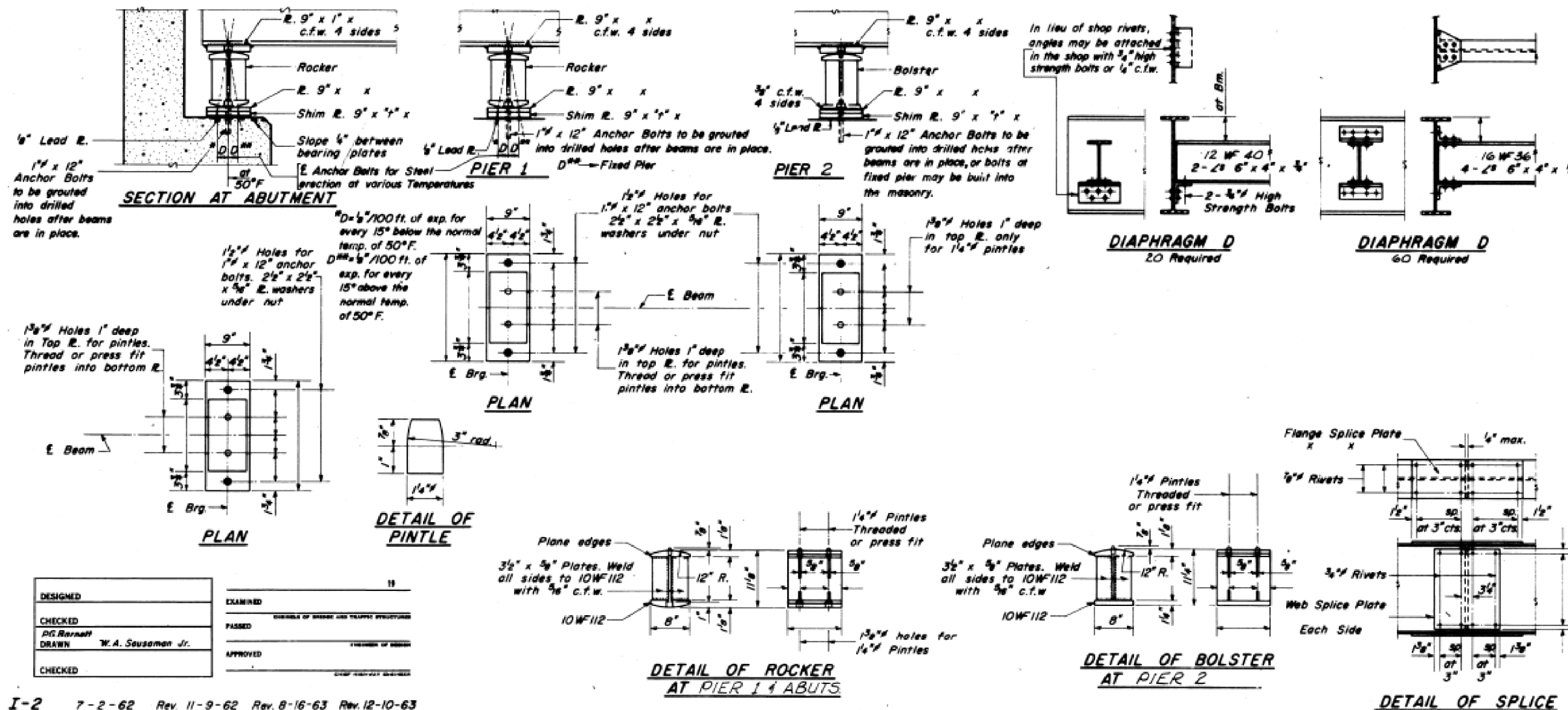

DESIGNED	EXAMINED	11
CHECKED	PASSED	
DG. Barnett	APPROVED	
DRAWN W.A. Sausaman Jr.		
CHECKED		

I-2 7-2-62 Rev. 11-9-62 Rev. 8-16-63 Rev. 12-10-63

STRUCTURAL STEEL
F.A.I. RT. 180 SEC. 06-1B
BUREAU COUNTY
STA. 283+00

STATE OF ILLINOIS
DEPARTMENT OF TRANSPORTATION

EXISTING STRUCTURE PLANS FOR
STRUCTURE NO. 006-0041 (SB) & STRUCTURE NO. 006-0042 (NB)
"FOR INFORMATION ONLY"

SCALE: SHEET 4 OF 4 SHEETS STA. TO STA.

F.A.J. RTE.	SECTION	COUNTY	TOTAL SHEETS	SHEET NO.
180	(06-18)BP & (06-18-1)BP	BUREAU	17	12
ILLINOIS			FED. AID PROJECT	

ROUTE NO.	SEC.	COUNTY	TOTAL SHEETS	SHEET NO.
FAI 180	*	*	277	126
FED. ROAD DIST. NO. 7 ILLINOIS PROJECT				
* (06-2 & 06-1)RS-2 & (06-2-1,06-3,78-1)RS-1				
* BUREAU & PUTNAM				
				SHEET NO. 1
				3 SHEETS

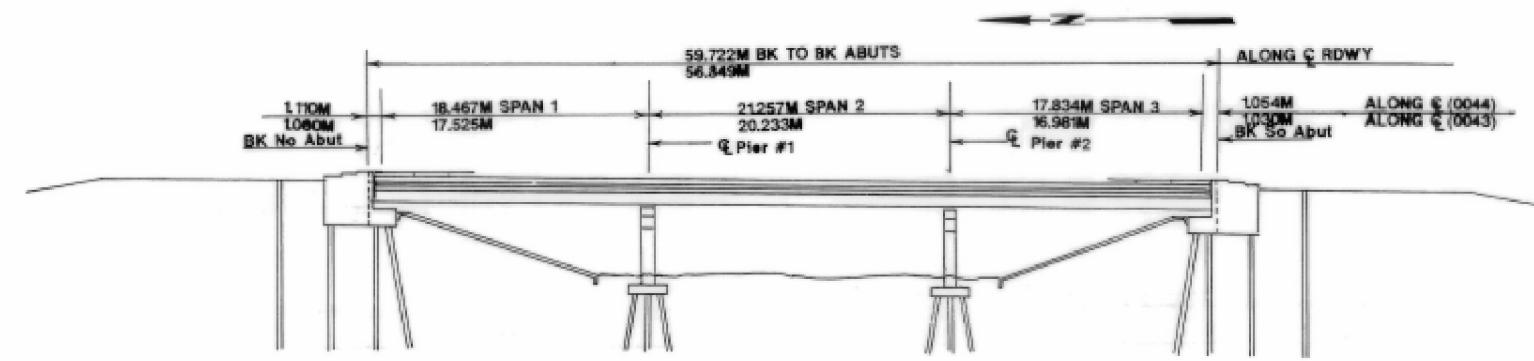

GENERAL NOTES

REINFORCEMENT BARS SHALL CONFORM TO THE REQUIREMENTS OF AASHTO M-31M, M-42M, OR M-53M GRADE 400.

ALL STRUCTURAL STEEL EXPANSION JOINT PLATES SHALL BE AASHTO M270M GRADE 250, UNLESS OTHERWISE NOTED.

PLAN DIMENSIONS AND DETAILS RELATIVE TO EXISTING STRUCTURE HAVE BEEN TAKEN FROM EXISTING PLANS AND ARE SUBJECT TO NOMINAL CONSTRUCTION VARIATIONS. IT SHALL BE THE CONTRACTOR'S RESPONSIBILITY TO VERIFY SUCH DIMENSIONS AND DETAILS IN THE FIELD AND MAKE NECESSARY APPROVED ADJUSTMENT PRIOR TO CONSTRUCTION OR ORDERING MATERIALS. SUCH VARIATIONS SHALL NOT BE CAUSE FOR ADDITIONAL COMPENSATION FOR A CHANGE IN THE SCOPE OF THE WORK, HOWEVER, THE CONTRACTOR WILL BE PAID FOR THE QUANTITY ACTUALLY FURNISHED AT THE UNIT PRICE BID FOR THE WORK.

ANY REINFORCEMENT BARS THAT ARE DAMAGED DURING CONCRETE REMOVAL SHALL BE REPLACED WITH AN APPROVED BAR SPLICER OR ANCHORAGE SYSTEM. COST SHALL BE INCLUDED IN THE COST OF "CONCRETE REMOVAL".

EXISTING LONGITUDINAL REINFORCEMENT EXTENDING INTO THE REMOVED AREA SHALL BE CLEANED, STRAIGHTENED AND INCORPORATED INTO THE NEW CONSTRUCTION. EXISTING TRANSVERSE REINFORCEMENT MAY BE CUT AS SHOWN AND REMOVED.

PRIOR TO POURING THE NEW CONCRETE FOR THE DECK, ALL LOOSE RUST, LOOSE MILL SCALE, AND ALL OTHER LOOSE, DETRIMENTAL FOREIGN MATERIAL SHALL BE REMOVED FROM THE PORTIONS OF FLANGES OF STRINGERS (GIRDERS) IN CONTACT WITH CONCRETE. THE REMOVAL SHALL BE ACCOMPLISHED IN ACCORDANCE WITH THE REQUIREMENTS OF THE SSPC SURFACE PREPARATION SPECIFICATIONS SP-3 FOR POWER TOOL CLEANING OR SP-2 FOR HAND TOOL CLEANING. COST SHALL BE INCIDENTAL TO CONTRACT.

THE EXISTING STRUCTURAL STEEL COATING CONTAINS LEAD. THE CONTRACTOR SHOULD TAKE APPROPRIATE PRECAUTIONS TO DEAL WITH THE PRESENCE OF LEAD ON THIS PROJECT.

ALL STRUCTURAL STEEL EXPANSION JOINT PLATES SHALL BE SHOP PAINTED WITH THE INORGANIC ZINC RICH PRIMER PER AASHTO M 300, TYPE 1. COST SHALL BE INCLUDED IN THE COST OF "FURNISHING AND ERECTING STRUCTURAL STEEL".

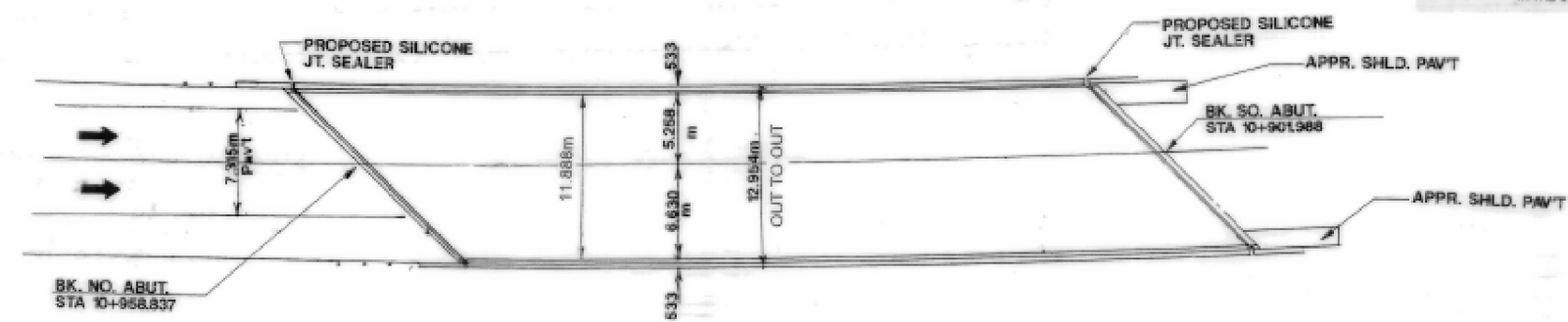
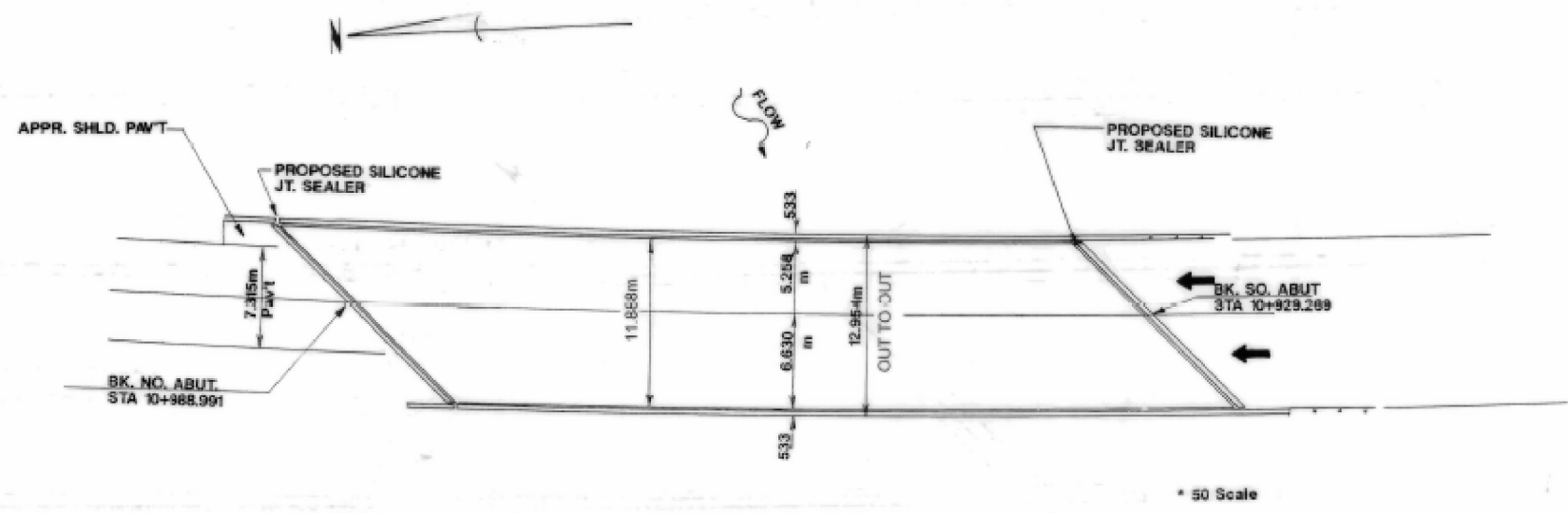

TOTAL BILL OF MATERIALS

ITEM	UNIT	QUANTITY
BIT CONC. REM (DECK)	SQ. M.	1375
CONCRETE REMOVAL	CU. M.	22.4
CONCRETE SUPERSTRUCTURE	CU. M.	25.3
REINFORCEMENT BARS, EPOXY CTD.	KG	2610
BAR SPLICERS	EACH	48
CONC. BR. DK. SCAR. (15MM)	SQ. M.	1315
BR. DK. MICROSILICA CONC. OVRLY.	SQ. M.	1315
BRIDGE DECK GROOVING	SQ. M.	131.5
FLOOR DRAINS	EACH	26
PLUG EXIST. DECK DRAINS	EACH	59
DECK SLAB REP (PART.)	SQ. M.	10
FORMED CONC. REP <=125	SQ. M.	12
F & E STRUCTURAL STEEL	KG	2165
SILICONE JT. SEALER	METER	73
STONE DUMPED RIP RAP	M TON	25
Deck Slab Repair (FD-T1)	SQ. M.	.2
Polymer Concrete	CU. M.	.03

FAI RTE 180, SEC 06-1B-1
BUREAU COUNTY
SN 006-0043 (SB)
SN 006-0044 (NB)

DISTRICT NO. 2 DIXON
DESIGNED M. Etemadi
DRAWN JA DATE 6/98
CHECKED SCALE

MODEL: Default
FILE: \\nas01c.psu.edu\pub\baron.com\data\illinois.gov\PROJECTS\DOT\Documents\DOT_Offices\District_3\Projects\03366L26\CADD\03366L26-cover.dgn

USER NAME = MARINEJ	DESIGNED -	REVISED -
	DRAWN -	REVISED -
PLOT SCALE = 3.9370' / mm	CHECKED -	REVISED -
PLOT DATE = 10/15/2020	DATE -	REVISED -

STATE OF ILLINOIS
DEPARTMENT OF TRANSPORTATION

EXISTING STRUCTURE PLANS FOR
STRUCTURE NO. 006-0043 (NB) & STRUCTURE NO. 006-0044 (SB)
"FOR INFORMATION ONLY"

SCALE: SHEET 1 OF 4 SHEETS STA. TO STA.

F.A.I. RTE.	SECTION	COUNTY	TOTAL SHEETS	SHEET NO.
180	(06-1B)BP & (06-1B-1)BP	BUREAU	17	13
			CONTRACT NO. 66L26	
		ILLINOIS	FED. AID PROJECT	

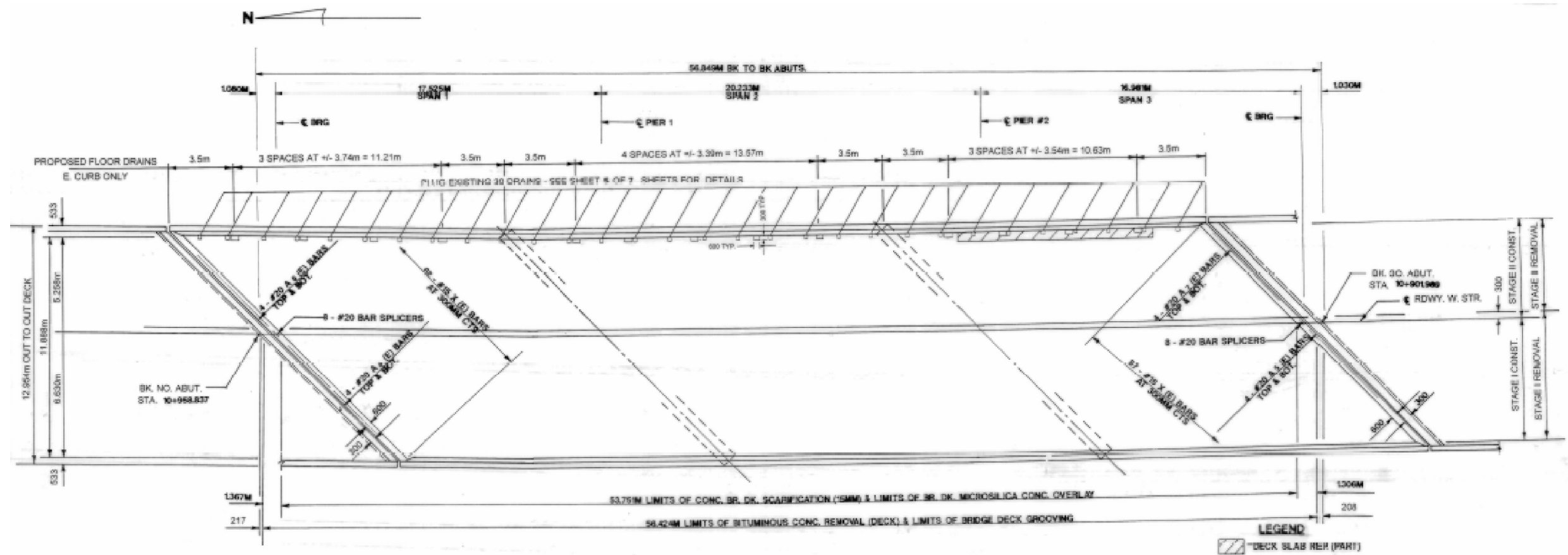

DECK SURVEY DATE 9-28-99
 NOTE: AREA OF DECK REPAIRS ARE ESTIMATED. THE PROJECT
DECK PLAN
 S.N. 006-0043

BUREAU & PUTNAM
 SHEET NO. 3
 8 SHEETS

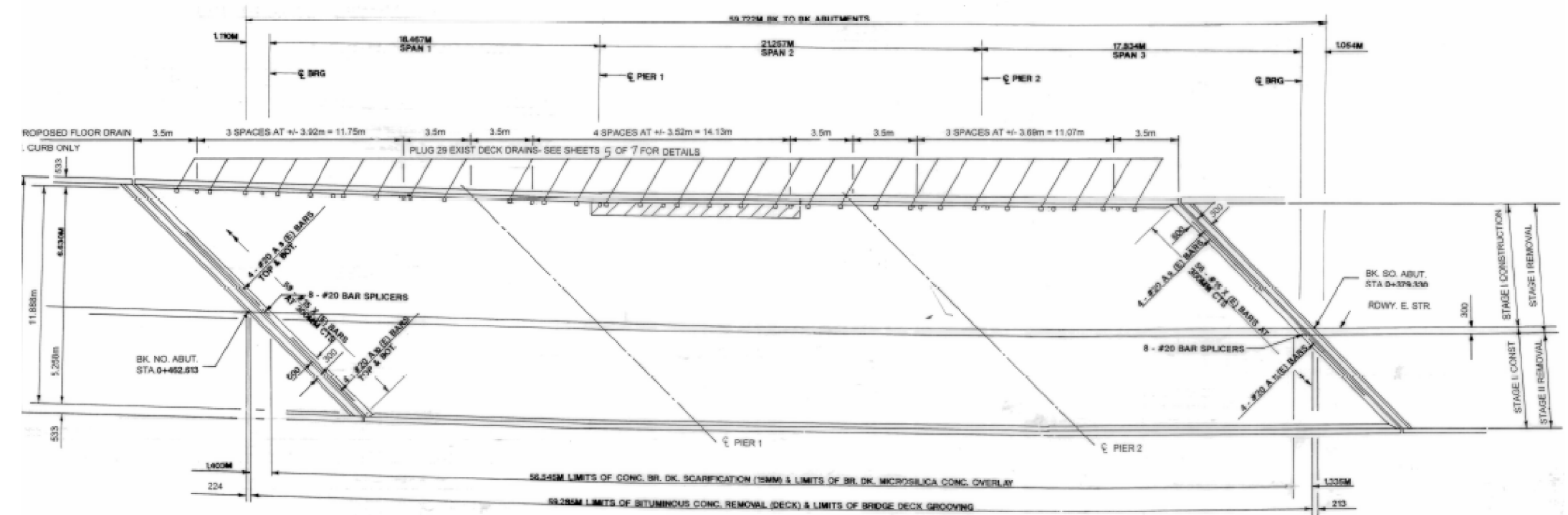

DECK PLAN
 SN 006-0044

MODEL: Default
 FILE: N:\bldg\p\pub\barcom\dat\illinois\gov\p\illinois\dot\Documents\DOT\Office\Drawings\3\Project\03366L26\CADD\03366L26-cover.dwg

USER NAME = MARINEJ	DESIGNED -	REVISED -
	DRAWN -	REVISED -
PLOT SCALE = 3.9370' / mm	CHECKED -	REVISED -
PLOT DATE = 10/15/2020	DATE	REVISED -

STATE OF ILLINOIS
DEPARTMENT OF TRANSPORTATION

EXISTING STRUCTURE PLANS FOR
STRUCTURE NO. 006-0043 (NB) & STRUCTURE NO. 006-0044 (SB)
"FOR INFORMATION ONLY"

SCALE: SHEET 2 OF 4 SHEETS STA. TO STA.

F.A.J. RTE.	SECTION	COUNTY	TOTAL SHEETS	SHEET NO.
180	(06-18)BP & (06-18-1)BP	BUREAU	17	14
			CONTRACT NO. 66L26	
ILLINOIS FED. AID PROJECT				

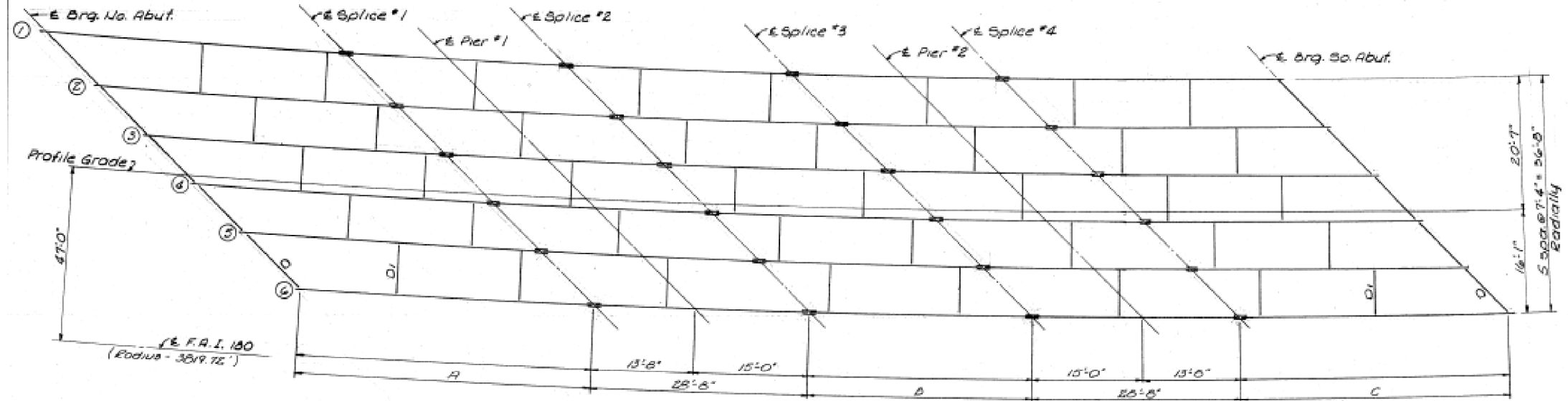

FRAMING PLAN - EAST BRIDGE

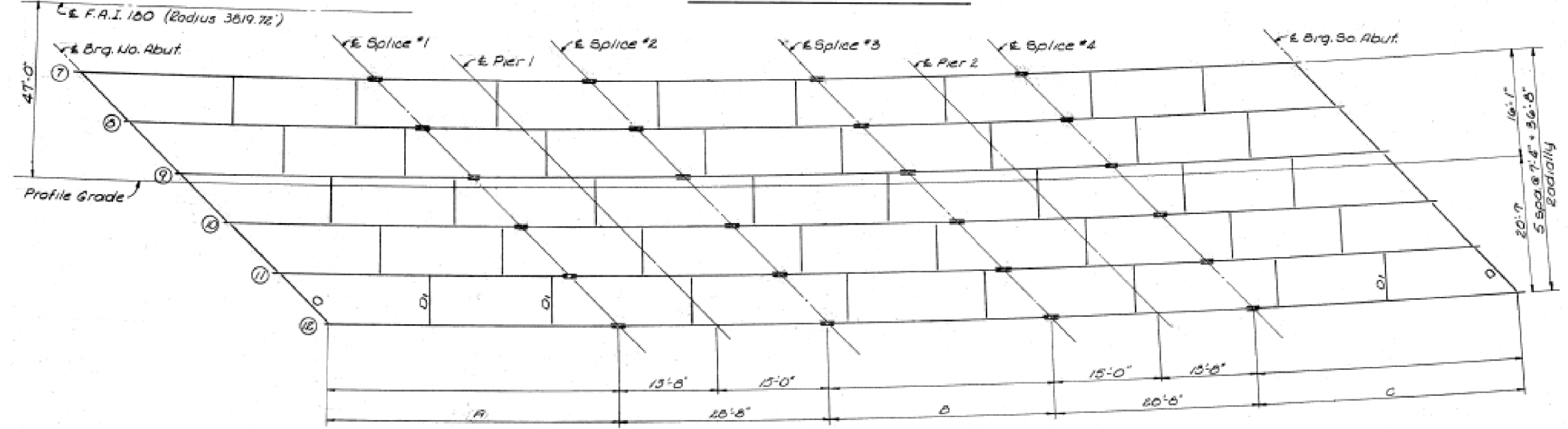

FRAMING PLAN - WEST BRIDGE

Beam	A	B	C
1			
2			
3			
4			
5			
6			
7			
8			
9			
10			
11			
12			
E.F.A.I. 180	44'-4"	38'-0"	44'-4"

Note: All beams are 3/4" W 160 (curved).
 All interior diaphragms 1/4" W 36 with connection angles top & bottom.
 All end diaphragms 1/2" W 40 with seat type connection.

STRUCTURAL STEEL
 F.A.I. RT. 180 SEC. 06-1B-1
 BUREAU COUNTY
 STA. 359+00

MODEL: Default
 FILE: Model: 3/10/2020 10:00:00 AM
 PROJECT: I:\Projects\180\06-1B-1\Structural Steel\06-1B-1-Structural Steel.dwg
 PLOT DATE: 10/15/2020

USER NAME = MARINEJ	DESIGNED -	REVISED -
	DRAWN -	REVISED -
PLOT SCALE = 3.9370' / mm	CHECKED -	REVISED -
PLOT DATE = 10/15/2020	DATE -	REVISED -

STATE OF ILLINOIS
 DEPARTMENT OF TRANSPORTATION

EXISTING STRUCTURE PLANS FOR
 STRUCTURE NO. 006-0043 (NB) & STRUCTURE NO. 006-0044 (SB)
 "FOR INFORMATION ONLY"

F.A.J. RTE.	SECTION	COUNTY	TOTAL SHEETS	SHEET NO.
180	(06-1B)BP & (06-1B-1)BP	BUREAU	17	15
SCALE: SHEET 3 OF 4 SHEETS STA. TO STA.			CONTRACT NO. 66L26	
ILLINOIS FED. AID PROJECT				

STATE OF ILLINOIS
DEPARTMENT OF PUBLIC WORKS & BUILDINGS
DIVISION OF HIGHWAYS

ROUTE NO.	SECTION	COUNTY	TOTAL SHEETS	SHEET NO.
F.A.I. 180	06-1B-1	BUREAU	162	68
P.L. ROAD DIST. NO. 1		ALIGNED	P.L. OR PROPOSED	

SHEET NO. 3
8 SHEETS

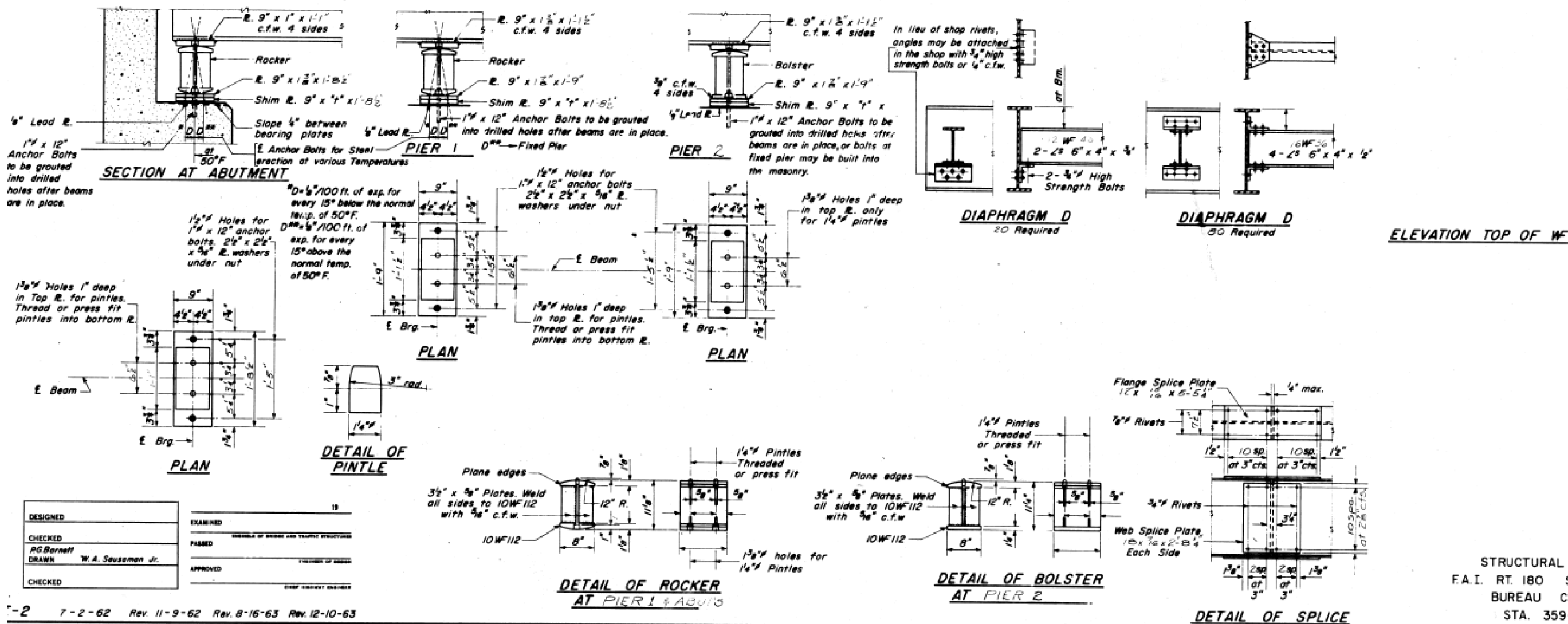

DESIGNED	18
CHECKED	EXAMINED
DRAWN	APPROVED

7-2-62 Rev. 11-9-62 Rev. 8-16-63 Rev. 12-10-63

STRUCTURAL STEEL
F.A.I. RT. 180 SEC. 06-1B-1
BUREAU COUNTY
STA. 359+00

MODEL: Default
 FILE: Model - StructuralSteel.dwg
 PROJECT: 0366126-CADD-Data-0366126-cover.dwg
 PROJECTDIR: C:\projects\0366126-CADD-Data-0366126-cover.dwg

USER NAME = MARINEJ	DESIGNED -	REVISED -	STATE OF ILLINOIS DEPARTMENT OF TRANSPORTATION		EXISTING STRUCTURE PLANS FOR STRUCTURE NO. 006-0043 (NB) & STRUCTURE NO. 006-0044 (SB) "FOR INFORMATION ONLY"		F.A.I. RTE.	SECTION	COUNTY	TOTAL SHEETS	SHEET NO.
PLOT SCALE = 3.9370' / mm	DRAWN -	REVISED -			SCALE: SHEET 4 OF 4 SHEETS STA. TO STA.		180	(06-1B)BP & (06-1B-1)BP	BUREAU	17	16
PLOT DATE = 10/15/2020	CHECKED -	REVISED -					CONTRACT NO. 66L26				
	DATE -	REVISED -					ILLINOIS FED. AID PROJECT				

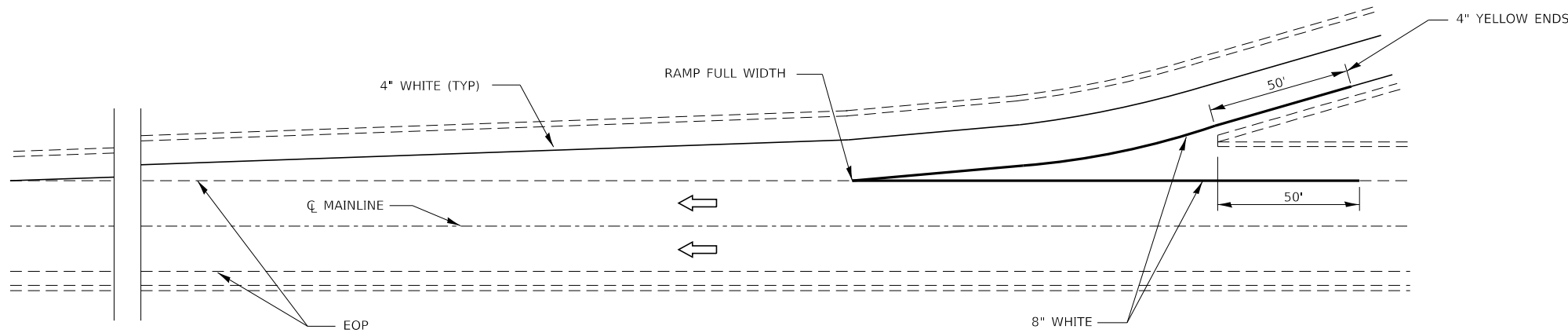

TYPICAL PAVEMENT MARKING FOR ENTRANCE RAMP TERMINALS

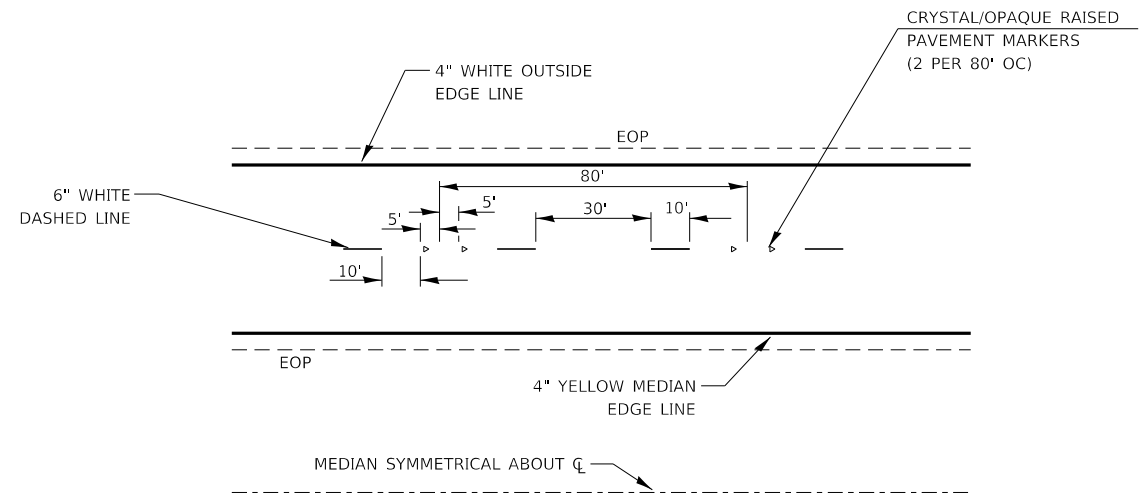

TYPICAL PAVEMENT MARKINGS

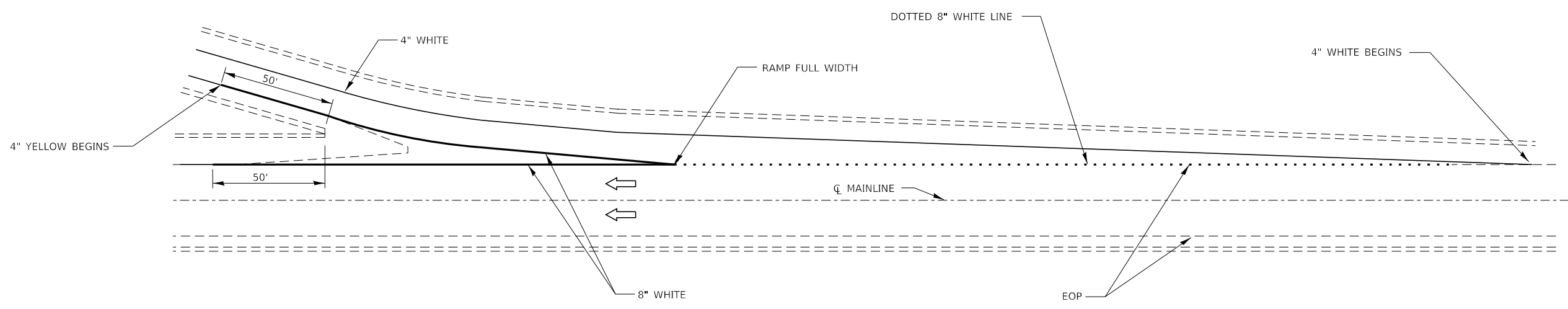

TYPICAL PAVEMENT MARKINGS FOR EXIT RAMP TERMINALS

MODEL: Default
 FILE: \\hpc101\pub\baronm.dwg
 PROJECT: \\hpc101\pub\baronm.dwg
 OFFICE: \\hpc101\pub\baronm.dwg
 DATE: 10/15/2020

USER NAME = MARINIEJ	DESIGNED -	REVISED -
PLOT SCALE = 3.9370' / mm	DRAWN -	REVISED -
PLOT DATE = 10/15/2020	CHECKED -	REVISED -
	DATE -	REVISED -

STATE OF ILLINOIS
DEPARTMENT OF TRANSPORTATION

PAVEMENT MARKING DETAILS	
SCALE:	SHEET 4 OF 4 SHEETS STA. TO STA.

F.A.J. RTE.	SECTION	COUNTY	TOTAL SHEETS	SHEET NO.
180	(06-1B)BP & (06-1B-1)BP	BUREAU	17	17
CONTRACT NO. 66L26				
ILLINOIS FED. AID PROJECT				