

**ELEVATION**

**SUMMARY OF QUANTITIES**

X9011215	TEMP BRIDGE TRAFFIC SIGNALS	1	EACH
Z0002600	BAR SPLICERS	23	EACH
Z0003700	BEARING PAD ADJUST	24	EACH
Z0017300	DOWEL REPAIR	44	EACH
Z0032700	KEYWAY REPAIR	59	LIN FT
40600810	BIT CON SC "C" CL I T1	45	TON
40600980	BITUMINOUS SURFACE REMOVAL-Butt Joint	98	SQ YD
44001205	Bituminous Concrete Surface Removal Complete	103	SQ YD
50301200	CONCRETE WEARING SURFACE	103	SQ YD
50800205	REINFORCEMENT BARS, EPOXY COATED	1250	LB
70100100	Traffic Control & Protection Standard 701316	1	EACH
70300100	Short-Term Pavement Marking	44	FOOT
50300260	Bridge Deck Grooving	103	SQ YD

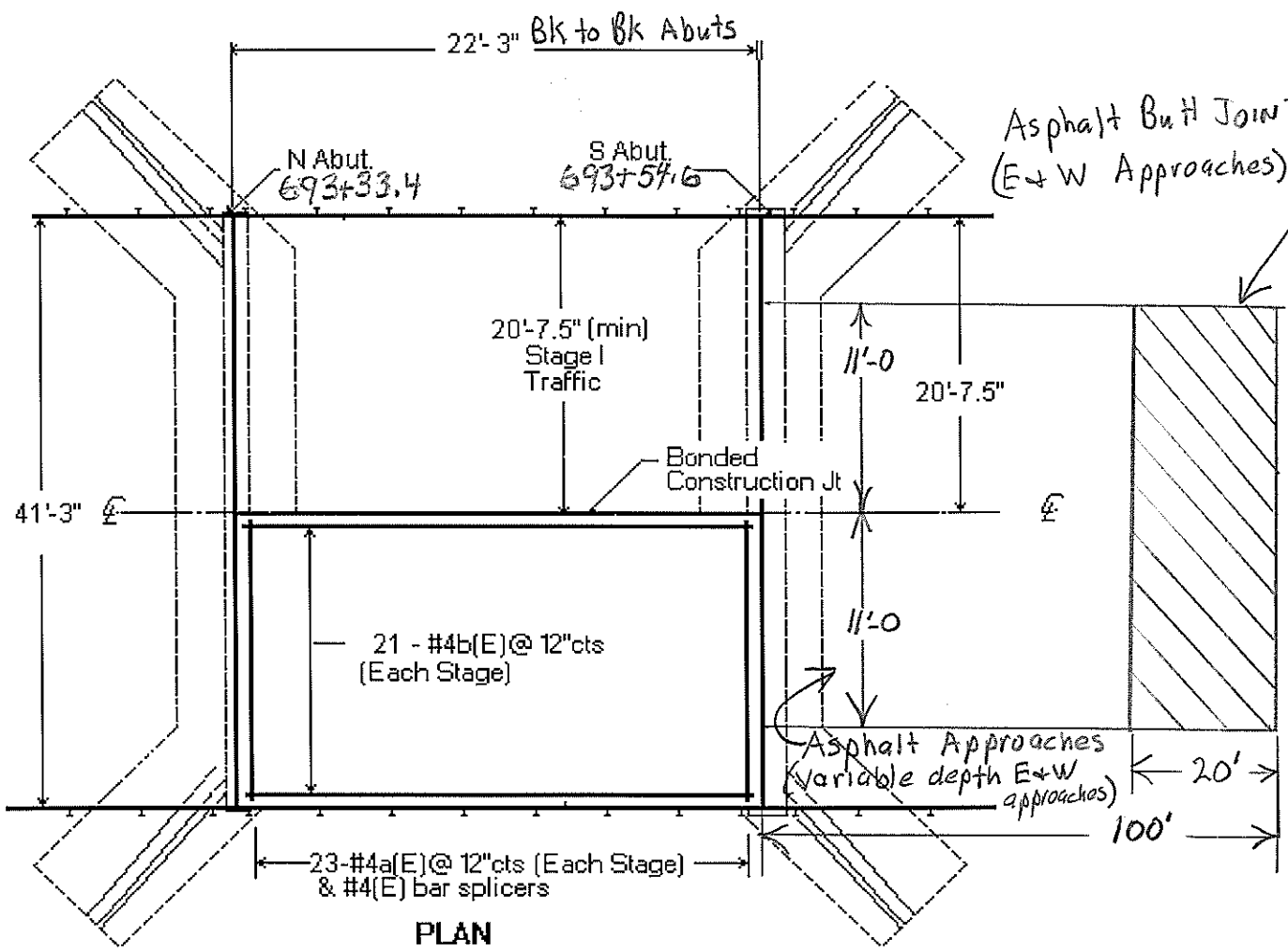

**PLAN**

**Bill Of Material**

Bar	No	Size	Length	Shape
a(E)	46	#4	20'-6"	—
b(E)	42	#4	22'-0"	—
Reinforcement Bars Epoxy Coated			1250	Lbs
Bar Splicers			23	Each

**General Notes**

Plan dimensions and details relative to existing structure have been taken from existing plans and are subject to nominal construction variations. It shall be the Contractor's responsibility to verify such dimensions and details in the field and make necessary approved adjustments prior to construction or ordering of materials. Such variations shall not be cause for additional compensation for a change in the scope of the work, however, the Contractor will be paid for the quantity actually furnished at the unit price bid for the work. The minimum thickness of the concrete overlay shall be 5" and varies as required to adjust for the existing profile grade and beam camber.

Reinforcement bars shall conform to the requirements of AASHTO M-31, M-42 or M-53 Grade 60.

FA 92 (IL99)  
 Section 122 BR(DL00)  
 Brown County  
 Project # 00  
 SN 005-0004

Rte	Section	County	Total Sheets	Sheet #
Fa 92 (IL99)	122BR	Brown	4	3

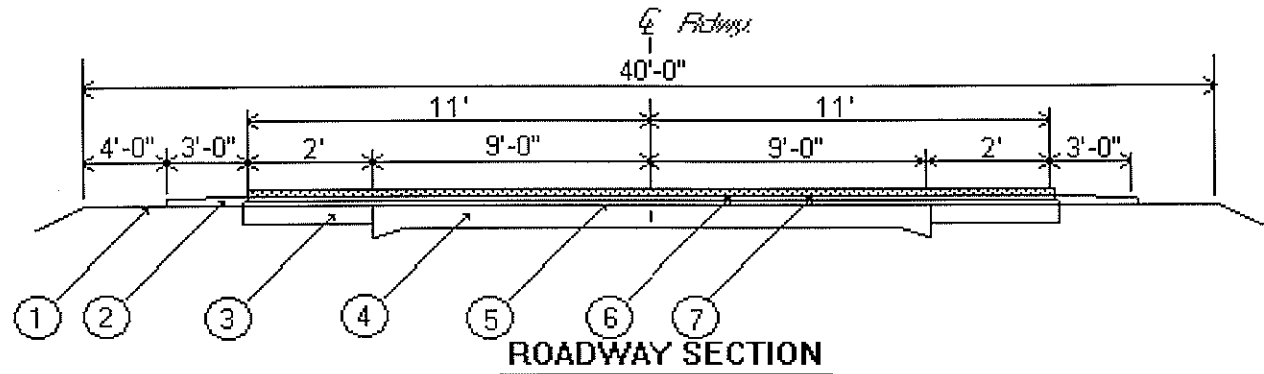

**ROADWAY SECTION**

- Sta 692+33.4 To Sta 693+33.4  
Sta 693+54.6 To Sta 694+54.6
- ① Earth Shoulders
  - ② Exist. Aggregate Shoulders Ty. A
  - ③ Exist. Base Cse. Widening 9
  - ④ Exist. PCC Pav't & Bit. Surf.
  - ⑤ Exist. Bit Binder Cse 3/4"
  - ⑥ Exist. Surf Cse.
  - ⑦ Prop. Bit. Conc. Surf. Variable Depth

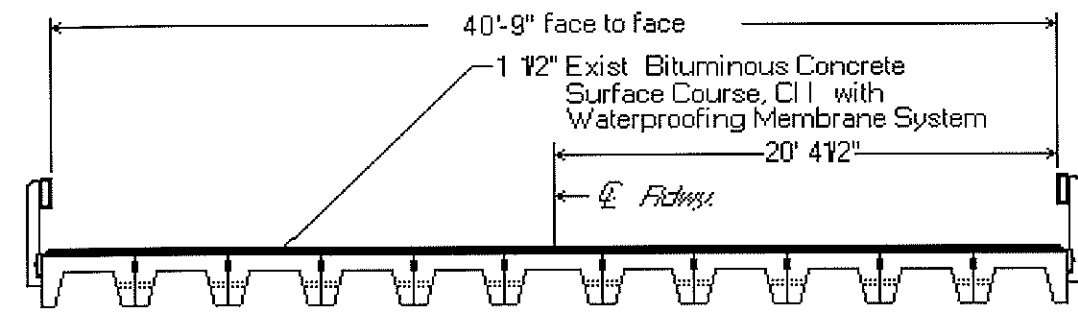

**EXISTING CROSS SECTION**

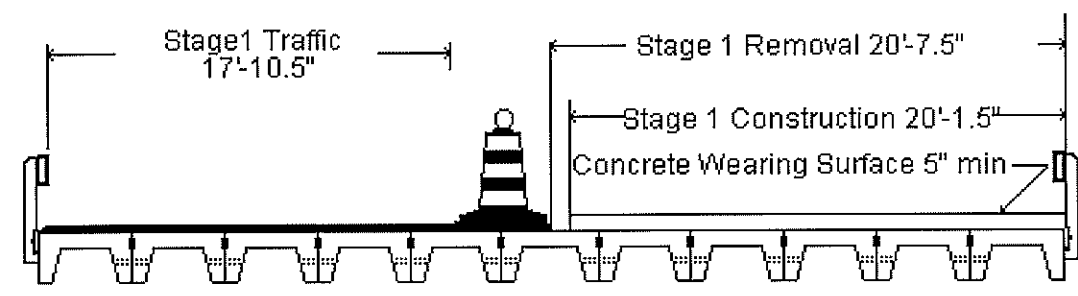

**Stage I**

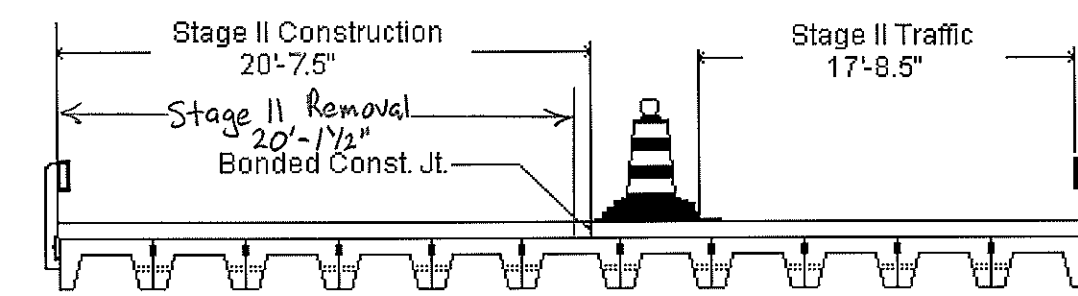

**Stage II**

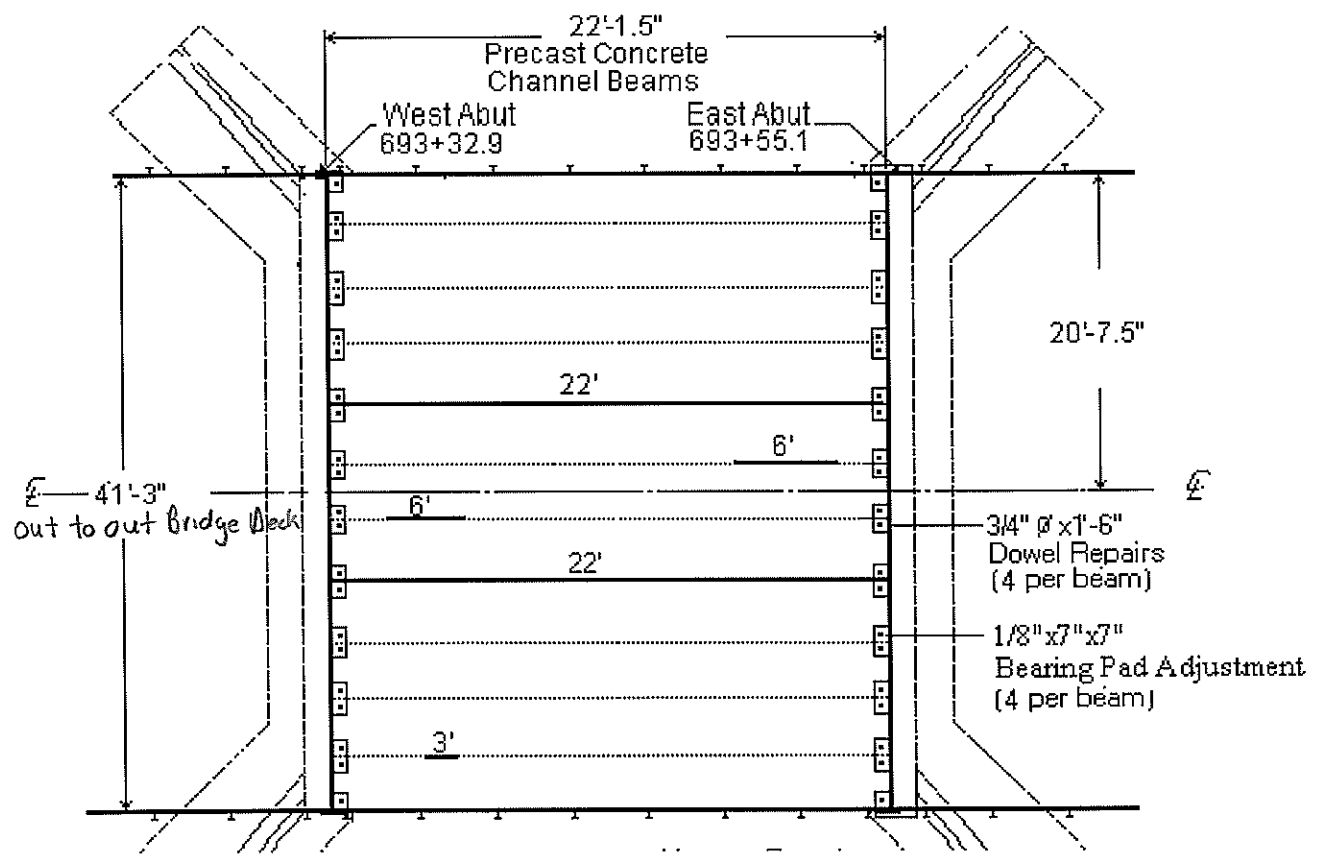

— Keyway Repair  
Actual repair areas and quantities to be determined in the field and recorded on as-built plans.

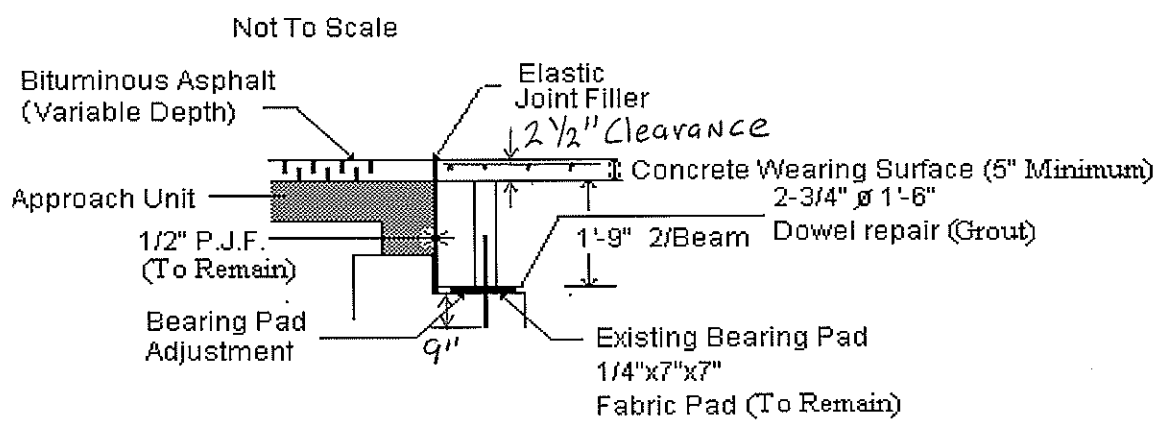

**Section Thru Abutment**

FA 92 (IL99)  
Section 122BR  
Brown County  
Project # 00  
SN 005-0004