

F.A.I.	SECTION	COUNTY	TOTAL SHEETS	SHEET N.O.
94/90	2005-034I	COOK	41	29
STA.	TO STA.			
FED. ROAD DIST. NO.	ILLINOIS FED. AID PROJECT			

60A05

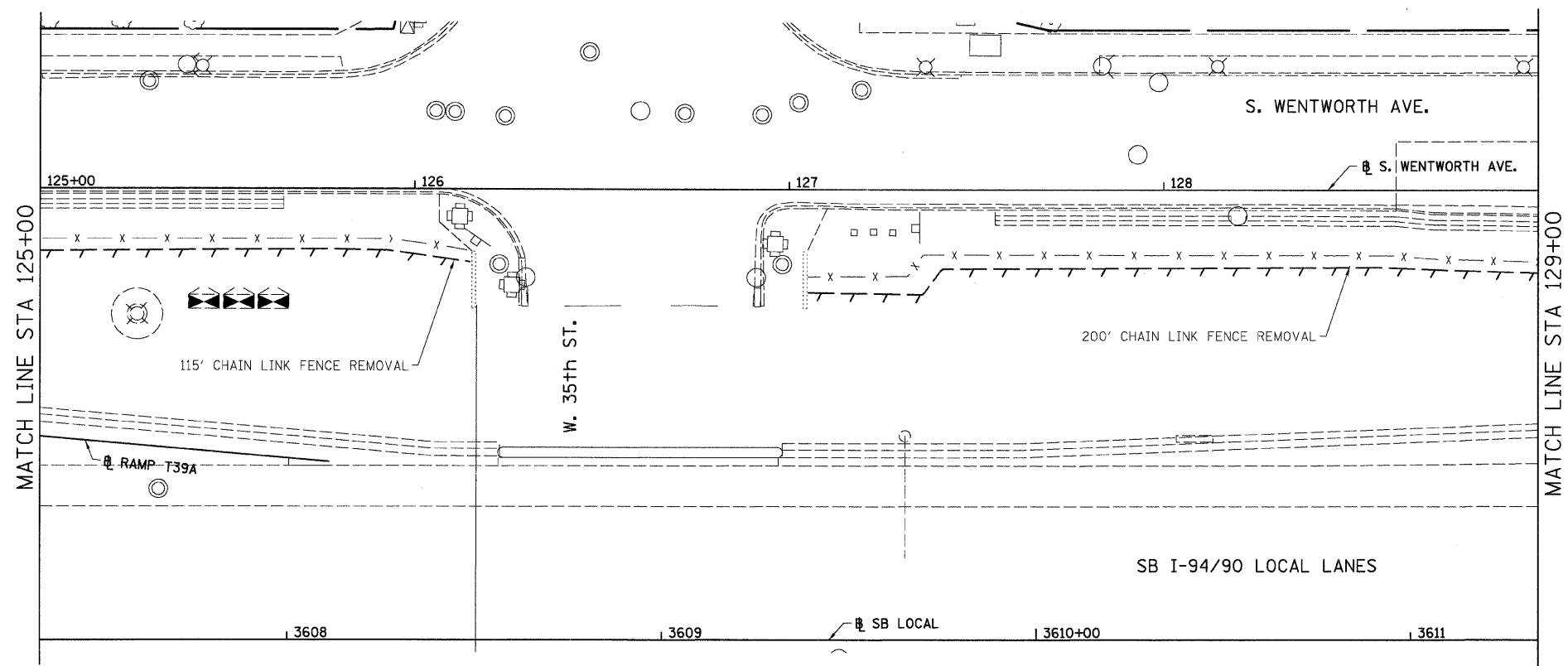

LEGEND:

 LINEAR REMOVALS

EXISTING CONDITIONS AND REMOVAL
 PROPOSED IMPROVEMENTS

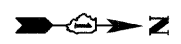
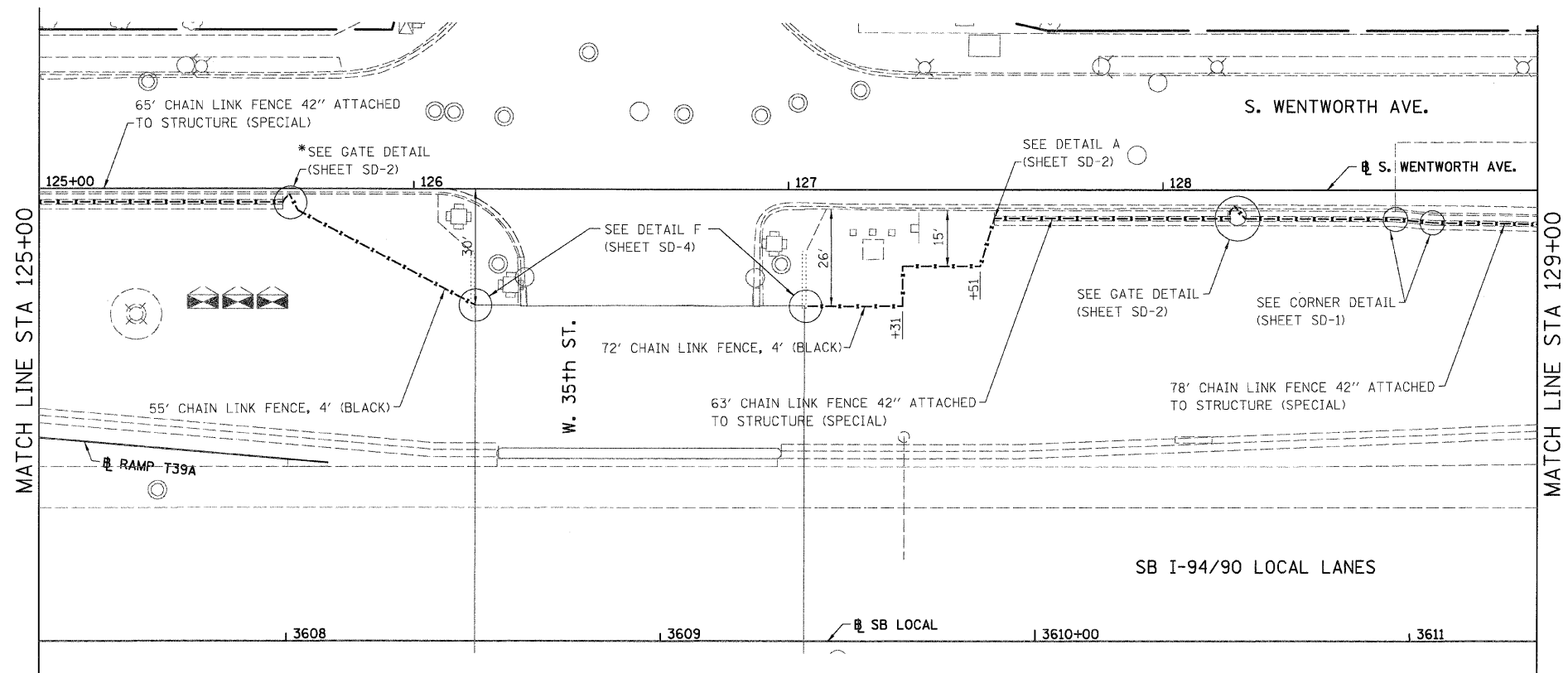

NOTES:
 1. SEE DETAIL FOR CHAIN LINK FENCE, 42" ATTACHED TO STRUCTURE (SPECIAL).

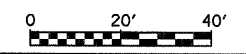

REVISIONS	
NAME	DATE
REVISED	11/5/08

ILLINOIS DEPARTMENT OF TRANSPORTATION
 F.A.I. 94/90 (DAN RYAN EXPRESSWAY)
 SOUTHBOUND FENCE AND GATES (47TH ST TO 31ST ST)
EXISTING AND PROPOSED FENCE PLANS
 SCALE: 1"=20'
 DATE: 10/23/08
 DRAWN BY: JDC
 CHECKED BY: DDM

BOWMAN, BARRETT & ASSOCIATES INC.
 CONSULTING ENGINEERS
 Chicago, Illinois
 312.228.0100
 www.bbandainc.com

* USE GATE DETAIL ON SHEET SD-2 FOR ATTACHMENT TO KNEE WALL AND STANDARD 664001 FOR GROUND POST INSTALLATION. ALL OTHER DETAILS AND REQUIREMENTS SHOWN ON GATE DETAIL ON SHEET SD-2 SHALL BE PROVIDED.

11/25/2008 5:09:21 PM PL-21