

DATE: \_\_\_\_\_ BY: \_\_\_\_\_  
 REVISIONS: \_\_\_\_\_  
 PLAN: \_\_\_\_\_  
 NO. \_\_\_\_\_

DATE: \_\_\_\_\_ BY: \_\_\_\_\_  
 REVISIONS: \_\_\_\_\_  
 PROFILE: \_\_\_\_\_  
 NO. \_\_\_\_\_

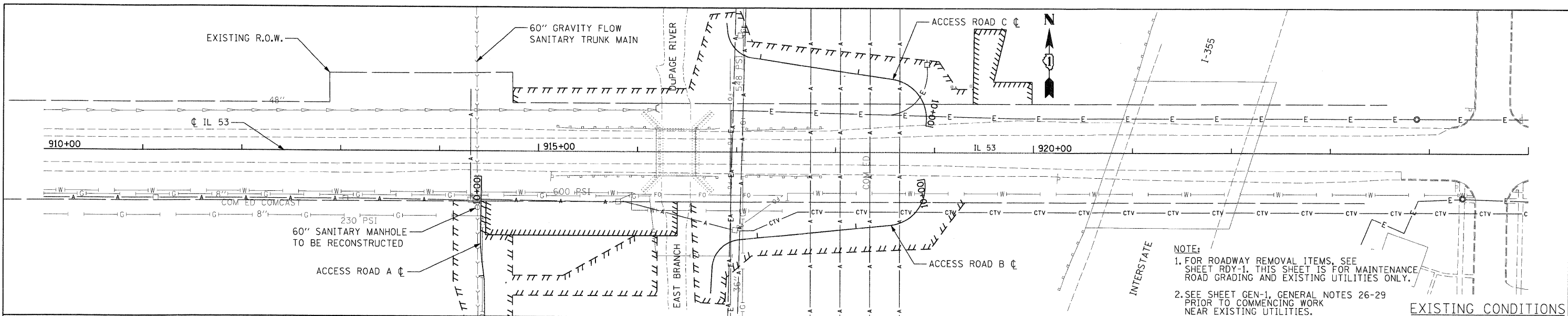

NOTE:  
 1. FOR ROADWAY REMOVAL ITEMS, SEE SHEET RDY-1. THIS SHEET IS FOR MAINTENANCE ROAD GRADING AND EXISTING UTILITIES ONLY.  
 2. SEE SHEET GEN-1, GENERAL NOTES 26-29 PRIOR TO COMMENCING WORK NEAR EXISTING UTILITIES.

EXISTING CONDITIONS

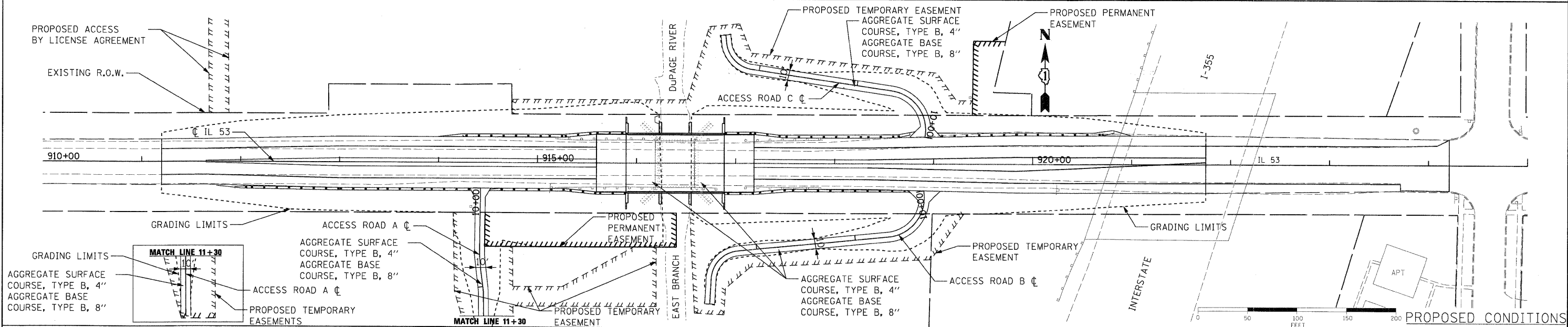

PROPOSED CONDITIONS

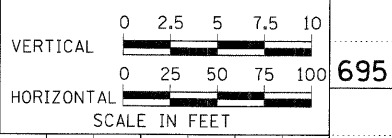
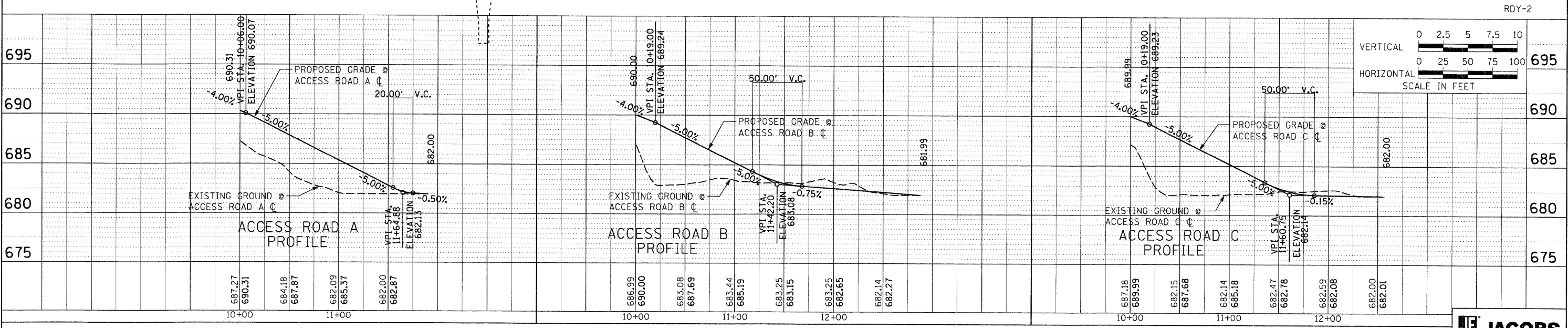

RDY-2

FILE NAME = P:\_2002\020019_004\Cadd\Sheet Files\Part	DESIGNED - TAI	REVISED -	F.A.P. ROUTE 870 (ILLINOIS 53) OVER EAST BRANCH DUPAGE RIVER	F.A. RTE. 870	SECTION 533 X-B-R-1	COUNTY DUPAGE	TOTAL SHEETS 87	SHEET NO. 14
\PLAN_PROF_2.SHT	DRAWN - KEB	REVISED -	PLAN AND PROFILE - UTILITY COMPANY ACCESS ROADS			CONTRACT NO. 60B95		
PLOT SCALE = 1" = 50'	CHECKED - PJM	REVISED -	SCALE: NONE	SHEET NO. OF SHEETS	STA. N/A TO STA. N/A	FED. ROAD DIST. NO. ILLINOIS FED. AID PROJECT		
PLOT DATE = 10/8/2008	DATE - 10/15/08	REVISED -	STATE OF ILLINOIS DEPARTMENT OF TRANSPORTATION					

