

FINAL SURVEY NOTE BOOK NO.	DATE
SUBMITTED PLOTTED AREAS CHECKED	BY

ORIGINAL SURVEY NOTE BOOK NO.	DATE
SUBMITTED PLOTTED AREAS CHECKED	BY

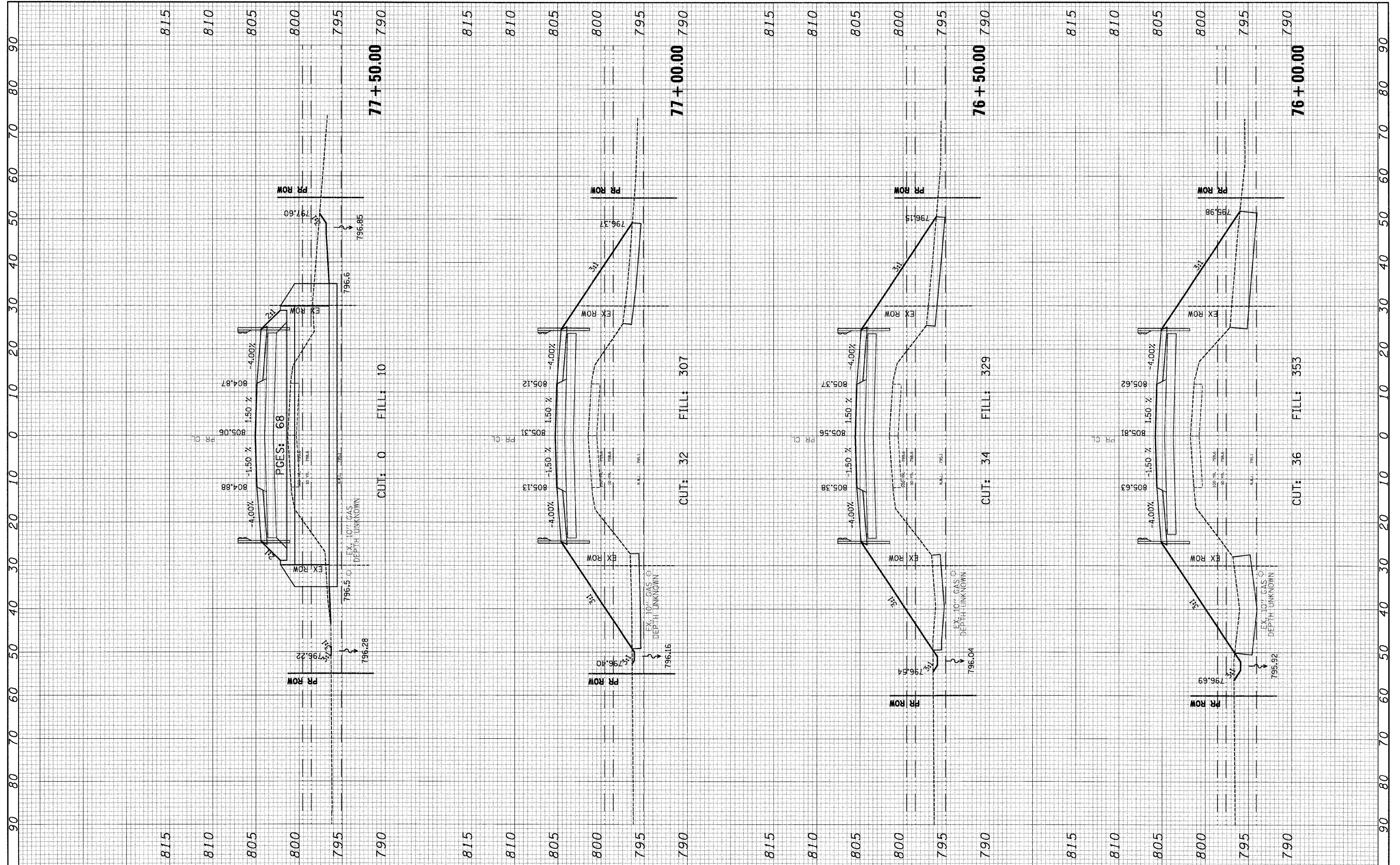

FILE NAME = #FILEL#	USER NAME = #USER#	DESIGNED - GJM	REVISD - 5/13/2008	STATE OF ILLINOIS DEPARTMENT OF TRANSPORTATION	CROSS SECTIONS		F.A.P. RTE. 324	SECTION 23B-1	COUNTY MCHENRY	TOTAL SHEETS 97	SHEET NO. 92	
	PLOT SCALE = #SCALE#	CHECKED - EJL	REVISD - 7/18/2008		SCALE: 1"=20' H 1"=30' V	SHEET NO. 8 OF 13 SHEETS	STA. 76+00.00 TO STA. 77+50.00	CONTRACT NO. 62892				
	PLOT DATE = 7/17/2008	DRAWN - GJM	REVISD -									
		CHECKED - EJL	REVISD -		FED. ROAD DIST. NO. 1 ILLINOIS FED. AID PROJECT							