

ORIGINAL SURVEY	DATE
AS REVISED	BY
NOTED	
PLOTTED	
TEMPLATE	
AREAS CHECKED	
NO.	

FINAL SURVEY	DATE
AS REVISED	BY
NOTED	
PLOTTED	
TEMPLATE	
AREAS CHECKED	
NO.	

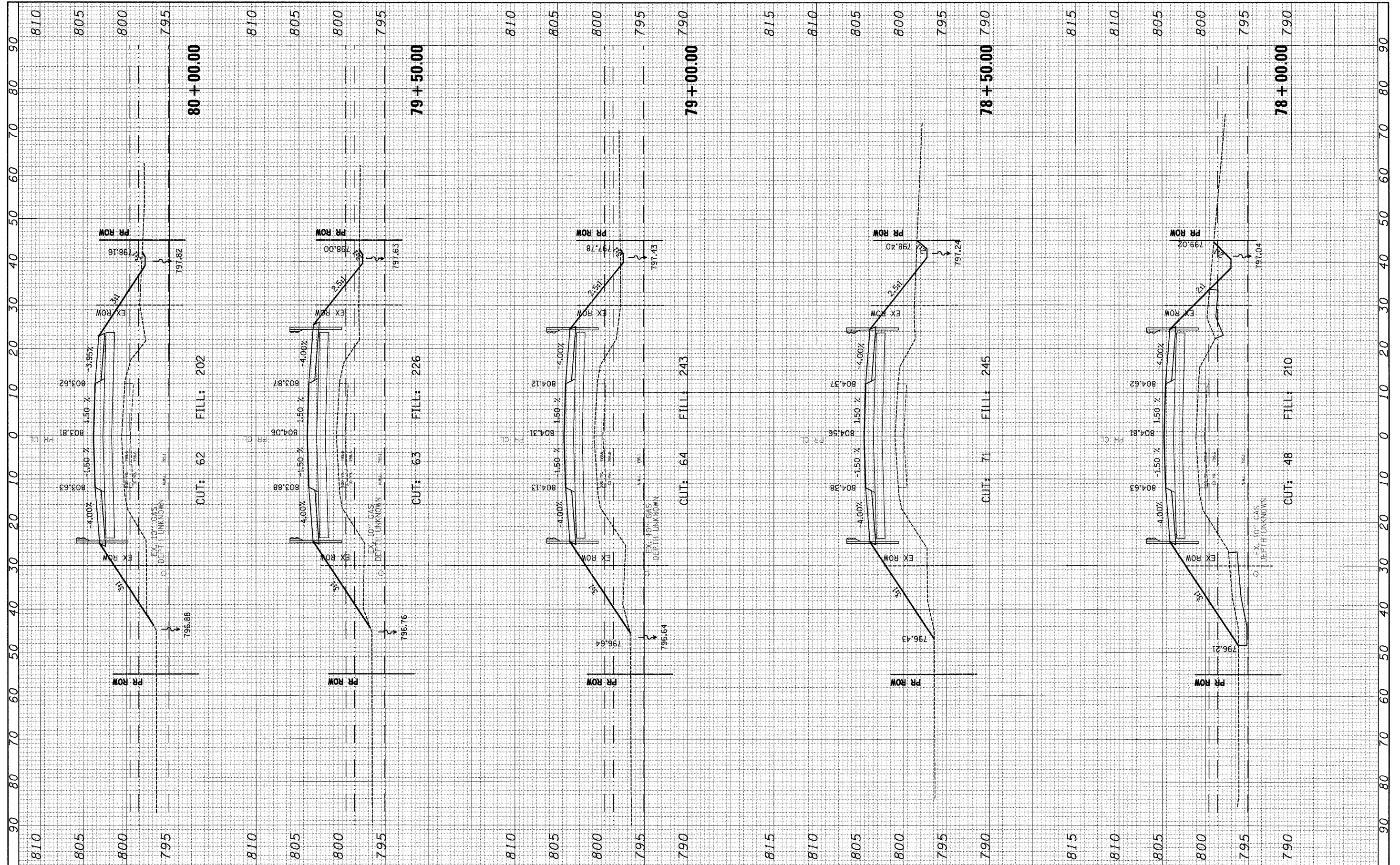

FILE NAME =	USER NAME = *USER*	DESIGNED - GJM	REVISED - 5/13/2008	<b>STATE OF ILLINOIS DEPARTMENT OF TRANSPORTATION</b>	<b>CROSS SECTIONS</b>		F.A.P. RTE. 324	SECTION 23B-1	COUNTY MCHENRY	TOTAL SHEETS 97	SHEET NO. 93	
*FILEL*	PLOT SCALE = *SCALE*	CHECKED - EJJ	REVISED - 7/18/2008		SCALE: 1"=10' H 1"=50' V	SHEET NO. 9 OF 13 SHEETS	STA. 78+00.00 TO STA. 80+00.00	CONTRACT NO. 62892				
	PLOT DATE = 7/17/2008	DRAWN - GJM	REVISED -		FED. ROAD DIST. NO. 1 ILLINOIS FED. AID PROJECT							
		CHECKED - EJJ	REVISED -									