

F.A.U. RTE.	SECTION	COUNTY	TOTAL SHEETS	SHEET No.
1004	08-00079-01-PP	COOK	46	15
STA.	TO STA.			
28+00	34+00			
FED. ROAD DIST. NO. 1		ILLINOIS	FED. AID PROJECT	

CONTRACT No. 63007

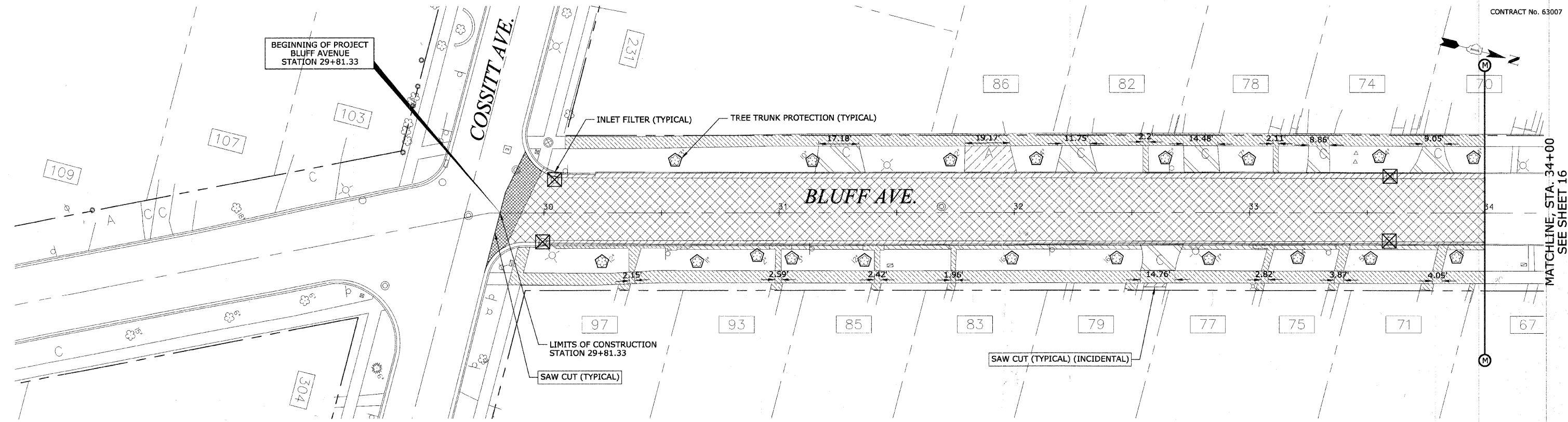

PLAN	SURVEYED	DATE
NOTE BOOK NO.	BY	
	PLOTTED	
	REVISIONS	
	FIELD CHECKED	
	DATE	
	CAD FILE NAME	

PROFILE	SURVEYED	DATE
NOTE BOOK NO.	BY	
	PLOTTED	
	REVISIONS	
	FIELD CHECKED	
	DATE	
	STRUCTURE NOTATIONS CHKD	

REMOVAL LEGEND	
	HOT-MIX ASPHALT SURFACE REMOVAL - BUTT JOINT
	PAVEMENT REMOVAL AND EXCAVATION
	SIDEWALK REMOVAL AND EXCAVATION
	CURB REMOVAL AND EXCAVATION
	HOT MIX ASPHALT DRIVEWAY REMOVAL AND EXCAVATION
	P.C.C. DRIVEWAY REMOVAL AND EXCAVATION
	EARTH EXCAVATION
	TREE REMOVAL

EROSION CONTROL LEGEND	
	INLET FILTER
	TREE TRUNK PROTECTION

**EROSION CONTROL GENERAL NOTES**

1. INLET FILTERS ARE TO BE PROVIDED AND MAINTAINED FOR ALL EXISTING AND PROPOSED DRAINAGE STRUCTURES WITHIN THE PROJECT LIMITS AND/OR AS DIRECTED BY THE ENGINEER (SEE DETAIL).
2. THE CONSTRUCTION LIMITS WILL BE THE EAST AND WEST RIGHT-OF-WAY LIMITS FOR BLUFF AVENUE. THE CONSTRUCTION LIMITS MAY BE ADJUSTED BY THE ENGINEER AND NO ADDITIONAL COMPENSATION WILL BE PAID TO THE CONTRACTOR FOR CHANGED CONSTRUCTION LIMITS.
3. SEE PAVEMENT MARKING, SIGNING AND LANDSCAPING PLAN SHEETS FOR SODDING INFORMATION.
4. SEE CROSS SECTIONS FOR GRADING INFORMATION.
5. SEE DRAINAGE AND UTILITY IMPROVEMENT SHEETS FOR STORM SEWER INFORMATION.

REVISIONS	
NAME	DATE

ILLINOIS DEPARTMENT OF TRANSPORTATION  
**BLUFF AVENUE IMPROVEMENTS  
STAGE 1**

**REMOVAL AND EROSION CONTROL PLAN**

SCALE: 1" = 20' H (Full Size)  
1" = 44' H (Tabloid)  
DATE 08/28/2008  
DRAWN BY H&A  
CHECKED BY PFH