



# Illinois Department of Transportation

2300 South Dirksen Parkway / Springfield, Illinois / 62764

December 17, 2008

SUBJECT: FAU 1263 & FAU 2718 (Wilmot Rd. & Hazel Ave.)  
Project BRM-9003(051)  
Section 08-00081-00-BR (Deerfield)  
Lake County  
Contract No. 63085  
Item 56  
January 16, 2009 Letting  
Addendum (A)

TO PROSPECTIVE BIDDERS:

Due to clarify information necessary to revise the following:

**Proposal – 'Bridge Approach Pavement Detail' added.**

Prime contractors must utilize the enclosed material when preparing their bid and must include any Schedule of Prices changes in their bidding proposal.

Bidders using computer-generated bids are cautioned to reflect any and all Schedule of Prices changes, if involved, into their computer programs.

Very truly yours,

Charles Ingersoll  
Engineer of Design and Environment

A handwritten signature in cursive script, reading "Ted B. Walschleger" followed by "P.E." to the right.

By: Ted B. Walschleger  
Engineer of Project Development  
and Implementation

**GUIDE BRIDGE SPECIAL PROVISION INDEX/CHECK SHEET**

Effective: July 9, 2008

√	Pg #	File Name	Title	Effective	Revised
		GBSP4	Polymer Modified Portland Cement Mortar	June 7, 1994	June 1, 2007
		GBSP11	Permanent Steel Sheet Piling	Dec 15, 1993	Jan 1, 2007
		GBSP12	Drainage System	June 10, 1994	Jan 1, 2007
		GBSP13	High-Load Multi-Rotational Bearings	Oct 13, 1988	Jan 1, 2007
		GBSP14	Jack and Remove Existing Bearings	April 20, 1994	Jan 1, 2007
		GBSP15	Three Sided Precast Concrete Structure	July 12, 1994	June 1, 2007
		GBSP16	Jacking Existing Superstructure	Jan 11, 1993	Jan 1, 2007
		GBSP17	Bonded Preformed Joint Seal	July 12, 1994	Jan 1, 2007
		GBSP18	Modular Expansion Joint	May 19, 1994	Jan 1, 2007
		GBSP21	Cleaning and Painting Contact Surface Areas of Existing Steel Structures	June 30, 2003	Jan 1, 2007
		GBSP22	Cleaning and Painting New Metal Structures	Sept 13, 1994	Jan 1, 2007
		GBSP25	Cleaning and Painting Existing Steel Structures	Oct 2, 2001	July 9, 2008
		GBSP26	Containment and Disposal of Lead Paint Cleaning Residues	Oct 2, 2001	July 9, 2008
		GBSP28	Deck Slab Repair	May 15, 1995	July 9, 2008
		GBSP29	Bridge Deck Microsilica Concrete Overlay	May 15, 1995	June 1, 2007
		GBSP30	Bridge Deck Latex Concrete Overlay	May 15, 1995	June 1, 2007
		GBSP31	Bridge Deck High-Reactivity Metakaolin (HRM) Conc Overlay	Jan 21, 2000	June 1, 2007
		GBSP32	Temporary Sheet Piling	Sept 2, 1994	Jan 1, 2007
		GBSP33	Pedestrian Truss Superstructure	Jan 13, 1998	Jan 1, 2007
X	72	GBSP34	Concrete Wearing Surface	June 23, 1994	Jan 15, 2008
		GBSP35	Silicone Bridge Joint Sealer	Aug 1, 1995	Jan 1, 2007
		GBSP36	Surface Preparation and Painting Req. for Weathering Steel	Nov 21, 1997	Feb 2, 2007
		GBSP37	Underwater Structure Excavation Protection	April 1, 1995	Jan 1, 2007
		GBSP38	Mechanically Stabilized Earth Retaining Walls	Feb 3, 1999	Jan 15, 2008
		GBSP42	Drilled Soldier Pile Retaining Wall	Sept 20, 2001	Feb 2, 2007
		GBSP43	Driven Soldier Pile Retaining Wall	Nov 13, 2002	Feb 2, 2007
		GBSP44	Temporary Soil Retention System	Dec 30, 2002	Jan 1, 2007
		GBSP45	Bridge Deck Thin Polymer Overlay	May 7, 1997	Jan 1, 2007
		GBSP46	Geotextile Retaining Walls	Sept 19, 2003	June 1, 2007
		GBSP47	High Performance Concrete Structures	Aug 5, 2002	Jan 1, 2007
		GBSP50	Removal of Existing Non-composite Bridge Decks	June 21, 2004	Jan 1, 2007
		GBSP51	Pipe Underdrain for Structures	May 17, 2000	Jan 1, 2007
		GBSP52	Porous Granular Embankment (Special)	Sept 28, 2005	Jan 1, 2007
X	74	GBSP53	Structural Repair of Concrete	Mar 15, 2006	April 2, 2008
		GBSP55	Erection of Curved Steel Structures	June 1, 2007	
		GBSP56	Setting Piles in Rock	Nov 14, 1996	Jan 1, 2007
		GBSP57	Temporary Mechanically Stabilized Earth Retaining Walls	Jan 6, 2003	April 2, 2008
		GBSP58	Mechanical Splice	Sep 21, 1995	Jan 1, 2007
		GBSP59	Diamond Grinding and Surface Testing Bridge Sections	Dec 6, 2004	July 9, 2008
		GBSP60	Containment and Disposal of Non-Lead Pain Cleaning Residues	Nov 25, 2004	July 9, 2008
		GBSP61	Slipform Parapet	June 1, 2007	
X	83	GBSP62	Concrete Deck Beams	June 13, 2008	July 9, 2008
		GBSP63	Demolition Plans for Removal of Existing Structures	Sept 5, 2007	
		GBSP64	Segmental Concrete Block Wall	Jan 7, 1999	July 9, 2008

LIST ADDITIONAL SPECIAL PROVISIONS BELOW

Temporary Wall Bracing System, Page 85

\* *Bridge Approach Pavement Detail, Page 86*

\* *Revised 12-17-08*

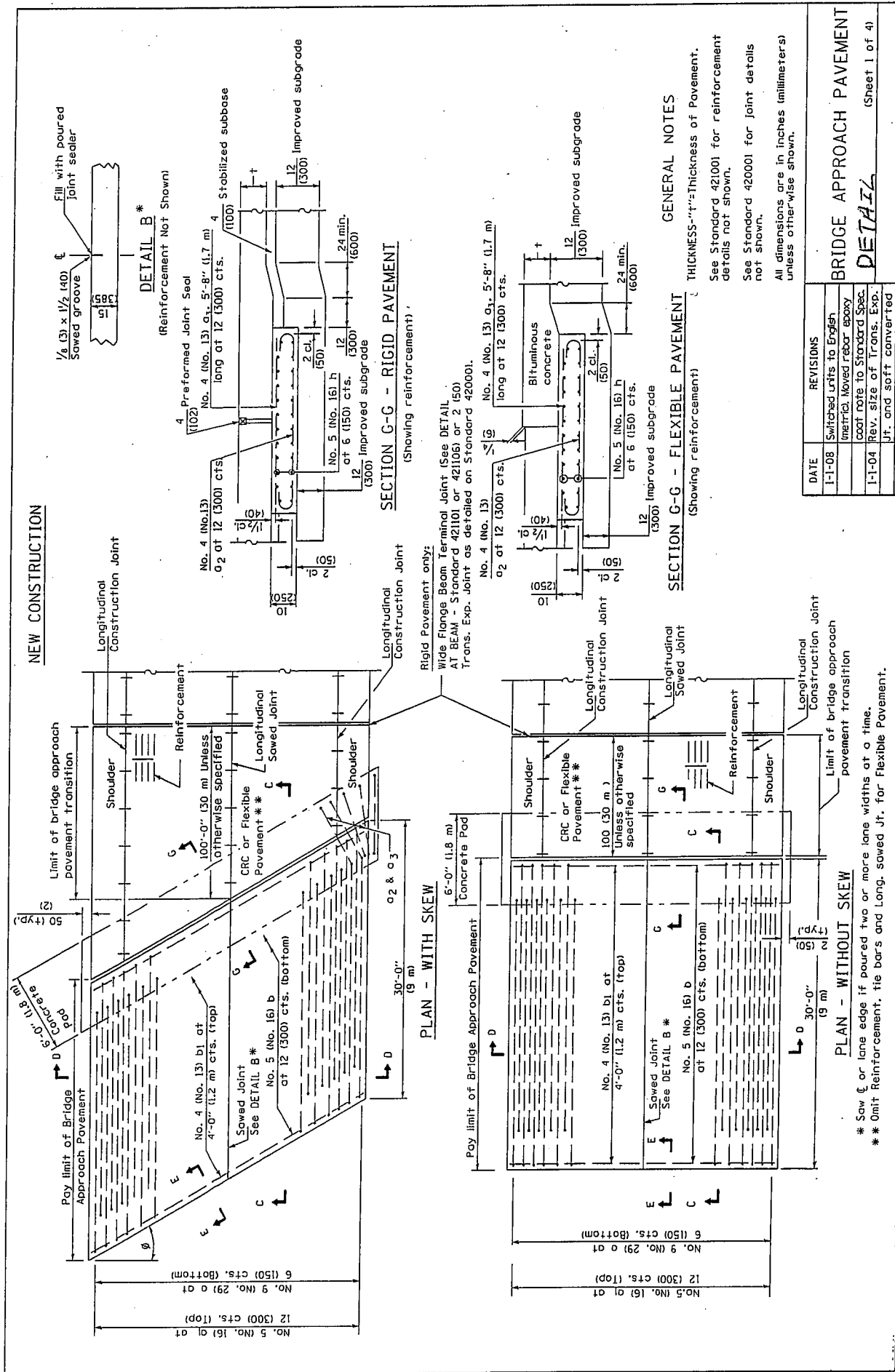

DATE	REVISIONS
1-1-08	Switched units to English (metric). Moved rebar epoxy coat note to Standard Spec.
1-1-04	Rev. size of Trans. Exp. Jt. and soft converted metric reinf.

**BRIDGE APPROACH PAVEMENT DETAIL**  
(Sheet 1 of 4)

EXISTING CONSTRUCTION

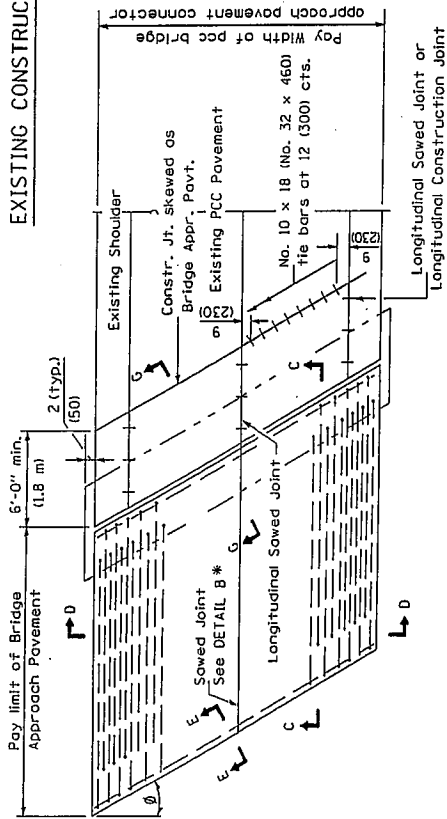

BRIDGE APPROACH PAVEMENT CONNECTOR (PCC)

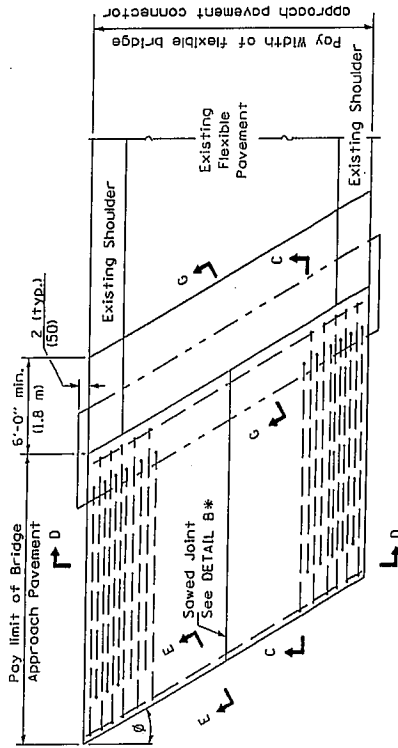

BRIDGE APPROACH PAVEMENT CONNECTOR (FLEXIBLE)

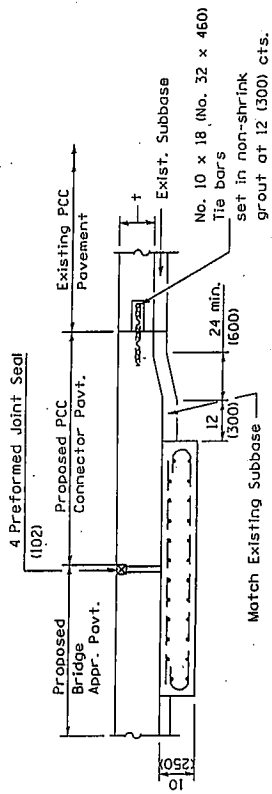

SECTION G-G - RIGID PAVEMENT

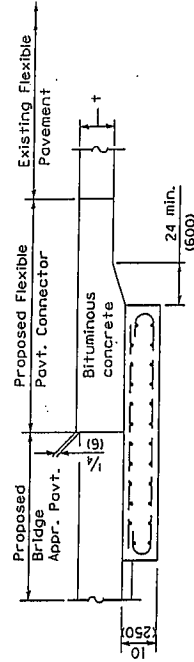

SECTION G-G - FLEXIBLE PAVEMENT

87

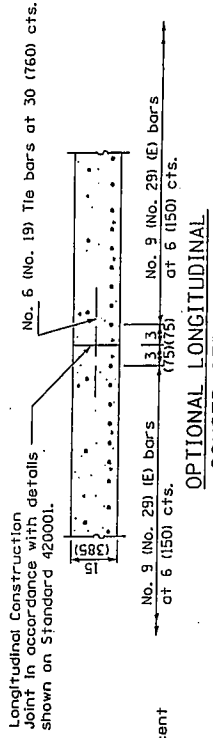
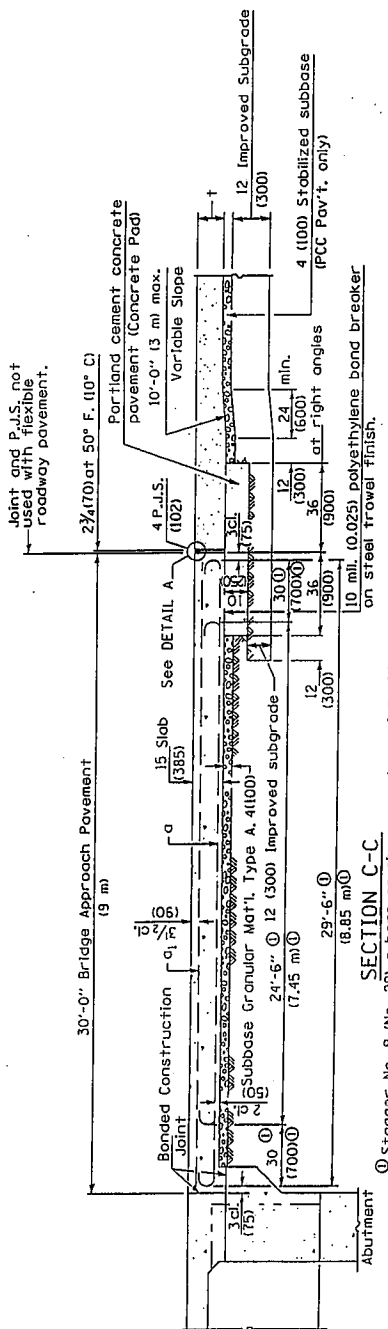
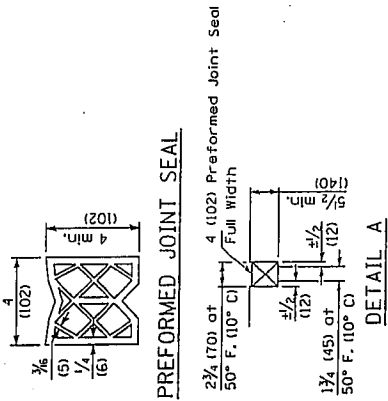

As approved by the Engineer, the Contractor may elect to reduce the widths of pair by use of the Optional Longitudinal Construction Joint shown. Joints shall be located at the edge of a traffic lane.

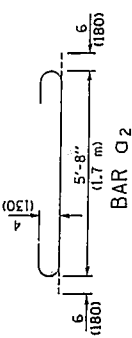
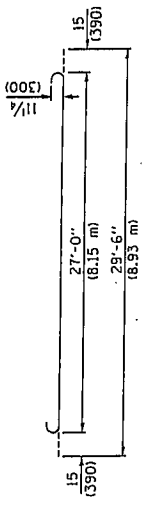
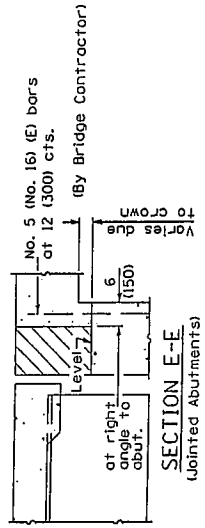
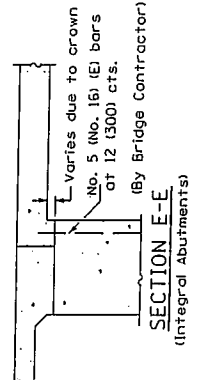
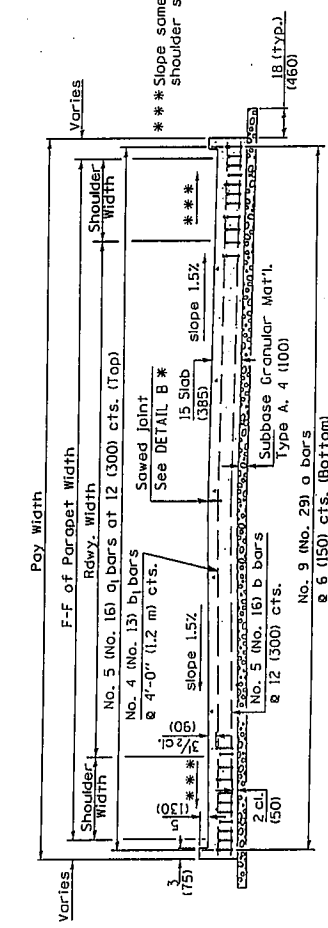

**BRIDGE APPROACH PAVEMENT**

*DETAIL*

(Sheet 3 of 4)

**DESIGN STRESSES**

f<sub>y</sub> = 60,000 P.S.I. (400 MPa)

f<sub>c</sub> = 3,500 P.S.I. (24 MPa)

n = 8.5

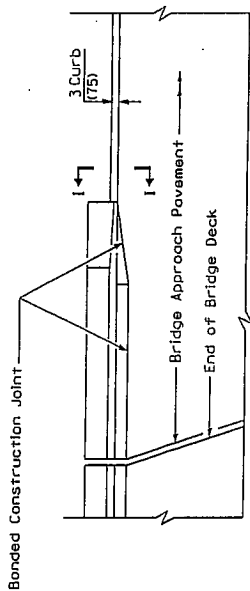

PARAPET TO CURB TRANSITION  
PILE BENT ABUTMENT

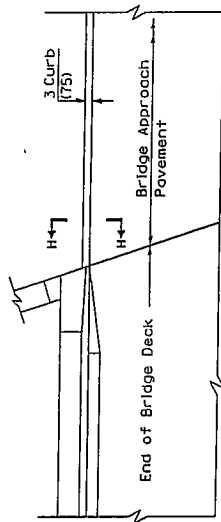

PARAPET TO CURB TRANSITION  
INTEGRAL ABUTMENT

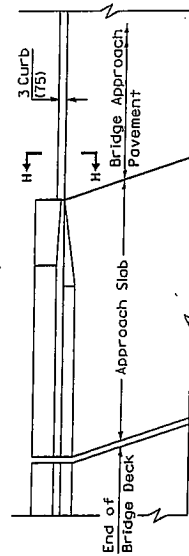

PARAPET TO CURB TRANSITION  
VAULTED ABUTMENT

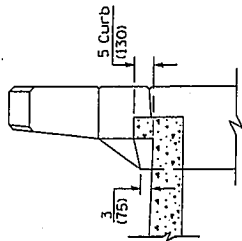

SECTION I - I

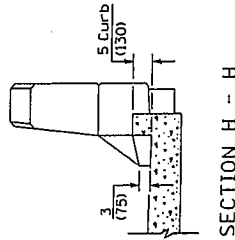

SECTION H - H