

F.A. RTE.	SECTION	COUNTY	TOTAL SHEETS	SHEET NO.
	08-00081-00-BR	LAKE	26	10
STA.	TO STA.			
FED. ROAD DIST. NO.	ILLINOIS FED. AID PROJECT			

63085

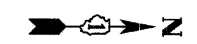

BENCHMARK 2007-70 (ALL ELEVATIONS ARE NAVD88 DATUM.)

VILLAGE OF DEERFIELD STANDARD MONUMENT LOCATED AT THE SOUTHEAST CORNER OF WILMOT ROAD AND SCHOOL STREET, AT 1313 WILMOT ROAD. THE MONUMENT IS 13.0 FEET EAST OF THE BACK OF WALK ON WILMOT ROAD AND 16.0 FEET SOUTH OF THE BACK OF ASPHALT PATH ON SCHOOL STREET. ELEVATION IS 668.29 NAVD88)

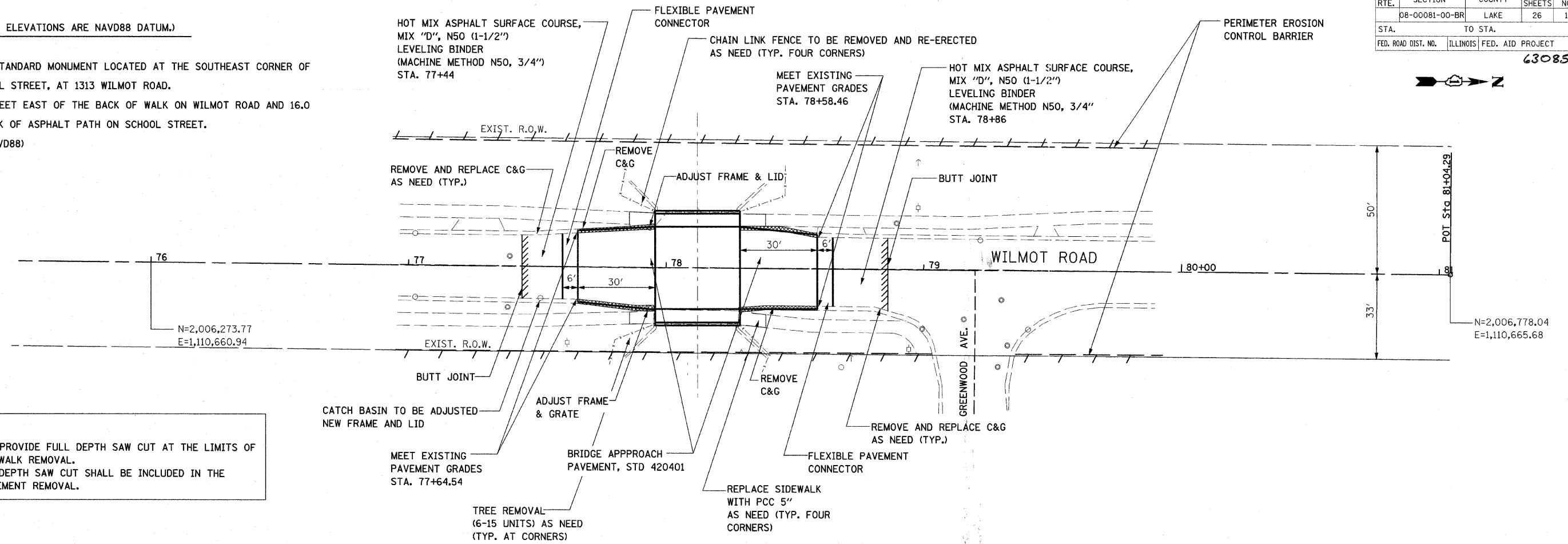

NOTE:
CONTRACTOR SHALL PROVIDE FULL DEPTH SAW CUT AT THE LIMITS OF PAVEMENT AND SIDEWALK REMOVAL. THE COST OF FULL DEPTH SAW CUT SHALL BE INCLUDED IN THE UNIT PRICE OF PAVEMENT REMOVAL.

PLAN	DATE
BY	
REVISIONS	
NO.	

PROFILE	DATE
BY	
REVISIONS	
NO.	

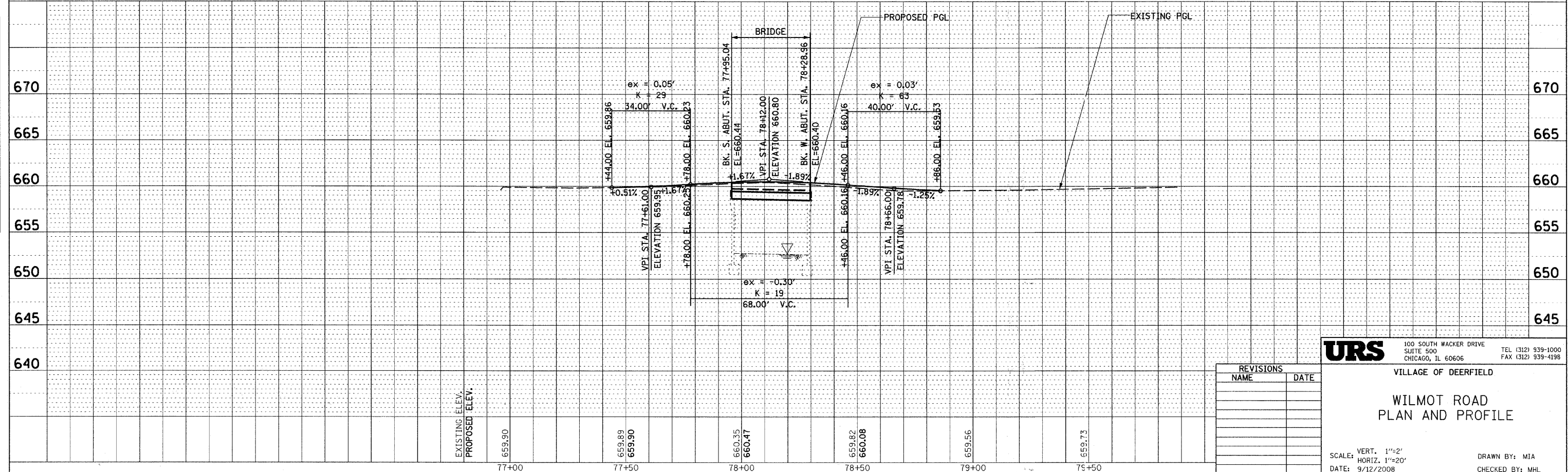

REVISIONS	NAME	DATE

URS 100 SOUTH WACKER DRIVE SUITE 500 CHICAGO, IL 60606 TEL (312) 939-1000 FAX (312) 939-4198

VILLAGE OF DEERFIELD

**WILMOT ROAD
PLAN AND PROFILE**

SCALE: VERT. 1"=2'
HORIZ. 1"=20'

DATE: 9/12/2008

DRAWN BY: MIA
CHECKED BY: MHL