

DESIGNER: JOSH JOCHUMS
PHONE: (309)671-3481

PROJECT ENGINEER: JIM MILLER
PHONE: (309)671-3451

STATE OF ILLINOIS
DEPARTMENT OF TRANSPORTATION
DIVISION OF HIGHWAYS

**PROPOSED
HIGHWAY PLANS**

FAP ROUTE 693 (IL.9)
D4 MISC. BRIDGE REPAIR 2008
McNAUGHTON BRIDGE – 12(B)
HMW METHACRYLATE SEALER
TAZEWELL COUNTY

F.A.P. RTE.	SECTION	COUNTY	TOTAL SHEETS	SHEET NO.
693	*	TAZEWELL	8	3
FED. ROAD DIST. NO. 4		ILLINOIS	CONTRACT NO. 68706	

* D4 MISC BRIDGE REPAIR 2008

D-94-036-07

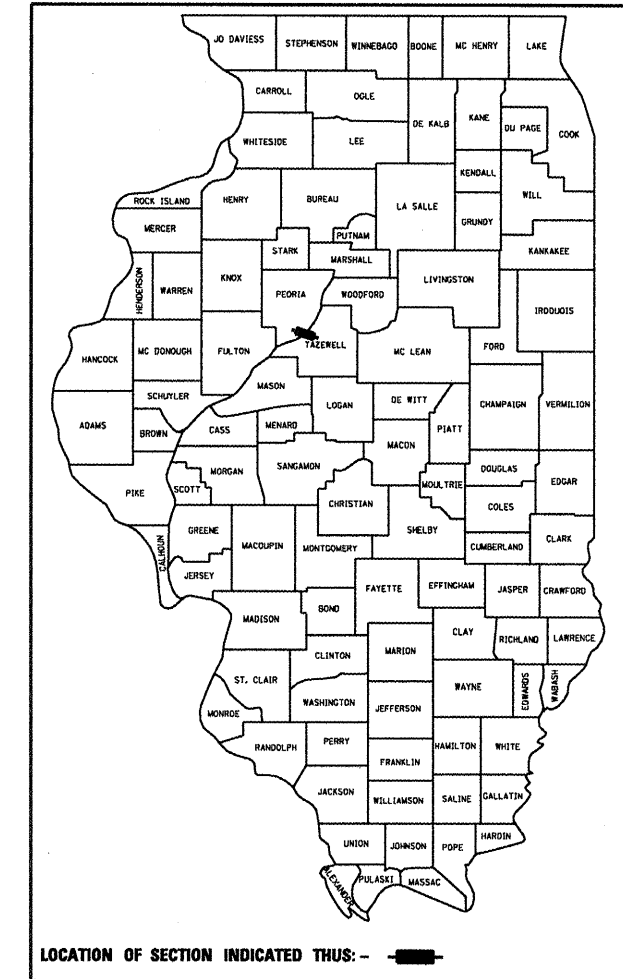

INDEX OF SHEETS:

1. COVER SHEET
2. COMMITMENTS & GENERAL NOTES
3. SUMMARY OF QUANTITIES
4. CROSS SECTIONS
5. SCHEDULE OF QUANTITIES
- 6-7. TRAFFIC CONTROL PLAN
8. GENERAL PLAN & ELEVATION

STANDARDS:

- 701001-02 701601-06
701006-03 701901-01
701422-02

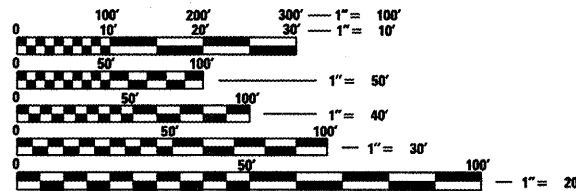

FULL SIZE PLANS HAVE BEEN PREPARED USING STANDARD ENGINEERING SCALES. REDUCED SIZED PLANS WILL NOT CONFORM TO STANDARD SCALES. IN MAKING MEASUREMENTS ON REDUCED PLANS, THE ABOVE SCALES MAY BE USED.

J.U.L.I.E.
JOINT UTILITY LOCATION INFORMATION FOR EXCAVATION
1-800-892-0123
OR 811

PROJECT ENGINEER: JIM MILLER
PROJECT MANAGER: MAUREEN ADDIS

CONTRACT NO. 68706

C-94-055-07

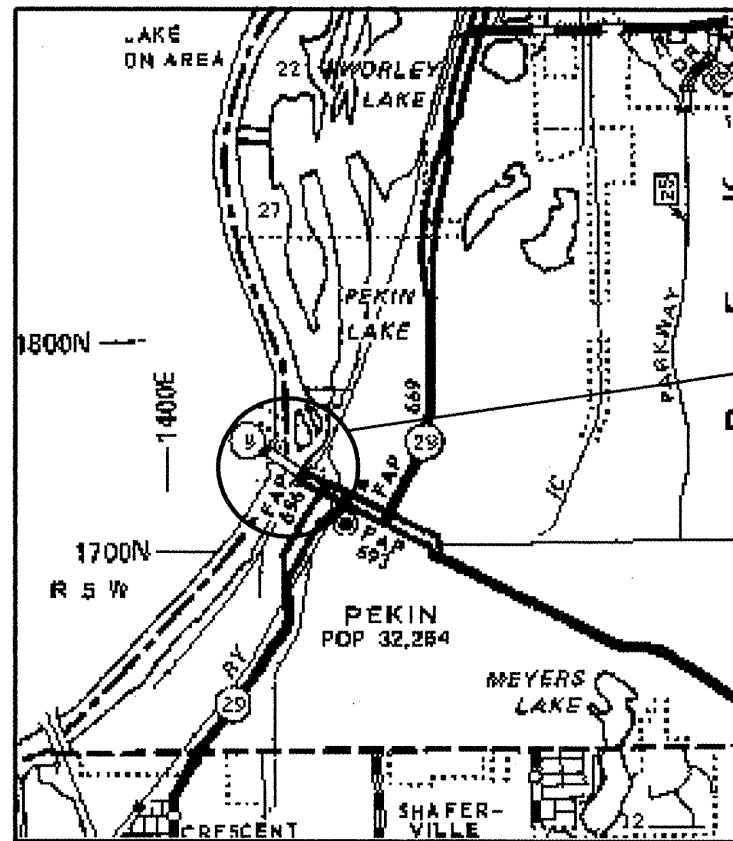

LOCATION MAP

GROSS LENGTH = 820,000 FT. = 0.155 MILE
NET LENGTH = 820,000 FT. = 0.155 MILE

WORK TO CONSIST OF APPLICATION OF HIGH MOLECULAR WEIGHT METHACRYLATE CONCRETE SEALER TO DECK OF McNAUGHTON BRIDGE CARRYING RT 9 OVER ILLINOIS RIVER (S.N. 090-0114) IN PEKIN.

STATE OF ILLINOIS
DEPARTMENT OF TRANSPORTATION
DIVISION OF HIGHWAYS

SUBMITTED 007 30 08

DEPUTY DIRECTOR OF HIGHWAYS, REGION ENGINEER
December 5, 2008
Eric E. Harmel
ENGINEER OF DESIGN AND ENVIRONMENT

December 5, 2008
Christine M. Reed
DIRECTOR OF HIGHWAYS, CHIEF ENGINEER

PRINTED BY THE AUTHORITY
OF THE STATE OF ILLINOIS

COMMITMENTS

NO COMMITMENTS HAVE BEEN MADE FOR THIS PROJECT.

GENERAL NOTES

THE DECK SEAL PRODUCT SHALL BE APPLIED TO THE CLEANED SURFACE FROM JOINT TO JOINT OVER SPANS 5,6,7,8, AND 9 (THE ORTHOTROPIC DECK AND ADJACENT SPANS) OF THE BRIDGE. SURFACE PREPARATIONS AS DESCRIBED IN THE SPECIAL PROVISIONS ARE INCIDENTAL TO SEALING METHOD SPECIFIED.

S.N. 090-0114 IL.9
over IL. RIVER

FILE NAME = #FILE#	USER NAME = #USER#	DESIGNED - ---	REVISED - ---	STATE OF ILLINOIS DEPARTMENT OF TRANSPORTATION	COMMITMENTS & GENERAL NOTES	F.A.P. RTE.	SECTION	COUNTY	TOTAL SHEETS	SHEET NO.	
		DRAWN - ---	REVISED - ---			693	D4 MISC BRIDGE REPR 2008	TAZEWELL	8	2	
		CHECKED - ---	REVISED - ---			HMW METHACRYLATE SEALER					
		DATE - 04-22-2008	REVISED - ---			FED. ROAD DIST. NO. 4 ILLINOIS FED. AID PROJECT					
				SCALE: _____ SHEET NO. ___ OF ___ SHEETS STA. _____ TO STA. _____							
68706											

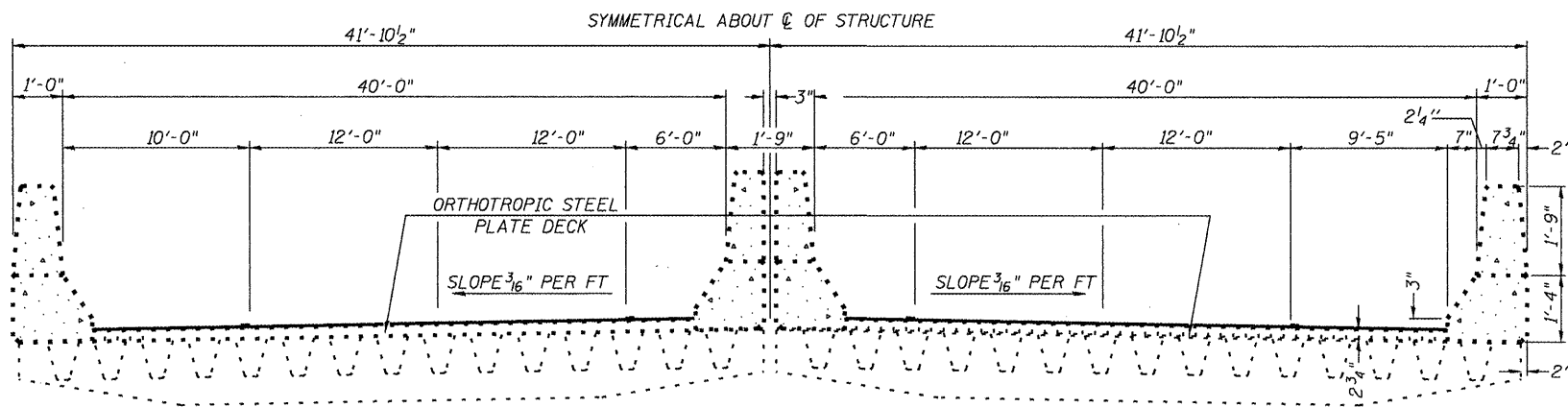

CROSS SECTION OF MAIN RIVER (SPANS 6-8)
(LOOKING EAST)

NOTE
SEALER APPLICATION DECK AREA
SHALL BE ON SPANS 5,6,7,8,9

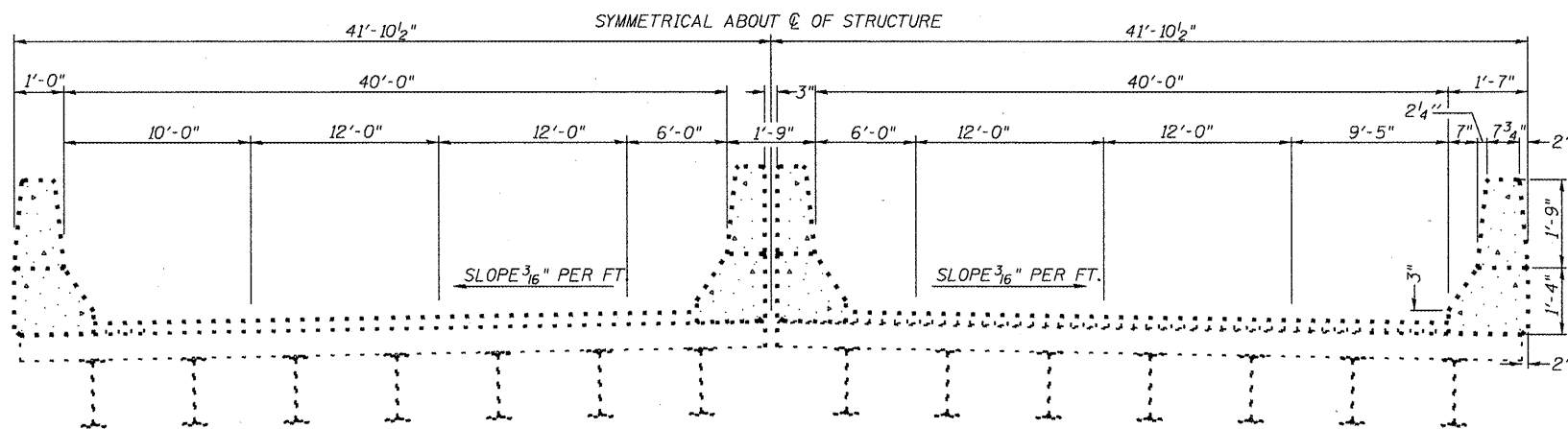

CROSS SECTION THRU APPROACH SPANS (1 THRU 5 AND 9)
(LOOKING EAST)

S.N. 090-0114 IL.9
over IL. RIVER

FILE NAME =	USER NAME = #USER#	DESIGNED -	REVISED -	STATE OF ILLINOIS DEPARTMENT OF TRANSPORTATION	CROSS SECTIONS	F.A.P. RTE.	SECTION	COUNTY	TOTAL SHEETS	SHEET NO.
#FILE#	DRAWN - JCJ	CHECKED -	REVISED -			693	D4 MISC BRIDGE REPR 2008	TAZEWELL	8	4
PLOT SCALE = #SCALE#	DATE - 04-22-2008	REVISED -	REVISED -			HMW METHACRYLATE SEALER			68706	
PLOT DATE = #DATE#						FED. ROAD DIST. NO. 4	ILLINOIS FED. AID PROJECT		DRAWN BY: JCJ	
SCALE: _____ SHEET NO. _____ OF _____ SHEETS STA. _____ TO STA. _____										

SCHEDULE OF QUANTITIES

SN. 090-0114 (McNAUGHTON BRIDGE)

MOBILIZATION

JOBSITE = 1.0 LSUM

T.C. & P, STANDARD 701422

EB WORKZONES = 1.0 LSUM

T.C. & P, STANDARD 701601

WB WORKZONES = 1.0 LSUM

CONCRETE METHACRYLATE SEALER

DECK OF STRUCTURE = 15,171 SQYD

S.N. 090-0114 IL.9
over IL. RIVER

FILE NAME =	USER NAME = #USER#	DESIGNED - ---	REVISED - ---	STATE OF ILLINOIS DEPARTMENT OF TRANSPORTATION	SCHEDULE OF QUANTITIES	F.A.P. RTE.	SECTION	COUNTY	TOTAL SHEETS	SHEET NO.
#FILE#		DRAWN - JGJ	REVISED - ---			693	D4 MISC BRIDGE REPR 2008	TAZEWELL	8	5
PLOT SCALE = #SCALE#		CHECKED - ---	REVISED - ---			HMW METHACRYLATE SEALER		CONTRACT NO. 68706		
PLOT DATE = #DATE#		DATE - 04-22-2008	REVISED - ---			FED. ROAD DIST. NO. 4 (ILLINOIS) FED. AID PROJECT		DRAWN BY: JGJ		
				SCALE: _____ SHEET NO. ___ OF ___ SHEETS STA. _____ TO STA. _____						

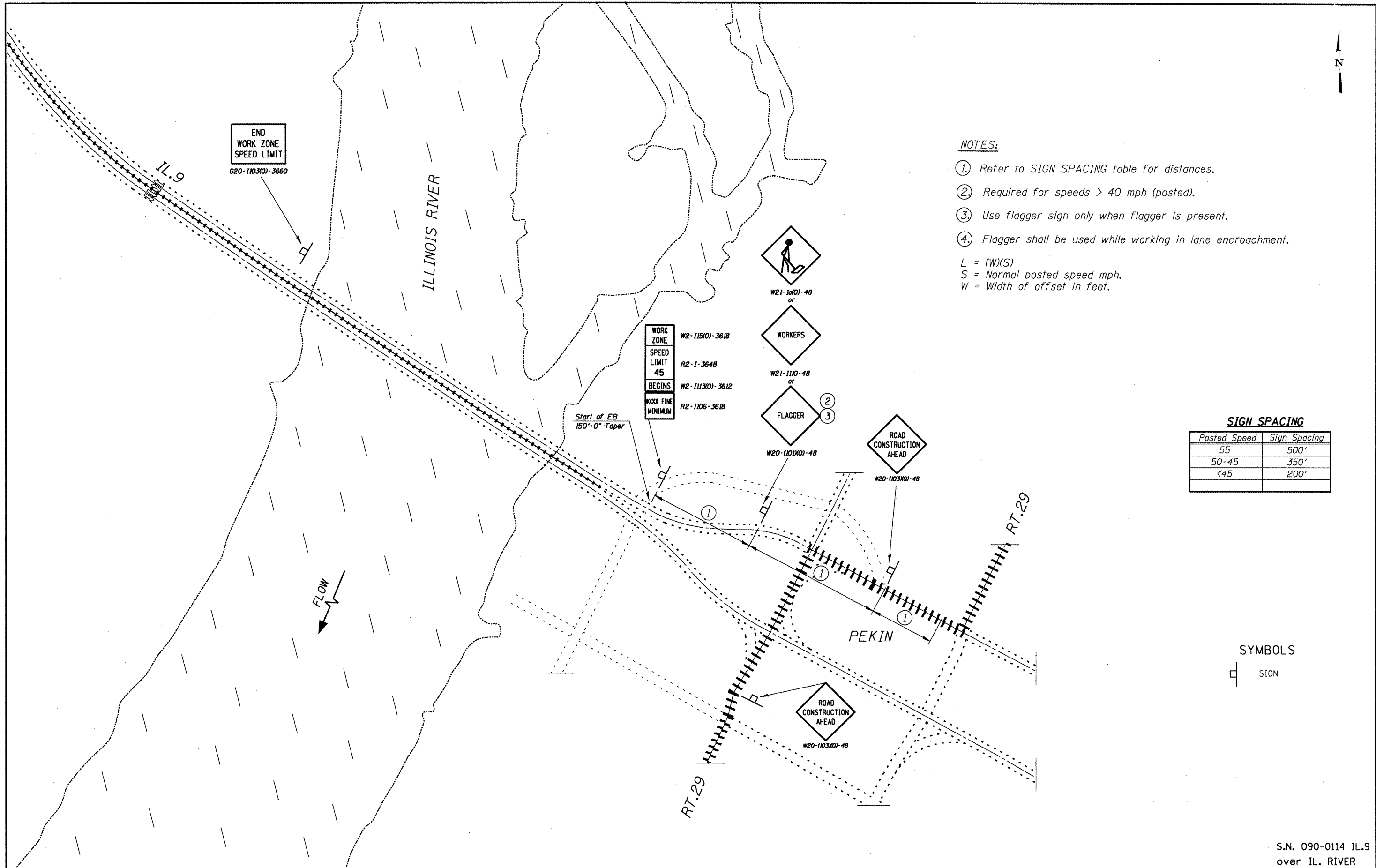

- NOTES:**
- ① Refer to SIGN SPACING table for distances.
 - ② Required for speeds > 40 mph (posted).
 - ③ Use flagger sign only when flagger is present.
 - ④ Flagger shall be used while working in lane encroachment.
- L = (W)(S)
 S = Normal posted speed mph.
 W = Width of offset in feet.

SIGN SPACING

Posted Speed	Sign Spacing
55	500'
50-45	350'
<45	200'

SYMBOLS

□ SIGN

S.N. 090-0114 IL.9
 over IL. RIVER

FILE NAME = #FILE#	USER NAME = #USER#	DESIGNED - ---	REVISED - ---	STATE OF ILLINOIS DEPARTMENT OF TRANSPORTATION	TRAFFIC CONTROL PLAN	F.A.P. RTE. 693	SECTION D4 MISC BRIDGE REPR 2008	COUNTY TAZEWELL	TOTAL SHEETS 8	SHEET NO. 6
		DRAWN - ---	REVISED - ---			HMW METHACRYLATE SEALER		CONTRACT NO. 68706		
		CHECKED - ---	REVISED - ---		SCALE: _____	SHEET NO. ___ OF ___ SHEETS		STA. _____ TO STA. _____		FED. ROAD DIST. NO. 4 ILLINOIS FED. AID PROJECT
		DATE - 04-22-2008	REVISED - ---							

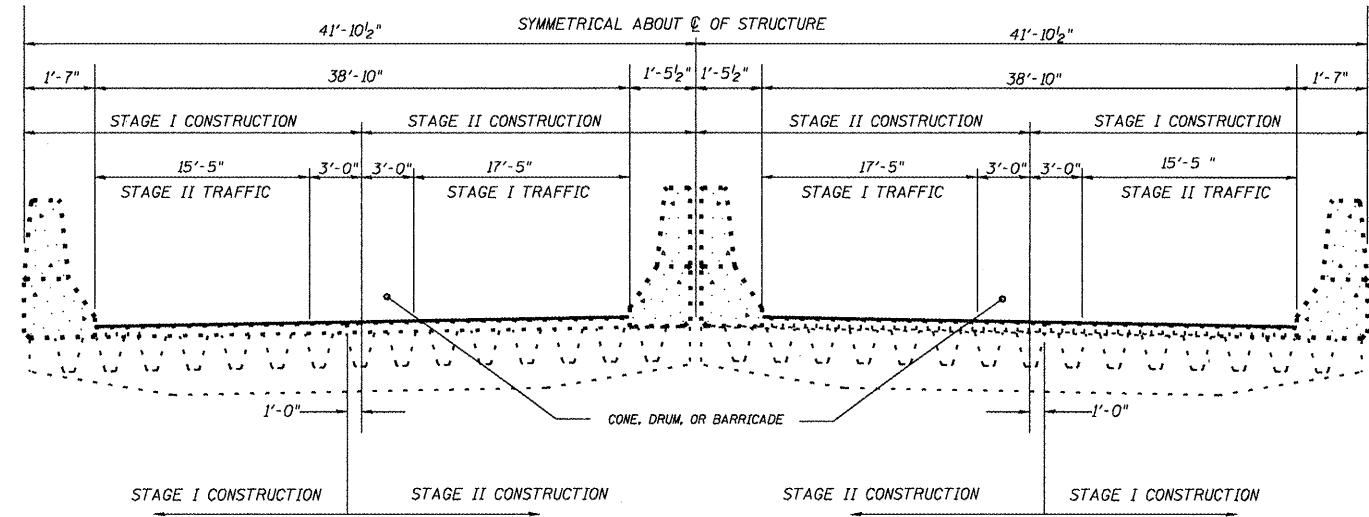

CROSS SECTION THRU MAIN RIVER SPANS (6 THRU 8)
(LOOKING EAST)

- SYMBOLS**
- Work area
 - Traffic Flow
 - Cone, Drum, or Barricade
 - Type II Barricades w/Flashing Lights

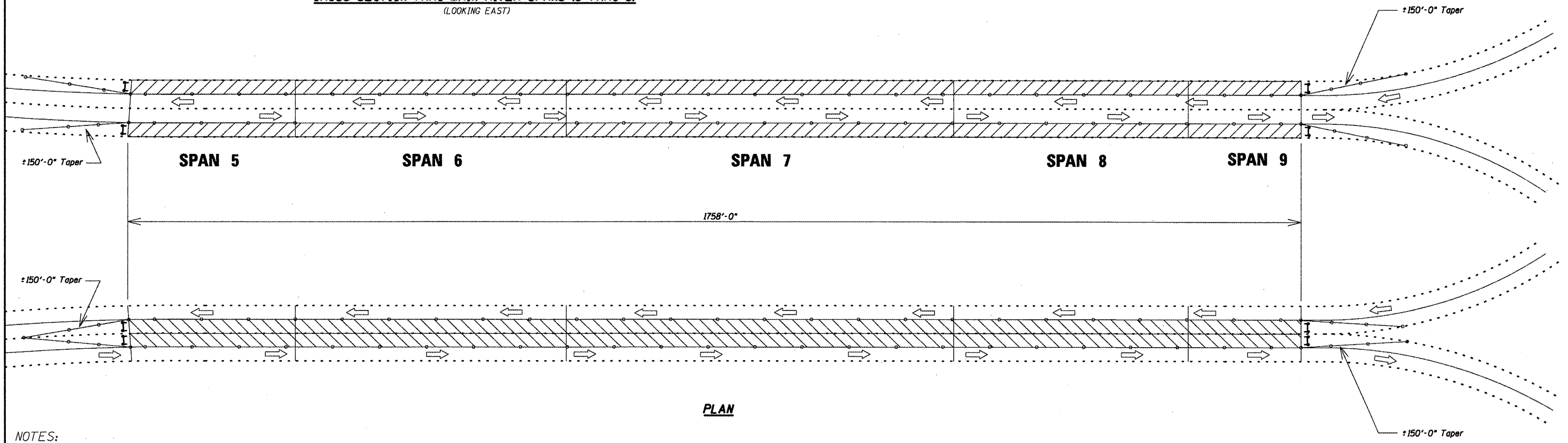

PLAN

NOTES:
 Refer to Highway Standards 701601 and 701422 in conjunction with this sheet for exact placement of traffic management devices and other clarifications as construction staging symbols were duplicated off of these standards.
 No parking or material storage shall be allowed in the taper.
 Existing posted speed limit signs shall be completely covered during working hours. All cones shall be a minimum height of 28".
 701422 shall be used for EB traffic control and 701601 for WB lanes.
 Resident Engineer shall have discretionary choice for order of traffic staging.
 Additional Speed Limit and End Work Zone signage and placement shall be included in cost of Traffic Control.

S.N. 090-0114 IL.9
over IL. RIVER

FILE NAME =	USER NAME = #USER#	DESIGNED -	REVISED -	STATE OF ILLINOIS DEPARTMENT OF TRANSPORTATION	TRAFFIC CONTROL PLAN		F.A.P. RTE.	SECTION	COUNTY	TOTAL SHEETS	SHEET NO.
#FILE#		DRAWN -	REVISED -				693	D4 MISC BRIDGE REPR 2008	TAZEWELL	8	7
		CHECKED -	REVISED -				HMW METHACRYLATE SEALER	CONTRACT NO. 68706			
		DATE - 04-22-2008	REVISED -				FED. ROAD DIST. NO. 4 [ILLINOIS] FED. AID PROJECT				
					SCALE: _____	SHEET NO. ___ OF ___ SHEETS	STA. _____	TO STA. _____			

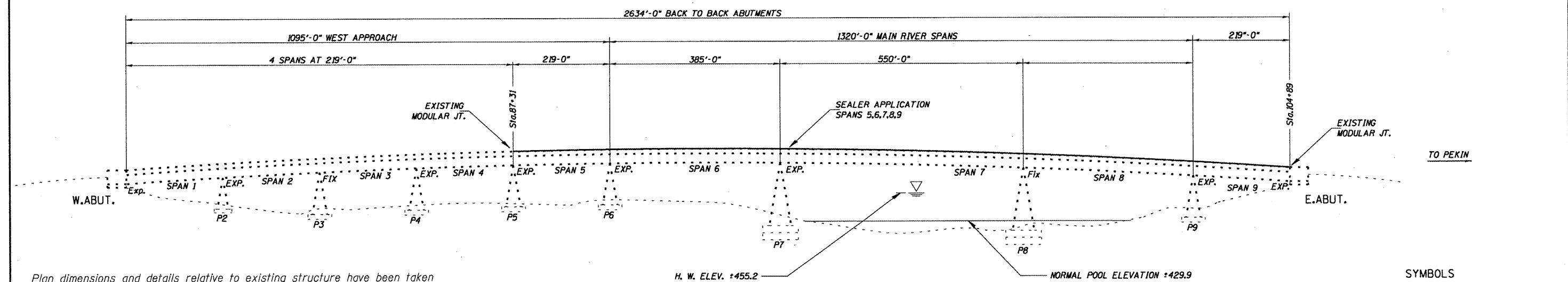
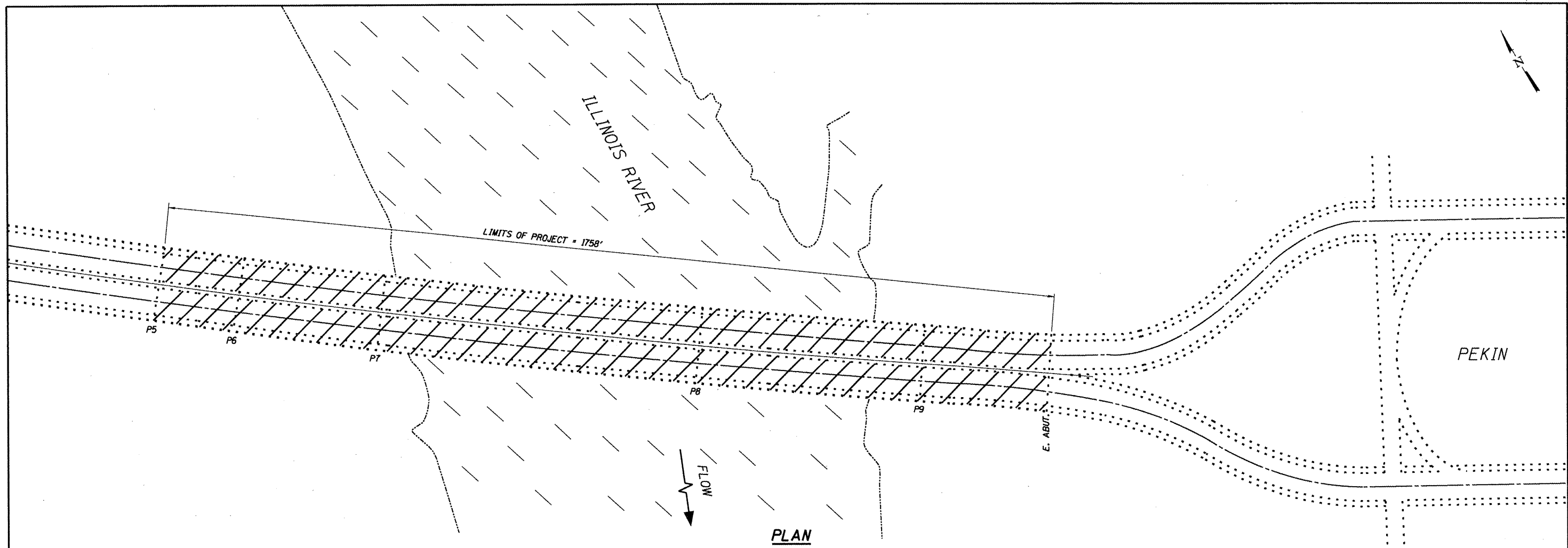

Plan dimensions and details relative to existing structure have been taken from existing plans and are subject to nominal construction variations. It shall be the Contractor's responsibility to verify such dimensions and details in the field and make necessary approved adjustments prior to construction or ordering of materials. Such variations shall not be cause for additional compensation for a change in the scope of the work, however, the Contractor will be paid for the quantity actually furnished at the unit price bid for the work.

SYMBOLS
 Sealer Application Area

FILE NAME =	USER NAME = #USER#	DESIGNED -	REVISED -
#FILE#		DRAWN - JGJ	REVISED -
	PLOT SCALE = #SCALE#	CHECKED -	REVISED -
	PLOT DATE = #DATE#	DATE - 04-22-2008	REVISED -

STATE OF ILLINOIS
DEPARTMENT OF TRANSPORTATION

GENERAL PLAN & ELEVATION

SCALE: _____ SHEET NO. _____ OF _____ SHEETS STA. _____ TO STA. _____

F.A.P. RTE.	SECTION	COUNTY	TOTAL SHEETS	SHEET NO.
693	D4 MISC BRIDGE REP 2008	TAZEWELL	8	8
HMW METHACRYLATE SEALER			CONTRACT NO. 68706	
FED. ROAD DIST. NO. 4 ILLINOIS FED. AID PROJECT			DRAWN BY: JGJ	

S.N. 090-0114 IL.9
over IL. RIVER