

NOTE:

Five W12-I103 signs, as described in the Special Provisions, will be required. Signs shall be placed at the intersections of US.34 with IL. routes 164, 94, & 67 as shown on Sheet 9. These signs shall be located at the direction of the Engineer.

High intensity flashing lights shall be placed on the RCA signs as directed by the Engineer.

The costs shall be included with the cost of the TRAFFIC CONTROL AND PROTECTION STANDARD 701321.

STAGE II

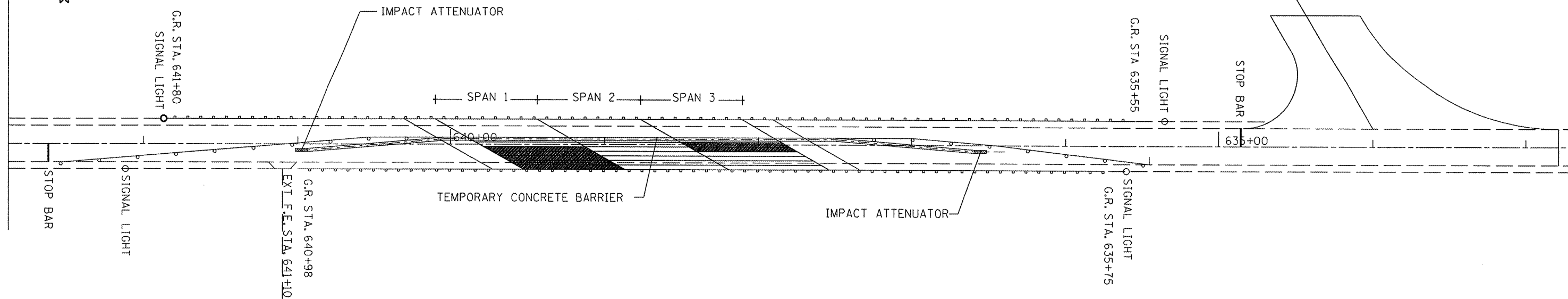
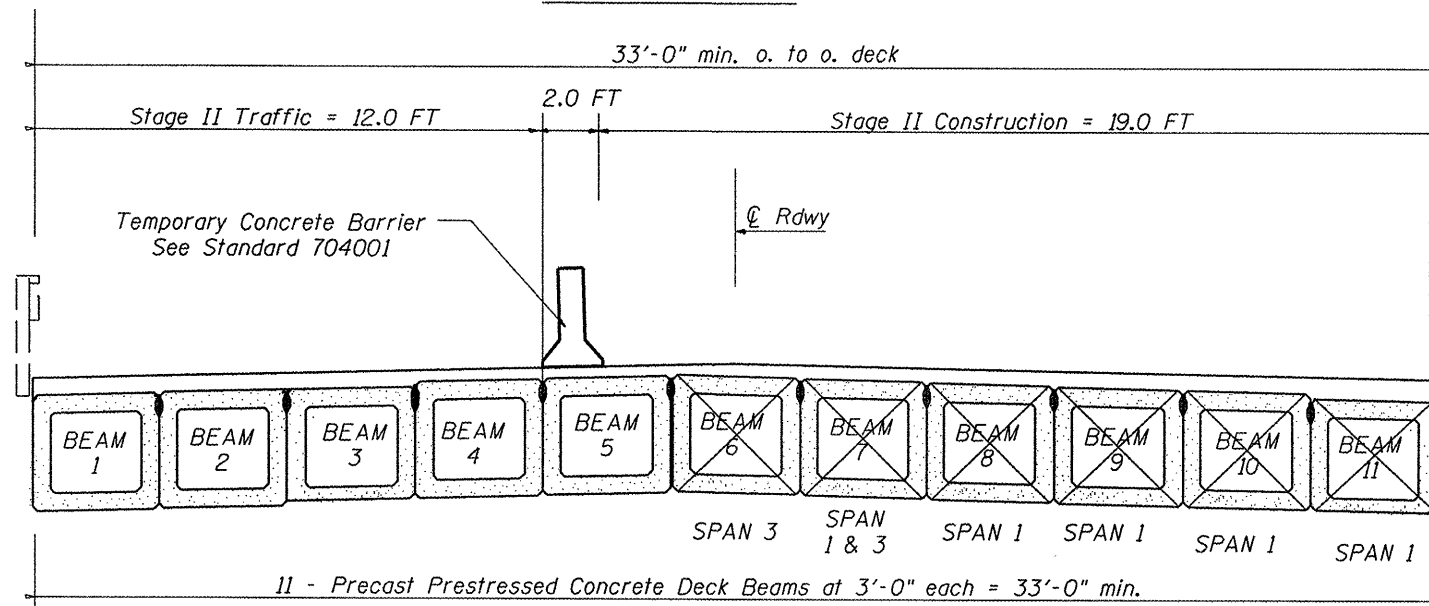

STAGE II CONSTRUCTION

FILE NAME : #FILE#	USER NAME : #USER#	DESIGNED - ---	REVISED - ---	STATE OF ILLINOIS DEPARTMENT OF TRANSPORTATION	STAGING PLAN SHEET		F.A.P. RTE. 313	SECTION (6BR-1)I	COUNTY HENDERSON	TOTAL SHEETS 14	SHEET NO. 8
	PLOT SCALE : #SCALE#	DRAWN - ---	REVISED - ---		SCALE:	SHEET NO. .. OF ... SHEETS	STA. TO STA.	CONTRACT NO. 68849		FED. ROAD DIST. NO.	FED. AID PROJECT
		CHECKED - ---	REVISED - ---								
		DATE -	REVISED - ---								