

ROUTE NO.	SECTION	COUNTY	TOTAL SHEETS	SHEET NO.
FAP 323	145BR-1	DOUGLAS	39	29
FED. ROAD DIST. NO. 7		ILLINOIS	FED. AID PROJECT	

SHEET NO. 5  
10 SHEETS

Contract #70393

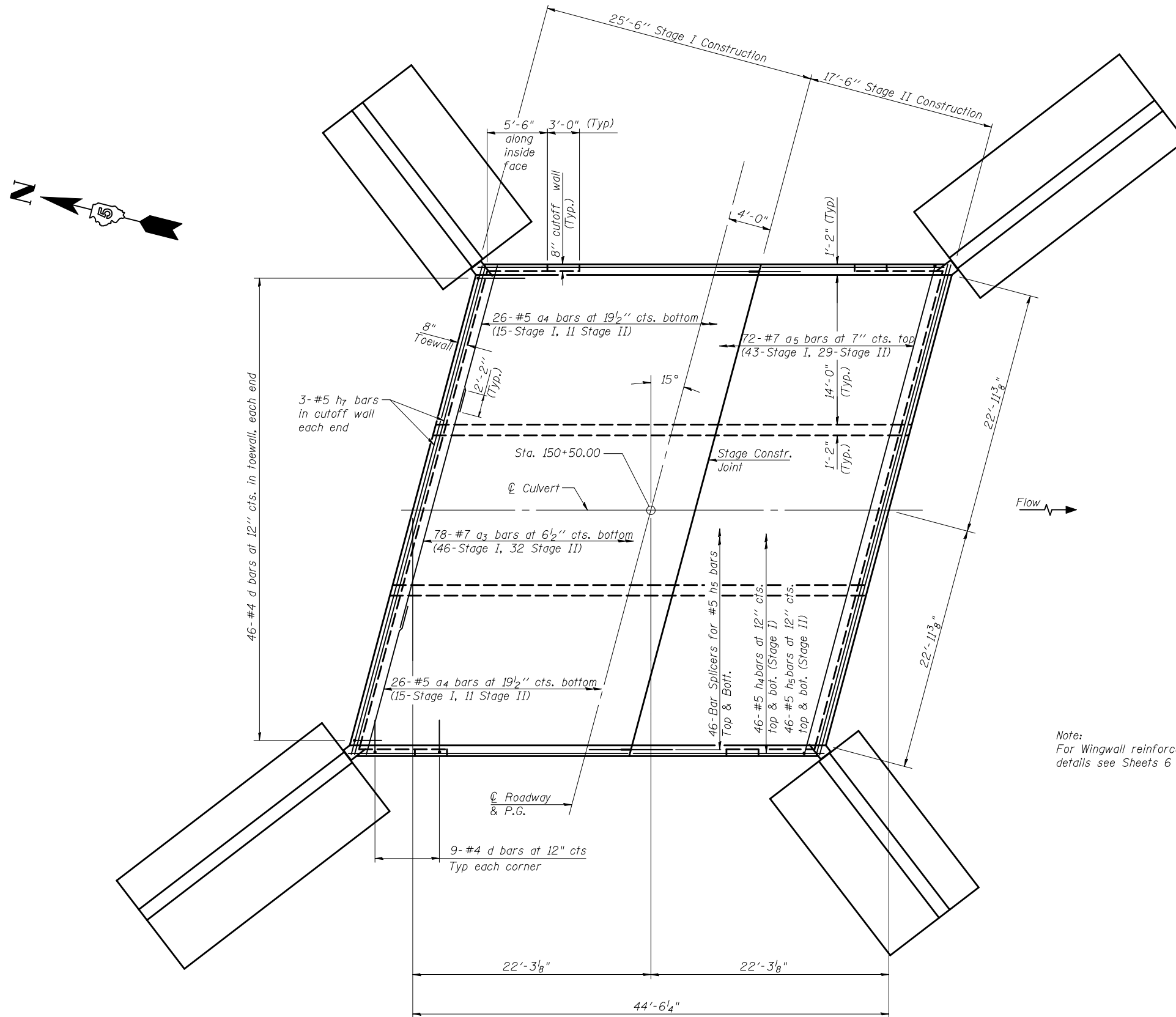

Note:  
For Wingwall reinforcement and details see Sheets 6 and 7 of 10.

**PLAN**  
**BOTTOM SLAB**

DATE = 10/16/2008  
FILE NAME = I:\Projects\70393\Drawings\Sheet-05-bottomslab.dgn  
PLOT SCALE = 1/8" = 1'-0"  
USER NAME = stuf18

ILLINOIS DEPARTMENT OF TRANSPORTATION	
SHEET TITLE BOTTOM SLAB DETAILS	
PROJECT US 36 OVER HACKETT BRANCH FAP RTE 323 SECTION 145 BR-1 DOUGLAS COUNTY STATION 150+50 STRUCTURE NUMBER 021-2026	PROJECT NO. 03020 SCALE DATE 06/05/07 DRAWN BY TFG CHECKED BY CME/KS/MCB DRAWING NO.
<b>COOMBE-BLOXDORF P.C.</b> Engineers / Land Surveyors Springfield, Illinois Design Firm License No. 184-002708	5 OF 10 SHTS