

STATE OF ILLINOIS
DEPARTMENT OF TRANSPORTATION
DIVISION OF HIGHWAYS
PROPOSED
HIGHWAY PLANS
F.A.S. ROUTE 331 (CH 10)
SECTION (79-102)2009BBR
VERMILION COUNTY

F.A.S. RTE.	SECTION	COUNTY	TOTAL SHEETS	SHEET NO.
331	(79-102)2009BBR	VERMILION	16	1
FED. ROAD DIST. NO.	ILLINOIS	CONTRACT NO. 70749		

FOR INDEX OF SHEETS, SEE SHEET NO. 2
 FOR SUMMARY OF QUANTITIES, SEE SHEET NO. 4

D-95-038-08

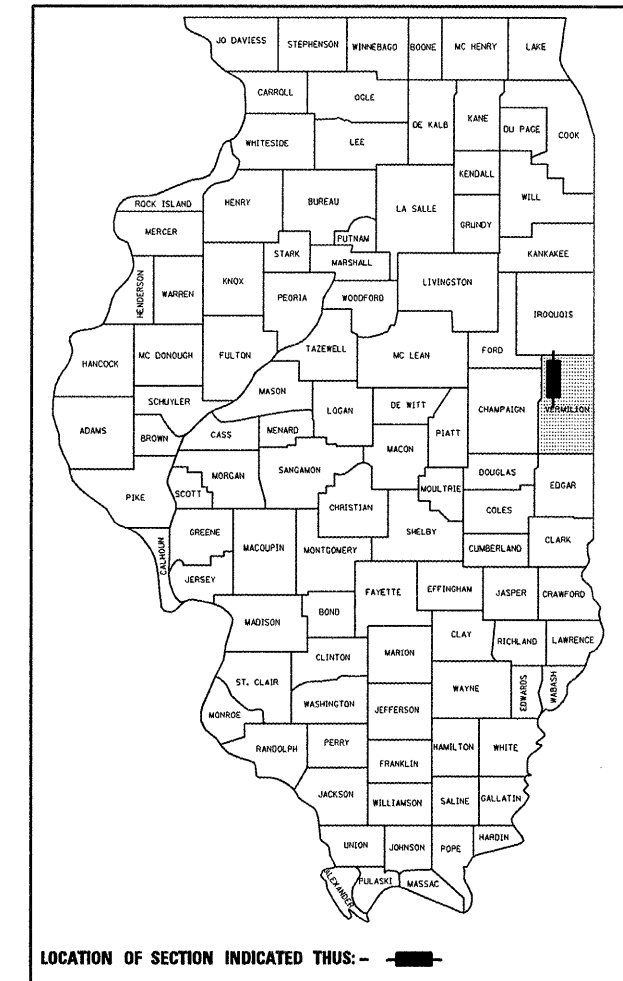

SECTION (79-102)2009BBR
 S.N. 092-0176
 STA. 69+38.43 TO STA. 69+84.83

CURRENT ADT TRAFFIC DATA	
2007 ADT	= 400
2027 ADT	= 450
PV + PC %	= 97.9
SU %	= 2.0
MU %	= 0.1

DESIGN DESIGNATION
 N/A

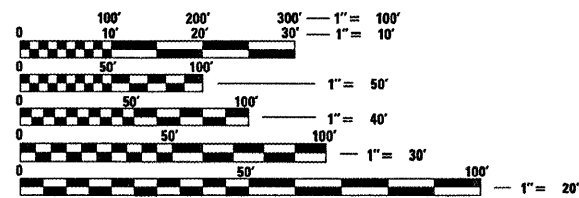

FULL SIZE PLANS HAVE BEEN PREPARED USING STANDARD ENGINEERING SCALES. REDUCED SIZED PLANS WILL NOT CONFORM TO STANDARD SCALES. IN MAKING MEASUREMENTS ON REDUCED PLANS, THE ABOVE SCALES MAY BE USED.

J.U.L.I.E.
 JOINT UTILITY LOCATION INFORMATION FOR EXCAVATION
 1-800-892-0123
 OR 811

PROJECT ENGINEER: KEVIN TRAPP
SQUAD LEADER: JEFF M. SHERER
DESIGNER: JEFF M. SHERER
PHONE: (217)465-4181
CONTRACT NO. 70749

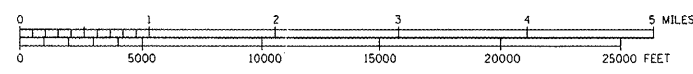
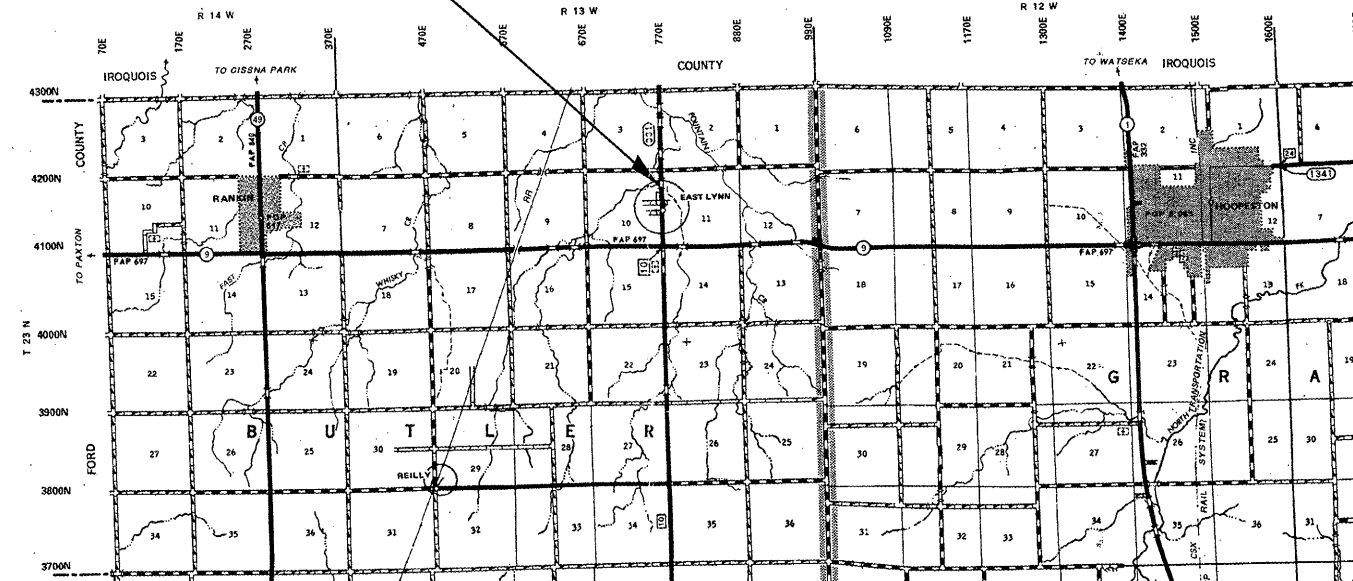

GROSS LENGTH = 46.4 FEET = 0.009 MILES
 NET LENGTH = 46.4 FEET = 0.009 MILES

STATE OF ILLINOIS
 DEPARTMENT OF TRANSPORTATION
 DIVISION OF HIGHWAYS

SUBMITTED 10/16 20 08
Joseph E. Goulet
 DEPUTY DIRECTOR OF HIGHWAYS, REGION THREE ENGINEER
December 5, 20 08
Eric E. Harm
 INTERIM ENGINEER OF DESIGN AND ENVIRONMENT
December 5, 20 08
Christine M. Reed
 DIRECTOR OF HIGHWAYS, CHIEF ENGINEER

PRINTED BY THE AUTHORITY
OF THE STATE OF ILLINOIS

PLOT DATE = 10/16/2008
 FILE NAME = c:\p\projects\052749\cadd\sheet\052749-akt-cover.dgn
 PLOT SCALE = 1/8"=1'-0"
 USER NAME = jshorer