

TRAFFIC SIGNAL QUANTITIES

LOCATION: 3RD & MAINE

QUANTITY	UNIT	ITEM
4.0	FOOT	CONDUIT IN TRENCH, 2" DIA., PVC
4.0	FOOT	TRENCH AND BACKFILL FOR ELECTRICAL WORK
12.0	FOOT	ELECTRIC CABLE IN CONDUIT, SIGNAL, NO. 14, 5/C
1	EACH	STEEL MAST ARM ASSEMBLY AND POLE, 28 FT.
10.0	FOOT	CONCRETE FOUNDATION, TYPE E, 30" DIA.
1	EACH	DRILL EXISTING HANDHOLE
2	EACH	SIGNAL HEAD, POLYCARBONATE, LED, 1-FACE, 3-SECTION, MAST ARM MOUNTED
1	EACH	SIGNAL HEAD, POLYCARBONATE, LED, 2-FACE, 3-SECTION, BRACKET MOUNTED
1	EACH	SIGNAL HEAD, POLYCARBONATE, LED, 3-FACE, 2-3 SECTION, 1-5 SECTION, BRACKET MOUNTED
2	EACH	PEDESTRIAN SIGNAL HEAD, POLYCARBONATE, LED, 2-FACE, BRACKET MOUNTED
3	EACH	TRAFFIC SIGNAL BACKPLATE
8	EACH	PEDESTRIAN PUSHBUTTON
73.0	FOOT	REMOVE AND REINSTALL ELECTRIC CABLE FROM CONDUIT
1	EACH	REMOVE EXISTING TRAFFIC SIGNAL EQUIPMENT
1	EACH	REMOVE EXISTING CONCRETE FOUNDATION
343.5	FOOT	ELECTRIC CABLE IN CONDUIT, GROUND, NO. 6 1/C (GREEN)
2	EACH	REBUILD EXISTING HANDHOLE

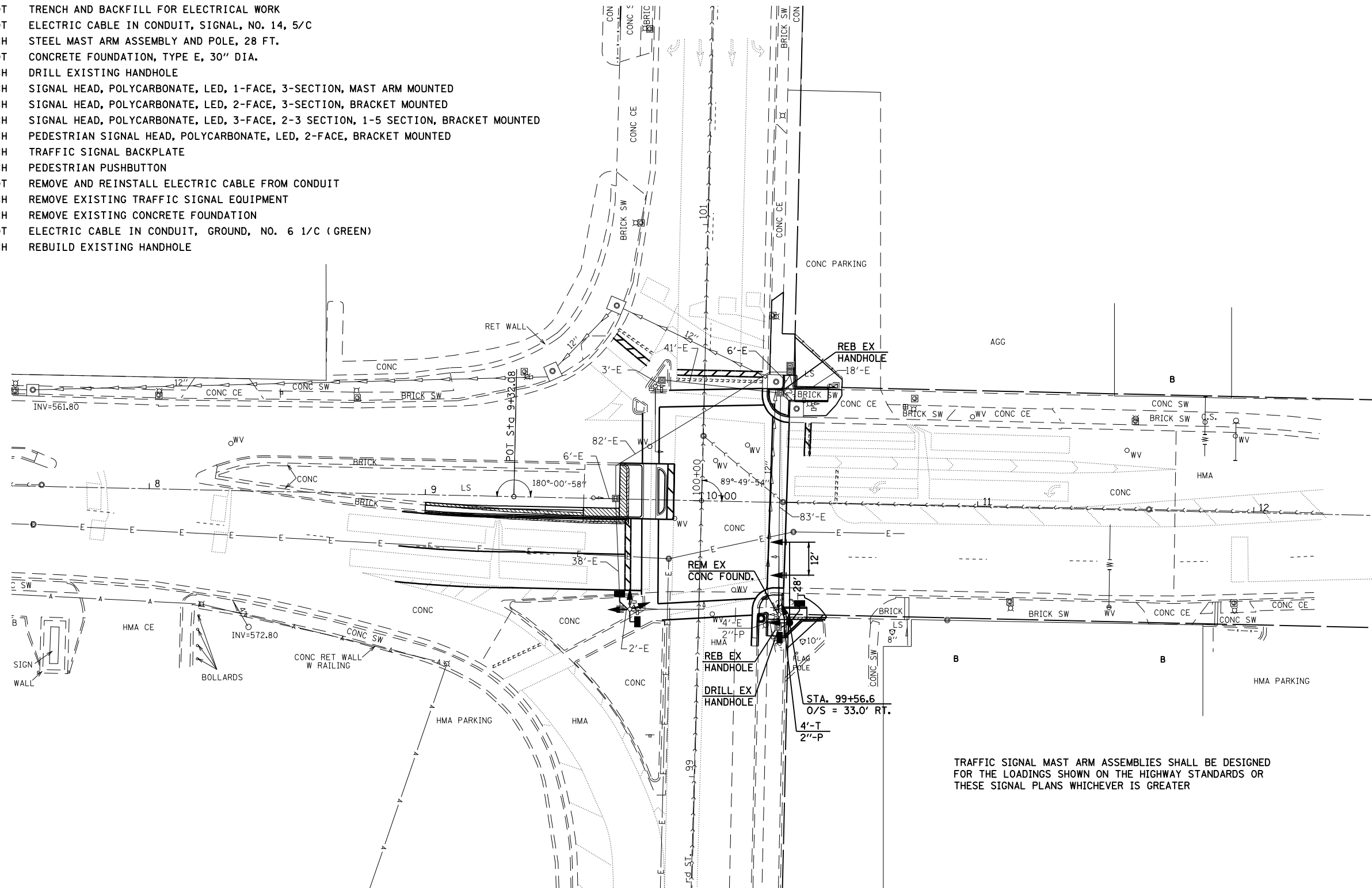

TRAFFIC SIGNAL MAST ARM ASSEMBLIES SHALL BE DESIGNED FOR THE LOADINGS SHOWN ON THE HIGHWAY STANDARDS OR THESE SIGNAL PLANS WHICHEVER IS GREATER

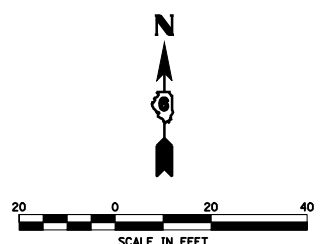

FILE NAME =	USER NAME = laughlinr1	DESIGNED -	REVISED -	STATE OF ILLINOIS DEPARTMENT OF TRANSPORTATION	TRAFFIC SIGNAL DETAILS			F.A.P. RTE.	SECTION	COUNTY	TOTAL SHEETS	SHEET NO.
et:\pw\work\PWIDOT\LAUGHLINRL\dms20392\esignal.dgn		DRAWN -	REVISED -		63	78-2(TS-2,N,T,I)	ADAMS	16	14			
PLOT SCALE = 40.0000' / IN.		CHECKED -	REVISED -		CONTRACT NO. 72B72							
PLOT DATE = Oct-10-2008 09:54:16AM		DATE -	REVISED -		FED. ROAD DIST. NO.	ILLINOIS	FED. AID PROJECT					
				SCALE:	SHEET NO.	OF SHEETS	STA.	TO STA.				