

STATE OF ILLINOIS  
DEPARTMENT OF TRANSPORTATION

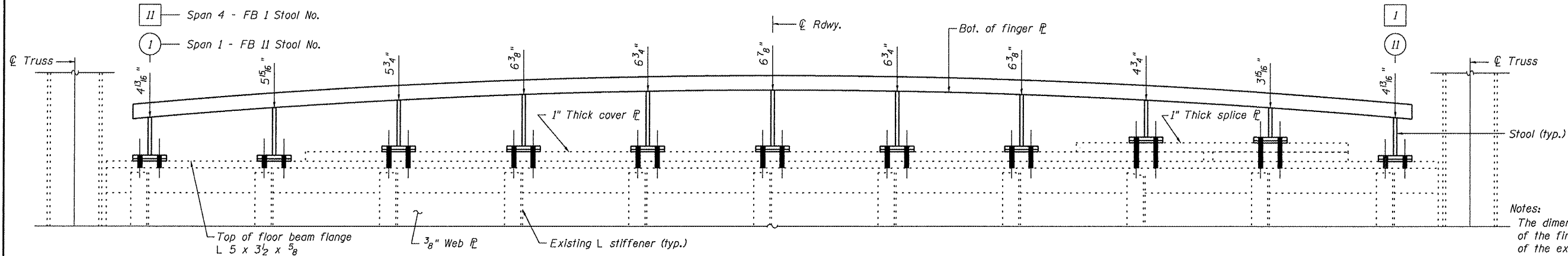

**PARTIAL FLOOR BEAM ELEVATION**

(Span 1 - FB 11: Looking East)  
(Span 4 - FB 1: Looking West)

Notes:  
The dimensions shown are from the bottom of the finger flange to the top most steel element of the exist. floor beam (flange L, cover flange, or splice plate) at the subject stool location.

Curb assembly and exist. stringers omitted from the elevation views for clarity.

Work this sheet with sheet 4 and 6 of 25.

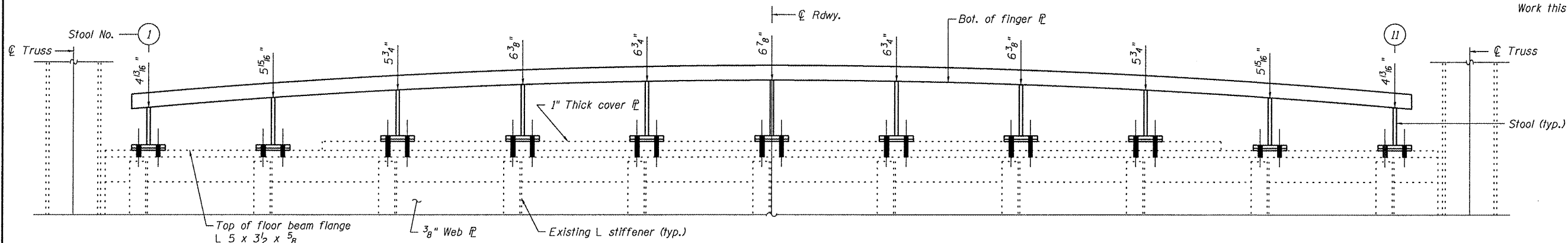

**PARTIAL FLOOR BEAM ELEVATION**

(Looking East)  
(Span 2 - FB 1)  
(Span 3 - FB 11)

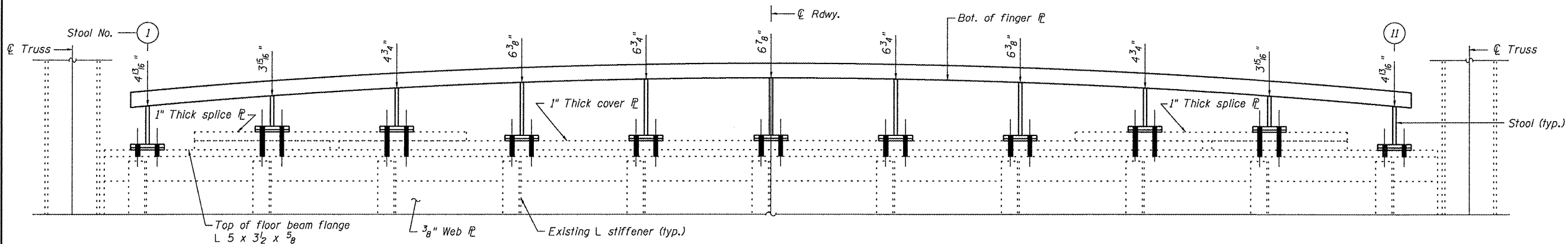

**PARTIAL FLOOR BEAM ELEVATION**

(Looking East)  
(Span 6 - FB 11)  
(Span 7 - FB 1)  
(Span 8 - FB 11)  
(Span 9 - FB 11)

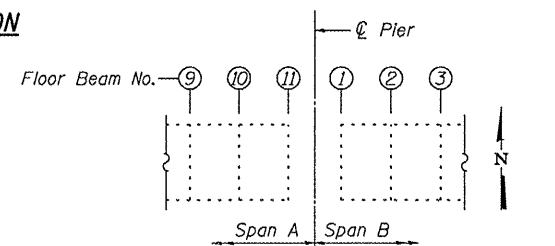

**PARTIAL TRUSS FLOOR BEAM PLAN**

**EXPANSION JOINT DETAILS**  
**ILLINOIS ROUTES 100 & 106 OVER**  
**ILLINOIS RIVER**  
**PUBLIC WATERS**

DESIGNED - CEH
CHECKED - SDS
DRAWN - DLH
CHECKED - CEH, SDS

**WHKS & CO.**  
ENGINEERING  
7018 KINGSMILL CT.,  
SPRINGFIELD, IL  
(217) 483-9457  
DESIGN FIRM #184001036

SHEET NO. 5 OF 25 SHEETS	F.A.P. RTE. 757	SECTION 20BR-2	COUNTY SCOTT/PIKE	TOTAL SHEETS 30	SHEET NO. 10
	SN 086-0001		CONTRACT NO. 72C39		
	FED. ROAD DIST. NO. - ILLINOIS FED. AID PROJECT				