

STATE OF ILLINOIS
DEPARTMENT OF TRANSPORTATION

ROUTE NO.	SECTION	COUNTY	SHEETS	SHEET NO.
FAP 824	*	COLES	5239	9
FED. ROAD DIST. NO.	ILLINOIS	FED. AID PROJECT		
		(16-2, 19X-2)RS-1, 19B, 19BR	Contract #74157	

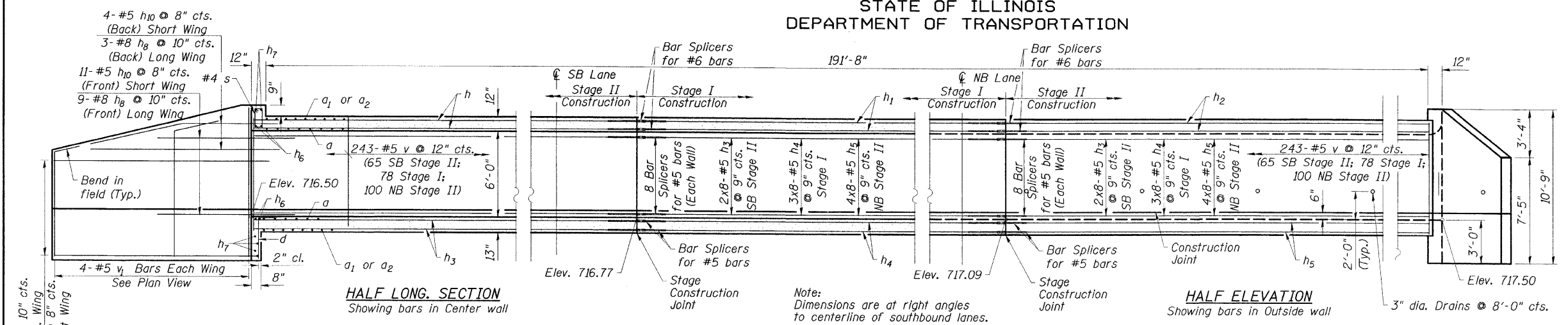

Note:
Place a, a₁, & a₂ bars on 37 degree skew unless noted otherwise.

MIN. BAR LAP

#5	1'-8"
#6	2'-0"

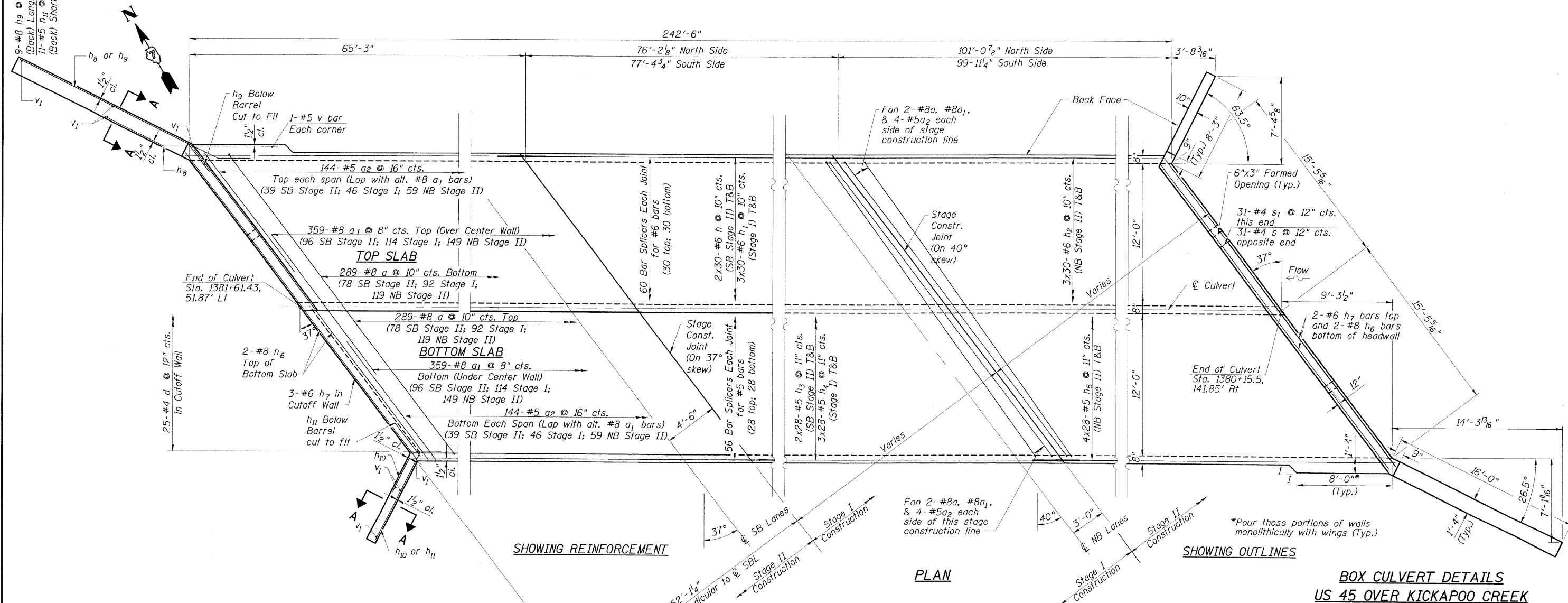

*Pour these portions of walls monolithically with wings (Typ.)

ESCA
CONSULTANTS, INC.

DESIGNED BY:	DAJ	07/08
DRAWN BY:	HAS	07/08
CHECKED BY:	ELH	07/08
APPROVED BY:	RDP	07/08

BOX CULVERT DETAILS
US 45 OVER KICKAPOO CREEK
FAP ROUTE 824
SECTION (16-2, 19X-2)RS-1, 19B, 19BR
COLES COUNTY
STATION 1381+22.50
STRUCTURE NO. 015-2023