

BM 0026: CHISELED "□" ON N.W. WINGWALL OF STRUCTURE 003-0026. STATION ± 2047+17 LEFT ELEV 496.90
 BM 0051: IDOT DISC (NOT STAMPED) ON S.E. WINGWALL OF SN 003-0051. ELEV 497.27

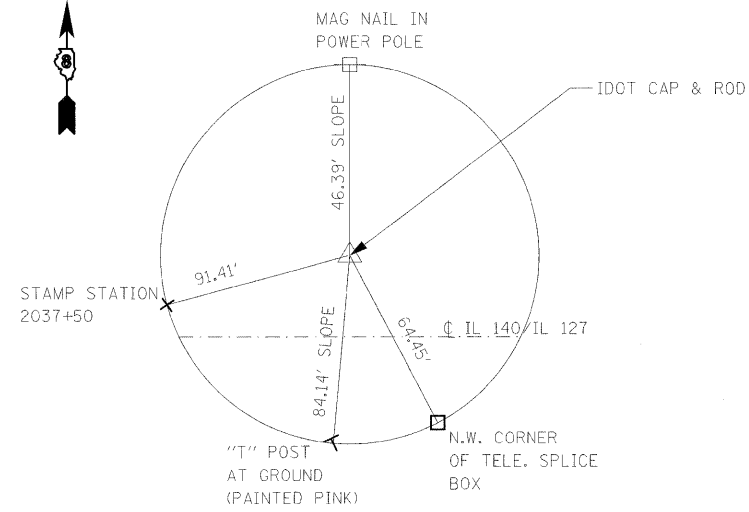

CONTROL POINT #1

STATION 2038+36.9
 OFFSET 16.6' LEFT
 N. 13311.1050 E. 505641.3870

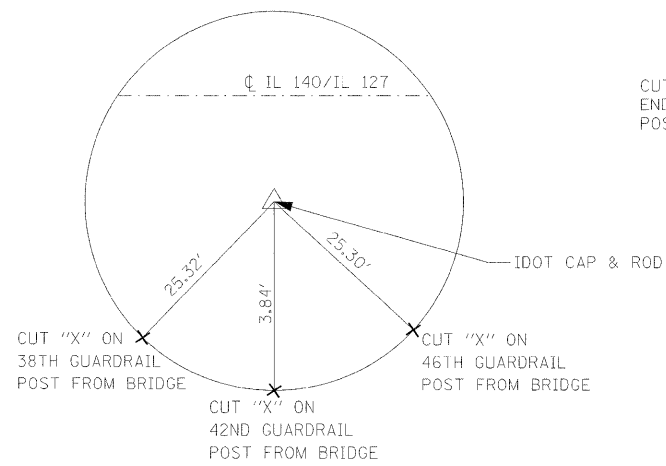

CONTROL POINT #2

STATION 2051+81.1
 OFFSET 16.3' RIGHT
 N. 13299.8000 E. 506985.9670

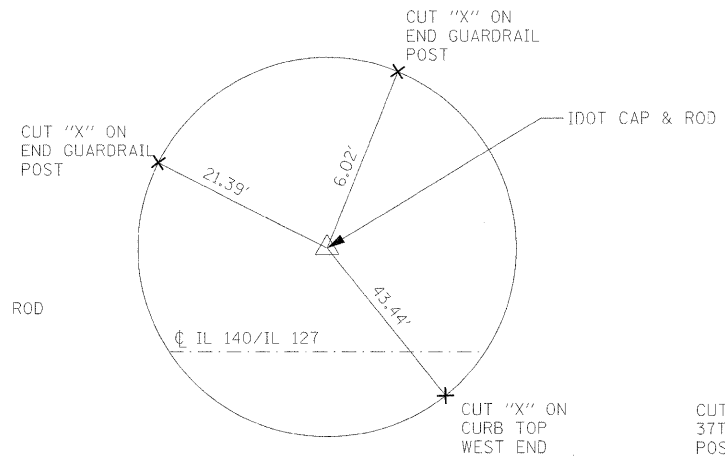

CONTROL POINT #3

STATION 2060+80.6
 OFFSET 19.5' LEFT
 N. 13350.0380 E. 507884.7830

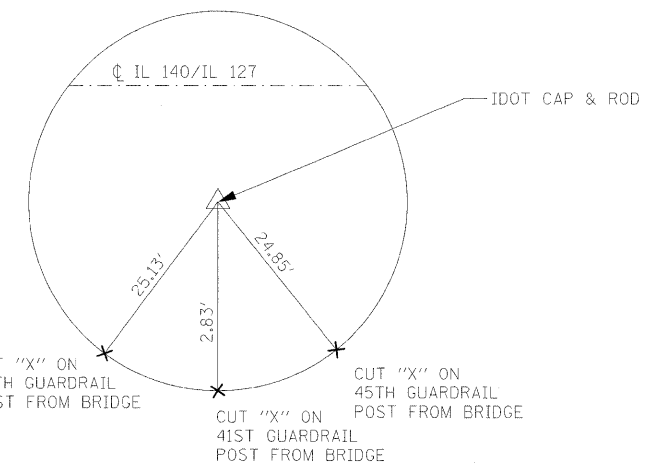

CONTROL POINT #4

STATION 2066+19.1
 OFFSET 17.2' RIGHT
 N. 13321.9460 E. 508423.6790

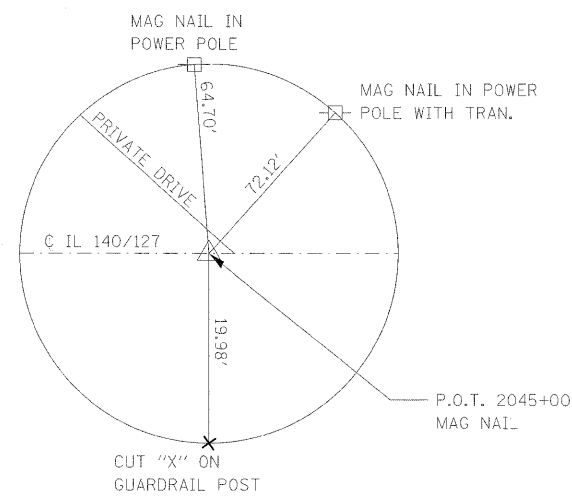

TIE POINT #1

P.O.T. 2045+00
 NOTE: POINT IS 433.51' WEST OF
 CENTER OF SN. 003-0026
 N. 13305.1897 E. 506304.6557

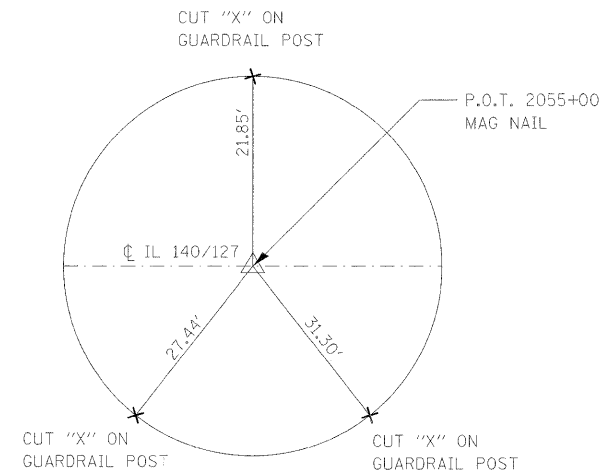

TIE POINT #2

P.O.T. 2055+00
 NOTE: POINT IS 566.49 EAST OF
 CENTER OF SN. 003-0026
 N. 13321.2364 E. 507304.5270

NOTE: ALL TIES ARE PULLED DIRECT

FILE NAME =	USER NAME = challandeske	DESIGNED -	REVISED -	STATE OF ILLINOIS DEPARTMENT OF TRANSPORTATION	TIE POINTS, CONTROL POINTS, AND BENCHMARKS				F.A.P. RTE.	SECTION	COUNTY	TOTAL SHEETS	SHEET NO.
ca:\pwwork\psidot\challandeske\dms51755	pln097a.dgn	DRAWN -	REVISED -						42	139BR	BOND	59	10
PLOT SCALE = 50.00' / IN.	CHECKED -	REVISED -	REVISED -		CONTRACT NO. 76391								
PLOT DATE = 10/23/2008	DATE -	REVISED -	REVISED -		SCALE:	SHEET NO. OF SHEETS	STA.	TO STA.	FED. ROAD DIST. NO.	ILLINOIS FED. AID PROJECT			