

STATE OF ILLINOIS
DEPARTMENT OF TRANSPORTATION
DIVISION OF HIGHWAYS

**PROPOSED
HIGHWAY PLANS**

FAS ROUTE 747 (IL 109)
SECTION (58,59)|
PROJECT:HSIP-0747(103)
JERSEY COUNTY

HMA SHOULDERS WITH RUMBLE STRIPS

C-98-104-08

F.A.S. RTE.	SECTION	COUNTY	TOTAL SHEETS	SHEET NO.
747	(58,59)	JERSEY	9	1
FED. ROAD DIST. NO.	ILLINOIS	CONTRACT NO. 76C30		

FOR INDEX OF SHEETS, SEE SHEET NO. 2

D-98-110-08

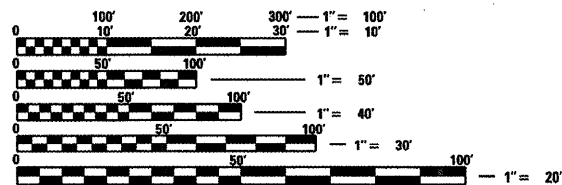

FULL SIZE PLANS HAVE BEEN PREPARED USING STANDARD ENGINEERING SCALES. REDUCED SIZED PLANS WILL NOT CONFORM TO STANDARD SCALES. IN MAKING MEASUREMENTS ON REDUCED PLANS, THE ABOVE SCALES MAY BE USED.

J.U.L.I.E.
JOINT UTILITY LOCATION INFORMATION FOR EXCAVATION
1-800-892-0123
OR 811

PROJECT ENGINEER: PATTI LEBEAU (618) 346-3179
PROJECT MANAGER: CHERYL KEPLAR (618) 346-3186

CONTRACT NO. 76C30

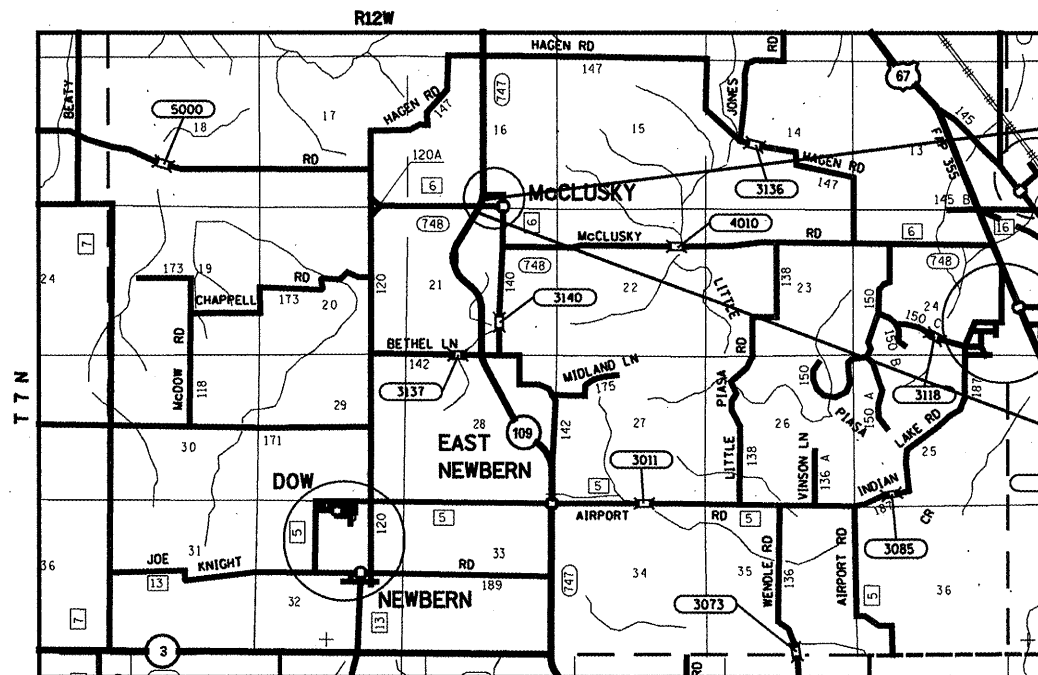

LAYOUT

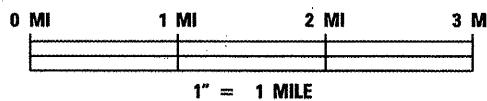

FUNCTIONAL ROADWAY CLASSIFICATION:
MAJOR COLLECTOR (NON-URBAN)

ADT
4950 (2007)
5100 (2009)
5800 (2029)
SU = 2.5%
MU = 2.0%

PROJECT ENDS:
0.2 MI N OF
MC CLUSKY RD.
STA. 197+39.23
LAT: 39.046941
LONG: -90.323209

PROJECT BEGINS:
0.2 MI S OF
MC CLUSKY RD.
STA. 175+00.00
LAT: 39.040836
LONG: -90.325723

GROSS LENGTH: 2239.23 FT (0.42 MILES)
NET LENGTH: 2239.23 FT (0.42 MILES)

STATE OF ILLINOIS
DEPARTMENT OF TRANSPORTATION
DIVISION OF HIGHWAYS

SUBMITTED Oct 16 2008
May C. Harris
DEPUTY DIRECTOR OF HIGHWAYS, REGION 5 ENGINEER

December 5 2008
Eric E. Horn
INTERIM ENGINEER OF DESIGN AND ENVIRONMENT

December 5 2008
Christine M. Reed
DIRECTOR OF HIGHWAYS, CHIEF ENGINEER

PRINTED BY THE AUTHORITY
OF THE STATE OF ILLINOIS

Rev.

SUMMARY OF QUANTITIES

SUMMARY OF QUANTITIES			TOTAL QUANTITIES	CONSTRUCTION TYPE CODE		SUMMARY OF QUANTITIES			TOTAL QUANTITIES	CONSTRUCTION TYPE CODE	
CODE NO	ITEM	UNIT		SFTY-2A 90% FED 10% STATE		CODE NO	ITEM	UNIT			
20200100	EARTH EXCAVATION	CU YD	350	350							
25000210	SEEDING, CLASS 2A	ACRE	0.9	0.9							
44004250	PAVED SHOULDER REMOVAL	SQ YD	482	482							
48102100	AGGREGATE WEDGE SHOULDER, TYPE B	TON	159	159							
48203037	HOT-MIX ASPHALT SHOULDERS, 10"	SQ YD	1425	1425							
64200105	SHOULDER RUMBLE STRIP	FOOT	4275	4275							
67100100	MOBILIZATION	L SUM	1	1							
70100460	TRAFFIC CONTROL AND PROTECTION, STANDARD 701306	L SUM	1	1							
70103815	TRAFFIC CONTROL SURVEILLANCE	CAL DA	5	5							
* 78001110	PAINT PAVEMENT MARKING - LINE 4"	FOOT	4275	4275							
* 78100100	RAISED REFLECTIVE PAVEMENT MARKER	EACH	21	21							
78300100	PAVEMENT MARKING REMOVAL	SQ FT	1425	1425							
70100500	TRAFFIC CONTROL AND PROTECTION, STANDARD 701326	L SUM	1	1							
70300220	TEMPORARY PAVEMENT MARKING - LINE 4"	FOOT	4275	4275							

* specialty items

FILE NAME =	USER NAME = #USER#	DESIGNED -	REVISED -	STATE OF ILLINOIS DEPARTMENT OF TRANSPORTATION	SUMMARY OF QUANTITIES			F.A.S RTE.	SECTION	COUNTY	TOTAL SHEETS	SHEET NO.
#FILE#		DRAWN -	REVISED -		747	(58,59)	JERSEY	9	3			
		CHECKED -	REVISED -		SCALE: SHEET NO. OF SHEETS STA. TO STA.			CONTRACT NO. 76C30				
		PLDT DATE = #DATE#	REVISED -					FED. ROAD DIST. NO. ILLINOIS FED. AID PROJECT				

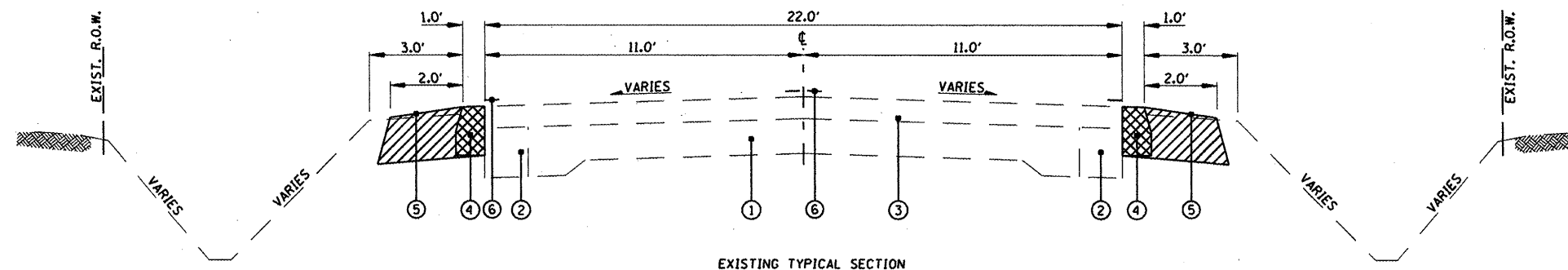

EXISTING TYPICAL SECTION
 STA. 175+00.00 TO STA. 183+95.74
 STA. 192+70.97 TO STA. 197+39.23

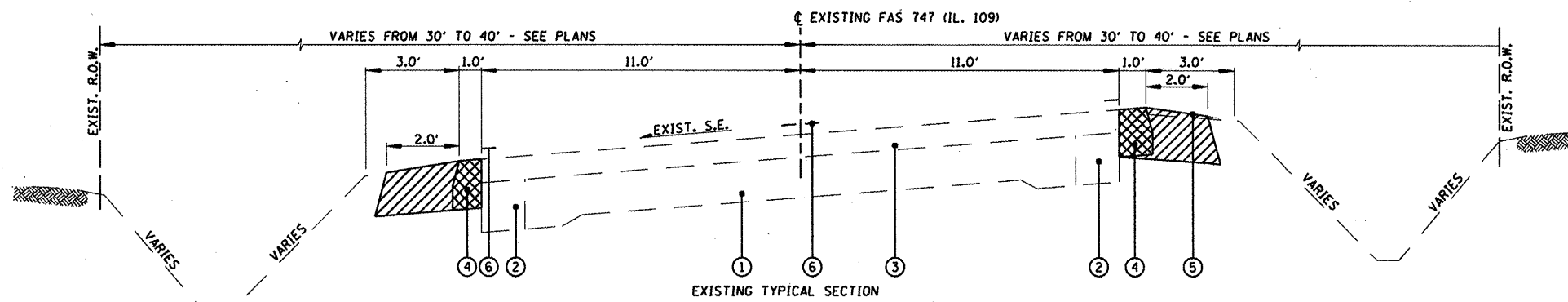

EXISTING TYPICAL SECTION
 STA. 183+95.74 TO STA. 192+70.97

- ① EXISTING P.C. CONCRETE BASE (9'-6"-9")
- ② EXISTING P.C. CONCRETE WIDENING (8")
- ③ EXISTING BITUMINOUS OVERLAY 5 1/4"
- ④ EXISTING BITUMINOUS SHOULDER (10 1/4")
- ⑤ EXISTING AGGREGATE SHOULDER WEDGE TYPE A
- ⑥ EXISTING PAINT PAVEMENT MARKING LINE - 4"
- ⑦ PROPOSED HMA SHOULDER 10"
- ⑧ PROPOSED SHOULDER RUMBLE STRIP
- ⑨ PROPOSED AGGREGATE SHOULDER WEDGE, TYPE B
- ⑩ PROPOSED PAINT PAVEMENT MARKINGS

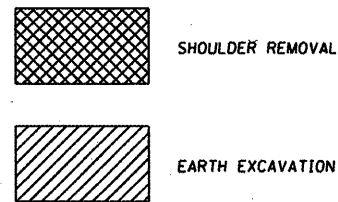

MIXTURE REQUIREMENTS		
MIXTURE USE	SHOULDERS	TOP LIFT SHOULDER
AC/PG	PG 58-22	PG 58-22
RAP % (MAX)	30%	30%
DESIGN AIR VOIDS	2.0% @ Ndes=30	**2.0% @ Ndes=30
MIX COMPOSITION (GRADATION MIXTURE)		
FRICITION AGG	BAM	BAM

** TOP LIFT SHOULDERS - DESIGN THIS MIX AT 2.0% VOIDS AND ADD ASPHALT TO REDUCE VOIDS TO 1.5%.

FILE NAME =	USER NAME = #USER#	DESIGNED -	REVISED -	STATE OF ILLINOIS DEPARTMENT OF TRANSPORTATION	EXISTING TYPICAL SECTIONS			F.A.S. RTE.:	SECTION	COUNTY	TOTAL SHEETS	SHEET NO.
#FILEL#		DRAWN -	REVISED -		747	(58,59)	JERSEY	9	4			
		CHECKED -	REVISED -		SCALE: SHEET NO. OF SHEETS STA. 176+27.23 TO STA. 197+39.23			CONTRACT NO. 76C30				
		DATE -	REVISED -					FED. ROAD DIST. NO. ILLINOIS FED. AID PROJECT				

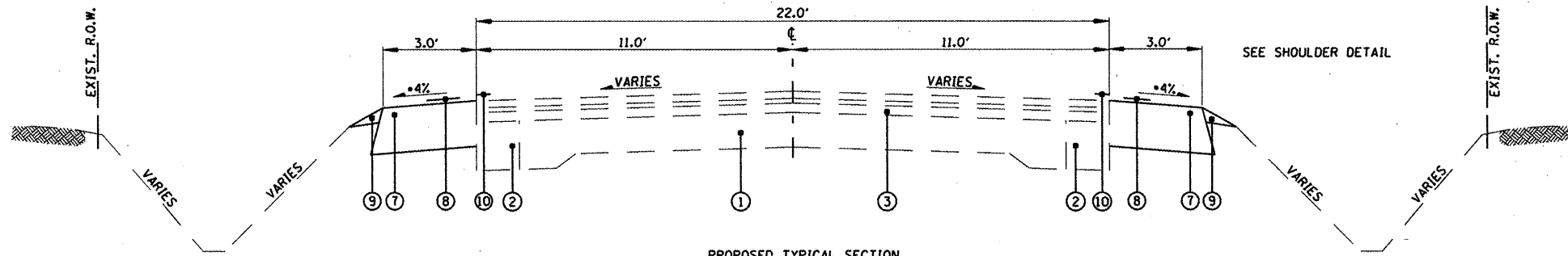

PROPOSED TYPICAL SECTION
 STA. 175+00.00 TO STA. 183+95.74
 STA. 192+70.97 TO STA. 197+39.23

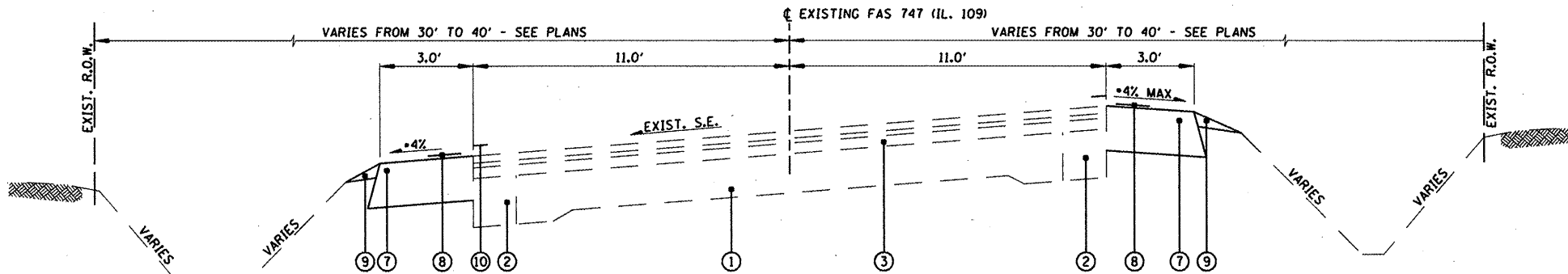

PROPOSED TYPICAL SECTION
 STA. 183+95.74 TO STA. 192+70.97

- ① EXISTING P.C. CONCRETE BASE (9"-6"-9")
- ② EXISTING P.C. CONCRETE WIDENING (8")
- ③ EXISTING BITUMINOUS OVERLAY 5 1/4"
- ④ EXISTING BITUMINOUS SHOULDER (10 1/4")
- ⑤ EXISTING AGGREGATE SHOULDER WEDGE TYPE A
- ⑥ EXISTING PAINT PAVEMENT MARKING LINE - 4"
- ⑦ PROPOSED HMA SHOULDER 10"
- ⑧ PROPOSED SHOULDER RUMBLE STRIP
- ⑨ PROPOSED AGGREGATE SHOULDER WEDGE, TYPE B
- ⑩ PROPOSED PAINT PAVEMENT MARKINGS

MIXTURE REQUIREMENTS		
MIXTURE USE	SHOULDERS	TOP LIFT SHOULDER
AC/PG	PG 58-22	PG 58-22
RAP % (MAX)	30%	30%
DESIGN AIR VOIDS	2.0% @ Ndes=30	**2.0% @ Ndes=30
MIX COMPOSITION (GRADATION MIXTURE)		
FRICITION AGG	BAM	BAM

** TOP LIFT SHOULDERS - DESIGN THIS MIX AT 2.0% VOIDS AND ADD ASPHALT TO REDUCE VOIDS TO 1.5%.

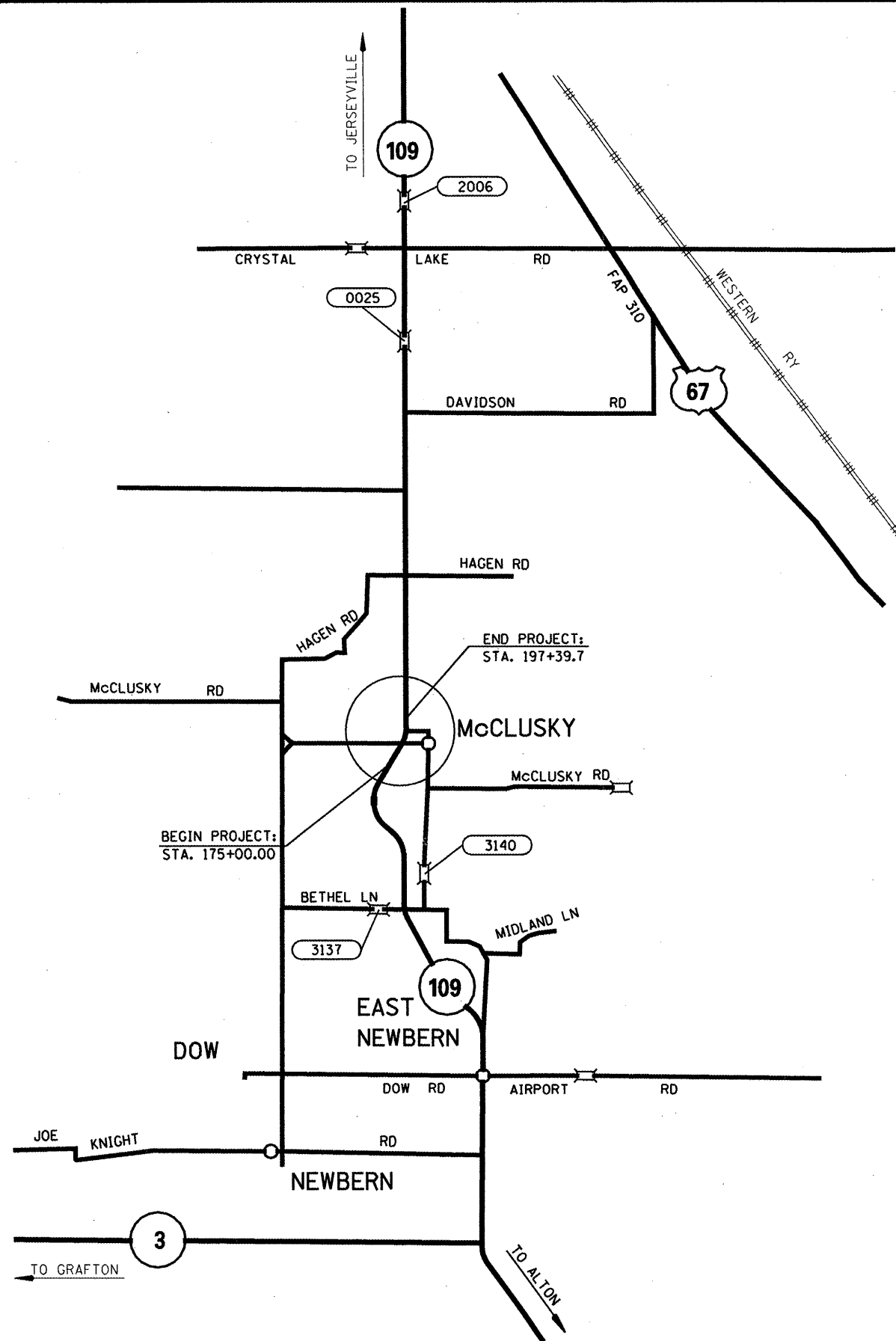

FILE NAME =	USER NAME = #USER#	DESIGNED -	REVISED -
#FILE#		DRAWN -	REVISED -
	PLDT SCALE = #SCALE#	CHECKED -	REVISED -
	PLDT DATE = #DATE#	DATE -	REVISED -

**STATE OF ILLINOIS
DEPARTMENT OF TRANSPORTATION**

ROADWAY LAYOUT			
SCALE:	SHEET NO.	OF SHEETS	STA. TO STA.

F.A.S. RTE.	SECTION	COUNTY	TOTAL SHEETS	SHEET NO.
747	(58.59)	JERSEY	9	6
CONTRACT NO. 76C30				
FED. ROAD DIST. NO. ILLINOIS FED. AID PROJECT				

PAVEMENT MARKING SCHEDULE				
STATION	TO	STATION	L/R	PAINT WHITE LINE 4"
				FOOT
175+00.	TO	186+17.06	L	1117.06
186+17.06	TO	187+27.03	L	OTTERVILLE ROAD
187+27.03	TO	197+39.23	L	1012.2
175+00.	TO	186+37.06	R	1137.06
186+37.06	TO	187+30.56	R	MCCLUSKY ROAD
187+30.56	TO	197+39.23	L	1008.67
TOTAL:				4274.99

(QUANTITY INCLUDED FOR EDGELINE STRIPING ONLY)

SHOULDER SCHEDULE									
STATION	TO	STATION	L/R	LENGTH	RUMBLE STRIP	HMA SHOULDER 10"	PAVED SHOULDER REMOVAL	EARTH EXCAVATION	AGGREGATE SHOULDER WEDGE, TYPE B
				(FOOT)	(FOOT)	(SQYD)	(SQYD)	(CU YD)	(TON)
175+00.00	TO	186+17.06	L	1117.06	1117.06	372.35	124.12	91.40	41.37
186+17.06	TO	187+27.03	L	OTTERVILLE ROAD					
187+27.03	TO	197+39.23	L	1012.20	1012.20	337.40	112.47	82.82	37.49
175+00.00	TO	186+37.06	R	1137.06	1137.06	379.02	126.34	93.03	42.11
186+37.06	TO	187+30.56	R	MCCLUSKY ROAD					
187+30.56	TO	197+39.23	R	1008.67	1008.67	336.22	112.07	82.53	37.36
187+35.00	TO	187+55.00	R	20.00			6.67		
TOTAL:					4275	1425	482	350	159

ANY FILLS ON THE OUTSIDE OF THE SHOULDER WILL BE DONE WITH AGGREGATE WEDGE SHOULDER

FILE NAME =	USER NAME = #USER#	DESIGNED -	REVISED -	STATE OF ILLINOIS DEPARTMENT OF TRANSPORTATION	SCHEDULES			F.A.S. RTE.	SECTION	COUNTY	TOTAL SHEETS	SHEET NO.
#FILE#		DRAWN -	REVISED -					747	(58,591)	JERSEY	9	7
	PLOT SCALE = #SCALE#	CHECKED -	REVISED -		SCALE: SHEET NO. OF SHEETS STA. TO STA.			CONTRACT NO. 76C30				
	PLOT DATE = #DATE#	DATE -	REVISED -		FED. ROAD DIST. NO. [ILLINOIS] FED. AID PROJECT							

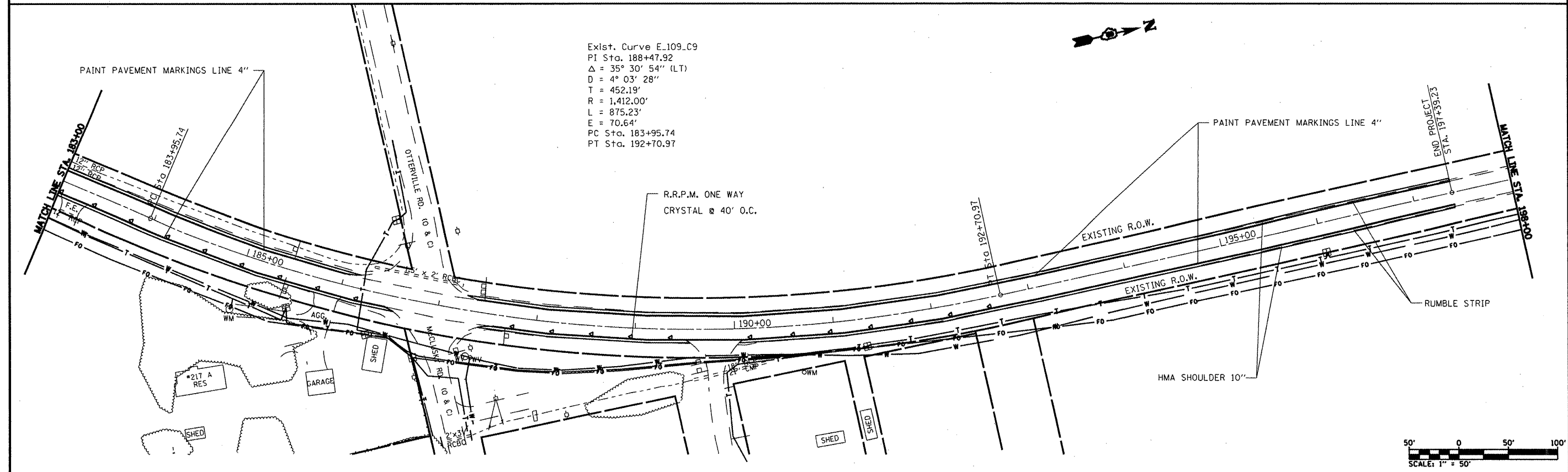
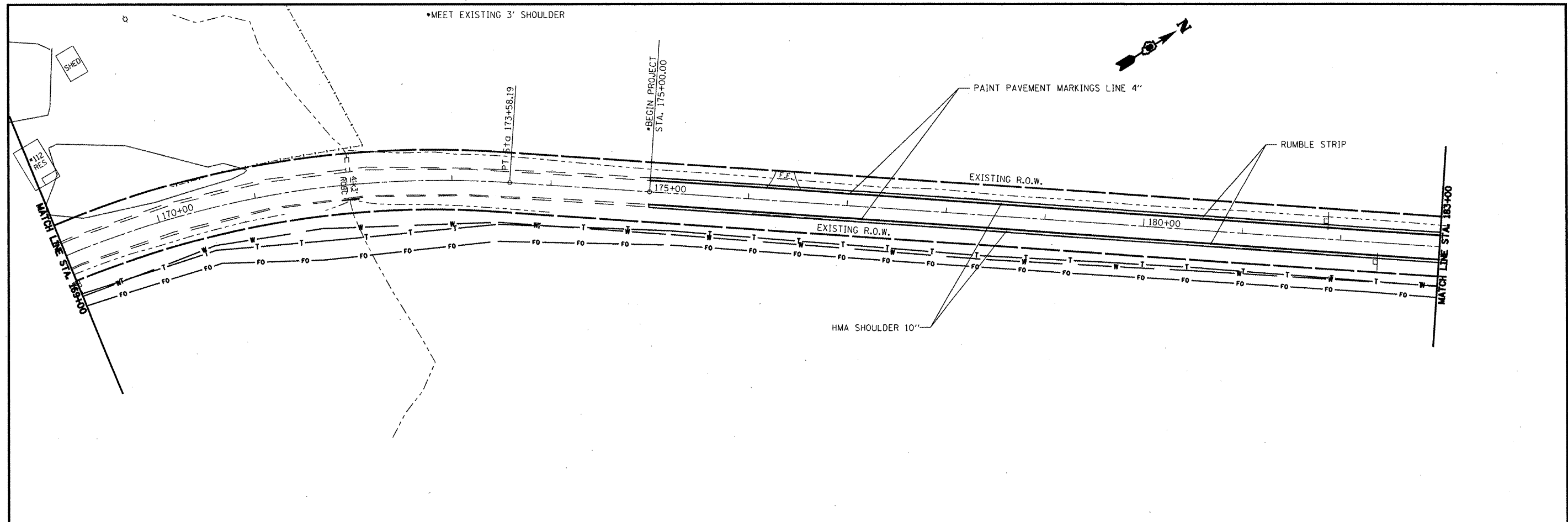

FILE NAME =	USER NAME = #USER#	DESIGNED -	REVISED -	STATE OF ILLINOIS DEPARTMENT OF TRANSPORTATION	PLAN SHEET	F.A.S. RTE.	SECTION	COUNTY	TOTAL SHEETS	SHEET NO.	
#FILE#		DRAWN -	REVISED -			747	(58,591)	JERSEY	9	8	
	PLOT SCALE = #SCALE#	CHECKED -	REVISED -			CONTRACT NO. 76C30					
	PLOT DATE = #DATE#	DATE -	REVISED -			FED. ROAD DIST. NO. [ILLINOIS] FED. AID PROJECT					

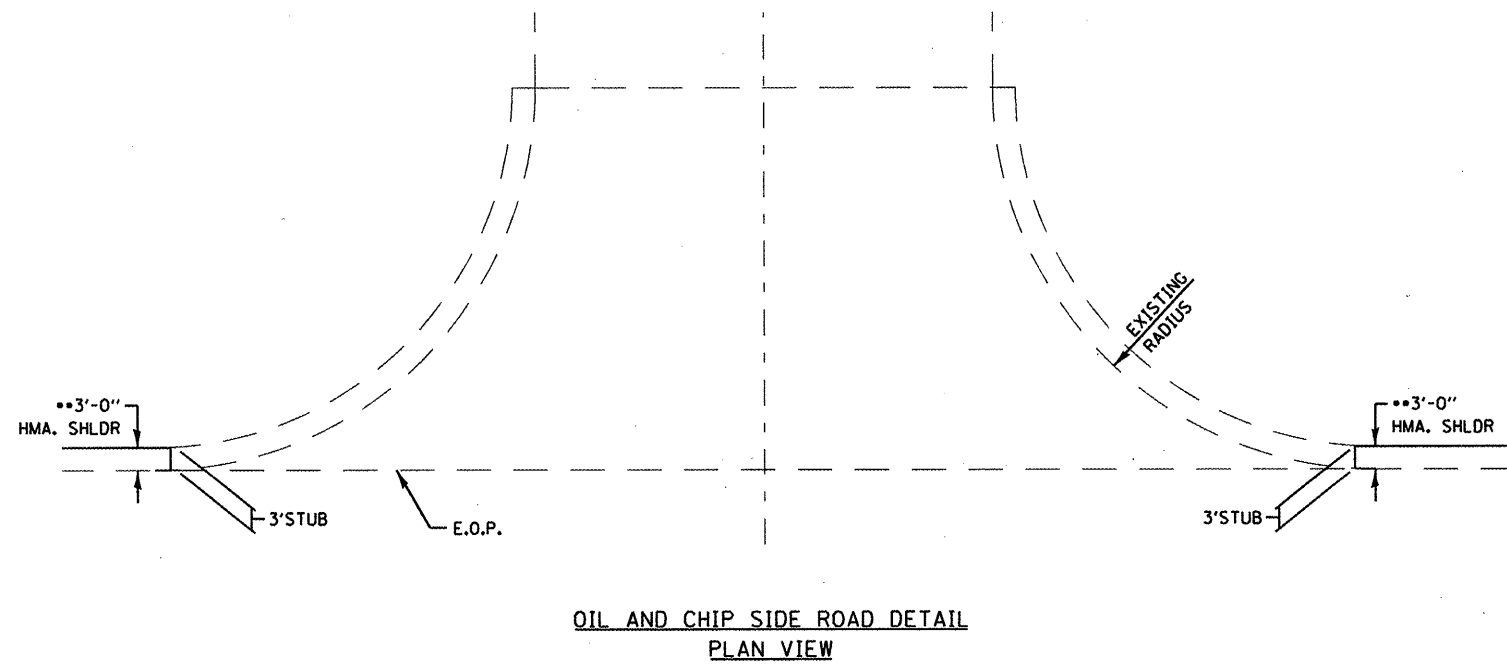

OIL AND CHIP SIDE ROAD DETAIL
PLAN VIEW

••END HMA SHOULDERS AT SIDEROAD RADIUS AS DIRECTED BY RESIDENT ENGINEER

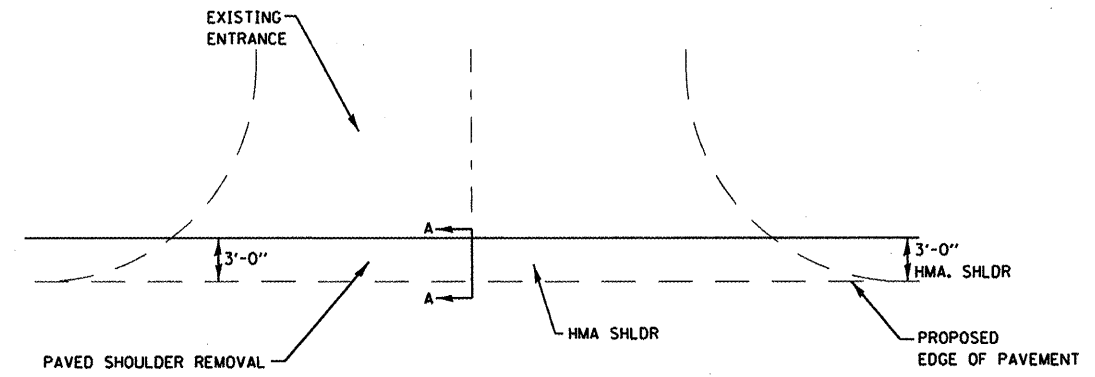

ENTRANCE DETAIL
PLAN VIEW

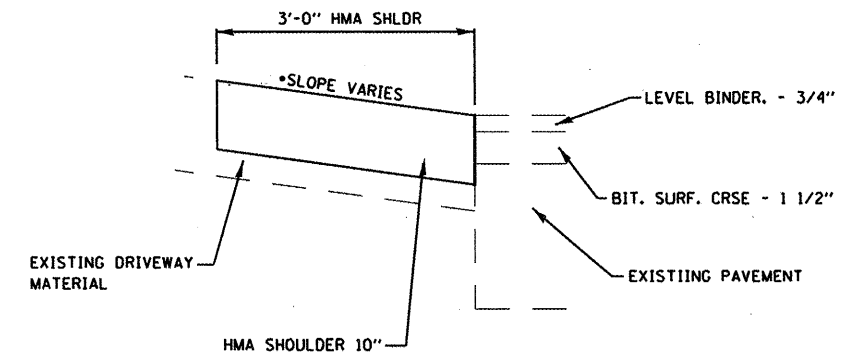

ENTRANCE DETAIL
SECTION A-A W/ POSITIVE SLOPE

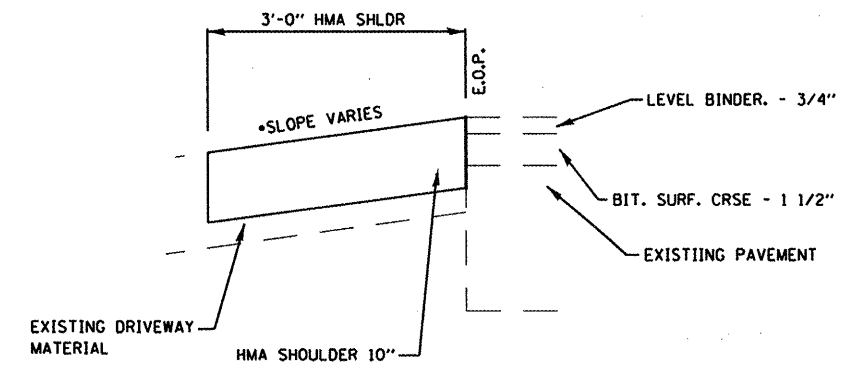

ENTRANCE DETAIL
SECTION A-A W/ NEGATIVE SLOPE

•TIE INTO EXISTING

FILE NAME =	USER NAME = #USER#	DESIGNED -	REVISED -
#FILE#		DRAWN -	REVISED -
	PLOT SCALE = #SCALE#	CHECKED -	REVISED -
	PLOT DATE = #DATE#	DATE -	REVISED -

STATE OF ILLINOIS
DEPARTMENT OF TRANSPORTATION

DETAILS

SCALE: SHEET NO. OF SHEETS STA. TO STA.

F.A.S. RTE.	SECTION	COUNTY	TOTAL SHEETS	SHEET NO.
747	(58,59)	JERSEY	9	9
CONTRACT NO. 76C30				
FED. ROAD DIST. NO. ILLINOIS FED. AID PROJECT				