

STATE OF ILLINOIS  
DEPARTMENT OF TRANSPORTATION  
DIVISION OF HIGHWAYS

**PROPOSED  
INTERSTATE HIGHWAY PLANS**

F.A.I. ROUTE 57 (I-57)  
SECTION 28-(1,1-1,1-2,2,2-1,3,3S)RS-1  
PROJECT: IM-057-2(147)080  
FRANKLIN COUNTY  
C-99-029-08

F.A.I. RTE.	SECTION	COUNTY	TOTAL SHEETS	SHEET NO.
57	28-(1,1-1,1-2,2,2-1,3,3S)RS-1	FRANKLIN	52	1
FED. ROAD DIST. NO.		ILLINOIS CONTRACT NO. 78046		

FOR INDEX OF SHEETS, SEE SHEET NO. 3

**TRAFFIC DATA**

I-57 TRAFFIC DATA  
(NORTHBOUND LANES ONLY)  
2007 ADT = 16,000 WITH 36% TRUCKS  
2008 ADT = 16,400 WITH 36% TRUCKS  
2028 ADT = 26,870 WITH 36% TRUCKS

**TOWNSHIPS**

BROWNING  
BENTON  
EWING

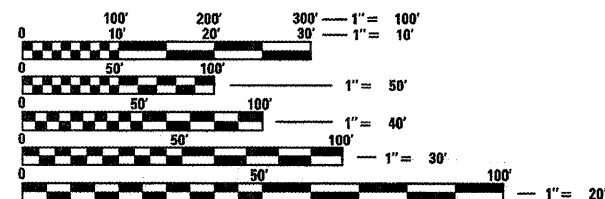
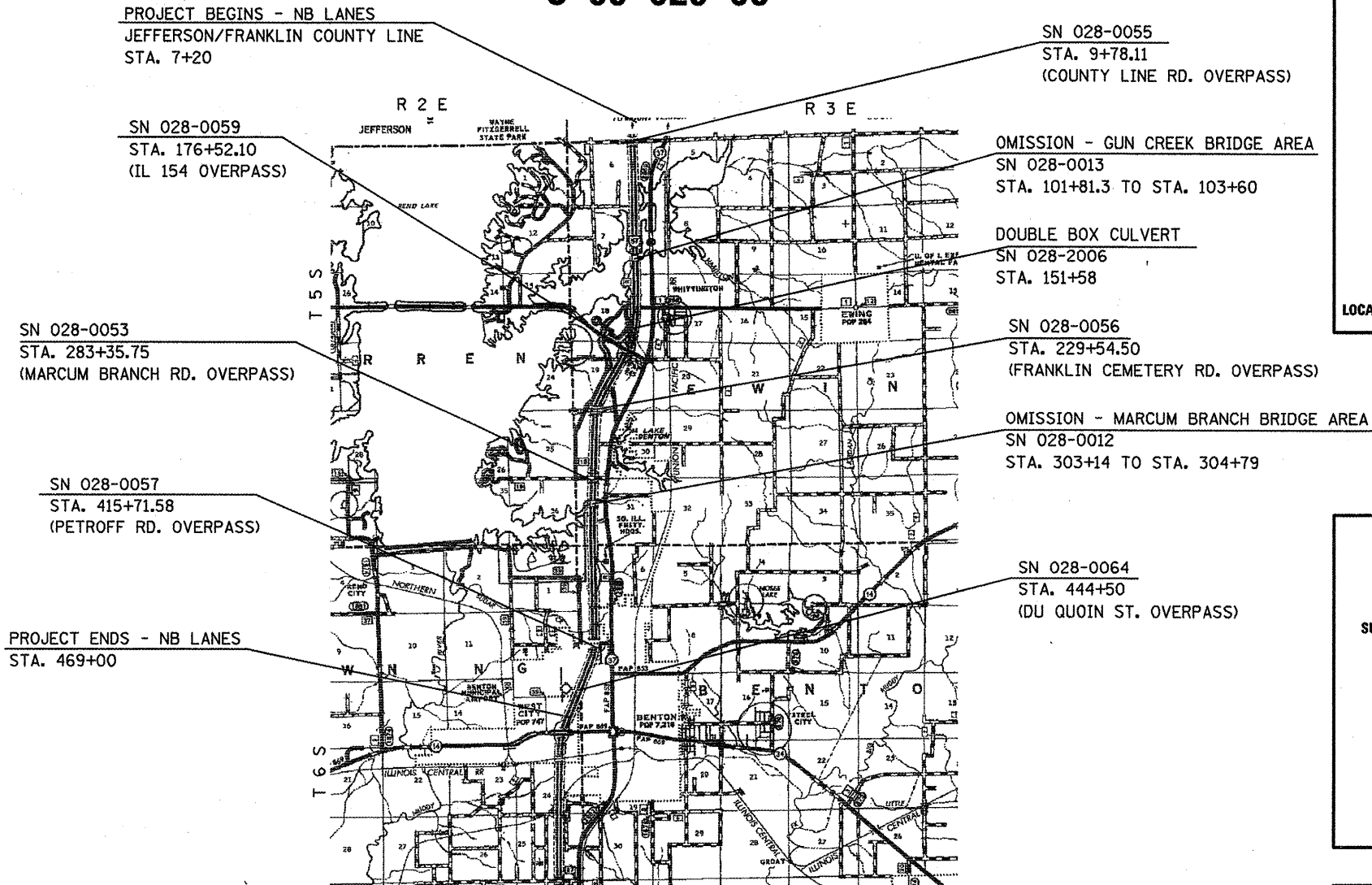
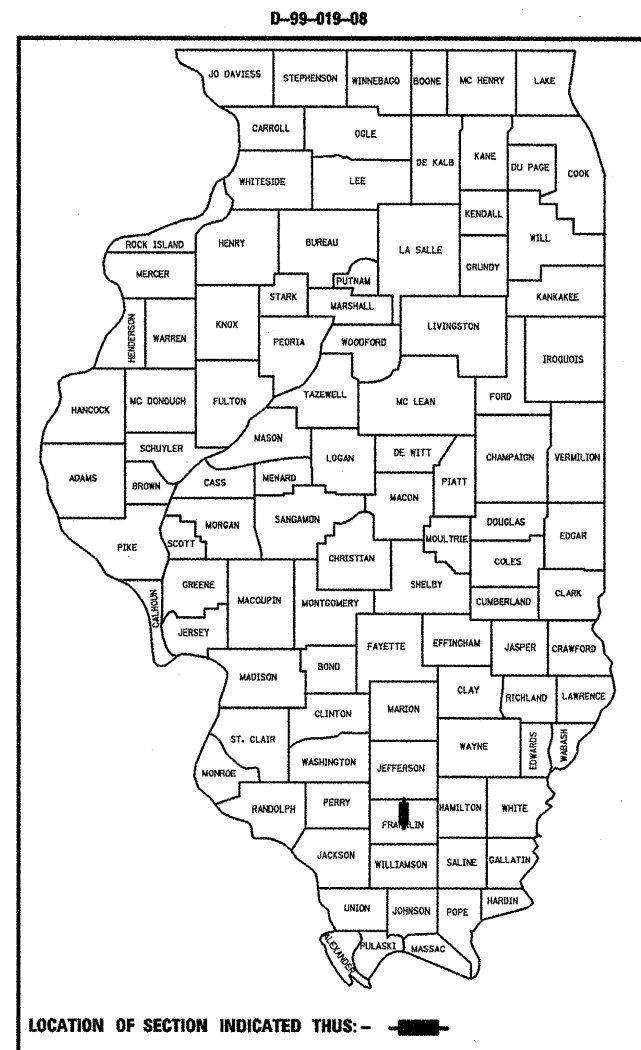

FULL SIZE PLANS HAVE BEEN PREPARED USING STANDARD ENGINEERING SCALES. REDUCED SIZED PLANS WILL NOT CONFORM TO STANDARD SCALES. IN MAKING MEASUREMENTS ON REDUCED PLANS, THE ABOVE SCALES MAY BE USED.

J.U.L.I.E.  
JOINT UTILITY LOCATION INFORMATION FOR EXCAVATION  
1-800-892-0123  
OR 811

PROJECT ENGINEER: CHARLES STEIN  
DESIGNER: MELISSA COLE

CONTRACT NO. 78046

GROSS LENGTH OF PROJECT = 46,180 FT = 8.75 MILES (NB)  
NET LENGTH OF PROJECT = 45,836.3 FT = 8.68 MILES (NB)

STATE OF ILLINOIS  
DEPARTMENT OF TRANSPORTATION  
DIVISION OF HIGHWAYS

SUBMITTED *Oct 14* 20 *08*

*Mary C. Lomic*  
DEPUTY DIRECTOR OF HIGHWAYS, REGION V ENGINEER

*December 5, 2008*  
*Eric E. Horn*  
INTERIM ENGINEER OF DESIGN AND ENVIRONMENT

*December 5, 2008*  
*Christine M. Reed*  
DIRECTOR OF HIGHWAYS, CHIEF ENGINEER

**PRINTED BY THE AUTHORITY  
OF THE STATE OF ILLINOIS**