

FINAL SURVEY	SURVEYED	BY	DATE
NOTE BOOK	TEMPLATE		
NO.	AREAS CHECKED		

ORIGINAL SURVEY	SURVEYED	BY	DATE
NOTE BOOK	TEMPLATE		
NO.	AREAS CHECKED		

PRINTED DATE: 10/6/2008
 P:\Projects\vermilion\com\42+75.0\42+75.0.dgn

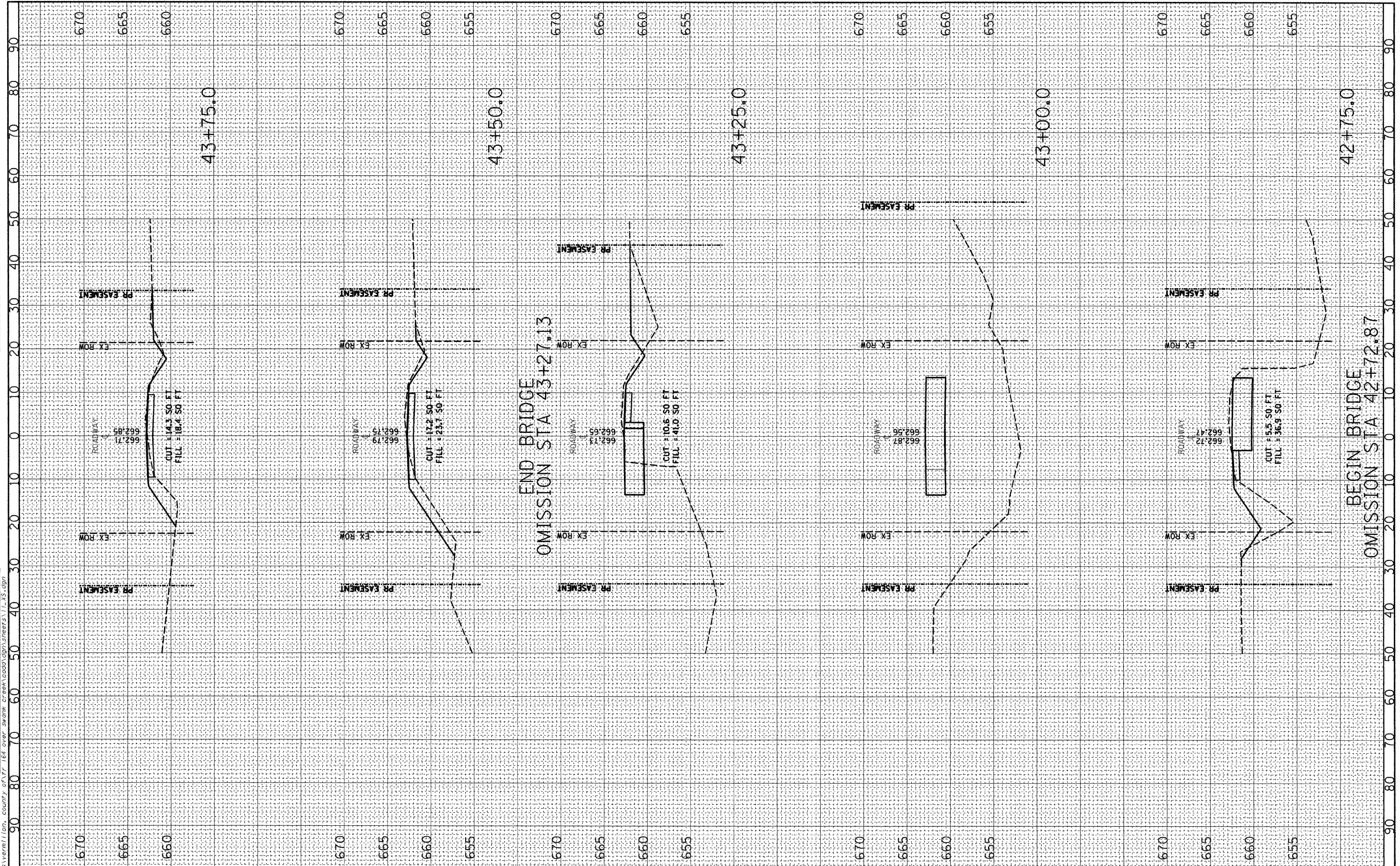

USER NAME = #USER#
 PLOT SCALE = 10.0000' / IN.
 PLOT DATE = 10/6/2008

DESIGNED - ADG
 DRAWN - ADG
 CHECKED - DF
 DATE - 09-29-2008

REVISED -
 REVISED -
 REVISED -
 REVISED -

STATE OF ILLINOIS
 DEPARTMENT OF TRANSPORTATION

CROSS SECTIONS

SCALE: 1"=10' 1"V=5' SHEET NO. 2 OF 3 SHEETS STA. 42+75.0 TO STA. 43+75.0

F.A. RTE.	SECTION	COUNTY	TOTAL SHEETS	SHEET NO.
	01-03131-00-BR	VERMILION	13	12
FED. ROAD DIST. NO. - ILLINOIS FED. AID PROJECT			CONTRACT NO. 91365	