

SEC. 26, T.19N., R.8E., 3rd P.M.
CHAMPAIGN COUNTY, ILLINOIS

F.A.P. RTE.	SECTION	COUNTY	TOTAL SHEETS	SHEET NO.
807	00-00374-01-PV	CHAMPAIGN	242	52
STA. 88+00.00		TO STA. 93+00.00		
ILLINOIS F.A. PROJ. NO. RS-HPP-1805(001)				
CONTRACT NO. 91368				

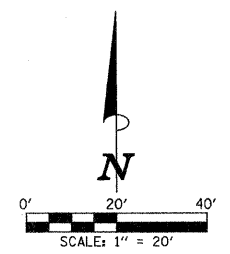

LEGEND

 PROPOSED SODDING FOR DITCH LINING

FURNISHING AND ERECTING RIGHT-OF-WAY MARKERS = 2 EACH
 STA. 90+00.00, 102.49' LT.
 STA. 91+00.00, 97.49' LT.

FOR REMOVAL/RELOCATION PLAN IN THIS AREA SEE SHEET NO'S. 34-35.

SEE SCHEDULE OF QUANTITIES FOR TYPICAL SECTION PAVEMENT PAY ITEMS AND THEIR LOCATIONS.

SEE THE STAGE CONSTRUCTION AND MAINTENANCE OF TRAFFIC PLANS FOR THE VARIOUS STAGES AND CONSTRUCTION SEQUENCES ON CURTIS RD.

BM 114R - TIMBER SPIKE IN POWER POLE ON SOUTH SIDE OF CURTIS RD.
 STA. 91+67, 88' RT.
 ELEV. 740.51

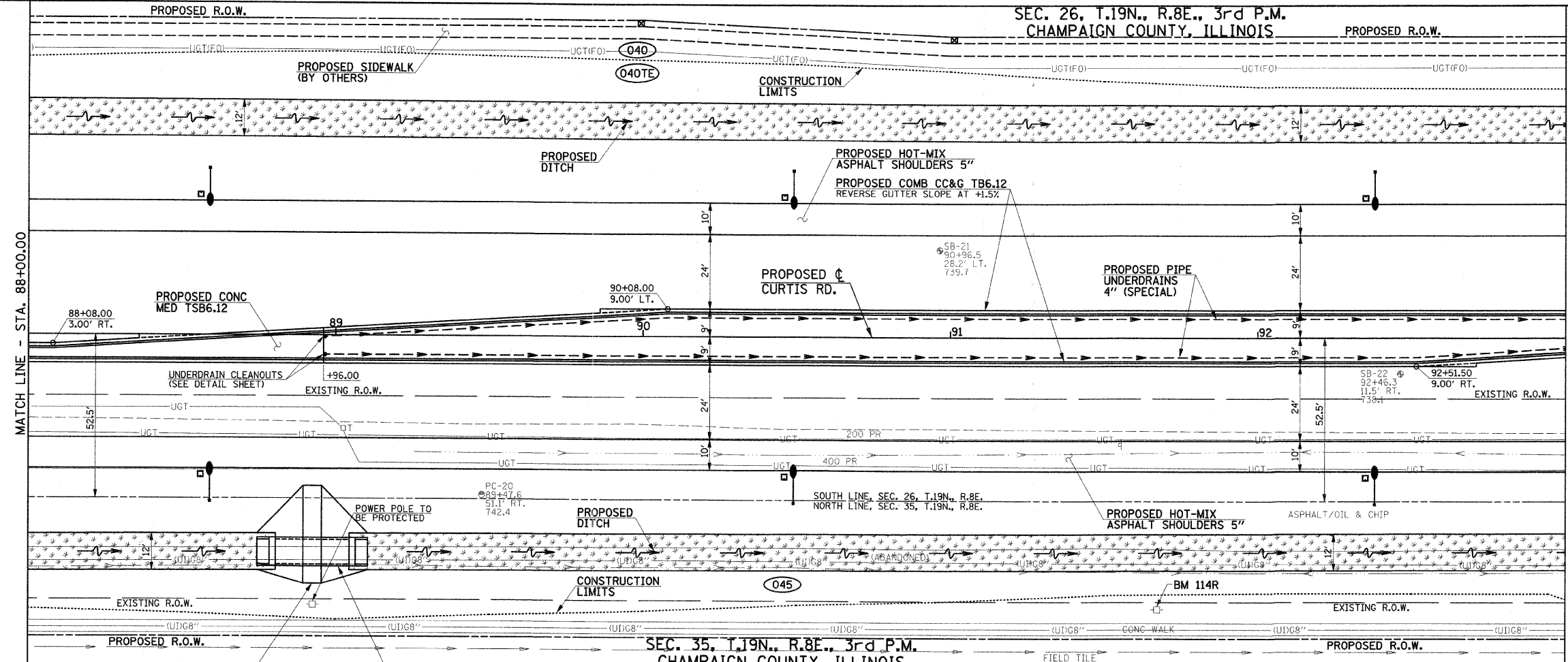

SEC. 35, T.19N., R.8E., 3rd P.M.
CHAMPAIGN COUNTY, ILLINOIS

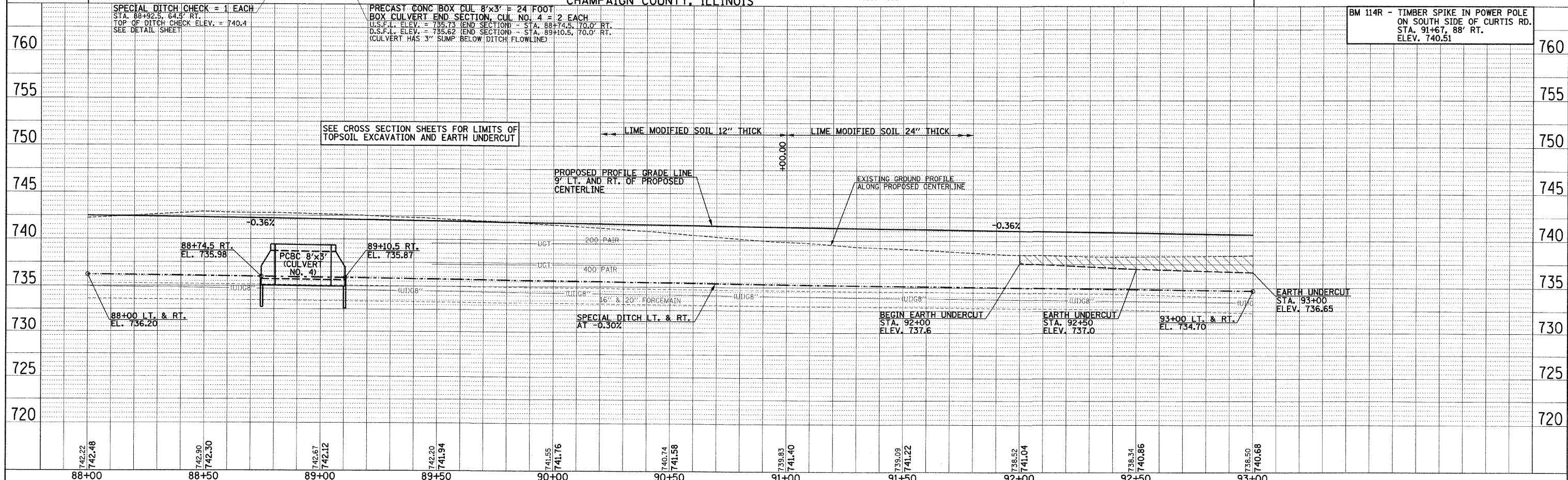

SEE CROSS SECTION SHEETS FOR LIMITS OF TOPSOIL EXCAVATION AND EARTH UNDERCUT

PRECAST CONC BOX CUL. 8'x3' = 24 FOOT BOX CULVERT END SECTION, CUL. NO. 4 = 2 EACH
 U.S.F.L. ELEV. = 785.73 (END SECTION) - STA. 88+74.5, 170.0' RT.
 D.S.F.L. ELEV. = 785.62 (END SECTION) - STA. 89+10.5, 170.0' RT.
 (CULVERT HAS 3\"/>

SPECIAL DITCH CHECK = 1 EACH
 STA. 88+92.5, 64.5' RT.
 TOP OF DITCH CHECK ELEV. = 740.4
 SEE DETAIL SHEET

PLAN	DATE	BY
REVISIONS		
NO.	DATE	BY
1		
2		
3		
4		
5		
6		
7		
8		
9		
10		

PROFILE	DATE	BY
REVISIONS		
NO.	DATE	BY
1		
2		
3		
4		
5		
6		
7		
8		
9		
10		