

SEC. 34, T.19N., R.8E., 3rd P.M.
CHAMPAIGN COUNTY, ILLINOIS

F.A.P. RTE.	SECTION	COUNTY	TOTAL SHEETS	SHEET NO.
807	00-00374-01-PV	CHAMPAIGN	242	67
STA. 488+00.00		TO STA. 491+40.00		
ILLINOIS F.A. PROJ. NO. RS-HPP-1805(00D)				
CONTRACT NO. 91368				

FURNISHING AND ERECTING RIGHT-OF-WAY MARKERS = 1 EACH
STA. 491+00.00, 70.00' LT.

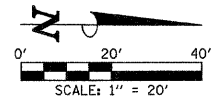

LEGEND

- [1] - PROPOSED PORTLAND CEMENT CONCRETE PAVEMENT 8" (JOINTED)
- [] - PROPOSED SODDING FOR DITCH LINING

FOR REMOVAL/RELOCATION PLAN IN THIS AREA SEE SHEET NO'S. 34 & 42.

SEE SCHEDULE OF QUANTITIES FOR TYPICAL SECTION PAVEMENT PAY ITEMS AND THEIR LOCATIONS.

SEE THE STAGE CONSTRUCTION AND MAINTENANCE OF TRAFFIC PLANS FOR THE VARIOUS STAGES AND CONSTRUCTION SEQUENCES ON MATTIS AVE.

SEC. 35, T.19N., R.8E., 3rd P.M.
CHAMPAIGN COUNTY, ILLINOIS

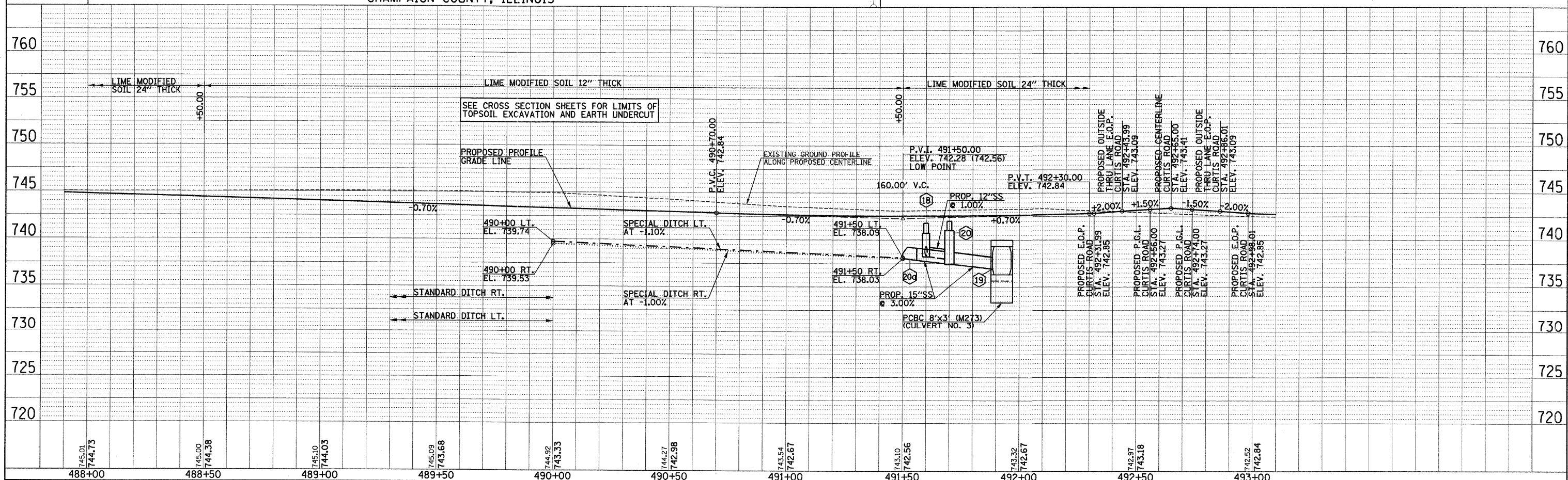

PLAN	DATE	BY

PROFILE	DATE	BY

p:\c01401\plans\sheet\mattispp.dgn
10/2/2008 9:07:54 AM