

SEC. 26, T.19N., R.8E., 3rd P.M.
CHAMPAIGN COUNTY, ILLINOIS

F.A.P. RTE.	SECTION	COUNTY	TOTAL SHEETS	SHEET NO.
807	00-00374-01-PV	CHAMPAIGN	242	71
STA. 661+00.00		TO STA. 666+00.00		
ILLINOIS F.A. PROJ. NO. RS-HPP-1805(001)				
CONTRACT NO. 91368				

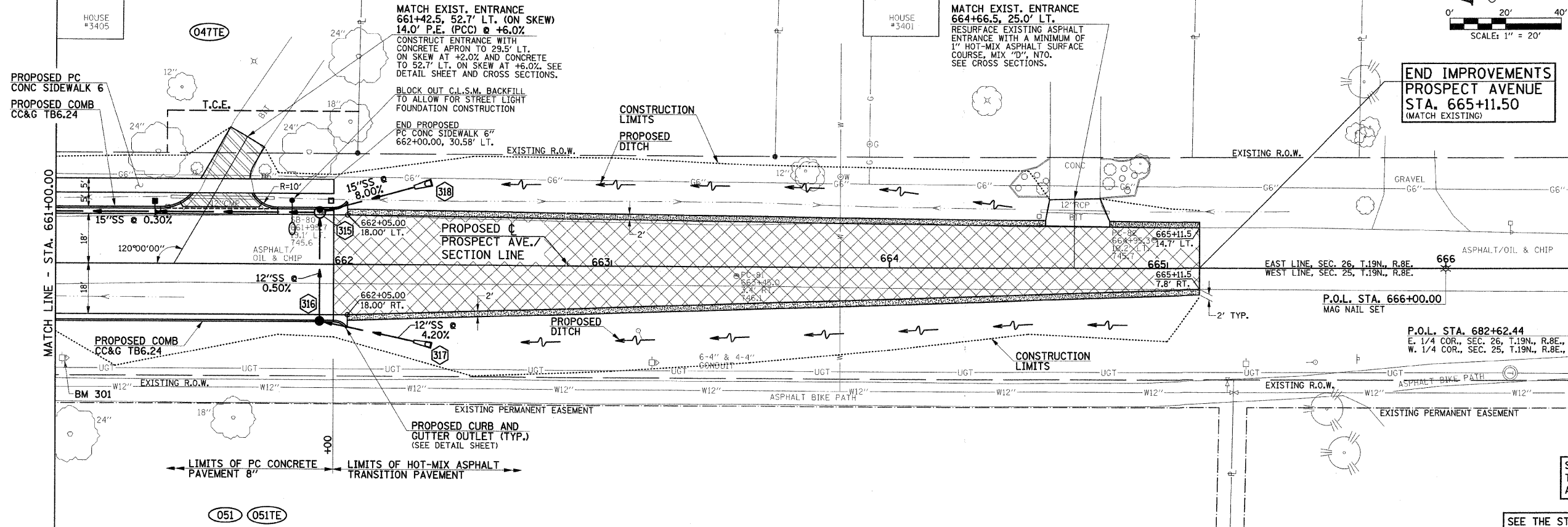
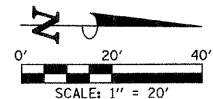

- LEGEND**
- PROPOSED TRANSITION PAVEMENT HOT-MIX ASPHALT SURFACE COURSE, MIX "D", N70 (2" THICK) OVER HOT-MIX ASPHALT BINDER COURSE, IL-19.0, N70 (3" THICK)
 - PROPOSED PCC DRIVEWAY PAVEMENT (6" FOR P.E. - 8" FOR C.E.)
 - PROPOSED AGGREGATE SHOULDERS, TYPE B 5'

FOR REMOVAL/RELOCATION PLAN IN THIS AREA SEE SHEET NO. 45

SEE SCHEDULE OF QUANTITIES FOR TYPICAL SECTION PAVEMENT PAY ITEMS AND THEIR LOCATIONS.

SEE THE STAGE CONSTRUCTION AND MAINTENANCE OF TRAFFIC PLANS FOR THE VARIOUS STAGES AND CONSTRUCTION SEQUENCES ON PROSPECT AVE.

SEC. 25, T.19N., R.8E., 3rd P.M.
CHAMPAIGN COUNTY, ILLINOIS

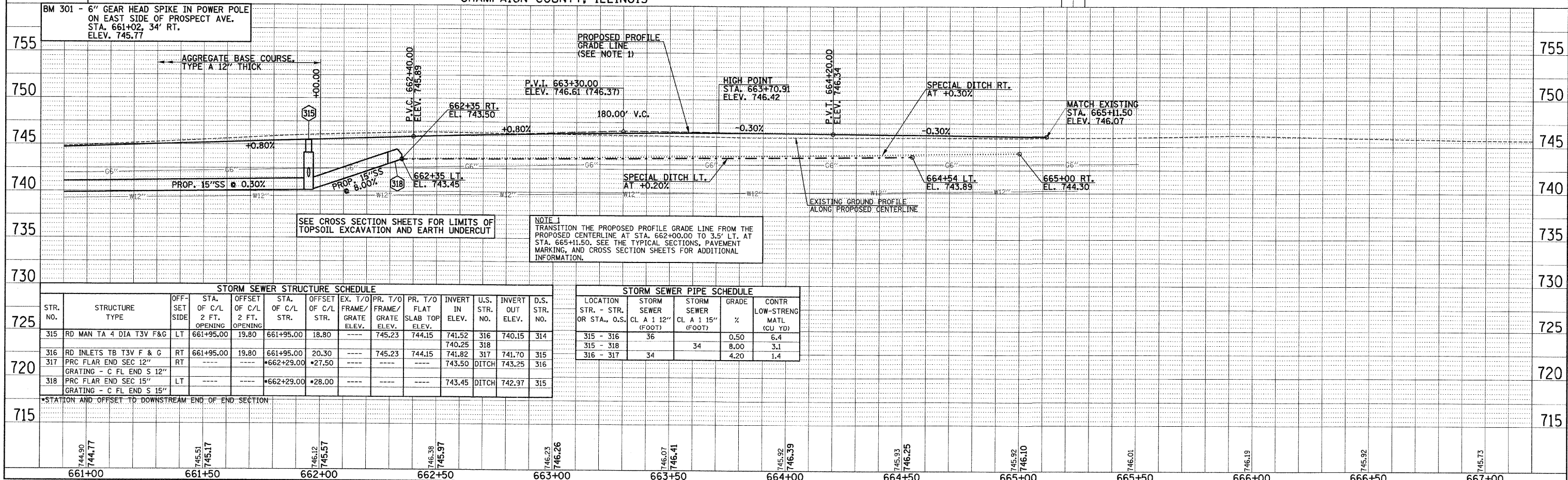

SEE CROSS SECTION SHEETS FOR LIMITS OF TOPSOIL EXCAVATION AND EARTH UNDERCUT

NOTE 1
TRANSITION THE PROPOSED PROFILE GRADE LINE FROM THE PROPOSED CENTERLINE AT STA. 662+00.00 TO 3.5' LT. AT STA. 665+11.50. SEE THE TYPICAL SECTIONS, PAVEMENT MARKING, AND CROSS SECTION SHEETS FOR ADDITIONAL INFORMATION.

STORM SEWER STRUCTURE SCHEDULE

STR. NO.	STRUCTURE TYPE	OFF-SET SIDE	STA. OF C/L 2 FT. OPENING	OFFSET OF C/L 2 FT. OPENING	STA. OF C/L STR.	OFFSET OF C/L STR.	EX. T/O FRAME/GRATE ELEV.	PR. T/O FRAME/SLAB TOP ELEV.	INVERT IN ELEV.	U.S. STR. NO.	INVERT OUT ELEV.	D.S. STR. NO.
315	RD MAN TA 4 DIA T3V F&G	LT	661+95.00	19.80	661+95.00	18.80	745.23	744.15	741.52	316	740.15	314
316	RD INLETS TB T3V F & G	RT	661+95.00	19.80	661+95.00	20.30	745.23	744.15	740.25	318	741.70	315
317	PRC FLAR END SEC 12"	RT	---	---	662+29.00	27.50	---	---	741.82	---	743.25	316
318	PRC FLAR END SEC 15"	LT	---	---	662+29.00	28.00	---	---	743.50	---	742.97	315

STORM SEWER PIPE SCHEDULE

LOCATION STR. - STR. OR STA., O.S.	STORM SEWER CL A 12" (FOOT)	STORM SEWER CL A 15" (FOOT)	GRADE %	CONTR LOW-STRENG MATL (CU YD)
315 - 316	36		0.50	6.4
315 - 318		34	8.00	3.1
316 - 317	34		4.20	1.4

*STATION AND OFFSET TO DOWNSTREAM END OF END SECTION