

SEC. 35, T.19N., R.8E., 3rd P.M.  
CHAMPAIGN COUNTY, ILLINOIS

F.A.P. RTE.	SECTION	COUNTY	TOTAL SHEETS	SHEET NO.
807	00-00374-01-PV	CHAMPAIGN	242	72
STA. 650+00.00		TO STA. 655+00.00		
ILLINOIS F.A. PROJ. NO. RS-HPP-1805(001)				
CONTRACT NO. 91368				

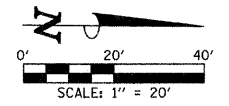

- LEGEND**
- PROPOSED AGGREGATE SURFACE COURSE, TYPE B (8" THICK)
  - PROPOSED PRECAST BLOCK REVETMENT MAT

FURNISHING AND ERECTING RIGHT-OF-WAY MARKERS = 1 EACH  
STA. 651+75.00, 40.00' LT.

FOR REMOVAL/RELOCATION PLAN IN THIS AREA SEE SHEET NO. 44

SEE SCHEDULE OF QUANTITIES FOR TYPICAL SECTION PAVEMENT PAY ITEMS AND THEIR LOCATIONS.

SEE THE STAGE CONSTRUCTION AND MAINTENANCE OF TRAFFIC PLANS FOR THE VARIOUS STAGES AND CONSTRUCTION SEQUENCES ON PROSPECT AVE.

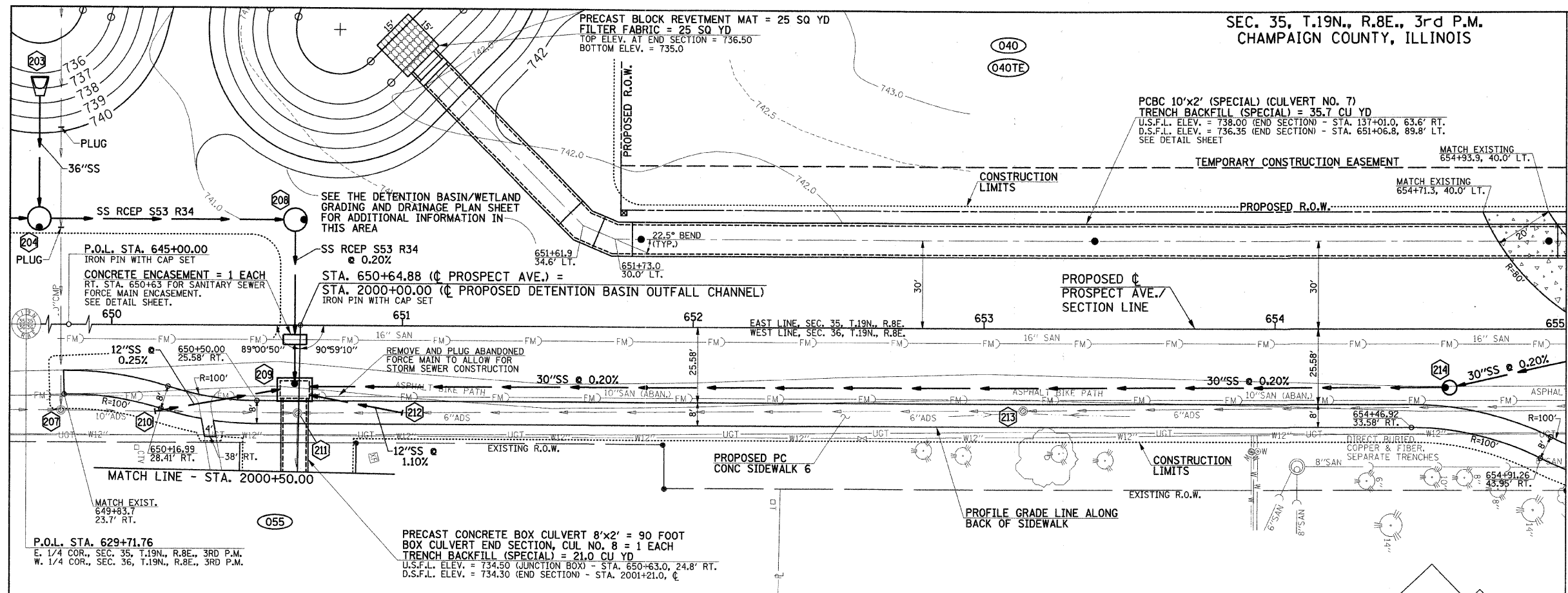

SEC. 36, T.19N., R.8E., 3rd P.M.  
CHAMPAIGN COUNTY, ILLINOIS

STR. NO.	STRUCTURE TYPE	OFF-SET SIDE	STA. OF C/L 2 FT. OPENING	OFFSET OF C/L 2 FT. STR.	STA. OF C/L STR.	OFFSET OF C/L STR.	EX. T/O FRAME/GRATE ELEV.	PR. T/O FRAME/GRATE ELEV.	PR. T/O FLAT SLAB TOP ELEV.	INVERT IN ELEV.	U.S. STR. NO.	INVERT OUT ELEV.	D.S. STR. NO.	
755	207	RT	649+82.50	---	---	---	738.52	---	---	736.72	SOUTH WEST	735.22	211	
750	208	LT	650+66.00	36.00	650+63.00	36.00	741.00	740.00	740.00	735.19	204	735.10	209	
	209	RT	650+63.00	19.80	650+63.00	21.80	740.20	739.40	739.40	735.00	208	734.50	BOX CUL	
	210	---	---	---	650+63.00	---	---	---	---	734.59	210	---	---	
745	211	RT	650+64.00	30.00	650+64.00	---	737.81	---	---	734.62	214	733.81	215	
	212	RT	---	---	651+00.00	29.50	---	---	---	734.70	207	733.81	209	
	213	RT	---	---	653+13.50	28.00	739.98	741.54	---	735.11	213	735.50	209	
740	214	RT	654+58.50	19.80	654+60.00	19.80	742.00	741.00	741.00	735.48	48	735.40	209	
	*FIELD VERIFY LOCATION AND ELEVATION **SEE JUNCTION BOX, NO. 1 DETAIL SHEET													
	P.V.I. 651+00.00 (BACK OF PROP. SIDEWALK) = STA. 650+98.97 (C PROSPECT AVE.) ELEV. 740.75													

LOCATION STR. - STR. OR STA., O.S.	CONCRETE COLLAR (EACH)	STORM SEWER REM 6" (FOOT)	STORM SEWER REM 10" (FOOT)	STORM SEWER 1 RCEP S53 R34 (FOOT)	STORM SEWER CL A 2 12" (FOOT)	STORM SEWER CL A 2 30" (FOOT)	GRADE %	CONTR LOW-STRENGTH MATL (CU YD)
208 - 209				52	44		0.20	33.1
209 - 210	1				34		1.10	14.4
209 - 214			48			390	0.20	25.1
210 - 211								7.7
211 - 212		35	170					
211 - 215								

CONCRETE COLLARS SHALL BE USED TO CONNECT STORM SEWERS

