

F.A.P. RTE.	SECTION	COUNTY	TOTAL SHEETS	SHEET NO.
807	00-00374-01-PV	CHAMPAIGN	242	75
STA.	TO STA.			
	ILLINOIS F.A. PROJ. NO. RS-HPP-1805(00D)			
CONTRACT NO. 91368				

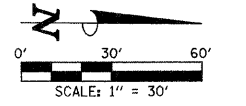

- LEGEND**
- ZONE 1 (BELOW ELEV. 735.0) AQUATIC ZONE
 - ZONE 2 (ELEV. 735.0 TO 736.0) SHORELINE/SEDGE MEADOW ZONE
 - ZONE 3 (ELEV. 736.0 TO 738.0) MESIC PRAIRIE ZONE
 - ZONE 4 (ELEV. 738.0 TO 741.0) PRAIRIE MIX ZONE
 - DECIDUOUS TREE (SEE PLANTING SCHEDULE FOR TREE SPECIES)
 - SELECTIVE MOWING STAKES

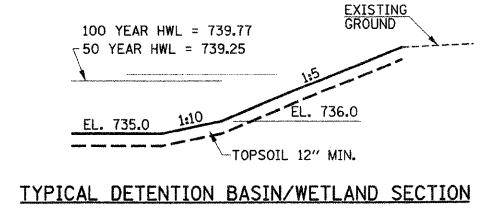
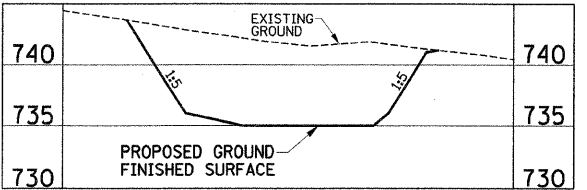
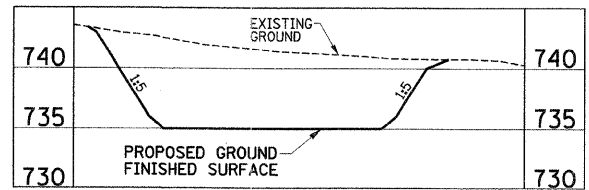
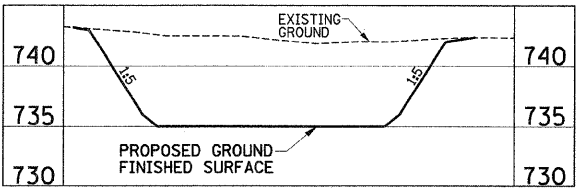
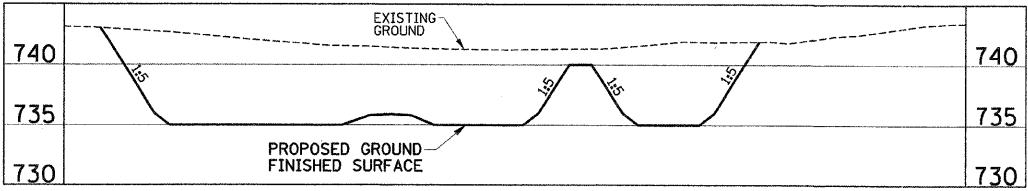
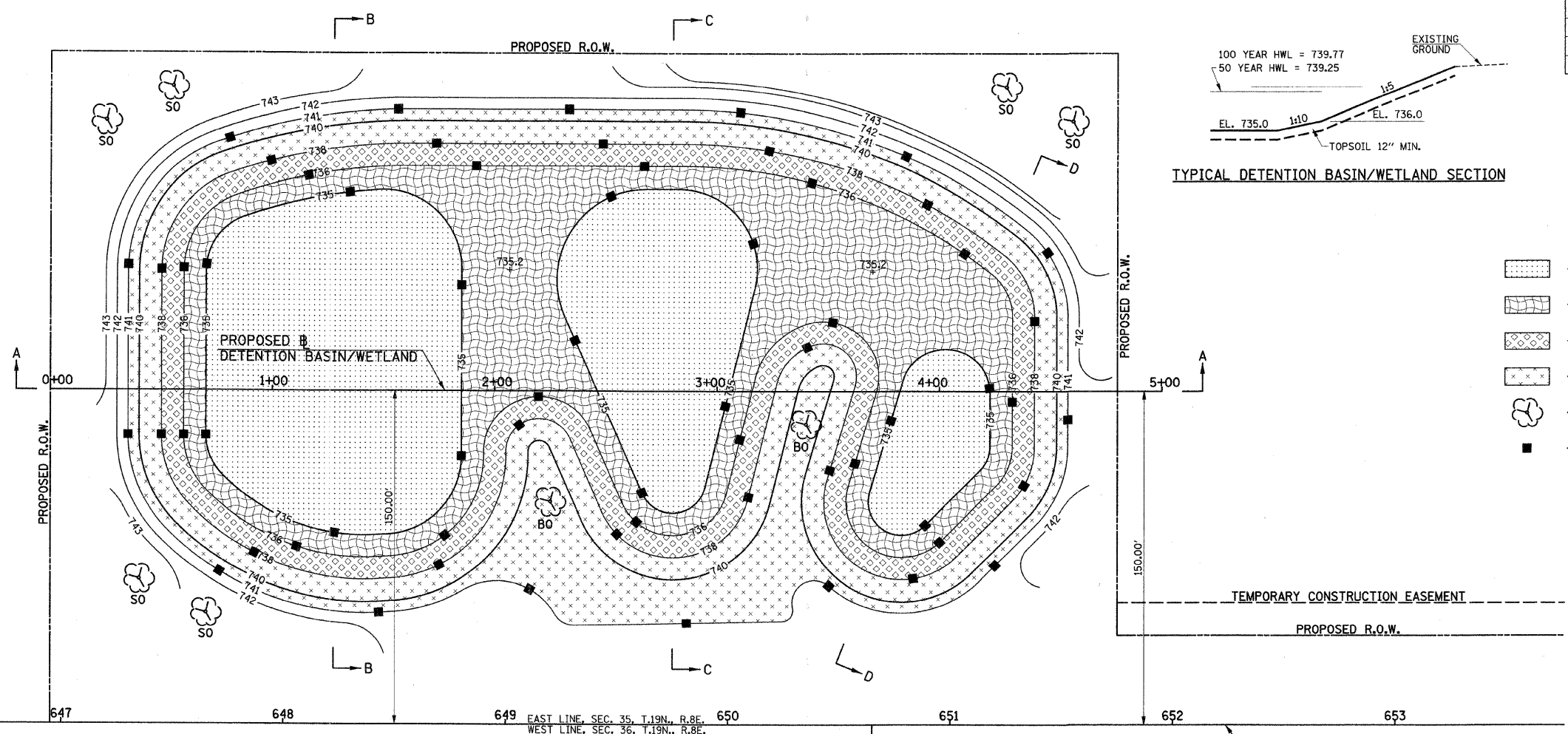

PLANTING ZONE	AREA (ACRE)	RATE	IDOT STANDARD SPECIFICATION SECTION REFERENCE	PLANTING SCHEDULE	PAY ITEM	UNIT	QUANTITY
1	0.7	SEE NOTE 1	SECTION 254.03(d)	PERENNIAL PLANTS, WETLAND EMERGENT TYPE, 6-12" WATER DEPTHS		UNIT	34
2	0.5	6 LB/ACRE	SECTION 250.07	SEEDING, CLASS 4B		ACRE	0.5
2	0.5	2 LB/ACRE	SECTION 250.07	SEEDING, CLASS 5B		ACRE	0.5
3	0.3	SEE NOTE 2	SECTION 254	PERENNIAL PLANTS, PRAIRIE TYPE (MODIFIED)		UNIT	1
3	0.3	SEE NOTE 2	SECTION 254	PRAIRIE SEEDING (SPECIAL)		ACRE	0.3
4	0.6	1 LB/ACRE	SECTION 250.07	SEEDING, CLASS 5		ACRE	0.6
ALL		SEE NOTE 3	SECTIONS 250.08 AND 1081.13(g)	SELECTIVE MOWING STAKES		EACH	62
TREE CODE							
SO			SECTIONS 253 AND 1081.01	TREE, QUERCUS BICOLOR (SWAMP WHITE OAK) 2 1/2" CALIPER, BALLED AND BURLAPPED		EACH	6
BO			SECTIONS 253 AND 1081.01	TREE, QUERCUS MACROCARPA (BUR OAK) 2 1/2" CALIPER, BALLED AND BURLAPPED		EACH	2

- NOTES**
- QUANTITIES FOR PERENNIAL PLANTS ARE BASED ON A SPACING OF THREE FOOT ON CENTER. QUANTITIES SHOULD BE DIVIDED EQUALLY AMONG THE SPECIES SPECIFIED FOR THE PLANTING ZONE.
 - SEE THE SPECIAL PROVISIONS FOR THE PLANTING SCHEDULE FOR THE MODIFIED PLANT LIST. BASED ON AVAILABILITY, PLANT SUBSTITUTIONS MAY BE MADE AT THE DISCRETION OF THE PLANTING CONTRACTOR. SUBSTITUTIONS MUST BE APPROVED BY THE ENGINEER AND I.D.O.T. THE CONTRACTOR SHALL PROVIDE A FINAL AS-BUILT PLANTING SCHEDULE AS A BASELINE RECORD FOR THE MONITORING PERIOD.
 - SELECTIVE MOWING STAKES SHALL BE PLACED AT 75 FOOT MAXIMUM SPACES TO DELINEATE THE PLANTING ZONES AT CONTOUR ELEVATIONS 735, 736, 738 AND 741.
 - SEEDING, CLASS 2 AND MULCH, METHOD 2 SHALL BE PLACED AROUND THE BASIN BEYOND THE ZONE 4 LIMITS.
 - FERTILIZER NUTRIENTS AND MULCH SHALL NOT BE SPREAD IN THE PLANTING ZONES 1, 2, 3 AND 4, BUT SHALL BE SPREAD IN THE CLASS 2 SEEDING AREA.
 - IN CONFORMANCE WITH THE WETLAND COMPENSATION PLAN, THE VILLAGE OF SAVOY WILL MONITOR AND MAINTAIN THE WETLAND SITE AFTER THE PLANTINGS HAVE BEEN ESTABLISHED AND ACCEPTED BY THE ENGINEER.

SEE THE DETENTION BASIN/WETLAND GRADING AND DRAINAGE PLAN SHEET FOR THE BASIN LAYOUT AND STORM SEWER OUTFALL INFORMATION.

ILLINOIS DEPARTMENT OF TRANSPORTATION
DETENTION BASIN/WETLAND PLANTING PLAN
 DATE : 10-08
 DRAWN BY : J.L.B.
 CHECKED BY : R.L.H.
 SCALE : 1"=30'