

SEC. 26, T.19N., R.8E., 3rd P.M.
CHAMPAIGN COUNTY, ILLINOIS

F.A.P. NO.	SECTION	COUNTY	TOTAL SHEETS	SHEET NO.
807	00-00374-01-PV	CHAMPAIGN	242	78
STA. 1012+00.00		TO STA. 1025+00.00		
ILLINOIS		F.A. PROJ. NO. RS-HPP-1805(000)		
CONTRACT NO. 91368				

PROPOSED PHINNEY
BRANCH CHANNEL
CURVE DATA
P.I. STA. 1013+94.32
Δ = 19°30'00"
D = 7°09'43"
T = 137.47'
R = 800.00'
L = 272.27'
E = 11.72'
P.C. STA. 1012+56.85
P.T. STA. 1015+29.12

040
040TE

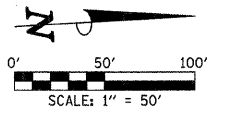

DATE	BY
DATE	BY
DATE	BY
DATE	BY
DATE	BY

DATE	BY
DATE	BY
DATE	BY
DATE	BY
DATE	BY

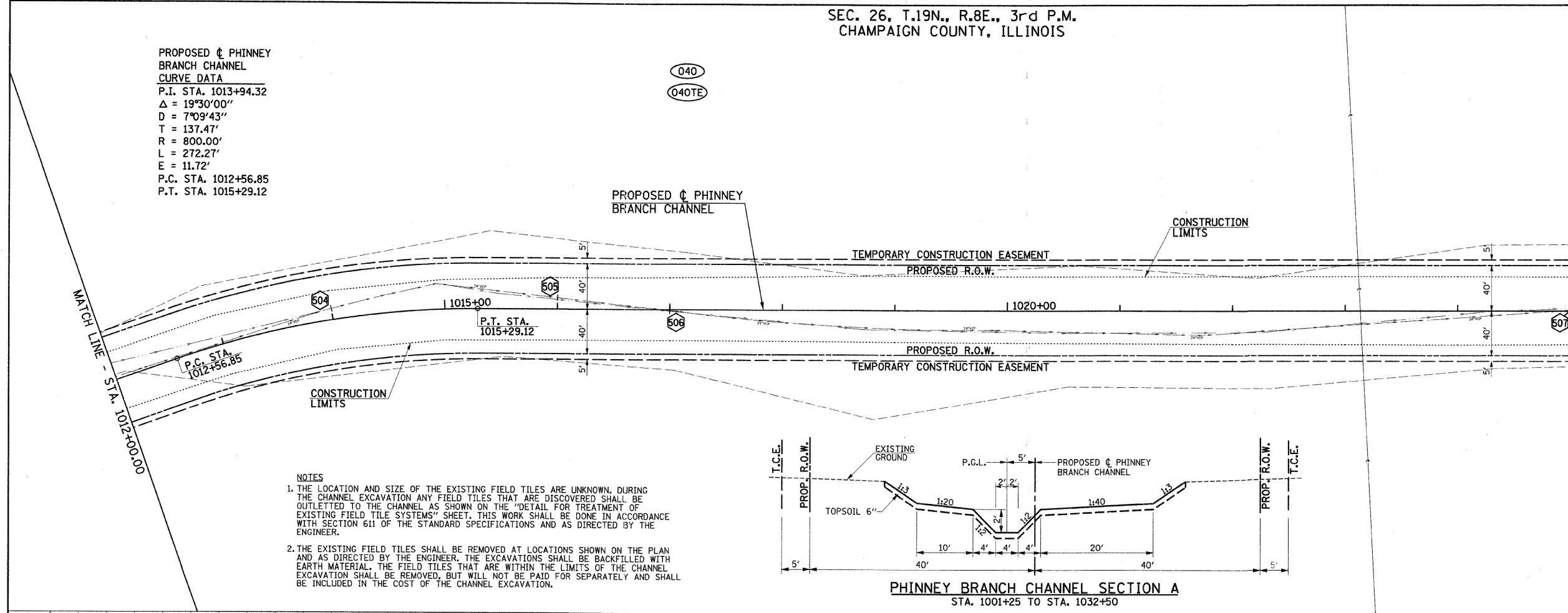

- NOTES
1. THE LOCATION AND SIZE OF THE EXISTING FIELD TILES ARE UNKNOWN. DURING THE CHANNEL EXCAVATION ANY FIELD TILES THAT ARE DISCOVERED SHALL BE OUTLETTED TO THE CHANNEL AS SHOWN ON THE "DETAIL FOR TREATMENT OF EXISTING FIELD TILE SYSTEMS" SHEET. THIS WORK SHALL BE DONE IN ACCORDANCE WITH SECTION 611 OF THE STANDARD SPECIFICATIONS AND AS DIRECTED BY THE ENGINEER.
 2. THE EXISTING FIELD TILES SHALL BE REMOVED AT LOCATIONS SHOWN ON THE PLAN AND AS DIRECTED BY THE ENGINEER. THE EXCAVATIONS SHALL BE BACKFILLED WITH EARTH MATERIAL. THE FIELD TILES THAT ARE WITHIN THE LIMITS OF THE CHANNEL EXCAVATION SHALL BE REMOVED, BUT WILL NOT BE PAID FOR SEPARATELY AND SHALL BE INCLUDED IN THE COST OF THE CHANNEL EXCAVATION.

SEE THE STAGE CONSTRUCTION AND MAINTENANCE OF TRAFFIC PLANS FOR THE VARIOUS STAGES AND CONSTRUCTION SEQUENCES ON CURTIS RD.

PHINNEY BRANCH CHANNEL SECTION A
STA. 1001+25 TO STA. 1032+50

ELEVATION	STORM SEWER PIPE SCHEDULE				STORM SEWER STRUCTURE SCHEDULE											ELEVATION			
	LOCATION STR.-STR. OR STA., O.S.	STORM SEWER REM 24" (FOOT)	GRADE %	CONTR LOW-STRENG MATL (CU YD)	STR. NO.	STRUCTURE TYPE	OFF-SET SIDE	STA. OF C/L 2 FT. OPENING	OFFSET OF C/L 2 FT. OPENING	STA. OF C/L STR.	OFFSET OF C/L STR.	EX. T/O FRAME/GRATE ELEV.	PR. T/O FRAME/GRATE ELEV.	PR. T/O FLAT SLAB TOP ELEV.	INVERT IN ELEV.		U.S. STR. NO.	INVERT OUT ELEV.	D.S. STR. NO.
750	504 - 505	200			504	BEGIN S.S. REMOVAL	LT			1014+00.00	+10.00				*728.20	SOUTH	*728.20	505	
745	506 - 507	800			505	END S.S. REMOVAL	LT			1016+00.00	+10.00				*727.90	504	*727.90	NORTH	
740					506	BEGIN S.S. REMOVAL	RT			1017+00.00	+1.00				*727.70	SOUTH	*727.70	507	
735					507	END S.S. REMOVAL	LT			1025+00.00	+2.00				*725.10	506	*725.10	NORTH	
730	*FIELD VERIFY LOCATION AND ELEVATION																		
725																			
720																			
715																			
710																			