

F.A.P. RTE.	SECTION	COUNTY	TOTAL SHEETS	SHEET NO.
807	00-00374-01-PV	CHAMPAIGN	242	82
STA.	TO STA.		ILLINOIS F.A. PROJ. NO. RS-HPP-1805(00)	
CONTRACT NO. 91368				



**LEGEND**

- CONSTRUCTION WORK ZONE
- POST MOUNTED SIGN LOCATION
- DETOUR SIGN NUMBER
- DIRECTION OF DETOUR
- PORTABLE CHANGEABLE MESSAGE SIGN

**DETOUR SIGN LEGEND**

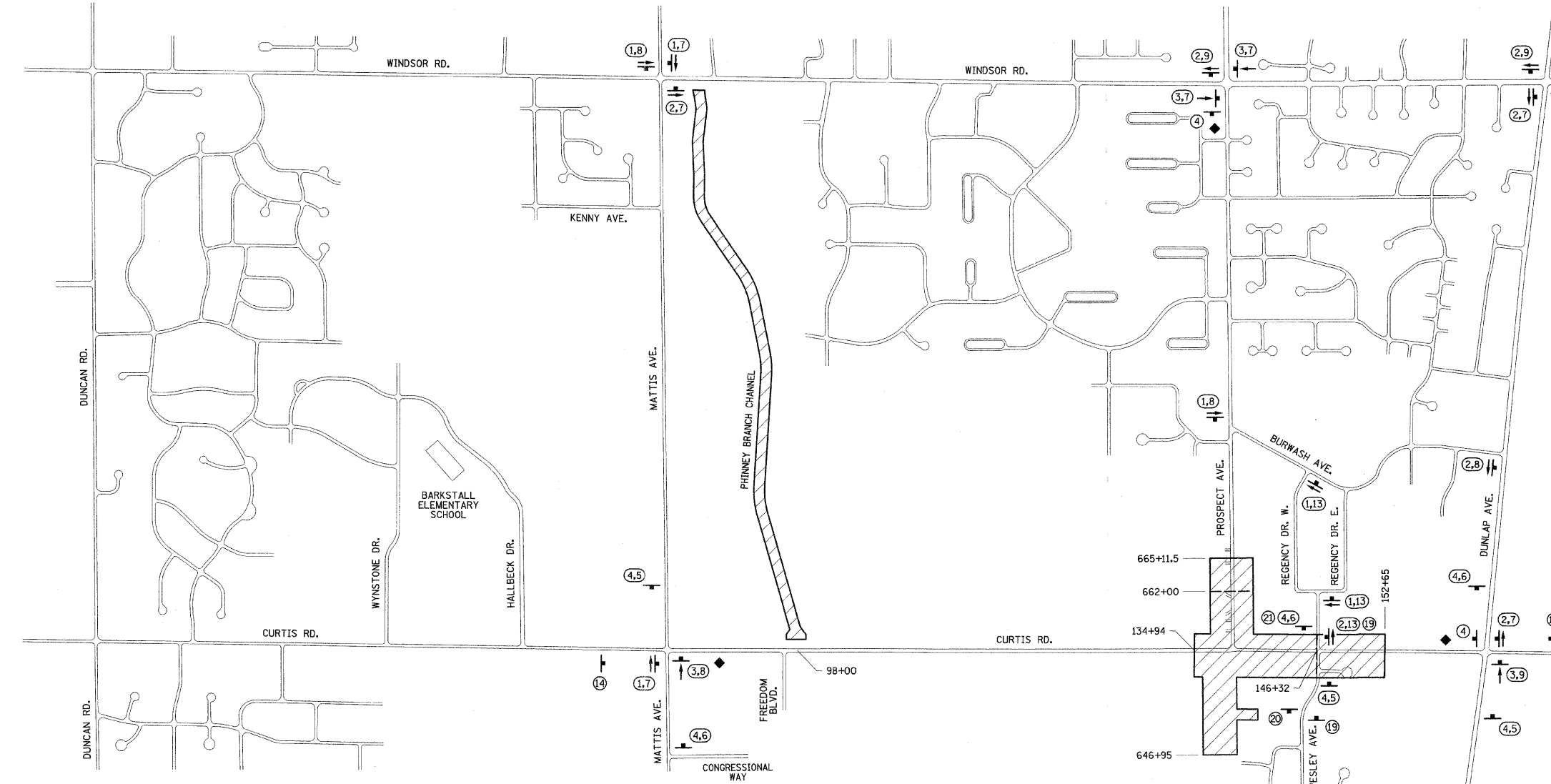

**SUGGESTED STAGE I CONSTRUCTION SEQUENCE**

1. CONSTRUCT THE TEMPORARY AGGREGATE ACCESS ROAD ON PROSPECT AVENUE BETWEEN STATIONS 658+48.7 AND 662+40.0 AND ON CURTIS ROAD BETWEEN STATIONS 134+65.0 AND 135+67.0 AS SHOWN IN THE DETAILS ON THIS SHEET. THE ACCESS ROADS SHALL BE CONSTRUCTED AT GRADE OR AS OTHERWISE DIRECTED BY THE ENGINEER. PROVIDE TRAFFIC CONTROL ON PROSPECT AVENUE AND CURTIS ROAD IN ACCORDANCE WITH STANDARD 701501.
2. CONSTRUCT THE PROSPECT POINTE APARTMENTS DRIVEWAY ON WESLEY AVENUE AS SHOWN ON THE DETAIL IN THE PLANS. PROVIDE TRAFFIC CONTROL ON WESLEY AVENUE IN ACCORDANCE WITH STANDARD 701501. THE DRIVEWAY SHALL BE OPEN TO TRAFFIC PRIOR TO CLOSING CURTIS ROAD.
3. CLOSE EASTBOUND CURTIS ROAD TO THRU TRAFFIC AT FREEDOM BOULEVARD (STATION 98+00) IN ACCORDANCE WITH STANDARD BLR 22. CLOSE CURTIS ROAD TO ALL TRAFFIC AT PROSPECT AVENUE (STATION 134+94) IN ACCORDANCE WITH STANDARD BLR 21. CLOSE CURTIS ROAD TO ALL TRAFFIC AT REGENCY DRIVE/WESLEY AVENUE (STATION 146+32) IN ACCORDANCE WITH STANDARD BLR 21. PROVIDE "ROAD CONSTRUCTION AHEAD" SIGNS ON REGENCY DRIVE AND WESLEY AVENUE IN ACCORDANCE WITH STANDARD 701502 AND AS DIRECTED BY THE ENGINEER.
4. CLOSE SOUTHBOUND PROSPECT AVENUE TO THRU TRAFFIC AT STATION 665+15 IN ACCORDANCE WITH STANDARD BLR 22. CLOSE PROSPECT AVENUE TO ALL TRAFFIC AT STATION 662+00 IN ACCORDANCE WITH STANDARD BLR 21.
5. CLOSE THE EXISTING SIDEWALKS AND BICYCLE PATHS ON CURTIS ROAD AT STATIONS 138+70 AND 152+65 AND ON PROSPECT AVENUE AT STATIONS 646+95 AND 665+11.5 IN ACCORDANCE WITH STANDARD 701801.
6. CONSTRUCT CURTIS ROAD BETWEEN STATIONS 134+94 AND 146+32. INCLUDE THE STORM SEWERS TO PROPOSED INLET NO. 400 AND PROPOSED MANHOLE NO. 39. PROVIDE TEMPORARY TYPE B GRATES ON PROPOSED INLET NO. 400 AND PROPOSED MANHOLE NO. 39 DURING THIS STAGE. THE TYPE B GRATES SHALL BE INCLUDED IN THE LUMP SUM PRICE OF TRAFFIC CONTROL COMPLETE. PROVIDE A TEMPORARY DITCH FROM THE EXISTING DITCH AT APPROXIMATE LT. STATION 134+00 TO PROPOSED INLET NO. 400. PROVIDE A TEMPORARY DITCH FROM THE EXISTING CULVERT OUTLET AT APPROXIMATE RT. STATION 132+98 TO PROPOSED MANHOLE NO. 39. CONSTRUCT THE PCC DRIVEWAY PAVEMENT AND SIDEWALK FOR THE ENTRANCE AT LT. STATION 134+89.7 IN HALF-WIDTHS USING HIGH-EARLY STRENGTH CONCRETE. SEE THE PLAN AND PROFILE SHEET AND THE SPECIAL PROVISION FOR TRAFFIC CONTROL COMPLETE FOR ADDITIONAL INFORMATION. DO NOT CONSTRUCT THE PROPOSED SHOULDER BETWEEN STATIONS 134+94 AND 137+86 DURING THIS STAGE. DO NOT CONSTRUCT THE PROPOSED DITCH BETWEEN STATIONS 134+94 AND 137+01 DURING THIS STAGE. CONSTRUCT PROSPECT AVENUE BETWEEN STATIONS 656+39.33 AND 662+00.
7. BEGIN CONSTRUCTION OF CULVERT NO. 7, THE STORM SEWER OUTFALL, THE DETENTION BASIN/WETLAND, AND THE PHINNEY BRANCH CHANNEL DURING STAGE I.
8. CONSTRUCT THE TRANSITION PAVEMENT ON PROSPECT AVENUE BETWEEN STATIONS 662+00 AND 665+11.5. THE ROAD CLOSURE AT STATION 662+00 SHALL BE RELOCATED TO STATION 665+11.5. THE ENTRANCES AT LT. STATIONS 658+39.3, 659+32.0, 660+22.5, AND 661+42.5 SHALL HAVE ACCESS TO PROSPECT AVENUE SOUTH OF STATION 662+00 AND CURTIS ROAD EAST OF STATION 137+19 DURING CONSTRUCTION OF THE TRANSITION PAVEMENT ON PROSPECT AVENUE. THE CONTRACTOR SHALL MODIFY THE TRAFFIC CONTROL DEVICES AS DIRECTED BY THE ENGINEER TO ALLOW THIS ACCESS FROM THE ENTRANCES WHILE PREVENTING ACCESS TO PROSPECT AVENUE NORTH OF STATION 662+00. AGGREGATE FOR TEMPORARY ACCESS SHALL BE PROVIDED FOR THE ENTRANCE AT LT. STATION 664+66.5 DURING CONSTRUCTION OF THE TRANSITION PAVEMENT AS DIRECTED BY THE ENGINEER. A QUANTITY OF 30 TONS OF AGGREGATE FOR TEMPORARY ACCESS HAS BEEN ASSUMED FOR THIS ENTRANCE.
9. CONSTRUCT CURTIS ROAD BETWEEN STATIONS 146+32 AND 152+65. PROVIDE TRAFFIC CONTROL ON CURTIS ROAD EAST OF STATION 146+32 IN ACCORDANCE WITH STANDARDS 701502 AND 701701. TWO-WAY TRAFFIC SHALL BE MAINTAINED ON CURTIS ROAD EAST OF STATION 146+32. CONSTRUCT TEMPORARY RAMPS AS DIRECTED BY THE ENGINEER AT ENTRANCES, REGENCY DRIVE, WESLEY AVENUE, AND STATION 152+65. THE TEMPORARY RAMPS SHALL BE CONSTRUCTED AFTER THE PLACEMENT OF THE HMA BINDER COURSE AND AT THE BUTT JOINT LOCATIONS. CURTIS ROAD SHALL REMAIN CLOSED TO ALL TRAFFIC WEST OF STATION 146+32 EXCEPT FOR RESIDENTS ACCESSING THEIR PROPERTIES ALONG PROSPECT AVENUE SOUTH OF STATION 662+00.
10. THE PROPOSED TRAFFIC SIGNAL HEADS AT THE INTERSECTION OF CURTIS ROAD AND PROSPECT AVENUE SHALL BE BAGGED UNTIL THE END OF STAGE IV UNLESS OTHERWISE DIRECTED BY THE ENGINEER.
11. AT THE END OF STAGE I, CLOSE THE SIDEWALKS AND BICYCLE PATHS ON CURTIS ROAD AT STATION 137+80 AND ON PROSPECT AVENUE AT STATIONS 646+95 AND 655+58 IN ACCORDANCE WITH STANDARD 701801. THE CLOSURE ON CURTIS ROAD AT STATION 137+80 SHALL REMAIN IN PLACE UNTIL THE END OF STAGE IV UNLESS OTHERWISE DIRECTED BY THE ENGINEER. THE CLOSURES ON PROSPECT AVENUE AT STATIONS 646+95 AND 655+58 SHALL REMAIN IN PLACE UNTIL THE CONSTRUCTION WORK IN THIS AREA IS FINISHED UNLESS OTHERWISE DIRECTED BY THE ENGINEER.
12. SEE THE SPECIAL PROVISION FOR TRAFFIC CONTROL COMPLETE FOR INFORMATION ON THE "PROSPECT POINTE APARTMENTS" SIGNS.

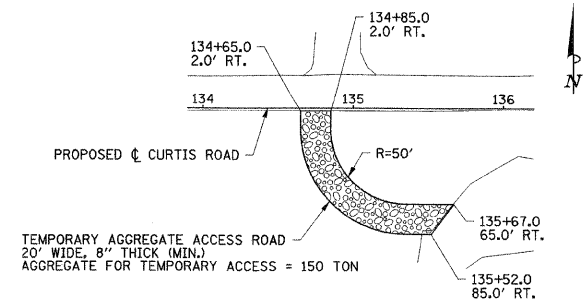

**STAGE I TEMPORARY AGGREGATE ACCESS ROAD DETAIL - CURTIS ROAD**

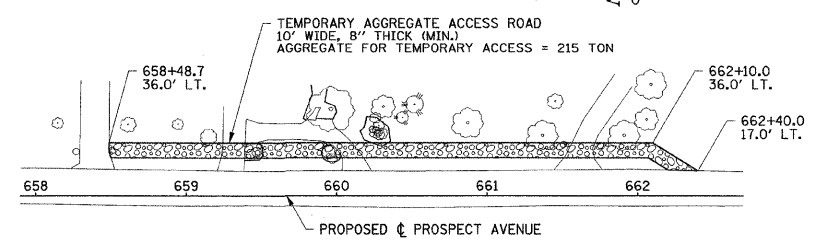

**STAGE I TEMPORARY AGGREGATE ACCESS ROAD DETAIL - PROSPECT AVENUE**

ILLINOIS DEPARTMENT OF TRANSPORTATION  
**STAGE CONSTRUCTION AND MAINTENANCE OF TRAFFIC PLANS**  
 STAGE I

DATE : 10-08  
 DRAWN BY : J.A.J.  
 CHECKED BY : R.L.H.  
 SCALE : NONE